

NAME	QUANT.
HIGH ST.	6
EAST ST.	1
BURTON ST.	1
ORCHARD ST.	1
WATER ST.	3
THIRD ST.	1
SECOND ST.	3

CURVE DATA
 R = 1909.86'
 Δ = 3°36'41"
 T = 60.21'
 A = 120.38'
 C = 120.36'

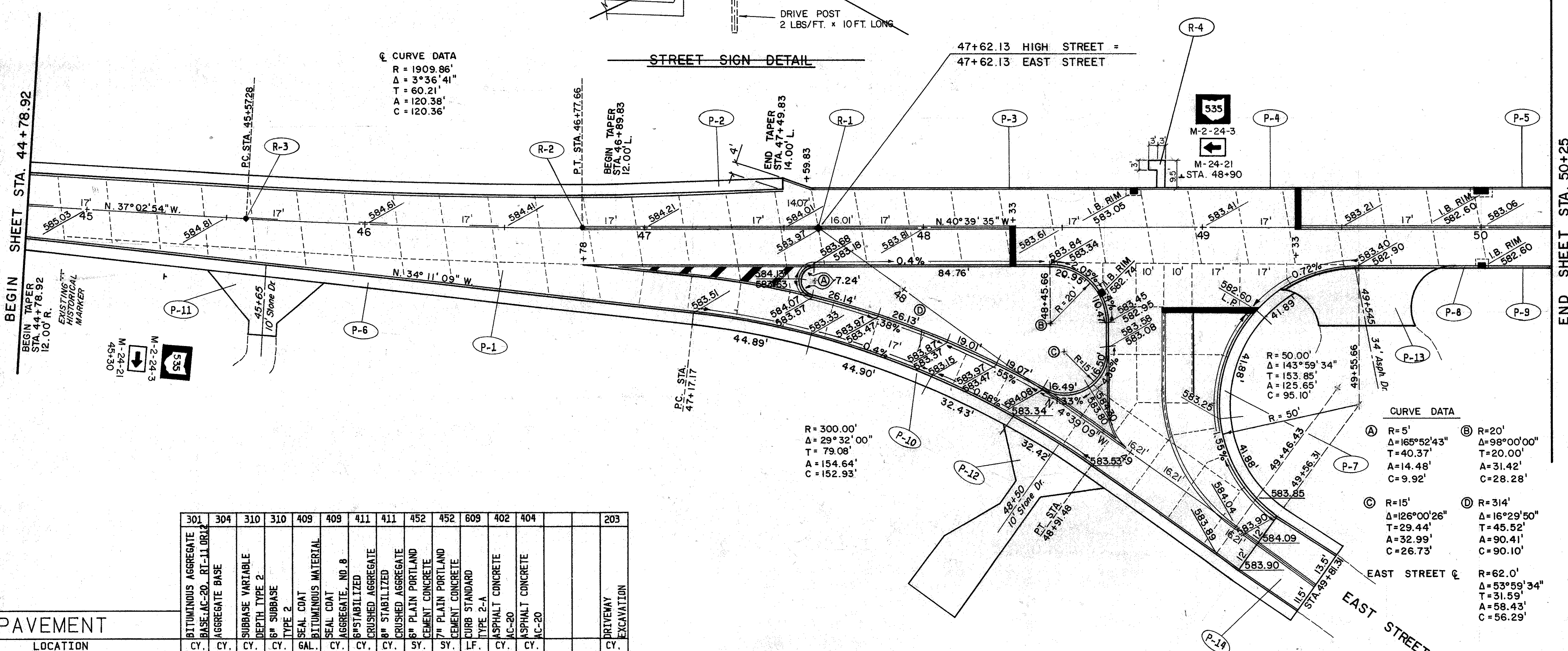

CURVE DATA
 A R=5' Δ=165°52'43" T=40.37' A=14.48' C=9.92'
 B R=20' Δ=98°00'00" T=20.00' A=31.42' C=28.28'
 C R=15' Δ=126°00'26" T=29.44' A=32.99' C=26.73'
 D R=314' Δ=16°29'50" T=45.52' A=90.41' C=90.10'
 R=62.0' Δ=53°59'34" T=31.59' A=58.43' C=56.29'

PAVEMENT

REF	LOCATION	301	304	310	310	409	409	411	411	452	452	609	402	404	203
		BITUMINOUS AGGREGATE BASE AC-20 RT-11 DR12	AGGREGATE BASE	SUBBASE VARIABLE DEPTH TYPE 2	6" SUBBASE TYPE 2	SEAL COAT BITUMINOUS MATERIAL	SEAL COAT AGGREGATE, NO. 8	6" STABILIZED CRUSHED AGGREGATE	8" STABILIZED CRUSHED AGGREGATE	6" PLAIN PORTLAND CEMENT CONCRETE	7" PLAIN PORTLAND CEMENT CONCRETE	CURB STANDARD TYPE 2-A	ASPHALT CONCRETE AC-20	ASPHALT CONCRETE AC-20	DRIVEWAY EXCAVATION
P-1	44+78.92-50+52				447.5										
P-2	44+78.92-47+49.83 L.	11.7	10.0	14.6		48.2	1.0								
P-3	47+49.83-48+73.5 L.														124.3
P-4	48+76.5-49+96.9 L.														120.4
P-5	50+03.1-50+25 L.														21.9
P-6	44+78.92-49+81.31 R.	21.1	18.7	27.0		86.7	1.7								
P-7	49+81.31-49+28.5 R.	5.3	4.7	6.8		21.8	0.4								
P-8	49+86.5-49+28.5 R.														75.5
P-9	50+01.5-50+25 R.														23.5
P-10	47+65.9-48+65.66														262.2
P-11	DRIVE 45+65 (COMM.) R.							11.1							11.1
P-12	DRIVE 48+50 R.							23.1							23.1
P-13	DRIVE 49+54.5 R.									86.2		3.3	1.9		14.4
P-14	49+56.31-49+81.31 (EAST STREET)	10.2													
TOTALS		49	34	49	448	157	4	24	12	87	2686	628	4	2	49

ROADWAY

REF	LOCATION	EA.	S.F.
R-1	47+62.13	1	
R-2	48+77.66	1	
R-3	45+57.28	1	
R-4	48+84.5 TO 48+87.5		38
TOTALS		3	38

TRAFFIC CONTROL

REF	LOCATIONS	MI.	MI.	MI.	LF.	LF.	LF.	SF.	LF.
C/L	44+78.92-46+78					0.04			
C/L	46+78-48+33			0.03					
C/L	49+33-50+25			0.02					
RT.	48+86-49+81.31 (EAST STREET)			0.02					
RT.	48+33								14.5
LT.	49+33								14.5
RT.	EAST STREET			0.02	73	25	35		
RT.	46+78-47+60				164	30			
RT.	48+97				30				
LT.	44+78.92-47+49.83				0.05				
RT.	44+78.92-49+81.31				0.09				
RT/LT	45+30 & 48+90 (M-2-24-3 & M-24-21)								14.4 26
TOTALS		0.07	0.04	0.16	267	55	64	15	26

HIGH STREET / WATER STREET