

MAINTENANCE OF TRAFFIC

MAINTENANCE OF TRAFFIC

THE WORK UNDER THIS IMPROVEMENT WILL REQUIRE THE CLOSING OF WATER STREET FROM THIRD STREET TO SECOND STREET AND SECOND STREET FROM WATER STREET TO HIGH STREET TO THROUGH TRAFFIC DURING PHASE I CONSTRUCTION AND THE CLOSING OF HIGH STREET TO NORTHBOUND TRAFFIC BETWEEN STATIONS 49+00 AND 84+45 DURING PHASE II CONSTRUCTION IN ACCORDANCE WITH THE FOLLOWING CONSTRUCTION PHASES:

- PHASE I: STATION 84+45 TO 129+10 AND SECOND STREET AND HIGH STREET.
- PHASE II: STATION 40+39 TO 84+45.

THE CONTRACTOR SHALL COMPLETE ALL WORK WITHIN A PARTICULAR PHASE OF CONSTRUCTION WITH THE EXCEPTION OF SEEDING AND SODDING AND PERMANENT PAVEMENT STRIPING PRIOR TO COMMENCING ANY WORK ON ANOTHER PHASE OF THE PROJECT. IN ADDITION, ALL WORK ASSOCIATED WITH THE REMOVAL AND RELOCATION OF THE UNITED STATES INDUSTRIAL CHEMICAL CO. RAILROAD SIDING GENERALLY WITHIN THE LIMITS OF STATIONS 74+08 AND 91+00 SHALL BE COMPLETED WITH PHASE I WORK PRIOR TO COMMENCING WORK ON PHASE II.

TWO-WAY TRAFFIC SHALL BE MAINTAINED ON HIGH STREET BETWEEN STATIONS 40+39 AND 49+00 AT ALL TIMES. WHILE WORK IS IN PROGRESS ON THAT SECTION OF PHASE II BETWEEN STATIONS 49+00 AND 84+45, NORTHBOUND HIGH STREET TRAFFIC SHALL BE DETOURED ALONG EAST STREET AND SECOND STREET AS SHOWN IN THE PHASE II PLAN ON THIS SHEET AND SOUTHBOUND HIGH STREET TRAFFIC SHALL BE MAINTAINED ON THE EXISTING HIGH STREET ALIGNMENT USING EXISTING PAVEMENT, NEW PAVEMENT OR CLASS "B" TEMPORARY PAVEMENT AS SHOWN ON SHEETS 10 AND 11.

PHASING AND SIGNING SHALL BE AS SHOWN ON SHEETS 9, 10, 11 AND 12.

ALL CONSTRUCTION TRAFFIC CONTROL SIGNS AND DETOUR SIGNS USED FOR THIS PROJECT SHALL CONFORM TO THE CURRENT "OHIO MANUAL OF UNIFORM TRAFFIC CONTROL DEVICES FOR STREETS AND HIGHWAYS", AND SHALL BE PROVIDED, ERECTED, MAINTAINED, AND SUBSEQUENTLY REMOVED BY THE CONTRACTOR.

THE VILLAGE OF FAIRPORT HARBOR POLICE, FIRE, AND SERVICE DEPARTMENTS SHALL BE NOTIFIED OF THE COMMENCEMENT OF CONSTRUCTION AT LEAST ONE (1) WEEK PRIOR TO THE ACTUAL START OF CONSTRUCTION. THE CONTRACTOR SHALL COORDINATE ALL TRAFFIC MAINTENANCE WITH THE FAIRPORT HARBOR POLICE DEPARTMENT PRIOR TO THE START OF ANY WORK.

LOCAL ACCESS TO ABUTTING PROPERTIES SHALL BE MAINTAINED AT ALL TIMES BY THE USE OF THE EXISTING PAVEMENT AND DRIVEWAYS. THE PROPOSED PAVEMENTS AND DRIVEWAYS, AND TEMPORARY PAVEMENT SURFACED WITH ITEM 410 AGGREGATE STABILIZED WITH ITEM 616 CALCIUM CHLORIDE OR ITEM 404 BITUMINOUS CONCRETE. THE LIMITS AND DURATION OF USE OF TEMPORARY WEARING SURFACES SHALL BE HELD TO AN ABSOLUTE MINIMUM, AND IN ALL CASES SHALL BE SUBJECT TO THE APPROVAL OF THE ENGINEER.

TEMPORARY LANE WIDTHS FOR MAINTAINING TRAFFIC SHALL BE A MINIMUM OF TEN (10) FEET.

THE FOLLOWING ITEMS FOR MAINTENANCE OF LOCAL ACCESS HAVE BEEN INCLUDED IN THE GENERAL SUMMARY FOR USE AS DIRECTED BY THE ENGINEER:

ITEM 404 BITUMINOUS CONCRETE FOR MAINTAINING TRAFFIC	50	C.Y.
ITEM 410 TRAFFIC COMPACTED SURFACE, TYPE A OR B	500	C.Y.
ITEM 616 CALCIUM CHLORIDE	10	Tons
ITEM 616 WATER	10	M. GALS.

PAYMENT FOR MAINTAINING LOCAL ACCESS SHALL BE INCLUDED IN THE LUMP SUM PRICE BID FOR ITEM 614, MAINTAINING TRAFFIC.

INTERSECTING STREETS

INTERSECTING STREETS WITHIN THE PROJECT LIMITS MAY BE CLOSED AFTER THE CONTRACTOR HAS FURNISHED AND ERECTED THE NECESSARY "ROAD CLOSED" SIGNS. THE CONTRACTOR SHALL REMOVE THE SIGNS UPON COMPLETION OF THE WORK. NO MORE THAN TWO (2) CONSECUTIVE INTERSECTING STREETS MAY BE CLOSED TO TRAFFIC AT HIGH STREET OR WATER STREET AT ANY ONE TIME UNLESS OTHERWISE DIRECTED BY THE ENGINEER.

WHEN INTERSECTING STREETS ARE CLOSED AT HIGH STREET OR WATER STREET, THE CONTRACTOR SHALL FURNISH, INSTALL, MAINTAIN, AND SUBSEQUENTLY REMOVE ADEQUATE SIGNS AND BARRICADES FOR THE PURPOSE OF PROVIDING ADVANCE WARNING OF SUCH CLOSINGS. THE CONTRACTOR SHALL NOTIFY THE VILLAGE OF FAIRPORT HARBOR POLICE, FIRE, AND SERVICE DEPARTMENTS AT LEAST 72 HOURS BEFORE CLOSING ANY STREETS.

THE CONTRACTOR SHALL FURNISH AND MAINTAIN ALL NECESSARY SAFEGUARDS SUCH AS BARRICADES, SATISFACTORY BARRIERS, LIGHTING, FLAGMEN, TEMPORARY GUARDRAIL, AND SUCH OTHER TRAFFIC CONTROL DEVICES AS PROVIDED IN "ITEM 614, MAINTAINING TRAFFIC" SO AS TO AVOID DAMAGE AND/OR INJURY TO VEHICLES AND PERSONS USING THE ROADWAY DURING CONSTRUCTION.

PAYMENT FOR LABOR AND EQUIPMENT REQUIRED FOR THE CONSTRUCTION, MAINTENANCE, AND SUBSEQUENT REMOVAL WHEREVER OF APPROACHES, DRIVEWAYS, BARRICADES, LIGHTS, TEMPORARY TRAFFIC DELINEATORS, FLAGMEN AND SIGNS SHALL BE INCLUDED IN THE LUMP SUM BID FOR ITEM 614, MAINTAINING TRAFFIC.

A QUANTITY OF CALCIUM CHLORIDE AND WATER IS PROVIDED FOR USE FOR DUST CONTROL AS DIRECTED BY THE ENGINEER.

ITEM 616 CALCIUM CHLORIDE	100	Tons
ITEM 616 WATER	500	M. GALLONS

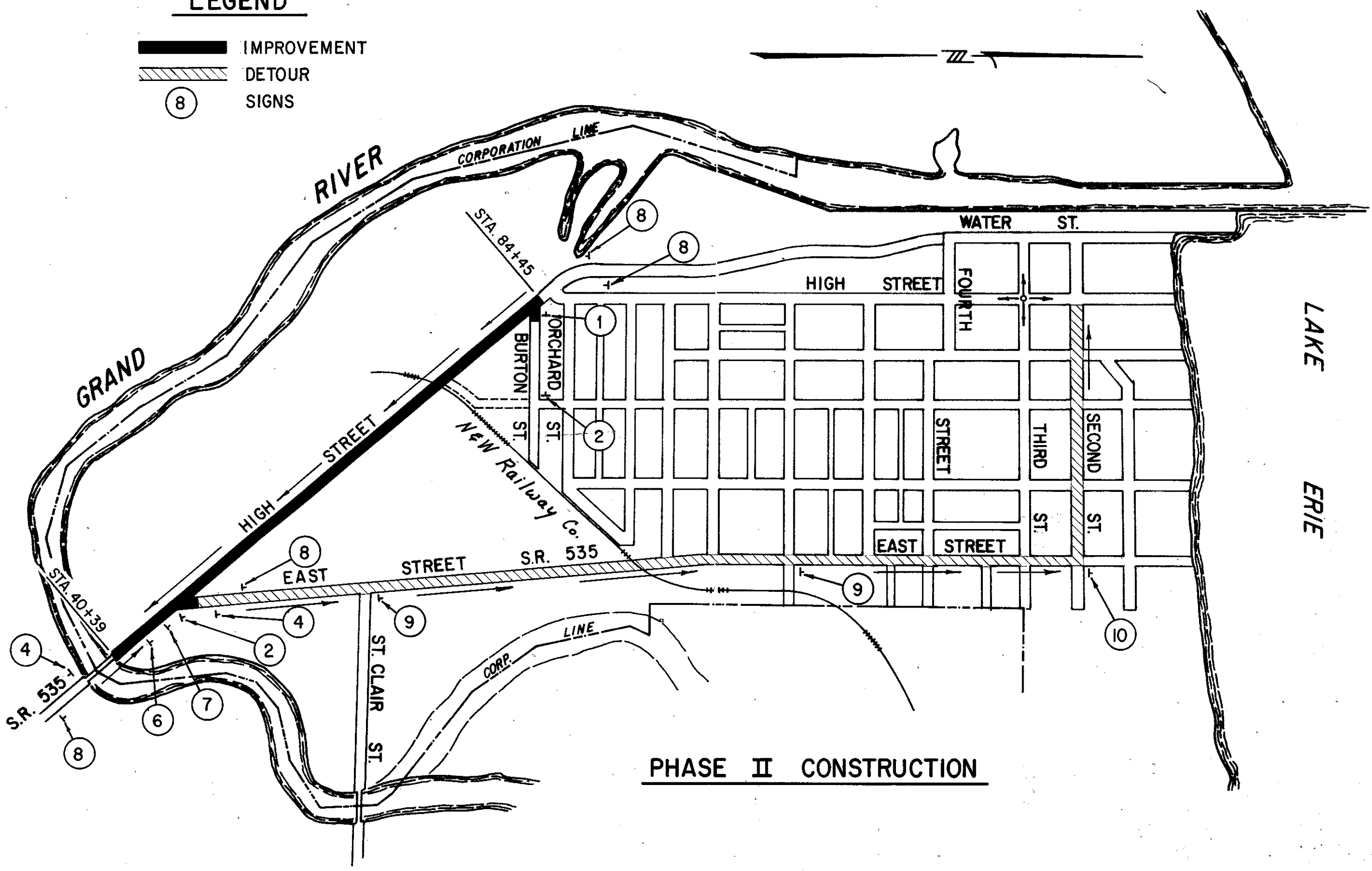
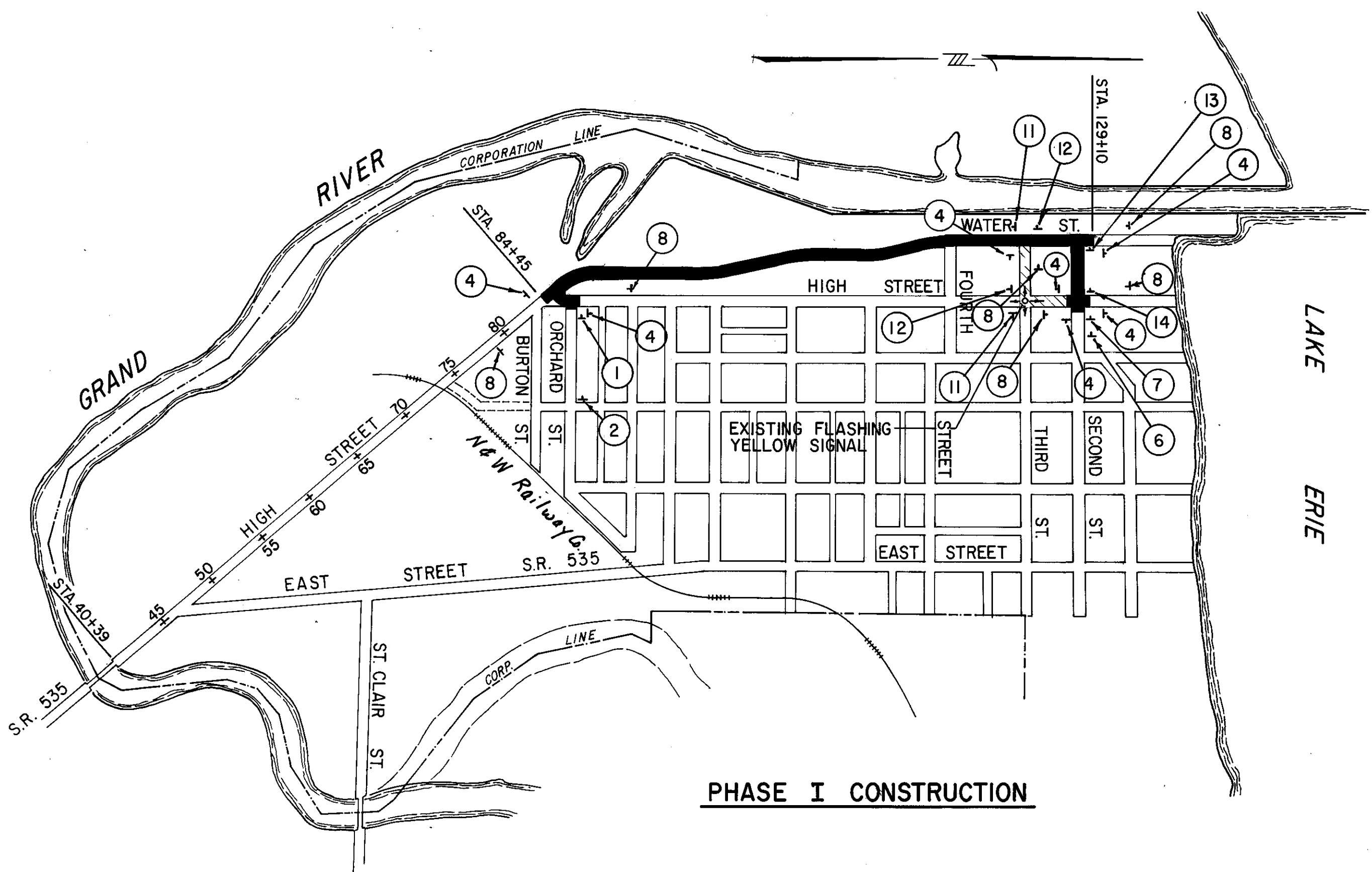

SIGN LEGEND

1 R-75 MOUNTED ON TYPE III PORTABLE BARRICADE
2 R-75 & OC-14-R MOUNTED ON TYPE III PORTABLE BARRICADE
3 END CONSTRUCTION
4 OC-8 MOUNTED ON DRIVE POSTS
5 R-76 C MOUNTED ON TYPE III BARRICADE
6 OW-120
7 OW-127
8 OW-128
9 D-14 & OC-29
10 D-14 & OC-29-L
11 D-14 & OC-29-L
12 D-14 & OC-29-R
13 R-76C & OC-14-R MOUNTED ON TYPE III BARRICADE
14 R-76C & OC-14-L MOUNTED ON TYPE III BARRICADE

HIGH STREET / WATER STREET