

LAKE COUNTY  
 S.H. 520 SEC. PAINESVILLE (PT.)  
 S.H. 744 SEC. PAINESVILLE (PT.)  
 & FAIRPORT (PT.)

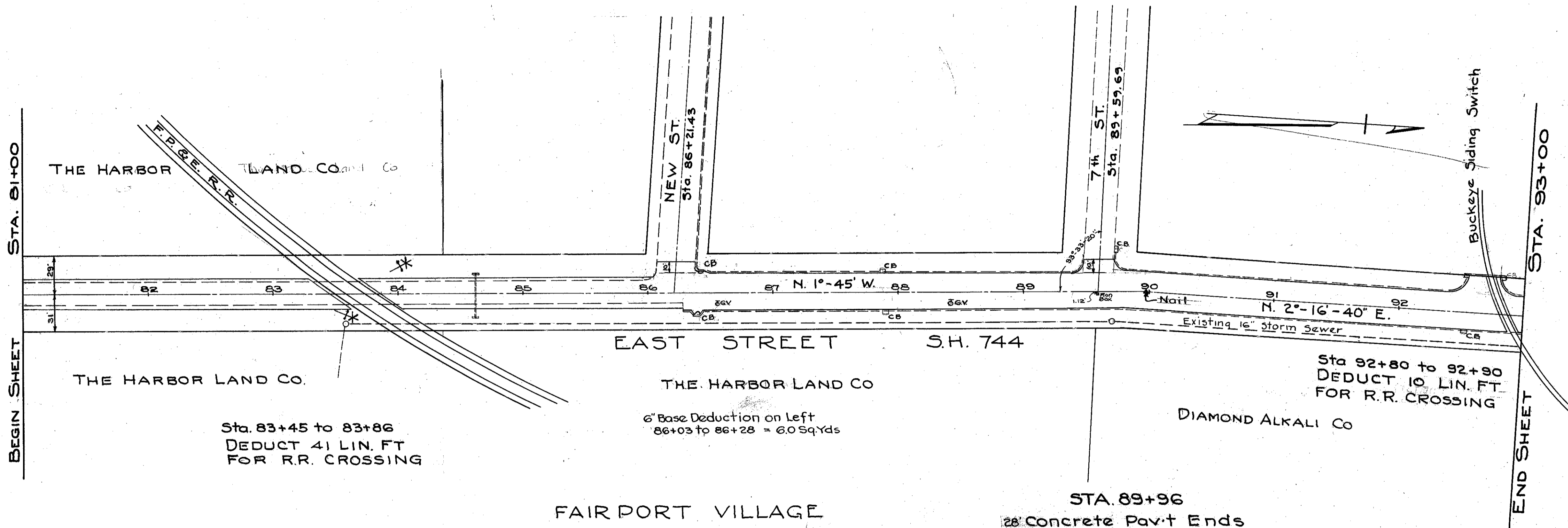

Sta.	Street	Side	Sq. Yds
86+21	New	Lt	40
89+59	7th	Lt	44
92+65	B.S. Switch	Lt	26

Station	Side	Distance	M.H.	C.B.	Man Box
86+39	Rt.	16.5'		1	
86+43	Lt.	17.5'		1	
87+08	Lt.	16'		1	
87+90	Rt.	14'		1	
89+60	Rt.	1.12'			1
92+53	Rt.	13.5'		1	
Total				5	1

Station to	Station	Side	Lin. Ft.
81+00	83+30	Lt.	230
83+71	86+05	Lt.	234
81+00	83+60	Rt.	260
84+01	86+30	Rt.	229
Total			953

Sta. 83+45 to 83+86  
 DEDUCT 41 LIN. FT.  
 FOR R.R. CROSSING

6" Base Deduction on Left  
 86+03 to 86+28 = 6.0 Sq. Yds

Sta 92+80 to 92+90  
 DEDUCT 10 LIN. FT.  
 FOR R.R. CROSSING

STA. 89+96  
 28 Concrete Pav't Ends  
 29.5 Brick Pav't Begins  
 (Existing)

Δ at Sta. 89+98.29  
 Def = 4°-01'-40" Rt

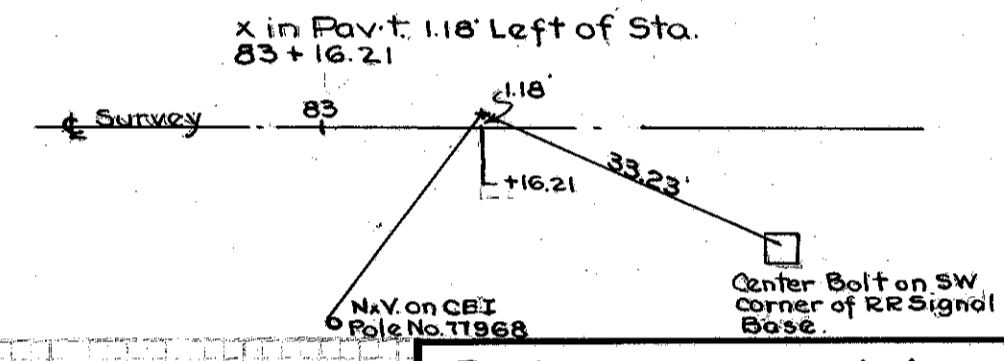

B.M. No. 22 N.W. Cor. E Signal Tower  
 Elev. 609.739

B.M. No. 23 Drill Hole S. End Island at  
 Gulf Filling Station at 7th St.  
 Elev. 611.825

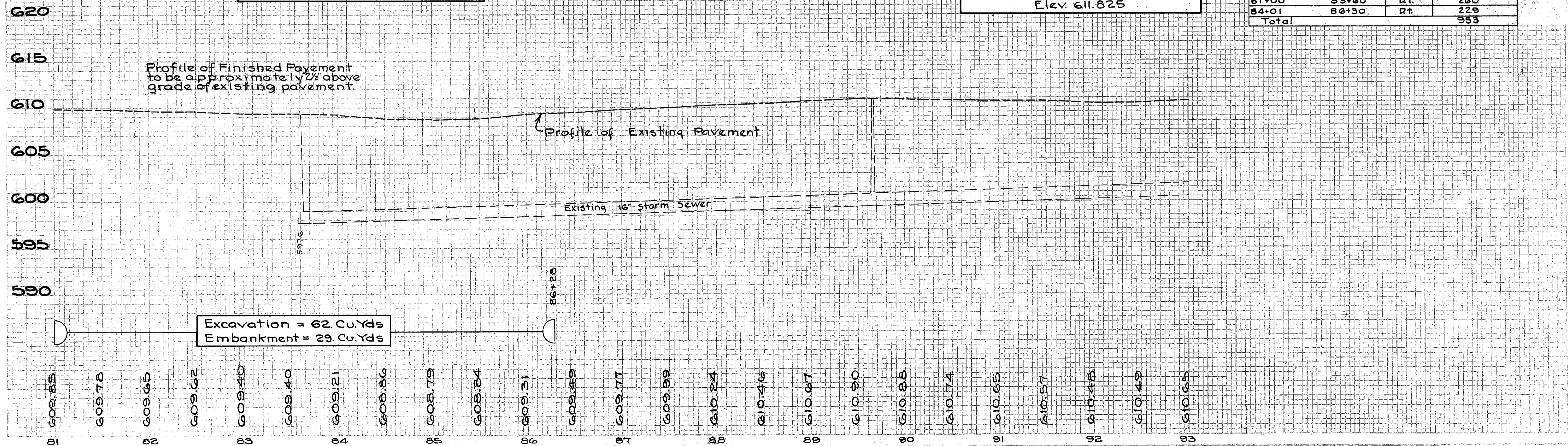

PLAN & PROFILE STA. 81+00 TO STA. 93+00