

FED. RD. DIV. NO.	STATE	PROJECT	FISCAL YEAR
2	OHIO	H.I.F.	1948

3
5

LAKE COUNTY
SEC. LAK-528-6.04
3/4 Mi. N. of Madison

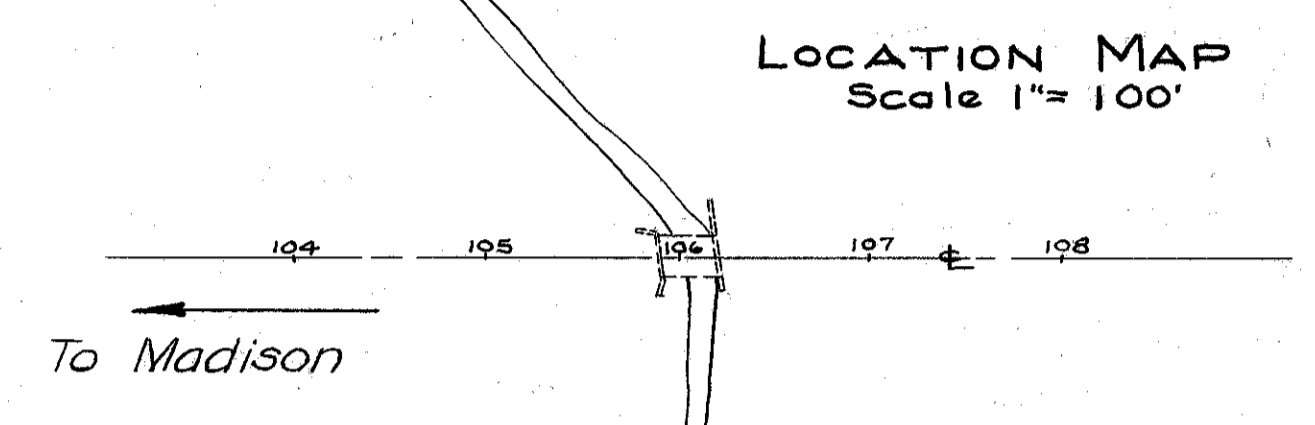
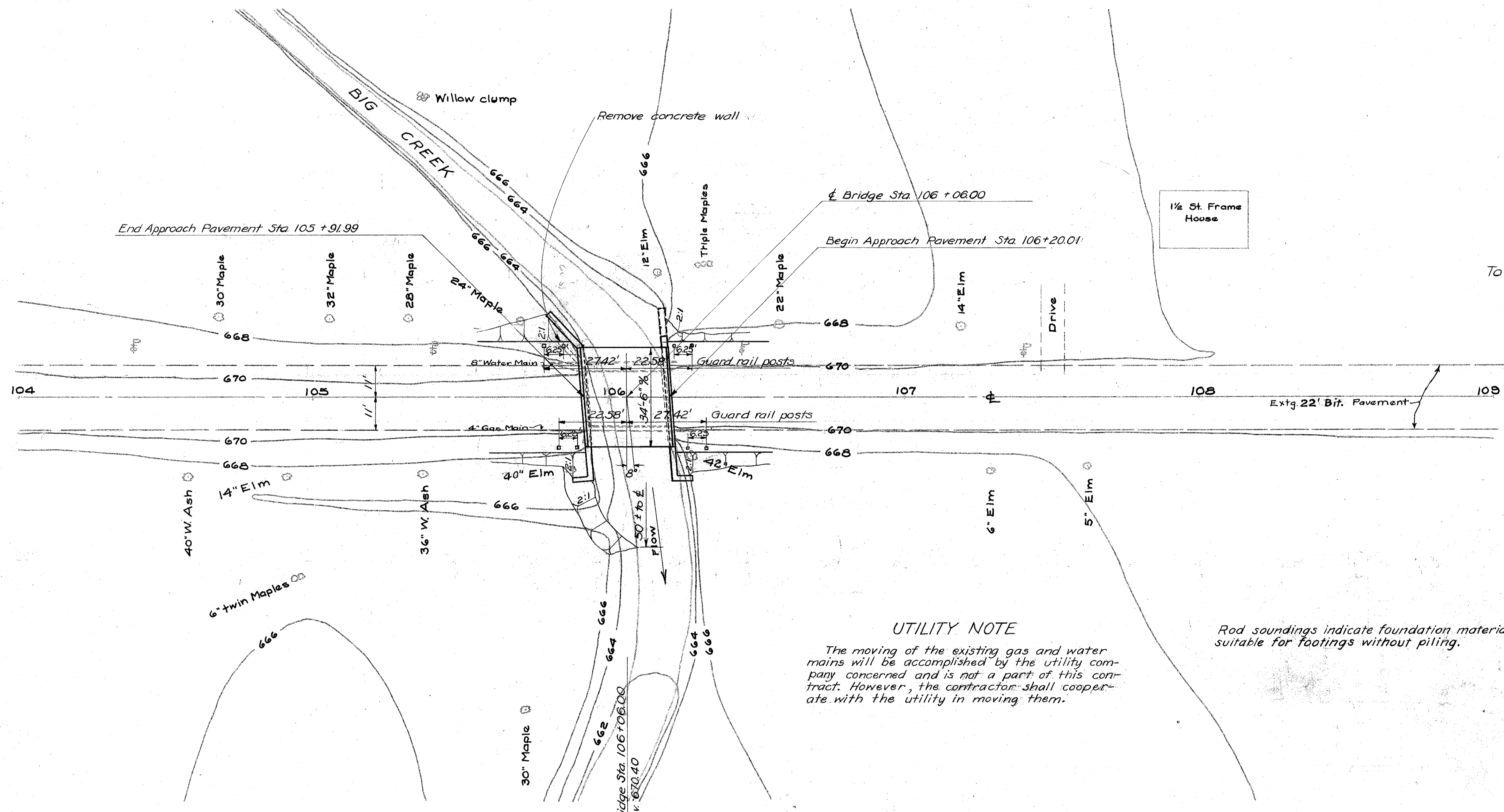

PROPOSED STRUCTURE
 Type: Concrete slab superstructure on existing stone masonry abutments capped and extended with concrete.
 Span: 26' Clear
 Roadway: 34' ff of guard rail posts
 Loading: S-15-46
 Skew: 8° R.F.
 Surf Course: 2 1/2 Bituminous
 Alignment: Tangent
 Std. Dwg: SB-1-47

UTILITY NOTE
 The moving of the existing gas and water mains will be accomplished by the utility company concerned and is not a part of this contract. However, the contractor shall cooperate with the utility in moving them.

Rod soundings indicate foundation material suitable for footings without piling.

EXISTING BRIDGE DATA
 TYPE: Conc. slab on steel I beams
 SPAN: 25'6" on E
 ROADWAY: 19'6"
 SKEW: 8° R.F.
 CONDITION: (Superstructure, Fair)
 DATE BUILT: 1900 (Substructure, Good)
 (Superstructure to be removed)

Drainage Area = 10.6 Sq. Mi.

STATE OF OHIO
 DEPARTMENT OF HIGHWAYS
 BUREAU OF BRIDGES
SITE PLAN
 BRIDGE No. LA-528-69
 OVER BIG CREEK
 LAKE COUNTY S.H. 327
 SEC. F STA. 106+06.00
 Scale 1" = 20'

Present Topography		Proposed Work			
Surveyed	Drawn	Designed	Drawn	Checked	Reviewed
J.P.	MBR.	C.W.A.	C.W.A.	C.F.B.	J.P.