

LAKE COUNTY
LA-528-6.04

EARTHWORK - (BUILDING BERMS)
EMBANKMENT= 115 CU.YDS. +22% = 140 CU.YDS.
BORROW = 140

TREE REMOVAL:-
STA. 105+87 = 25' EAST = 1 - 40" ELM
STA. 106+28 = 20.5' EAST = 1 - 42" ELM

GUARD RAIL:-

LOCATION	FROM	TO	LIN. FT.
WEST SIDE	STA. 105+78.58	STA. 105+89.60	11.02
"	" 106+17.60	" 106+28.58	10.98
EAST SIDE	STA. 105+83.42	STA. 105+94.38	10.96
"	" 106+22.38	" 106+33.42	11.04
TOTAL			44.00

APPROACH PAVEMENT:-
I-35 ASPHALTIC CONC. SURFACE COURSE-
 BEGIN PAVMT. STA. 105+26.99 END PAVMT. 105+91.99 = 64.99 LIN. FT.
 BEGIN PAVMT. STA. 106+20.01 END PAVMT. 106+25.01 = 5.00 LIN. FT.
 TOTAL LENGTH OF PAVEMENT 70.00 LIN. FT.
 AREA OF PAVMT. = (10' x 70.00) = 700.00 SQ. YDS.
 TOTAL QUANTITY = 1 1/2" T-35 (24.44 x 1.25) = 36.00 CU. YDS.
B-35 ASPHALTIC CONC. LEVELING COURSE
 TOTAL QUANTITY (SEE CALC. T-35) 0.85 CU. YDS.
B-35 ASPHALTIC CONC. BASE COURSE
 TOTAL LENGTH OF PAVMT. (SEE CALC. T-35) = 10.00 LIN. FT.
 AREA UPPER 3" COURSE = (10' x 22.50) = 225.00 SQ. YDS.
 TOTAL QUANTITY UPPER 3" COURSE = (25' x 3") = 36.00 CU. YDS.
 AREA LOWER 3" COURSE = (10' x 25') = 250.00 SQ. YDS.
 TOTAL QUANTITY LOWER 3" COURSE = (25.55' x 3") = 239.96 CU. YDS.
 TOTAL UPPER AND LOWER COURSES 4.21 CU. YDS.

L-9 SEEDING AND PROTECTING TYPE "A"
 TOTAL NET AREA L-9 SEEDING 2825 SQ. FT. @ 9" = 314 SQ. YDS.
L-9 COMMERCIAL FERTILIZER (10-6-4)
 TOTAL QUANTITY 2825 SQ. FT. @ 20% 1000 SQ. FT. = 56.5' x 2000 = 0.03 TONS
L-9 AGRICULTURAL HYDRATED LIME
 TOTAL QUANTITY 2825 SQ. FT. @ 20% 1000 SQ. FT. = 141.25' x 2000 = 0.07 TONS.
E-11 WATER
 140 CUBIC YARDS EMBKMT x 5.700 GAL. USE 1 M. GAL.
I-19 INSULATION COURSE
 Same as B-35 Lower Base Course - 2555 S.Y.

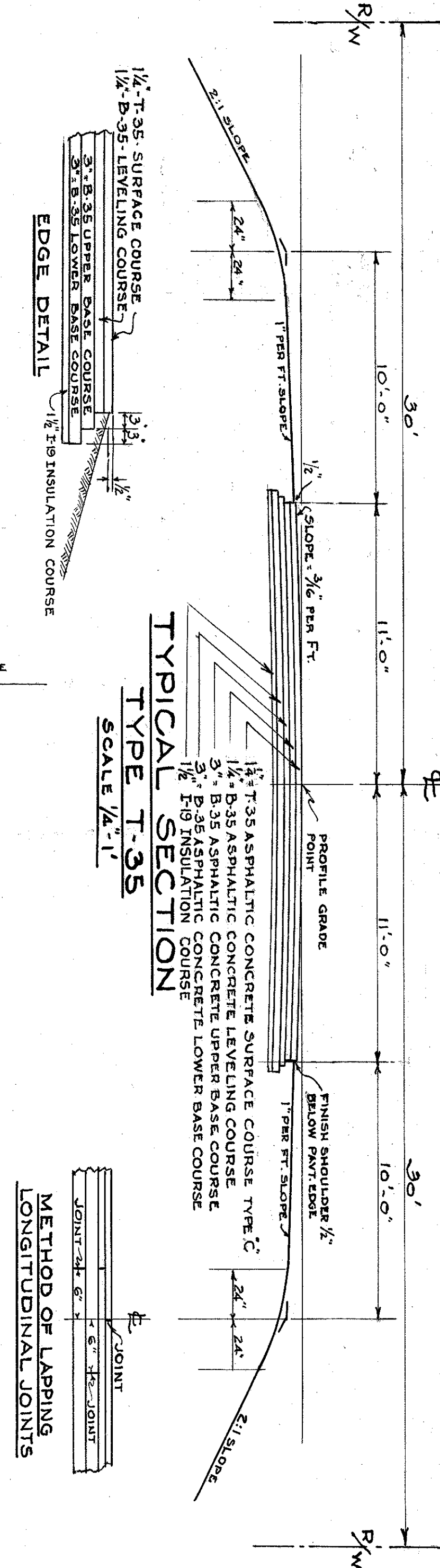
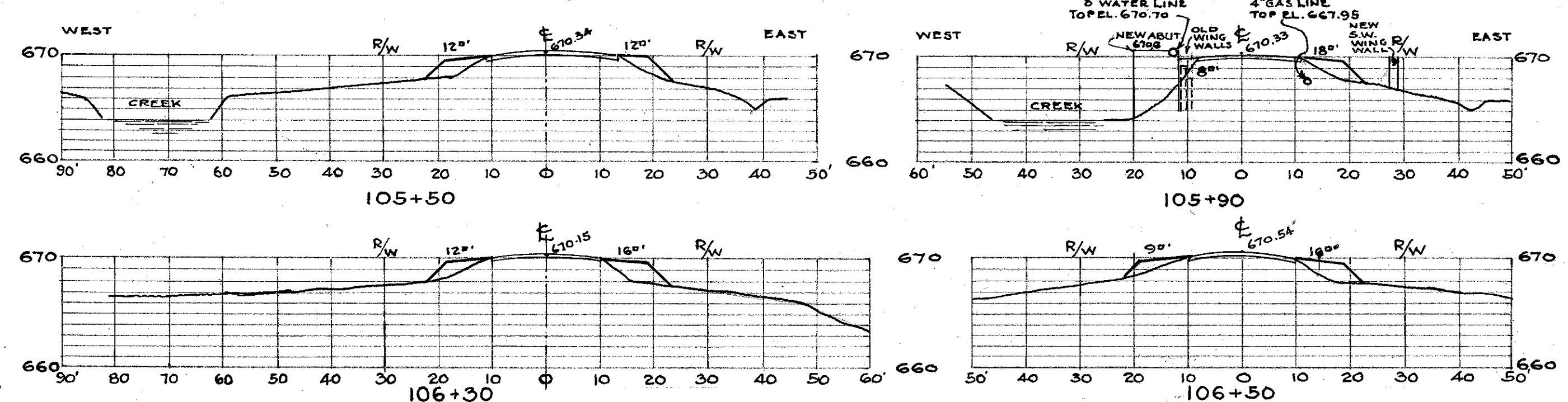

GENERAL SUMMARY

ESTIMATED QUANTITIES

ITEM	TOTAL	UNIT	DESCRIPTION
E-4	140	CU.YDS	BORROW
E-9	2	EACH	REMOVAL OF TREES & STUMPS
I-15	44	LIN. FT.	GUARD RAIL STEEL BEAM TYPE (DEEP)
T-35	1	CU.YDS	ASPHALTIC CONCRETE SURFACE COURSE, TYPE "C" (70-80 or 85-100)
B-35	1	CU.YDS	ASPHALTIC CONCRETE LEVELING COURSE
B-35	5	CU.YDS	ASPHALTIC CONCRETE BASE COURSE
L-9	314	SQ.YDS	SEEDING AND PROTECTING-TYPE "A" AS PER PLAN
L-9	0.03	TONS	COMMERCIAL FERTILIZER (10-6-4)
L-9	0.07	TONS	AGRICULTURAL HYDRATED LIME
E-11	1	M. GALS.	WATER
I-19	26	SQ.YDS.	1 1/2" INSULATION COURSE

ITEM L-9 SEEDING AND PROTECTING ROADWAY AREAS-TYPE "C":
 ALL SEEDING AREAS SHALL BE PERFORMED IN ACCORDANCE WITH THE TYPICAL SECTIONS. USE THE FOLLOWING GRASS SEED MIXTURES-
 50% KENTUCKY BLUE GRASS
 15% PERENNIAL RYE GRASS
 20% ALSIKE CLOVER
 15% HAIRY VETCH
ITEM L-9 COMMERCIAL FERTILIZER (10-6-4):
 FERTILIZER SHALL BE APPLIED AT THE RATE OF 20 POUNDS PER 1000 SQ. FT.
ITEM L-9 AGRICULTURAL HYDRATED LIME:
 AGRICULTURAL HYDRATED LIME SHALL BE APPLIED AT THE RATE OF 50 POUNDS PER 1000 SQ. FT.
NOTE:
 CHANNEL EXCAVATION OF SUITABLE MATERIAL SHALL BE USED IN LIEU OF BORROW. COST SHALL BE INCLUDED IN UNIT PRICE BID PER CUBIC YARD OF E-3 CHANNEL EXCAVATION.

L-9 SEEDING AND PROTECTING ROADWAY AREAS:
 QUANTITIES FOR SEEDING ITEM L-9 ARE CALCULATED FOR THE SOIL AREAS BETWEEN LINES TEN FEET (10') OUTSIDE THE WORK LIMITS AS SHOWN ON THE CROSS SECTIONS OR TO THE R/W LINE IF SUCH LINE IS LESS THAN TEN FEET FROM THE WORK LIMITS. ALL AREAS OUTSIDE THESE LIMITS WHERE THE VEGETATIVE GROWTH HAS BEEN INJURIOUSLY DISTURBED OR DESTROYED BY CONTRACTOR SHALL BE RESTORED AND SEEDING IN ACCORDANCE WITH THE PROVISIONS OF ITEM L-9 BY THE CONTRACTOR AT HIS OWN EXPENSE.

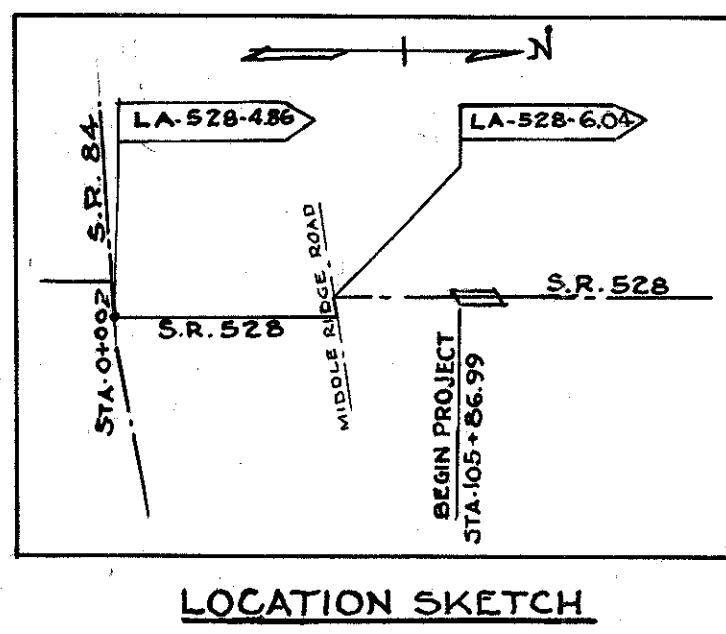

CHANNEL SECTIONS
 LOOKING WEST
 SCALE: VERTICAL 1/2"=10 FT.

