

760
755
750
745
760
755
750
745
755
750
745
740
760
755
750
745

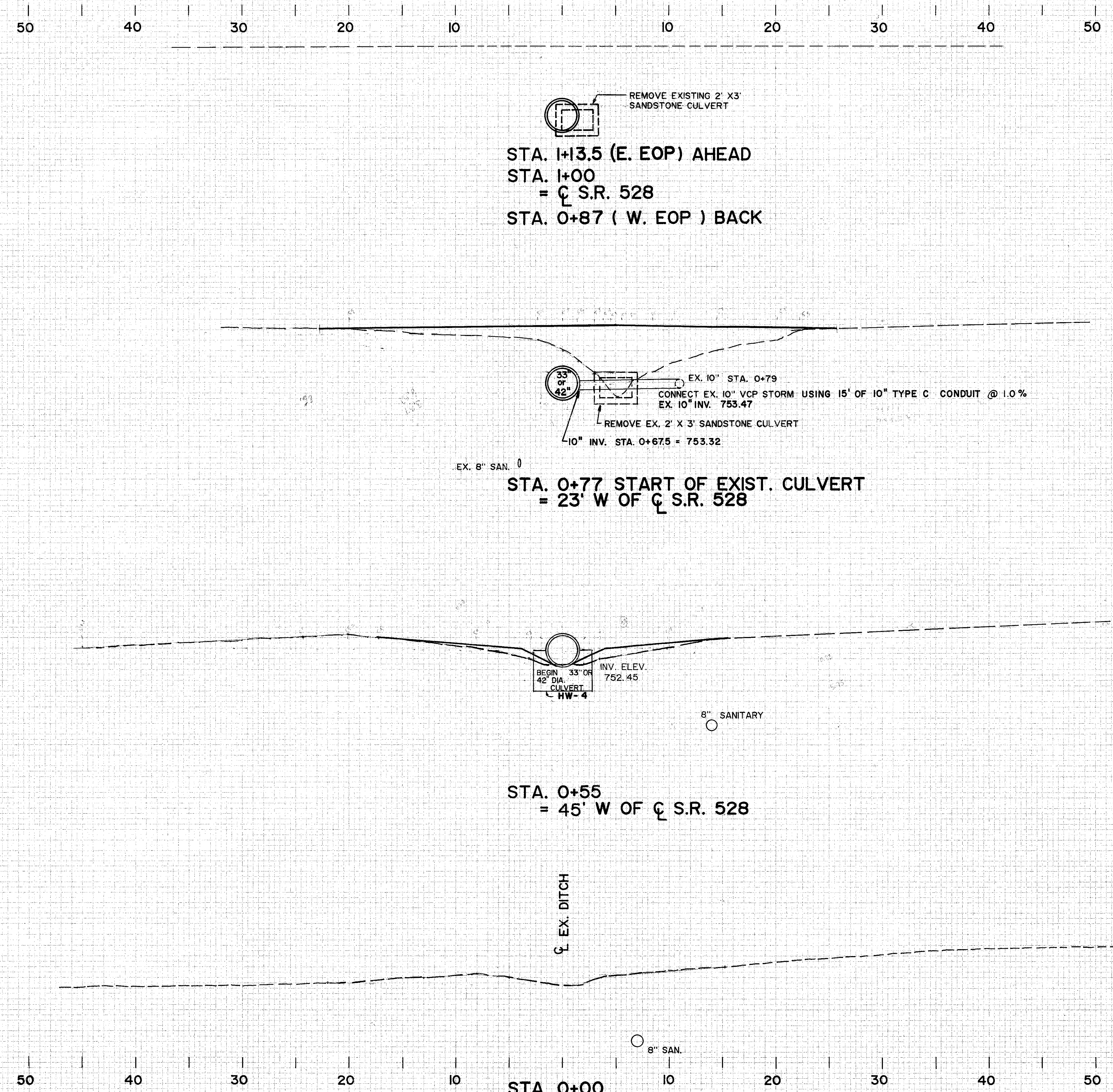

760
755
750
745
760
755
750
745
755
750
745
740
760
755
750
745

END	AREA		VOLUME	
	CUT	FILL	CUT	FILL
755				
750	0	0		
745			0	18
760	0	97		
755				
750				
745			0	45.6
755	0	15		
750				
745				
740			0	15.3
760	0	0		
755				
750				
745				

STA. 0+00
= 100' W OF CL S.R. 528

CULVERT CROSS SECTIONS