

B.M. #9 - R.R. SPIKE IN POLE (No. NUMBER)
 STA. 311+82 (181' L. of P). ADJ. ELEV. = 636.782

B.M. #10 - R.R. SPIKE SET IN 12" OAK, STA. 322+91
 (R/W BASELINE) 85' L. of P. ADJ. ELEV. = 633.011

PG. NO.	DATE	PERIOD
2	OHIO	

82
204

LAKE COUNTY
 LAK-44-3.79

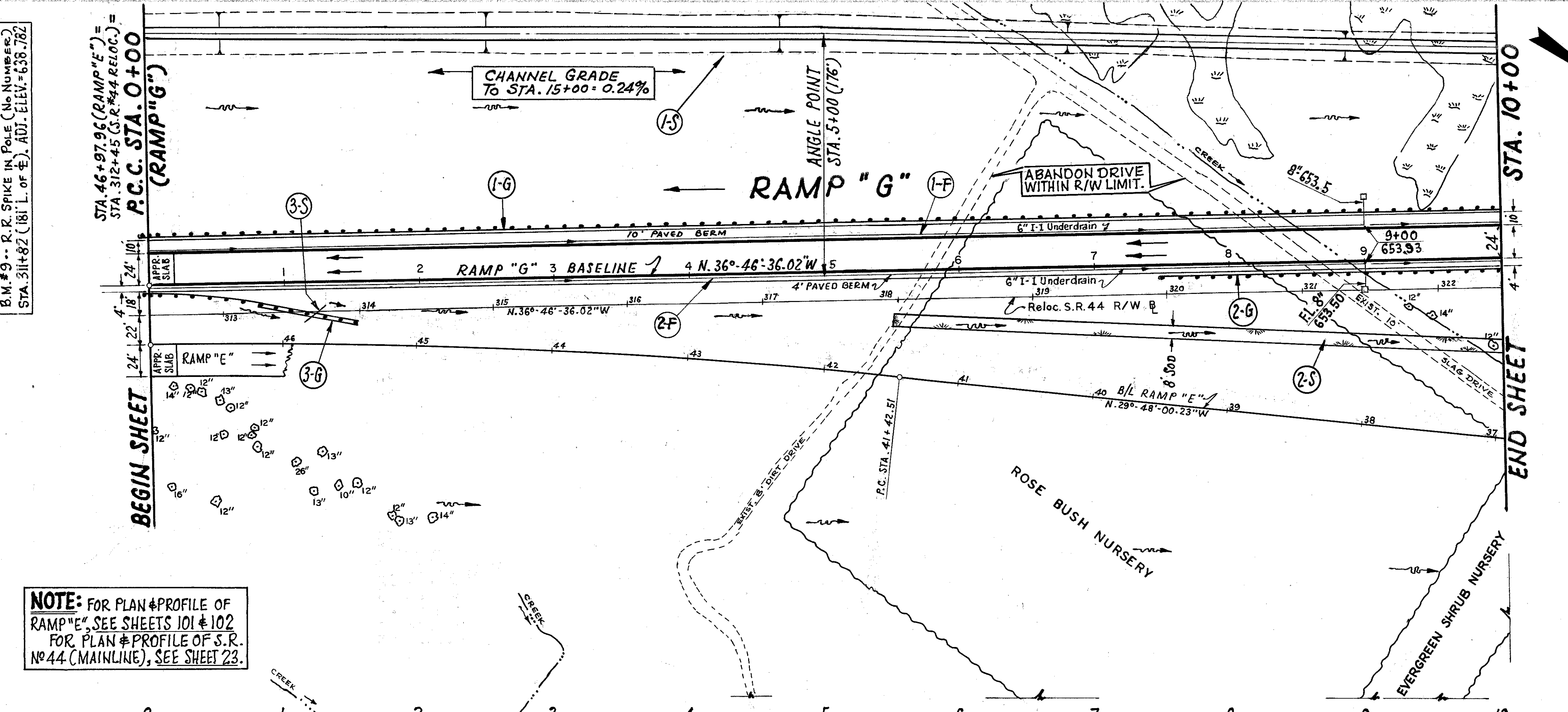

NOTE: FOR PLAN & PROFILE OF RAMP "E", SEE SHEETS 101 & 102 FOR PLAN & PROFILE OF S.R. NO. 44 (MAINLINE), SEE SHEET 23.

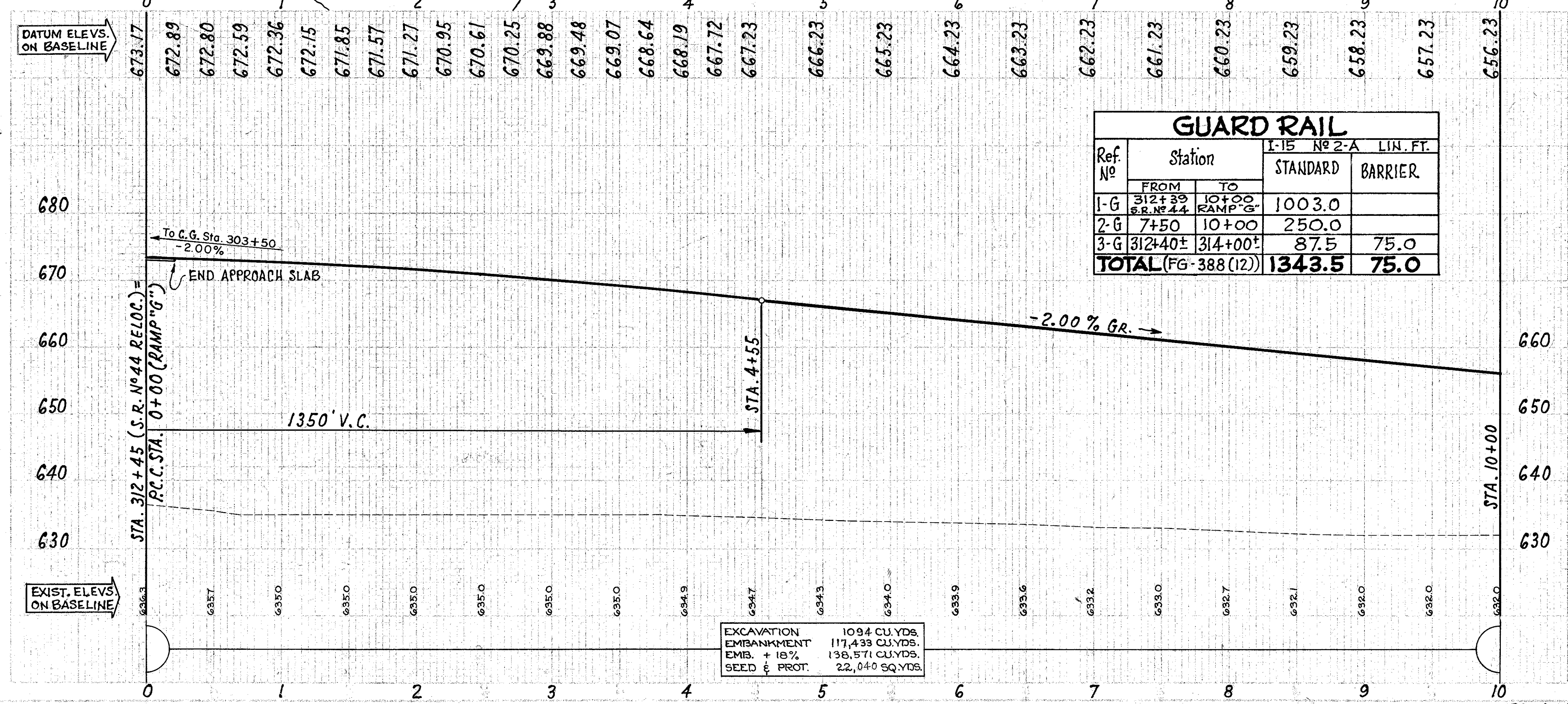

GUARD RAIL				
Ref. No.	Station		I-15 No. 2-A LIN. FT.	
	FROM	TO	STANDARD	BARRIER
1-G	312+39 S.R. No. 44	10+00 RAMP "G"	1003.0	
2-G	7+50	10+00	250.0	
3-G	312+40±	314+00±	87.5	75.0
TOTAL (FG-388(12))			1343.5	75.0

DRAINAGE					
Ref. No.	Station		E-3 CU. YDS.	L-10 SQ. YDS.	I-1 LIN. FT.
	FROM	TO	CHANNEL EXCAVATION	SODDING	8" PIPE CLASS F-1
1-S	0+00	10+00	3187		
2-S	5+50	10+00		400	
3-S	1+14±	1+31±			20
TOTAL (FG-388(12))			3187	400	20

UNDERDRAINS					
Ref. No.	Station		ITEM I-1 LIN. FT.		I-5 EACH 3-29 CU. YDS.
	FROM	TO	6" CLASS I-3 SHALLOW	8" OUTLET Class F-1 Sec. M-4(A) 90° BEND	
1-F	0+00	10+00	1008	10	0.3
2-F	0+00	10+00	1008	10	0.3
TOTAL (FG-388(12))			2016	20	0.6

PLAN & PROFILE - RAMP "G" - P.C.C. STA. 0+00 to STA. 10+00