

LAKE COUNTY  
SEC. LAK-44-379

NOTE: FOR STRUCTURE PLANS (LAK. 44-0483)  
SEE SHEETS 154 & 169.  
FOR TEMPORARY RAILROAD FORCE ACCOUNT WORK  
SEE SHEETS 151 & 153

MICROFILMED  
DEC 15 1987

S.R. No 44 RELOC.  
CURVE DATA  
Dc = 1°-28'-00"  
R = 3906.53'  
Δ = 22°-02'-03.43"  
T = 760.57'  
L = 1502.34'  
Ch = 1493.10'  
N. 36°-55'-03.72"W  
EXT. = 73.35'

B.M. #5 - R.R. SPIKE SET IN POLE. (No NUMBER)  
STA. 272+90, 145' W. OF E. ELEV. = 680.443

NOTE:  
JUTE MATTING  
L=150'

S.R. No 44 RELOCATION

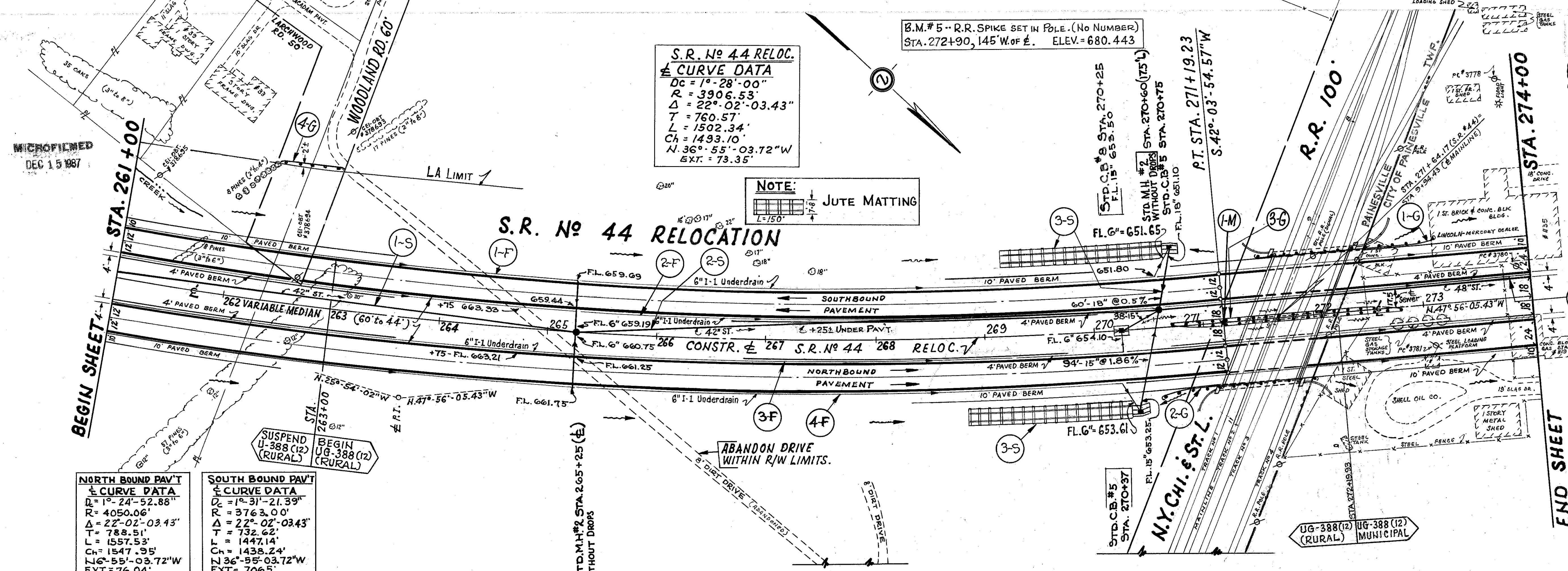

NORTH BOUND PAVT  
CURVE DATA  
Dc = 1°-24'-52.88"  
R = 4050.06'  
Δ = 22°-02'-03.43"  
T = 788.51'  
L = 1557.53'  
Ch = 1547.35'  
N. 36°-55'-03.72"W  
EXT. = 76.04'

SOUTH BOUND PAVT  
CURVE DATA  
Dc = 1°-31'-21.39"  
R = 3763.00'  
Δ = 22°-02'-03.43"  
T = 732.62'  
L = 1447.14'  
Ch = 1438.24'  
N. 36°-55'-03.72"W  
EXT. = 70.65'

Station	261	262	263	264	265	266	267	268	269	270	271	272	273	274									
DATUM ELEV. = INSIDE EDGE OF PAVT.	673.88	673.04	672.20	671.36	670.52	669.68	668.84	668.00	667.16	666.32	665.48	664.64	663.80	662.96	662.12	661.28	660.44	659.60	658.76	657.92	657.08	656.24	655.40

**GUARD RAIL**

Ref. No	Station	ITEM I-15 LIN. FT.		
		STANDARD No 2-A	RURAL	MUNICIPAL
1-G	271+55±	273+17.5±	100.0	62.5
2-G	270+38±	272+00±	162.5	
4-G	WOODLAND ROAD			50
3-G	270+70±	272+80±	307.0	118.0
<b>TOTAL (UG-388(12))</b>		<b>569.5</b>		
<b>TOTAL (UG-388(12) MUNICIPAL)</b>		<b>180.5</b>		
<b>TOTAL (RURAL)</b>		<b>50</b>		

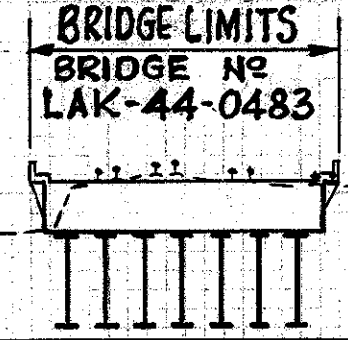

**UNDERDRAINS**

Ref. No	Station	ITEM I-1 LIN. FT.						ITEM I-5 EACH				
		6" UNDERDRAIN CLASS I-3 (DEEP)		6" UNDERDRAIN CLASS I-3 (SHALLOW)		CLASS F-1	6" CLASS A-1	6"	6"	6"		
		RURAL	MUNICIPAL	RURAL	MUNICIPAL						90° BEND	60° BEND
1-F	261+00	274+00	200	955	155							
2-F	261+00	274+00				200	912	170				
3-F	261+00	274+00				200	920	190				
4-F	261+00	274+00	200	930	203							
<b>TOTAL (UG-388(12))</b>		<b>1885</b>		<b>1832</b>		<b>60</b>	<b>78</b>	<b>3</b>	<b>2</b>	<b>2</b>		
<b>TOTAL (UG-388(12) MUNICIPAL)</b>		<b>358</b>		<b>360</b>								
<b>TOTAL (UG-388(12) RURAL)</b>		<b>400</b>		<b>400</b>								

**I-8 MONUMENTS**

Ref. No	Station	REFERENCE MONUMENTS
1-M	271+19.23	1
<b>TOTAL (UG-388(12) RURAL)</b>		<b>1</b>

EXCAVATION 28,781 CU. YDS.  
EMBANKMENT 57 CU. YDS.  
EMB. + 18% 67 CU. YDS.  
SEED & PROT. 4,934 SQ. YDS.

EXCAVATION 78,466 CU. YDS.  
EMBANKMENT 0 CU. YDS.  
EMB. + 18% 0 CU. YDS.  
SEED & PROT. 11,778 SQ. YDS.

EXCAVATION 29,548 CU. YDS.  
EMBANKMENT 0 CU. YDS.  
EMB. + 18% 0 CU. YDS.  
SEED & PROT. 2,908 SQ. YDS.

**DRAINAGE**

Ref. No	Station	ITEM I-1 LIN. FT.		ITEM I-8 EACH	
		42" CLASS A-1 (18 Class A-1 Sec. M-6.6(a) or M-6.8(b))	42" CLASS A-1 (18 Class A-1 Sec. M-6.6(a) or M-6.8(b))	STANDARD MANHOLE No 2 (WITHOUT DROPS)	STANDARD CATCH BASIN No 5
1-S	261+00	265+25	274+00	170	170
2-S	265+25	274+00	270+75	2	2
3-S	268+80	270+75	270+75	2	2
<b>TOTAL (UG-388(12) RURAL)</b>		<b>94</b>	<b>60</b>	<b>534</b>	<b>222</b>
<b>TOTAL (UG-388(12) MUNICIPAL)</b>		<b>170</b>	<b>170</b>		
<b>TOTAL (UG-388(12) RURAL)</b>		<b>200</b>	<b>200</b>		