

6-14
MICROFILMED
DEC 15 1987

STATE OF OHIO DEPARTMENT OF HIGHWAYS

LAK-44-379

CITY OF PAINESVILLE
CONCORD & PAINESVILLE TOWNSHIPS
LAKE COUNTY

GRADE SEPARATIONS WITH THE N.Y.C. R.R. CO. & THE N.Y.C. & ST. L. R.R. CO.

LIMITED ACCESS
THIS IMPROVEMENT IS ESPECIALLY
DESIGNED FOR THROUGH TRAFFIC AND HAS
BEEN DECLARED A LIMITED ACCESS HIGH-
WAY OR FREEWAY BY ACTION OF THE
DIRECTOR OF HIGHWAYS IN ACCORDANCE
WITH THE PROVISIONS OF SECTION 5511.02
OF THE REVISED CODE OF OHIO.

FED. RD. DIVISION	STATE	PROJECT
2	OHIO	

1
204

LAKE COUNTY
LAK-44-3.79

U-UG-F-FG-388 (12)

APR 12 1965
GROUND PHOTO LAB

CONVENTIONAL SIGNS

COUNTY LINE
CORPORATION LINE
CENTER LINE
RAILROAD
GUARD RAIL
LIMITED ACCESS R/W
LIMITED ACCESS ONLY
R/W ONLY
EXISTING R/W
POLE LINES
FENCE LINE

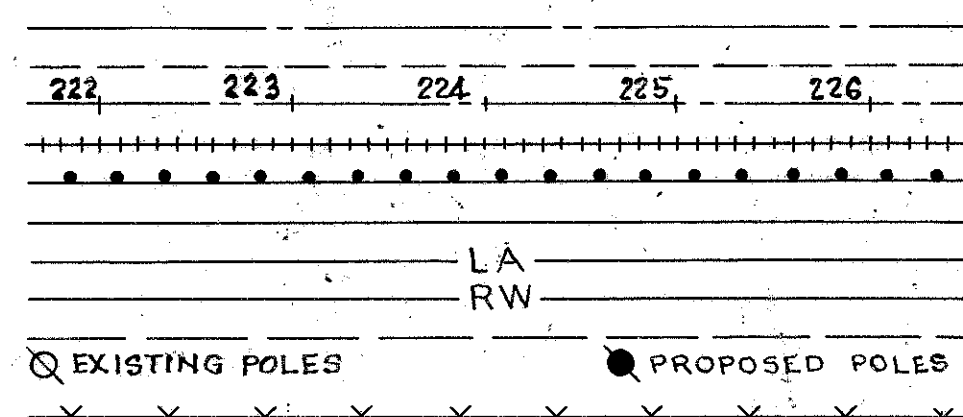

INDEX OF SHEETS

TITLE SHEET	1	RAMP 1 & 2	
LOCATION PLAN	2	GRADING PLAN	124
TYPICAL SECTIONS	3-6	PLAN & PROFILE	125-126
GENERAL NOTES	7-8	SUPERELEVATION TABLES	127
SUMMARY OF QUANTITIES	9	EXTRA AREA DETAILS	128-129
CALCULATIONS	10, 11, 11-A		
GENERAL SUMMARY	12, 13, 13-A, 14, 14-A, 15		
S.P. 44			
PLAN & PROFILE	16-23		
SUPERELEVATION TABLES	24		
CROSS SECTIONS	25-81		
RAMP "G" & RAMP "F"			
PLAN & PROFILE	82-84		
CROSS SECTIONS	85-100		
RAMP "E"			
PLAN & PROFILE	101-102		
CROSS SECTIONS	103-113		
RAMP "A" & "B" ANDERSON LANE			
GRADING PLAN	114		
PLAN & PROFILE	115-117		
EXTRA AREA DETAILS	118-119		
CROSS SECTIONS	120-123		
		RAILROAD FORCE ACCOUNT WORK	151-153
		BRIDGE PLANS	154-169, 169-A, 170-192
		RIGHT OF WAY	193-204

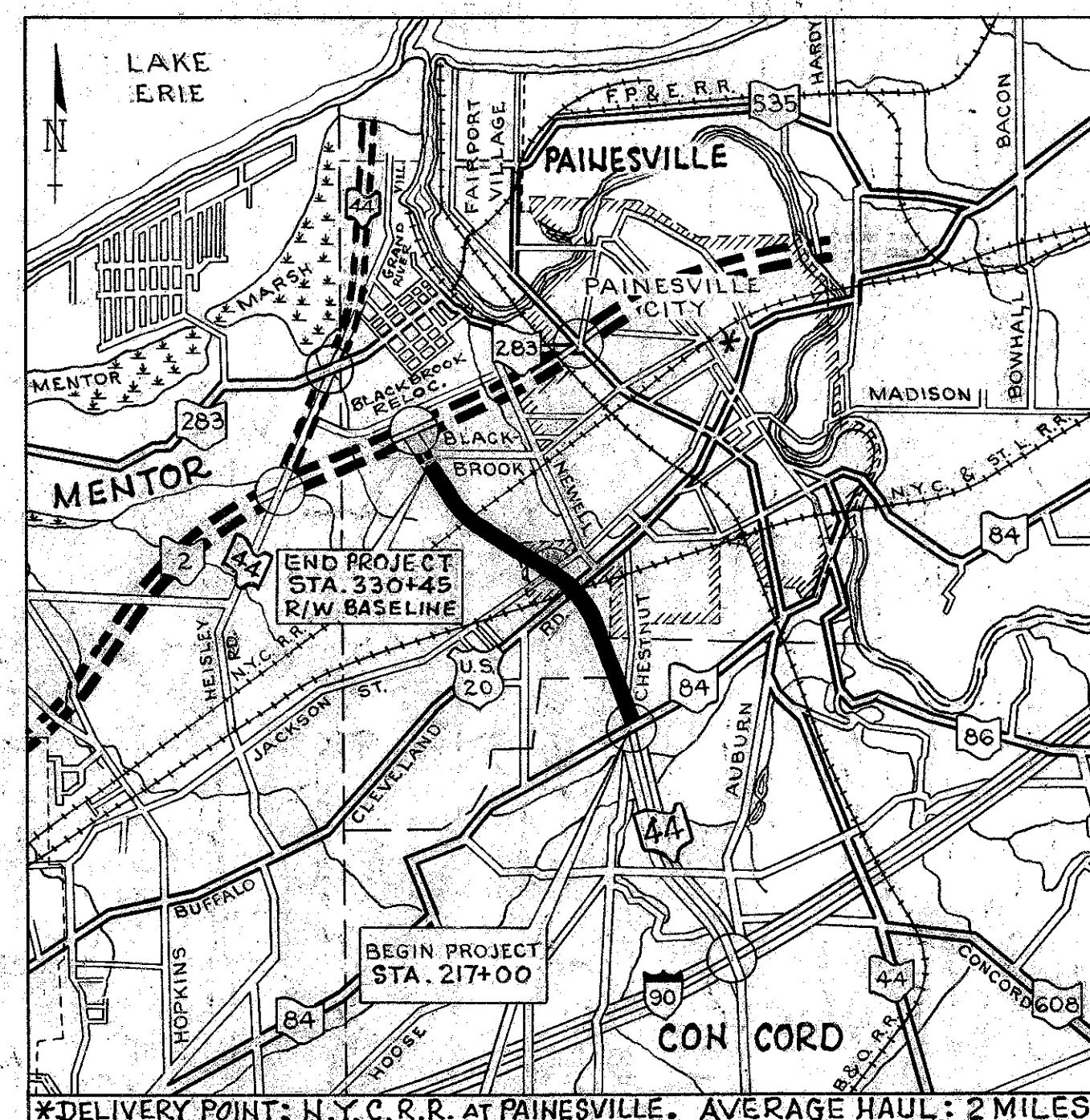

LOCATION MAP

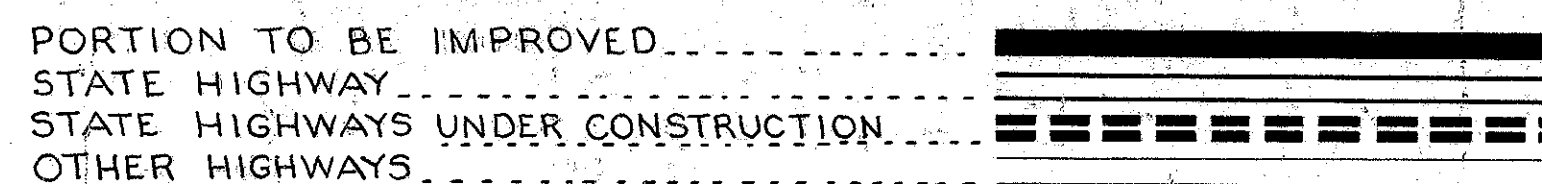

SCALES

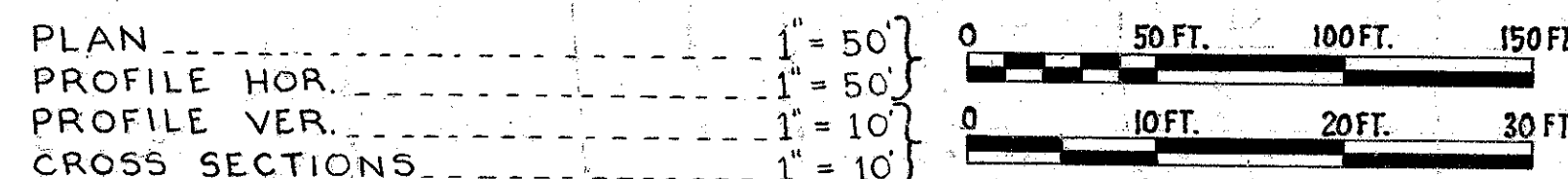

LINE DATA								
PROJECT NO.		BEGIN STA.	SUSPEND STA.	RESUME STA.	END STA.	LENGTH LIN. FT.	LENGTH LIN. FT.	LENGTH MILES
U-388(12)		217+00			263+00	4,600.00	6,050.00	1.145
UG-388(12)	U-388(12)	281+50			296+00	1,450.00		
		263+00			272+19.93	919.93	2,797.27	0.529
	UG-388(12)	272+19.93	281+50	296+00	305+47.27	1,877.34		
FG-388(12)		305+47.27			326+45	2,097.73	2,097.73	0.397
F-388(12)		326+45			330+45	400.00	400.00	0.075
TOTAL LENGTH OF PROJECT						11,345.00	11,345.00	2.148
APPROACHES:								
"U" STA. 216+62 TO STA. 217+00 (MAIN LINE)						38.00	38.00	.007
"UG" STA. 6+21.68 TO STA. 13+30 (MENTOR AVE)						708.32	708.32	0.134
"F" STA. 18+00 TO STA. 19+81.87 (RAMP "G")						181.87	181.87	0.034
"F" STA. 12+00 TO STA. 18+42.04 (RAMP "F")						642.04	642.04	0.121
TOTAL LENGTH OF WORK						12,915.23	12,915.23	2.446

NET LENGTH OF WORK "U" = 6088.00 LIN. FT. OR 1.153 MILES
NET LENGTH OF WORK "UG" = 3505.59 LIN. FT. OR 0.663 MILE
NET LENGTH OF WORK "FG" = 2097.73 LIN. FT. OR 0.397 MILE
NET LENGTH OF WORK "F" = 1223.91 LIN. FT. OR 0.231 MILE

STANDARD DRAWINGS							
I-8CB No. 3	1-26-59	I-1	11-15-60	I-12	7-1-54	I-8 IN #2	4-23-59
I-8CB No. 3A	1-26-59	I-1	11-15-60	I-12	7-1-54	RI-1	7-15-58
B.T. 70-71	11-15-60	I-8CB.2-2A & B	3-2-59	RB-1-55	2-2-59	SP-53	6-30-61
B.T. 71 R	3-2-53	I-8CB.2-3 & 24	1-26-59	I-15 NO. 1	11-15-60	T.J.	9-12-60
DR-1	1-3-55	I-8CB.2-3 & 24	1-26-59	I-15 NO. 2	8-17-60	T-35	1-2-56
F-1	9-1-59	I-8CB.2-3 & 24	1-26-59	I-15 NO. 6	7-1-59	AS-1-54	12-1-54
F-2	10-1-58	I-8CB.2-3 & 24	1-26-59	I-15 NO. 6	7-1-59	CSB-2-56	
F-3	9-1-59	I-8CB.2-3 & 24	1-26-59	I-15 NO. 6	7-1-59	(Sub 283 of 6)	2-2-59
G.7.07	6-1-56	I-8CB.2-3 & 24	1-26-59	I-15 NO. 6	7-1-59	L-1	4-1-50
HW-A & B	7-15-57	I-8CB.2-3 & 24	1-26-59	I-15 NO. 6	7-1-59	FAC. I-1	12-27-61
H.W.C	7-15-57	I-8CB.2-3 & 24	1-26-59	I-15 NO. 6	7-1-59	FAC. I-2	12-27-61
H.W.E	11-15-60	I-8CB.2-3 & 24	1-26-59	I-15 NO. 6	7-1-59	AC-1-57	12-12-60

SUPPLEMENTAL SPECIFICATIONS			
18	Rev. 6-15-59	I-128	7-31-59
B-112	8-21-61		
S-103	Rev. 2-16-55		
S-107	Rev. 2-16-55		
I-129	Rev. 4-5-61		
I-124	REV. 3-20-61		
L-120	Rev. 1-2-62		
CE-101.04	5-22-56		
M-107.1B	Rev. 4-3-61		
M-109.2B	Rev. 8-12-59		

Sheets 171, 179, 180, 186 and 191 revised 8-5-62

Sheet 191 rev. 7/27/62

DEPARTMENT OF COMMERCE
BUREAU OF PUBLIC ROADS
APPROVED: _____
DIVISION ENGINEER DATE

APR 12 1965
GROUND PHOTO LAB

FILE NO. LAKE COUNTY LAK-44-379
Date of Letting 19
Contract No. 00155R

TITLE SHEET