

A PVT WIDTH	DIMENSIONS (INCHES)		
	B	C	D
8'-0"	52	44	84
9'-0"	58	50	96
10'-0"	60	60	96
11'-0"	66	66	96
12'-0"	72	72	120

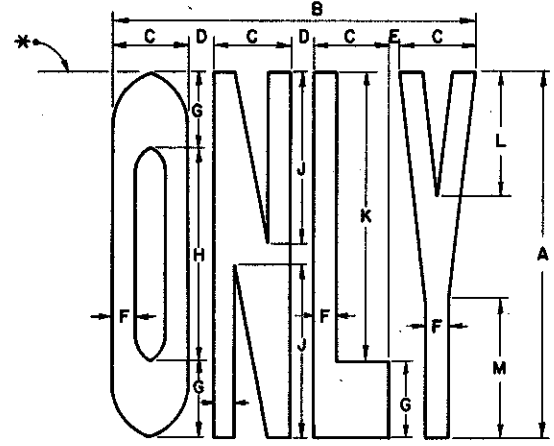

TYPE	DIMENSIONS (INCHES)											
	A	B	C	D	E	F	G	H	J	K	L	M
RURAL	96	94	20	6	2	6	20	56	45	76	32	36
URBAN	72	90	18	8	2	4.50	15	42	33.75	57	24	27

* INDICATES STATION REFERENCE POINT.

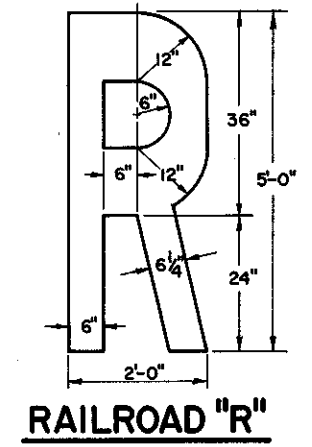
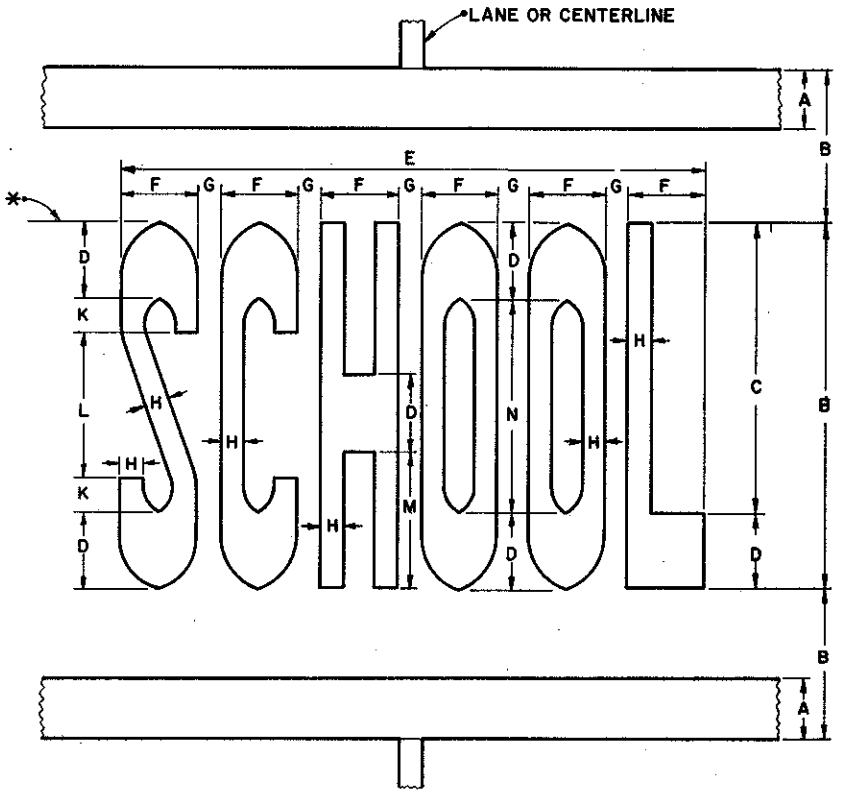
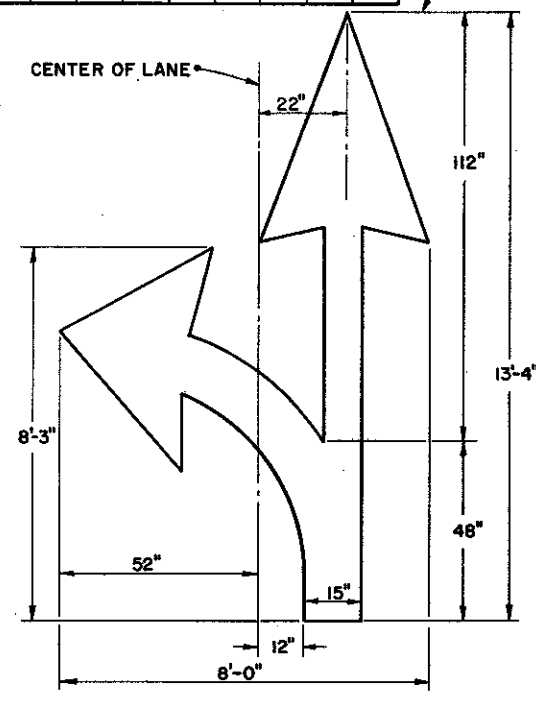
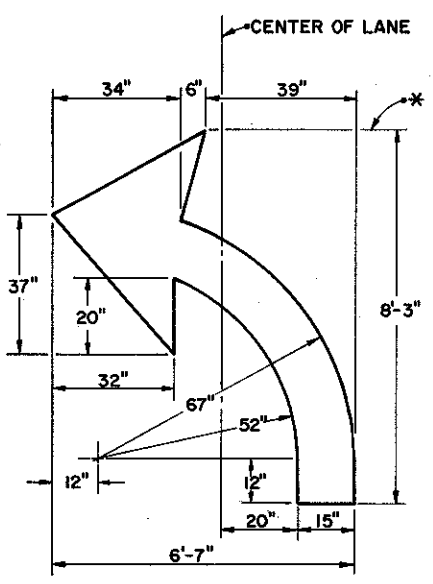
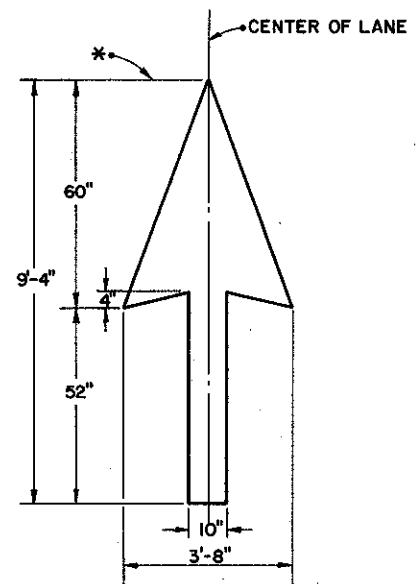

TYPE	DIMENSIONS (INCHES)													
	A	B	C	D	E	F	G	H	J	K	L	M	N	
RURAL	16	96	76	20	150	20	6	6	8	9	38	45	56	
URBAN	16	72	57	15	148	18	8	4.50	9	6.75	28.50	33.75	42	

- NOTES:**
- PAVEMENT MARKING FOR WORDS, SYMBOLS, ARROWS, AND TRANSVERSE LINES FOR THE WORD SCHOOL OR THE RAILROAD SYMBOL SHALL BE WHITE REFLECTIVE MATERIAL.
 - TWO TRANSVERSE LINES SHALL BE INCLUDED IN THE PAYMENT FOR EACH WORD SCHOOL. THREE TRANSVERSE LINES SHALL BE INCLUDED IN THE PAYMENT FOR EACH RAILROAD SYMBOL.
 - ON MULTI-LANE APPROACHES, THE TRANSVERSE LINES USED WITH THE RAILROAD SYMBOLS SHALL EXTEND ACROSS ALL APPROACH LANES AND INDIVIDUAL SYMBOLS SHALL BE PLACED IN EACH APPROACH LANE.
 - FOR THE RAILROAD SYMBOL, NO PORTION OF ONE TRANSVERSE LINE SHALL BE CLOSER THAN 30 FEET FROM THE NEAREST RAILROAD TRACK RAIL AND THE LINE MAY BE EITHER PARALLEL TO THE TRACK OR PERPENDICULAR TO THE CENTERLINE OF THE ROADWAY. THE OTHER TWO TRANSVERSE LINES AND THE RAILROAD SYMBOL SHALL BE LOCATED FROM THE STATION REFERENCE POINT SHOWN IN THE PLANS.
 - ON MULTI-LANE APPROACHES, THE TRANSVERSE LINES USED WITH THE WORD SCHOOL SHALL EXTEND ACROSS ALL APPROACH LANES WITH A SINGLE WORD SCHOOL CENTERED ACROSS THE APPROACH LANES. ON TWO LANE ROADWAYS, THE TRANSVERSE LINES SHALL EXTEND ACROSS THE ROADWAY WITH THE WORD SCHOOL CENTERED ACROSS THE ROADWAY. CENTER OR LANE LINES SHALL NOT PASS THROUGH THE SCHOOL MARKING.
 - THE PAVEMENT ARROW STATION REFERENCE POINT SHALL BE 30 FEET IN ADVANCE OF THE STOP LINE. THE WORD ONLY SHALL BE LOCATED FROM 35 TO 65 FEET (IN URBAN AREAS) OR 40 TO 85 FEET (IN RURAL AREAS) IN ADVANCE OF THE PAVEMENT ARROW STATION REFERENCE POINT. IN AREAS WHERE THESE DIMENSIONS ARE NOT PRACTICAL, THEY MAY BE REDUCED AS DETERMINED BY THE ENGINEER.

BUREAU OF DESIGN SERVICES DIVISION OF HIGHWAYS OHIO DEPARTMENT OF TRANSPORTATION	
TRAFFIC CONTROL	DATE 12/1/75
WORDS, SYMBOLS AND ARROWS	
STANDARD CONSTRUCTION DRAWING	TC-71.10
APPROVED: <i>[Signature]</i> Engineer of Design Services	