

MOVABLE GATE

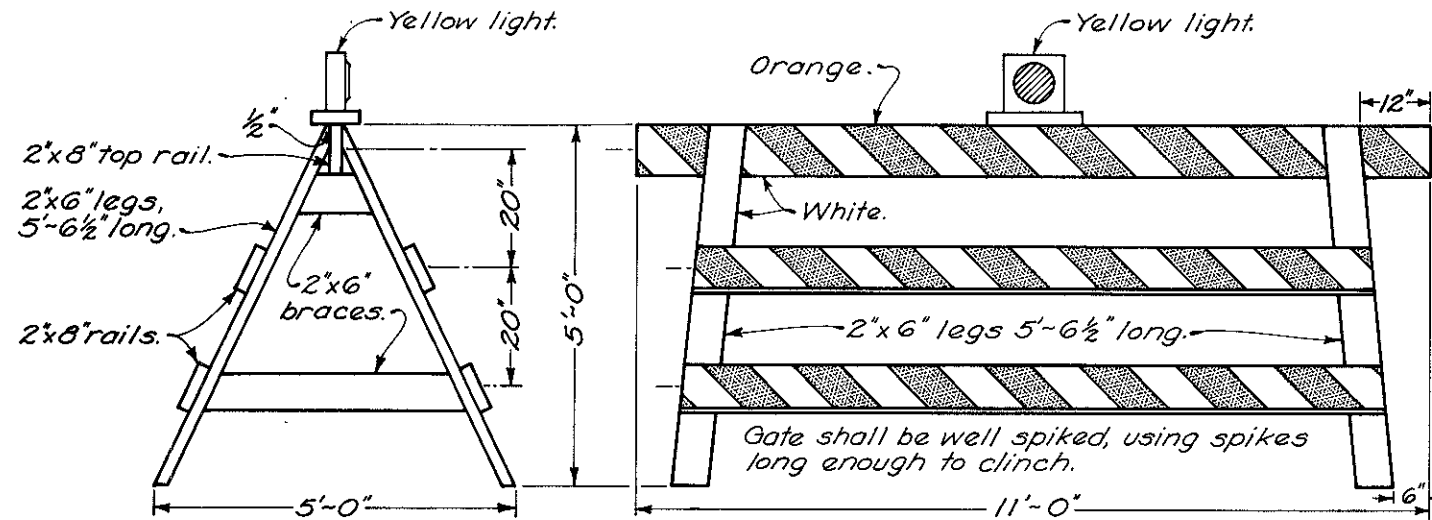

ROAD CONSTRUCTION

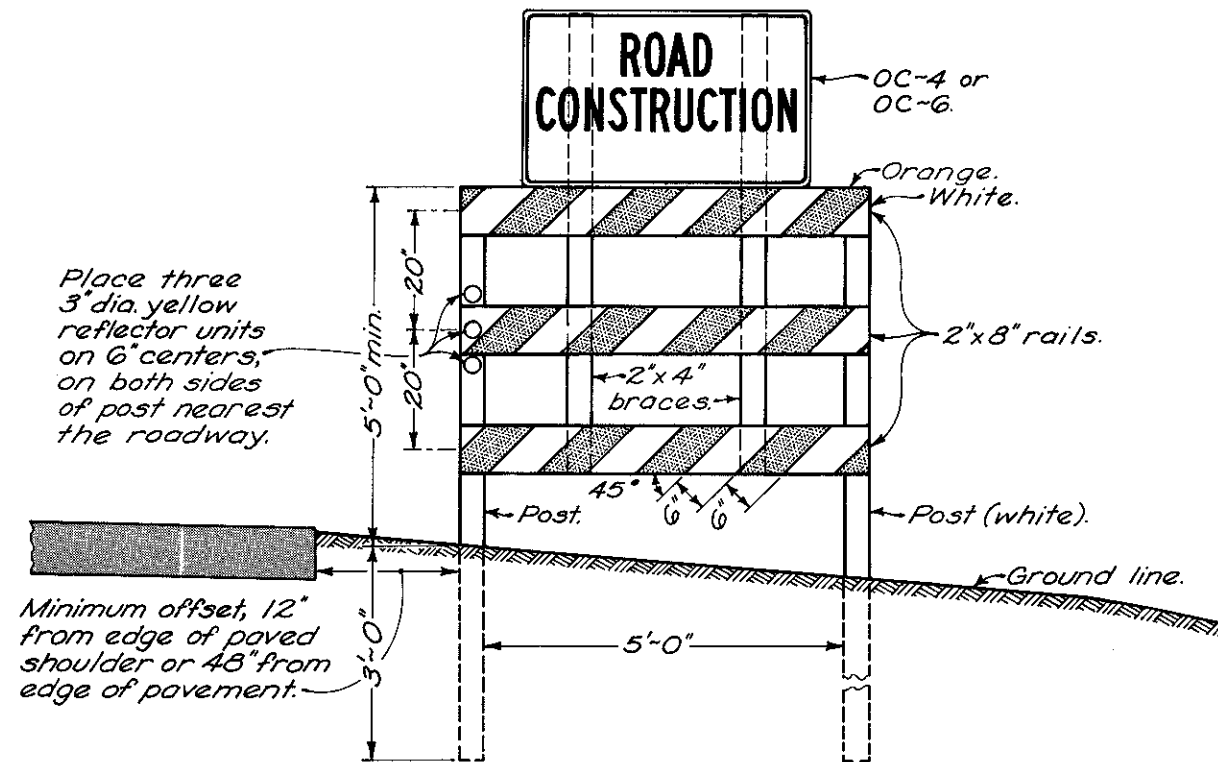

WING BARRICADE

NOTES

BARRICADES shall be constructed according to details shown. Where traffic is maintained during construction, wing barricades shall be used on each shoulder: (1) at both ends of the project, (2) on all interchange entrance ramps or on the cross road preceding the entrance ramp, (3) on all other major approach roads as directed by the Engineer. When the road is closed to traffic, barricades and gates shall be used to effectively close the entire roadway including the median of divided highways. In urban areas and at locations where it is impracticable to extend the barricade to the right-of-way line because of a sidewalk or other obstruction, the ends of the barricade shall be located as directed by the Engineer to effect the desired closing of the highway.

PAINTING AND REFLECTORIZATION: All rails of the barricades and gates shall be reflectorized with orange and white reflectorized sheeting in 6" wide alternate stripes which slope downward toward the center line of the road at an angle of 45%. All three rails of the Road Closed barricade shall be striped on the side facing traffic. All three rails of the wing barricade and all gate rails shall be striped on both sides. All posts, braces, gate legs and any unstriped rails shall be painted white.

GATES: One gate shall be erected for each traffic lane. Gates shall be chained and padlocked to one another and to adjacent posts of the barricades. Chains shall be 1/4" stock or larger with welded links.

A hinged gate may be used and shall be an approved 12 by 4 steel frame farm type, or a type approved by the Engineer. The gate shall be hung on hinge screw hooks, or as otherwise approved. Striping similar to that used on the movable gate shall be accomplished with 1x8" lumber or with metal strips fastened to the gate. The gate shall be supported at the center in an approved manner.

YELLOW LIGHT: Each gate shall be equipped with a steady burning yellow light, conspicuously visible at all distances up to 1000' under normal atmospheric conditions. The light, operated by battery, electric generator, commercial power or propane gas, shall be in operation at all times between sunset and sunrise during the period the highway is closed.

SIGNS: Where the road is closed to traffic by the erection of gates and barricades, a **ROAD CLOSED** sign (R-75) shall be mounted on the gate as shown. On three-lane pavement, the sign shall be mounted on the middle gate facing traffic.

Where traffic is maintained, a **ROAD CONSTRUCTION TRAFFIC MAINTAINED** sign (OC-4) shall be used on the right shoulder wing barricade on the approaches to major construction or maintenance jobs less than 2 miles in length. A **ROAD CONSTRUCTION NEXT MILES** sign (OC-6) shall be used on the right shoulder wing barricade on the approaches to any major construction or maintenance job of 2 miles or more in length. An **END CONSTRUCTION** sign (OC-8) shall be erected above the right hand wing barricade facing traffic leaving the construction section. The signs on the wing barricades shall be erected above the top rail of the wing barricade on braces, as detailed hereon.

LUMBER used in the construction of the gates and barricades shall be No. 1 common yellow pine or No. 1 common Douglas fir, surfaced on four sides standard, or other materials approved by the Engineer. All sizes are nominal.

POSTS shall be sound 4"x4" sawed or 4 1/2" round. Rails of the barricade shall be bolted to the posts with 5/8" bolts.

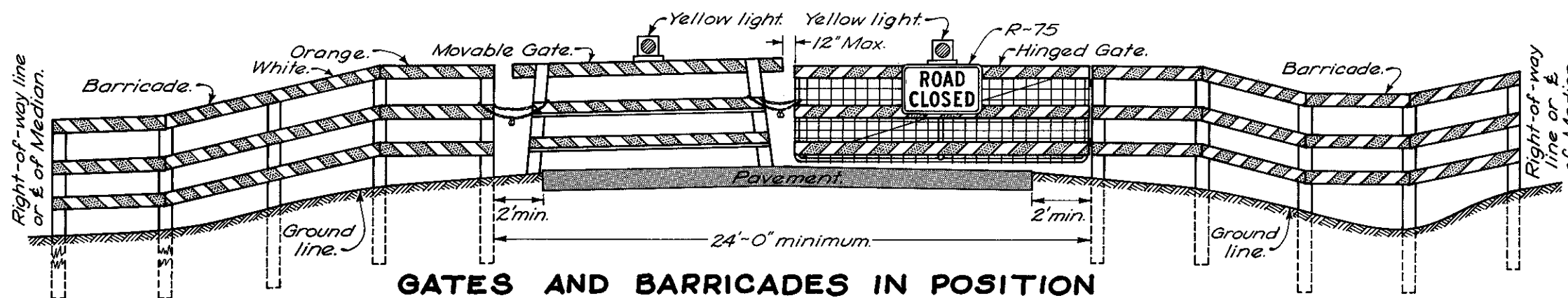

GATES AND BARRICADES IN POSITION

BUREAU OF ROADWAY DESIGN OHIO DEPARTMENT OF TRANSPORTATION	
BARRICADES AND GATES	
STANDARD CONSTRUCTION DRAWING	
MC-3	
APPROVED <i>[Signature]</i> ENGR., R. D.	
DATE	6-1-65
	5-1-66
	11-1-66
	6-20-69
	6-1-73