

MICROFILM
JUN 12 1987

FED. RD. DIVISION	STATE	PROJECT	210 228
2	OHIO		

LAKE COUNTY
LAK-44-1.70

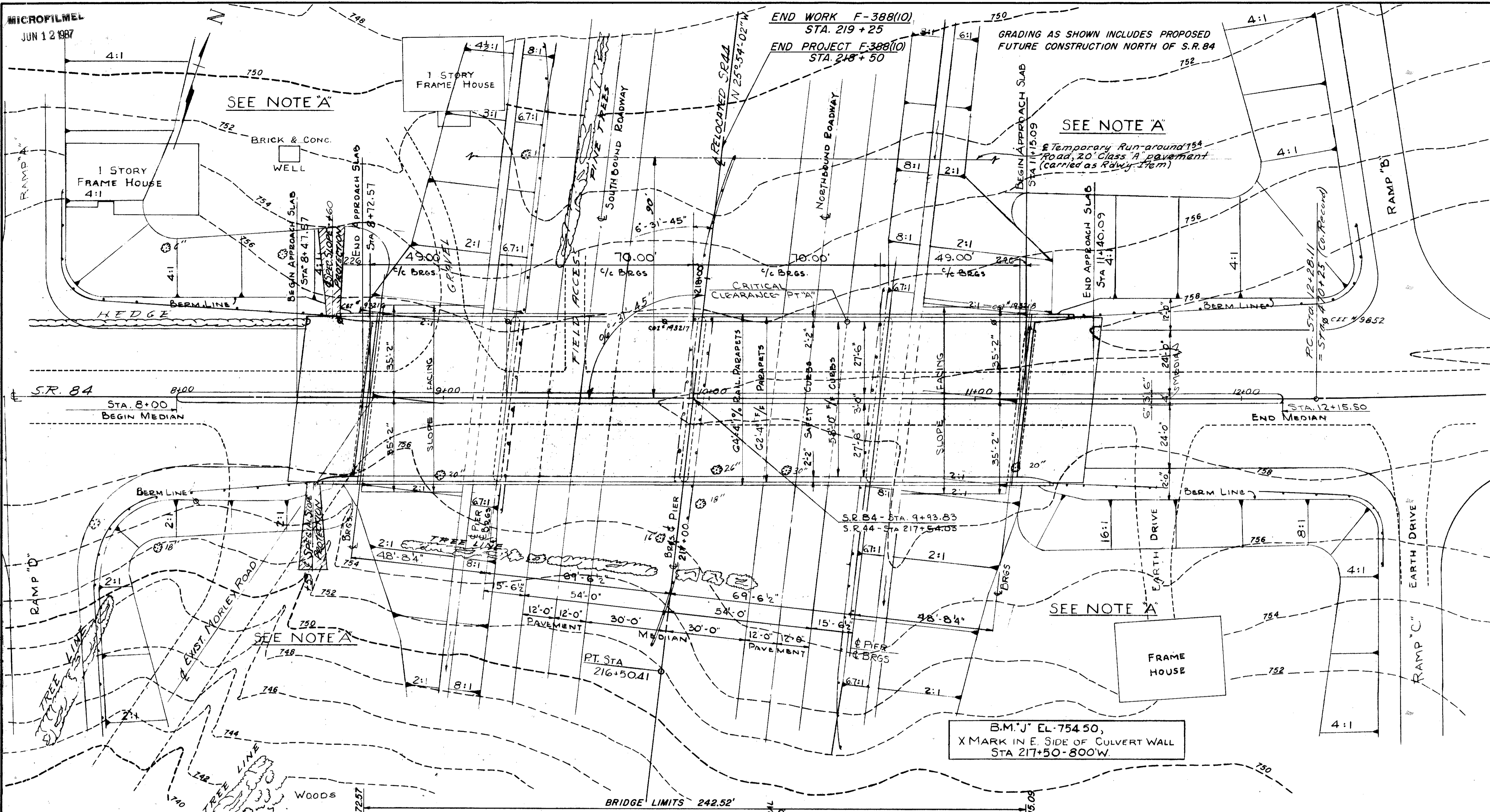

PROPOSED STRUCTURE
 TYPE: CONTINUOUS STEEL BEAM WITH REINF. CONC. DECK & SUBSTRUCTURE
 SPAN: 49'-0", 70'-0", 70'-0", 49'-0"
 ROADWAY: 58'-0" F/A 2'-2" SAFETY CURBS INCLUDING 3'-0" MEDIAN
 LOAD FREQUENCY: CF = 400 (57)
 SKEW: 6°-31'-45" L.F.
 WEARING SURFACE: 1" MONOLITHIC CONC.
 APPROACH SLABS: 25' LONG
 ALIGNMENT: TANGENT

FOUNDATION SOUNDINGS:
 FOUNDATION DESIGN AND FOUNDATION QUANTITIES ARE BASED ON A STUDY OF STANDARD PENETRATION TESTS AND SOIL SAMPLING MADE AT THE SITE. THIS INFORMATION MAY BE INSPECTED IN THE OFFICE OF THE BUREAU OF BRIDGES IN COLUMBUS OR IN THE DIVISION OFFICE, BUT THE STATE DOES NOT GUARANTEE THE ACCURACY THEREOF.

NOTE 'A'
 FOR GRADING OF AREA BOUND BY SR 44 AND INTERCHANGE RAMPS SEE CROSS SECTIONS AND GRADING PLANS SHEETS 109 AND 110.

NOTES:
 FOR DETAIL OF SPECIAL SLOPE PROTECTION SEE SHEET 6

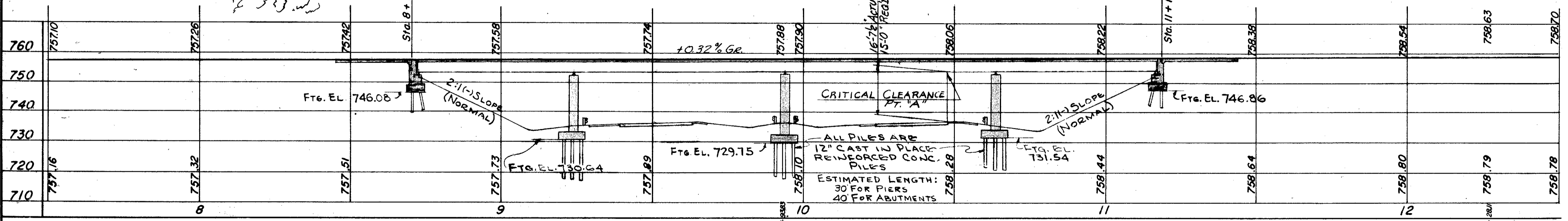

SCALE: 1" = 20'

TRYGVE HOFF & ASSOCIATES
 1922 EAST 107TH STREET ENGINEERS CLEVELAND, OHIO

SITE PLAN
BRIDGE NO. LAK-44-0411
S.R. 44 UNDER S.R. 84
 LAKE COUNTY S.R. 44
 STA. 217+54.03

DESIGNED	DRAWN	TRACED	CHECKED	REVIEWED	DATE	REVISED
JWP	JWP		AJ	T.L.L.	10/11/58	