

CALC. BY J.G.N.
 DATE 9/93
 CHKD. BY R.A.O.
 DATE 9/93

LAK 306 - 6.82

OHIO
 FHWA REGION 5

3
 3

PROJECT 1094-92
 CHANGE ORDER

MATCH LINE
 LAK - 306-6.91 STA.35+30=
 LAK - 306-7.12 STA.26+08.04

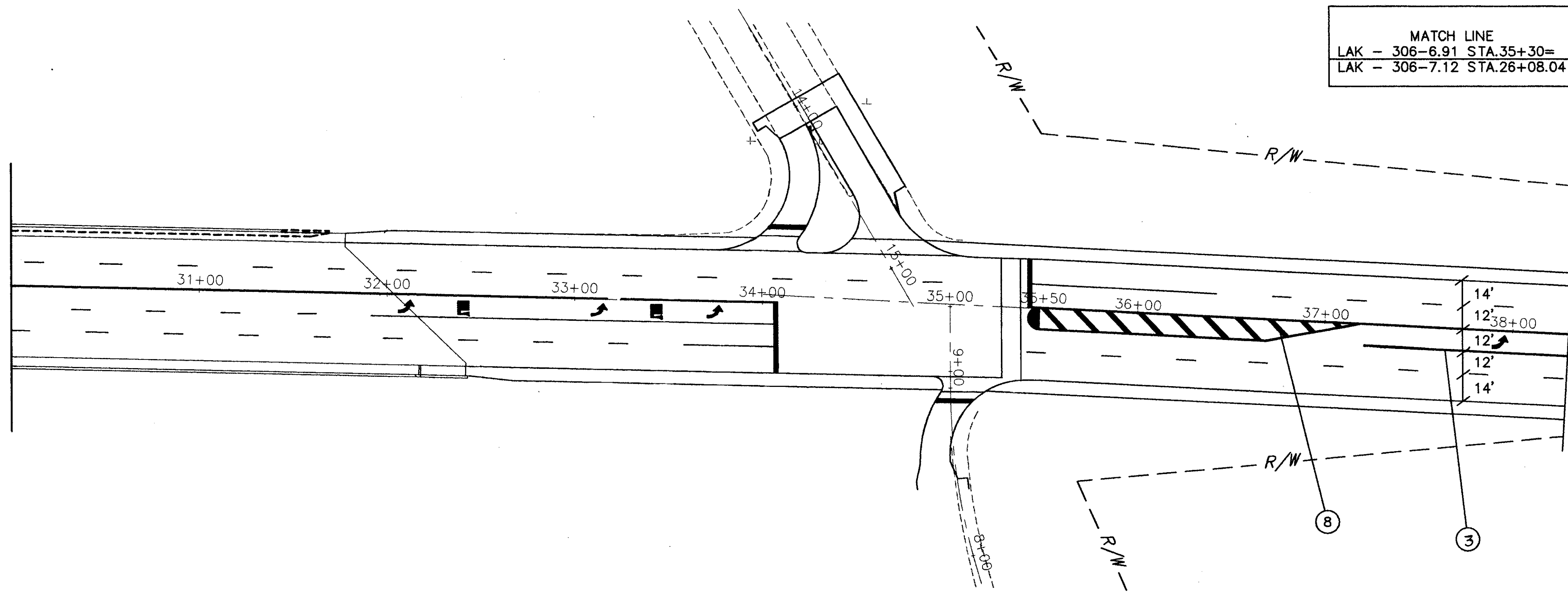

SIGN LEGEND

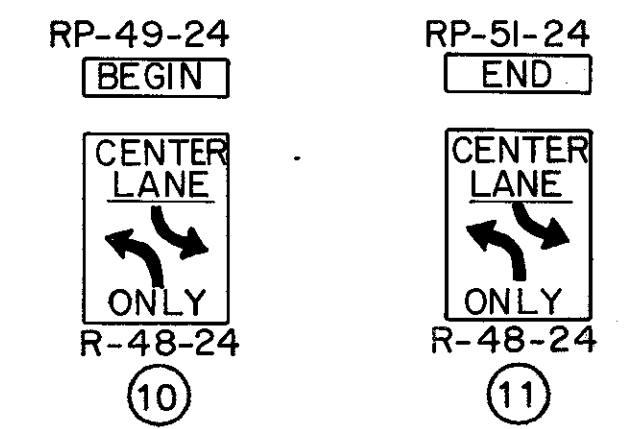

LEGEND

- ① LANE LINE
- ② CENTER LINE
- ③ CHANNELIZING LINE
- ④ STOP LINE
- ⑤ CROSSWALK LINE
- ⑥ LANE ARROW
- ⑦ WORD ON PAVEMENT
- ⑧ TRANSVERSE LINE

R-26A-30 R-30A-30 R-30A-30
 OVERHEAD MOUNTED

EX. MASTARM STA.24+70.36'L
 REMOVE EX. SIGNS 2R-50,
 RP-49, & RP-51

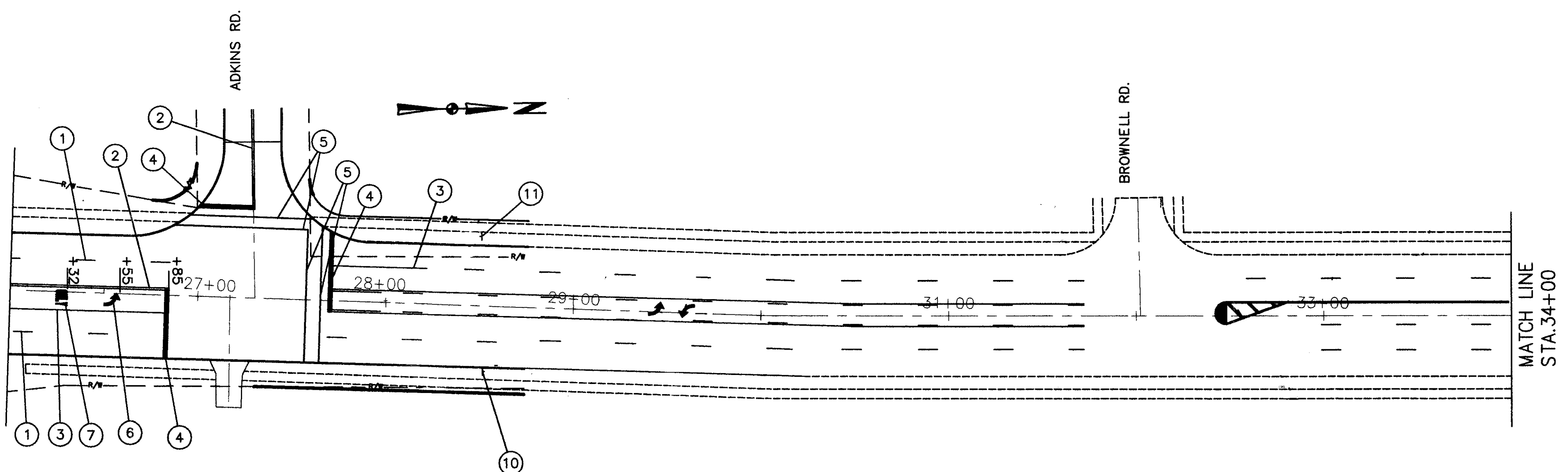

08-26-93 10:02 C:\VAD\JAN\BRT212109.DWG 3000