

FOR SIGNING DETAILS SEE SHEET 363-365
FOR CURB RAMP CALL OFFS SEE SHEET 50
FOR PAVEMENT MARKING DETAILS SEE SHEET 352-353
FOR TRAFFIC CONTROL GENERAL SUMMARY SEE SHEET 336-337
FOR ORIENTATION ANGLES SEE SHEET 347
FOR MAINLINE PLAN & PROFILE SEE SHEET 119-120
FOR SIDESTREET PLAN & PROFILE SEE SHEET 145-146

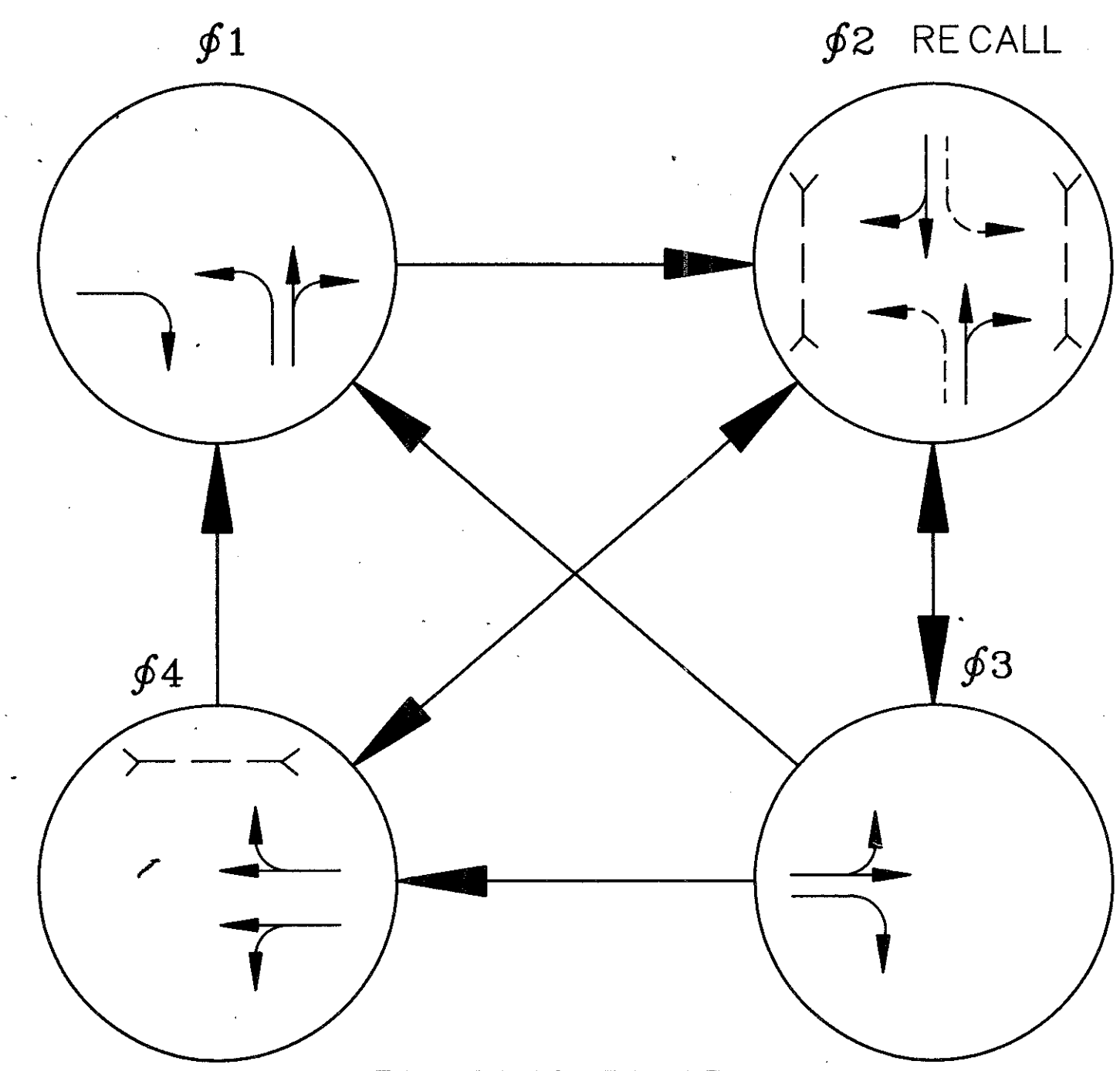

PHASING DIAGRAM

SIGNAL HEAD	φ1		φ2		φ3		φ4		FLASH	DWELL
	R/W	CLEAR	R/W	CLEAR	R/W	CLEAR	R/W	CLEAR		
A	G	G	G	Y	R	R	R	R	Y	G
B	G	G	G	Y	R	R	R	R	Y	G
C	R	R	G	Y	R	R	R	R	Y	G
D	R	R	G	Y	R	R	R	R	Y	G
E	R	R	R	R	R	R	G	Y	R	R
F	R	R	R	R	R	R	G	Y	R	R
G	R	R	R	R	R	R	R	R	Y	R
H	R	R	R	R	R	R	R	R	Y	R
W-W	DW	DW	W	FDW	DW	DW	DW	DW	OUT	DW
X-X	DW	DW	W	FDW	DW	DW	DW	DW	OUT	DW
Y-Y	DW	DW	DW	DW	DW	DW	DW	DW	OUT	DW

SIGNAL SEQUENCE CHART

FUNCTION	φ1	φ2	φ3	φ4
INITIAL GREEN	3.0	-	3.0	3.0
MINIMUM GREEN	-	24.0	-	-
VEHICLE EXTENSION	2.0	-	2.0	2.0
MAXIMUM GREEN	15.0	-	25.0	20.0
PEDESTRIAN WALK	-	10.0	-	7.0
PEDESTRIAN CLEARANCE	-	14.0	-	13.0
VEHICLE YELLOW CLEARANCE	3.0	3.0	3.0	3.0
VEHICLE ALL RED CLEARANCE	1.0	1.0	1.0	1.0
RECALL	-	YES	-	-
MEMORY	-	-	-	-

SIGNAL TIMING CHART

NOTE: L-2 & L-3 DETECTORS SHALL BE WOUND IN OPPOSITE DIRECTIONS.
NOTE: L-4 & L-5 DETECTORS SHALL BE WOUND IN OPPOSITE DIRECTIONS.

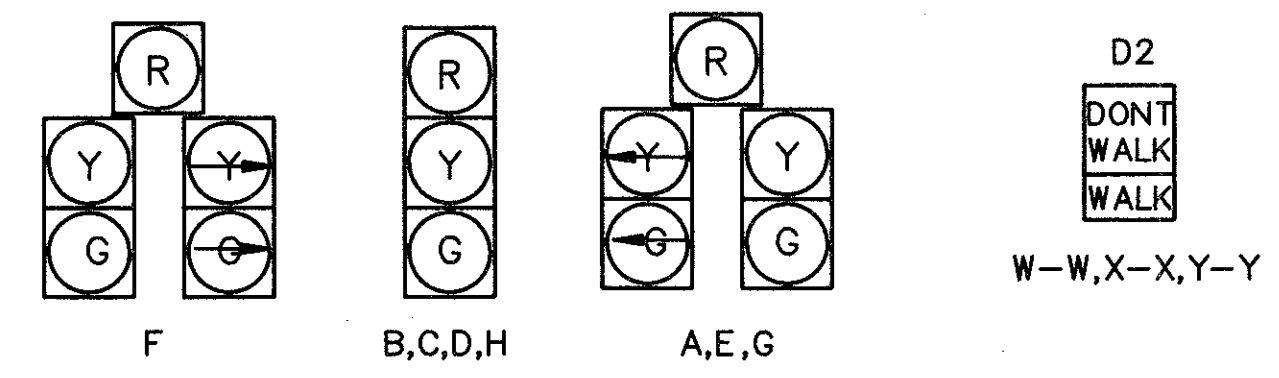

12" SIGNAL HEADS

LOOP	SIZE	TURNS	MODE	DELAY	EXTEND	PHASE	REMARK	INHIBITED DELAY	LOCATION 1st FRONT CORNER	LOCATION 2nd FRONT CORNER
L-1	6X35	2-4-2	PRESENCE		2.0	φ1	QUADRAPOLE		STA.10+38,3'R	STA.10+38,3'L
L-2	6X35	2-4-2	PRESENCE	7.0		φ4	QUADRAPOLE	φ4	STA.150+20,3'L	STA.150+20,9'L
L-3	8X35	2-4-2	PRESENCE	7.0		φ4	QUADRAPOLE	φ4	STA.150+20,15'L	STA.150+20,23'L
L-4	6X35	2-4-2	PRESENCE			φ3	QUADRAPOLE		STA.149+45,3'R	STA.149+45,9'R
L-5	8X30	2-4-2	PRESENCE	10.0		φ3	QUADRAPOLE	φ3	STA.149+47,15'R	STA.149+47,23'R

LOOP DETECTOR CHART

NOTE: SEE SHEET 349 FOR ADDITIONAL LOOP DETECTOR UNITS TO BE INSTALLED IN CONTROLLER AT THIS LOCATION.

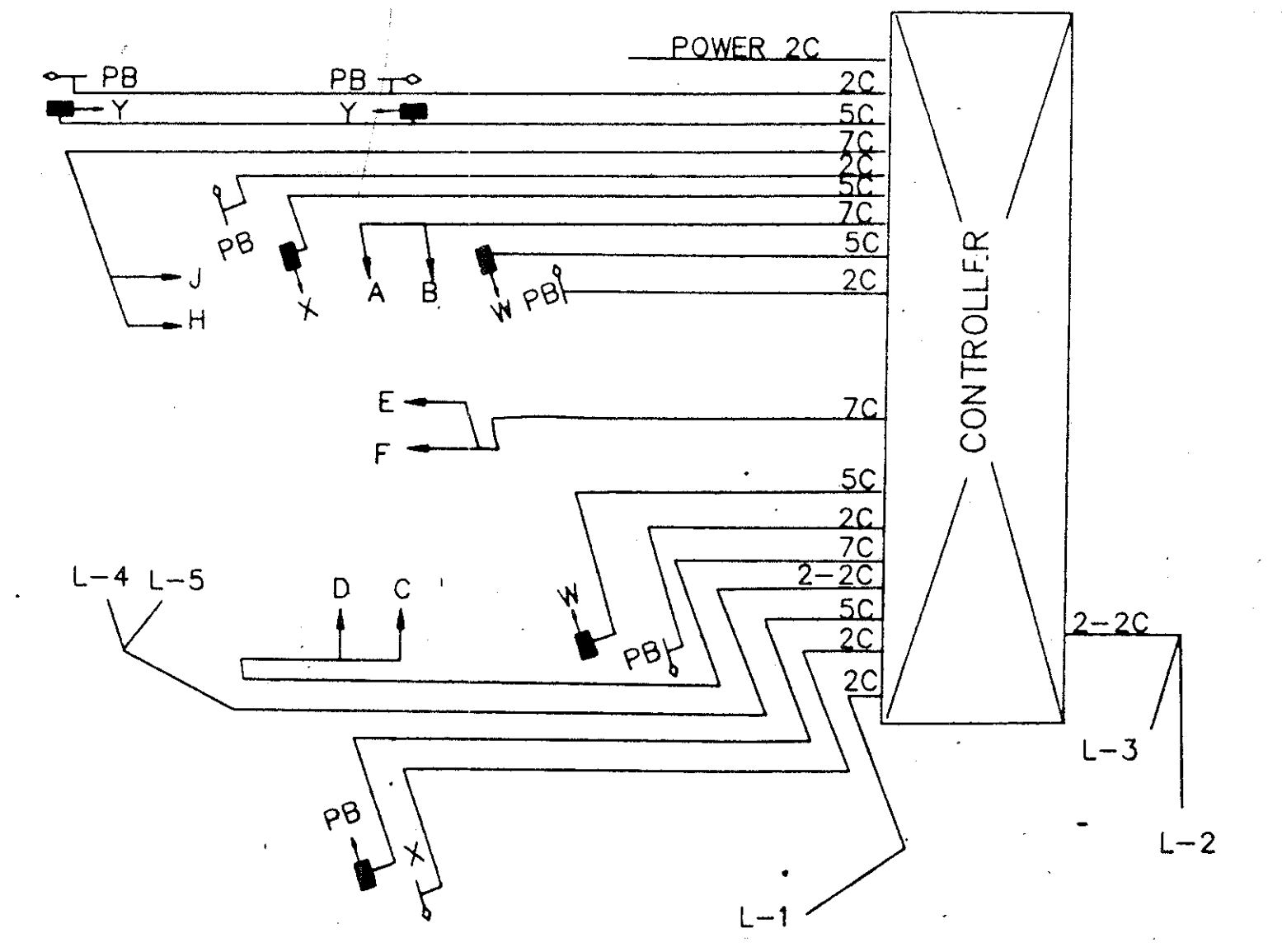
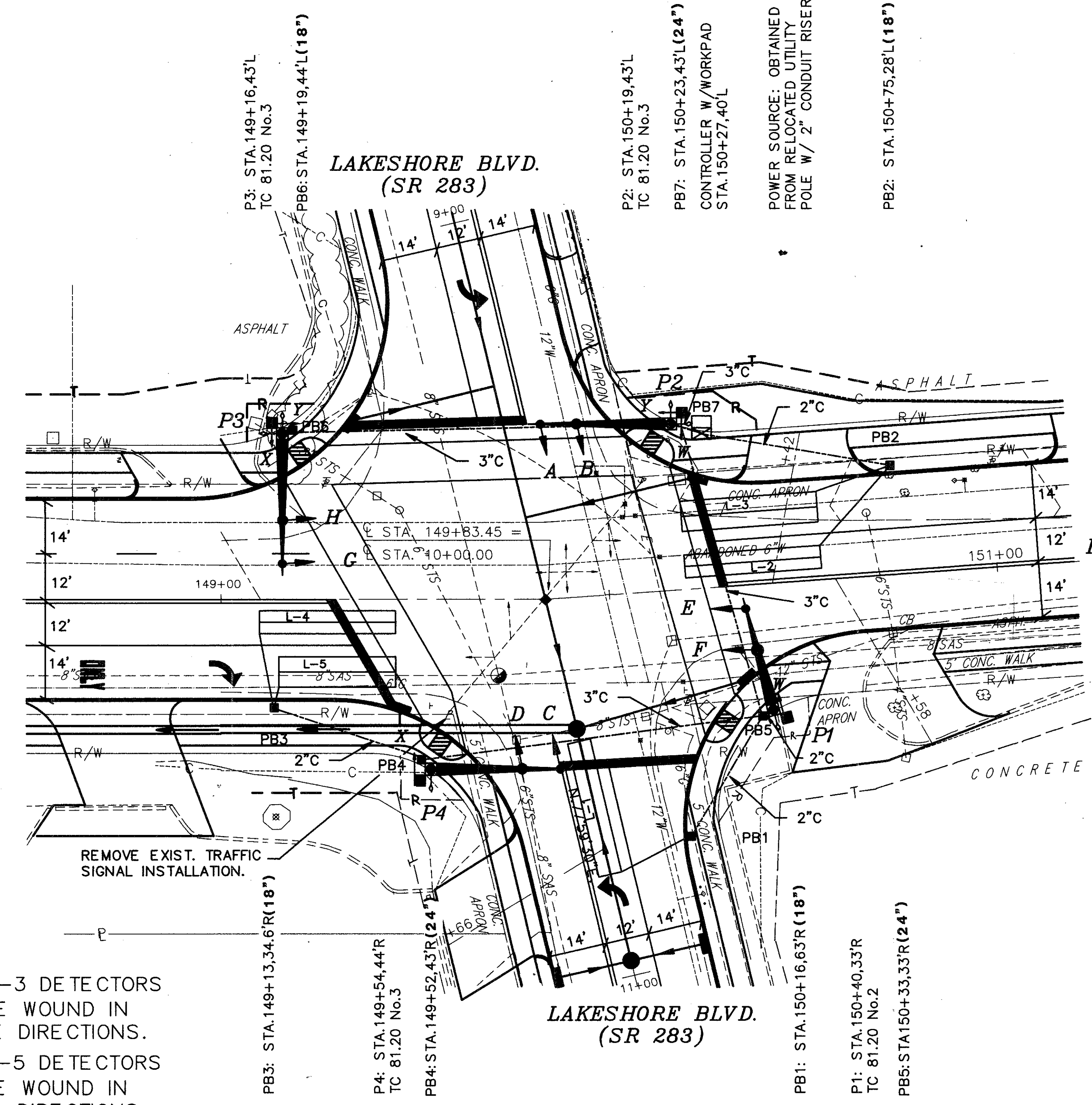

WIRING DIAGRAM

SUB SUMMARY			
ITEM	DESCRIPTION	UNIT	QTY
625	GROUND ROD	EACH	5
625	PULL BOX, 713.08, 18"	EACH	4
625	PULL BOX, 713.08, 24"	EACH	3
625	TRENCH	LN FT	409
625	CONDUIT, 2", 713.07, TYPE DB	LN FT	133
625	CONDUIT, CONCRETE ENCASED, 3", 713.07	LN FT	276
632	VEHICULAR SIGNAL HEADS, 3-SECTION, 12" LENS, 1-WAY, AS PER PLAN	EACH	4
632	VEHICULAR SIGNAL HEADS, 5-SECTION, 12" LENS, 1-WAY, AS PER PLAN	EACH	4
632	PEDESTRIAN SIGNAL HEAD, TYPE D2, AS PER PLAN	EACH	6
632	PEDESTRIAN PUSHBUTTON	EACH	6
632	LOOP DETECTOR UNIT, DELAY AND EXTENSION TYPE, AS PER PLAN	EACH	5
632	LOOP DETECTOR PAVEMENT CUTTING	LN FT	670
632	CONCRETE FOR ANCHOR BASE FOUNDATION	CU YDS	6.49
632	SIGNAL SUPPORT, TYPE TC-81.20, DESIGN No.2, W/ 29' ARM	EACH	1
632	SIGNAL SUPPORT, TYPE TC-81.20, DESIGN No.3, W/ 35' ARM	EACH	3
632	CABLE SUPPORT ASSEMBLY	EACH	4
632	SIGNAL CABLE, 2-CONDUCTOR, 14 AWG, AS PER PLAN	LN FT	616
632	SIGNAL CABLE, 5-CONDUCTOR, 14 AWG	LN FT	640
632	SIGNAL CABLE, 7-CONDUCTOR, 14 AWG	LN FT	676
632	LOOP DETECTOR WIRE, TYPE E	LN FT	1715
632	LOOP DETECTOR LEAD-IN CABLE	LN FT	418
632	POWER CABLE, 2-CONDUCTOR, 8 AWG	LN FT	150
632	POWER SERVICE	EACH	1
632	COVERING OF VEHICULAR SIGNAL HEADS	EACH	8
632	REMOVAL OF TRAFFIC SIGNAL INSTALLATION, AS PER PLAN	EACH	1
632	CONDUIT RISER, 2" DIAMETER	EACH	1
633	CONTROLLER, ACTUATED, 8 PHASE, SOLID STATE DIGITAL MICROPROCESSOR, AS PER PLAN	EACH	1
633	CONCRETE FOR CABINET FOUNDATION	CU YDS	1.0
633	CONTROLLER WORK PAD	SQ FT	8.3