

FED. RD. DIVISION	STATE	FED. AID PROJECT	TYPE FUNDS
2	OHIO	S-46(3)	POST WAR

5
9

LAKE COUNTY
LAK-306-4.33

1/2 mile ± north of Mormon Temple
at Kirtland, Ohio

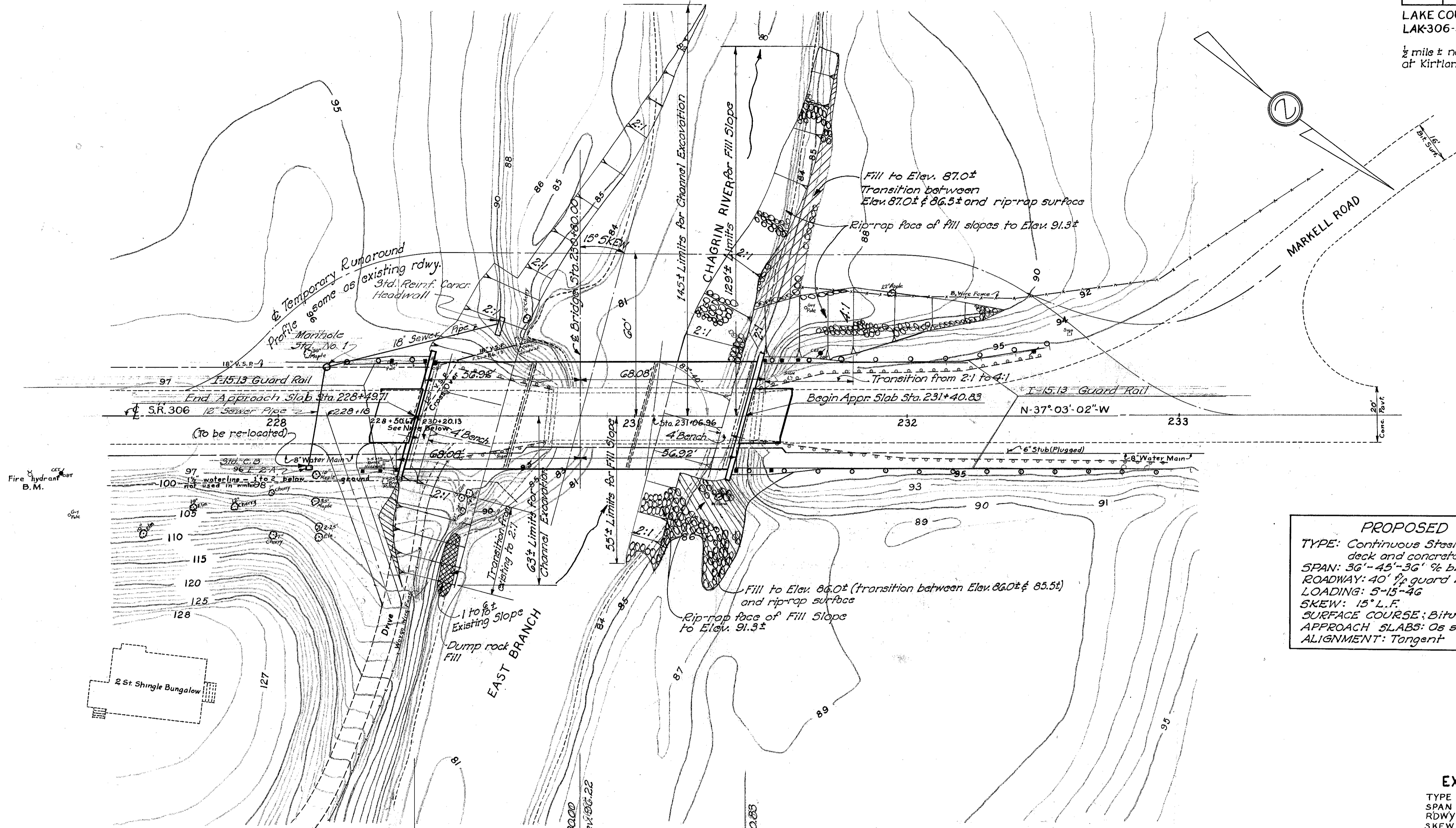

PROPOSED STRUCTURE
 TYPE: Continuous Steel Beam with concrete deck and concrete substructure
 SPAN: 36'-45'-36" 3/4 brgs.
 ROADWAY: 40' w/ guard rails
 LOADING: 5-15-46
 SKEW: 15° L.F.
 SURFACE COURSE: Bituminous
 APPROACH SLABS: As shown
 ALIGNMENT: Tangent

EXISTING BRIDGE DATA

TYPE Low Truss (Pratt)
 SPAN 72'-0"
 RDWY 18'
 SKEW Tan.rear-L.C.fwd. 6° L.F.
 CONDITION Good, Abutments fair
 DATE BUILT 1915

Waterway Area = 795± Sq. Ft.
 Drainage Area = 45.0± Sq. Mi.

Foundation design and foundation quantities are based on a study of rod soundings made at the site. This sounding information may be inspected in the office of the Bureau of Bridges in Columbus or in an abridged form in the Division Office, but the State assumes no responsibility for the accuracy thereof.

B.M. West Cap bolt on Fire Hydrant East of S.R. 306 opposite Sta. 227+12.5 Elev. 100.00

EQUATION
 Sta. 228+50.67 (Back) =
 Sta. 230+20.13 (Ahead)

Clears 5 yr. H.W. 2.5±

NOTE: All elevations shown on this sheet are relative elevations. For true elevations add 548.32 ft.

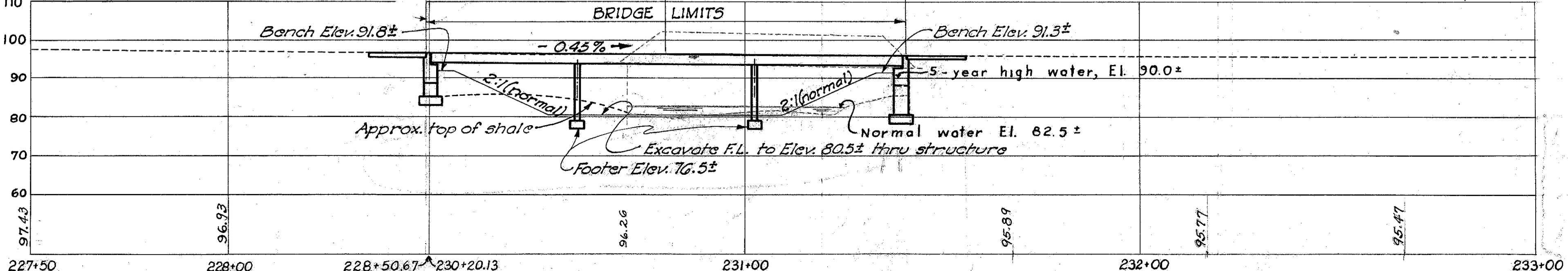

STATE OF OHIO DEPARTMENT OF HIGHWAYS BUREAU OF BRIDGES			
SITE PLAN			
BRIDGE N° LA-306-4.3 SECTION LAK-306-4.33 over East Branch of Chagrin River Sta. 230+80.00			
LAKE COUNTY			
Scale: 1"=20'-0"			
TOPOGRAPHY	PROPOSED WORK		
Survey	Design	Drawn By	Checked Reviewed Date
ASB	SCR	SCR	R.H.B. C.H.A.
BFG a.p. 9/27/51			