

FOR TYPICAL SECTIONS SEE SHEETS 3 THRU 6
 FOR BENCHMARKS SEE GENERAL NOTE SHEET 7
 FOR CROSS-SECTIONS SEE SHEETS 34 THRU 73
 FOR DRIVEWAY SCHEDULE & DETAILS SEE SHEET 79 & 80
 FOR PAVEMENT DETAILS SEE SHEET 81
 FOR TRAFFIC CONTROL DETAILS SEE SHEETS 84 THRU 104

REF	LOCATION	CU.YD.	SO.YD.	UN.FT.	SO.YD.	UN.FT.	SO.YD.	UN.FT.	TOTALS
255	255								
609	609								
451	451								
304	304								
255	255								
203	203								
									92.4
									665
									416.8
									69.4
									704
									68.4
									4.4

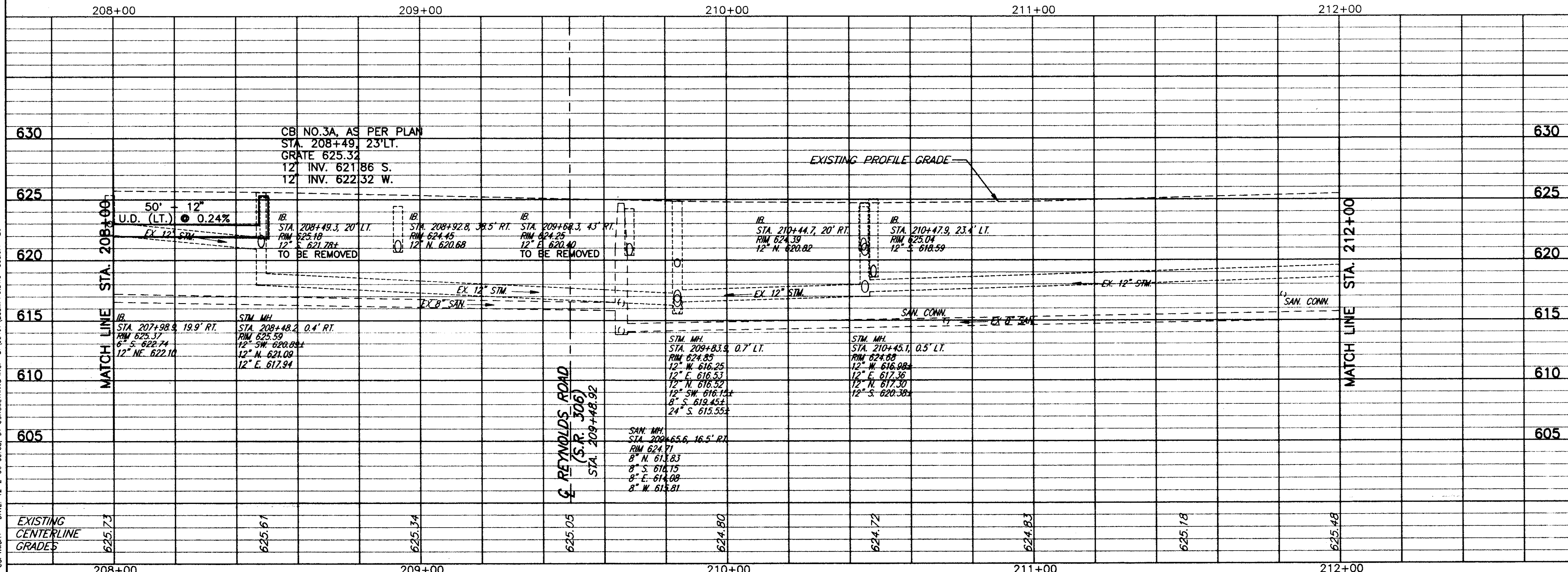

* LENGTH OF NEW SIDEWALK MINUS AREA THRU DRIVES

REF	LOCATION	SQ.YD.	SQ.FT.	UN.FT.	SQ.FT.	SQ.FT.
R-1	STA. 208+00, LT. TO STA. 209+10, LT.			112		
R-2	STA. 208+00, LT. TO STA. 209+10, LT. = 110 L.F. *	57.1	226			623
R-3	STA. 208+00, RT. TO STA. 208+91, RT.		510			510
R-4	STA. 208+00, RT. TO STA. 208+91, RT.			98		
R-5	STA. 208+49.3, 20' LT.				1	
R-6	STA. 209+68.3, 43' RT.				1	
R-7	STA. 149+35(SR306), RT. TO STA. 210+06, RT.		270			340
R-8	STA. 149+35(SR306), RT. TO STA. 210+06, RT.			58		
R-9	STA. 210+44.7, 20' RT.				1	
R-10	STA. 210+06, RT. TO STA. 212+00, RT. = 100 L.F. *		970			550
R-11	STA. 210+06, RT. TO STA. 212+00, RT.			194		
R-12	STA. 210+47.9, 23.4' LT.				1	
R-13	STA. 209+95, LT. TO STA. 212+00, LT.		1020			1040
R-14	STA. 209+95, LT. TO STA. 212+00, LT.			208		
R-15	STA. 208+00, RT. TO STA. 208+91, RT.		21.8			
R-16	STA. 209+95, LT. TO STA. 212+00, LT.		46.2			
R-17	STA. 149+35(SR306), RT. TO STA. 212+00, RT.		56.2			
R-18	STA. 208+00 TO STA. 208+35, LT.		31.2			
TOTALS		2125	2996	670	4	3063

REF	LOCATION	UN.FT.	UN.FT.	UN.FT.	EACH	EACH
D-1	STA. 208+49, 23' LT. TO STA. 208+49, 18' LT.	5	10	10	1	1
D-2	STA. 210+45, 23' LT. TO STA. 210+45, 19' LT.	4		20	1	
D-3	STA. 210+45, 23' RT. TO STA. 210+45, 18' RT.	5		20	1	
D-4	STA. 208+00 TO STA. 208+49, LT.	50				
TOTALS		64	10	50	2	1

PLAN & PROFILE STA. 208+00 TO STA. 212+00