

FOR TYPICAL SECTIONS SEE SHEET 3  
 FOR BENCHMARKS SEE GENERAL NOTE SHEET 4  
 FOR CROSS-SECTIONS SEE SHEETS 43 THRU 45  
 FOR DRIVEWAY SCHEDULE & DETAILS SEE SHEET 53  
 FOR PAVEMENT DETAILS SEE SHEET 54  
 FOR TRAFFIC CONTROL DETAILS SEE SHEETS 55 THRU 57  
 FOR WATERWORK DETAILS SEE SHEET 58

ITEM NO.	DESCRIPTION	CU. YD.	SQ. YD.	GAL.	TONS	TONS	TONS	TONS	TONS
203	EXCAVATION, NOT INCLUDING EMBANKMENT CONSTRUCTION								182
254	1-1/4" PAVEMENT PLANING, BITUMINOUS		856						856
411	6" STABILIZED CRUSHED AGGREGATE								23.3
203	SUBGRADE COMPACTION								466
407	TACK COAT (0.10 GAL./SQ.YD.)			132					132
304	4" AGGREGATE BASE								51.8
301	7" BITUMINOUS AGGREGATE BASE, AC-20								90.8
402	1-3/4" ASPHALT CONCRETE, AC-20								22.6
403	0" MIN. ASPHALT CONCRETE, AC-20 (1/2" AVG.)								11.9
404	1-1/4" ASPHALT CONCRETE, AC-20								45.9
<b>TOTALS</b>									

REF	LOCATION	CU. YD.	SQ. YD.	GAL.	TONS	TONS	TONS	TONS
P-1	STA. 160+50 TO 164+00, LT. & RT. = 11,900 S.F.	45.9						
P-2	STA. 160+50 TO 164+00, RT. = 2,100 S.F.	11.9						
P-3	STA. 160+50 TO 164+00, LT. = 2,100 S.F.	11.9						
<b>TOTALS</b>								

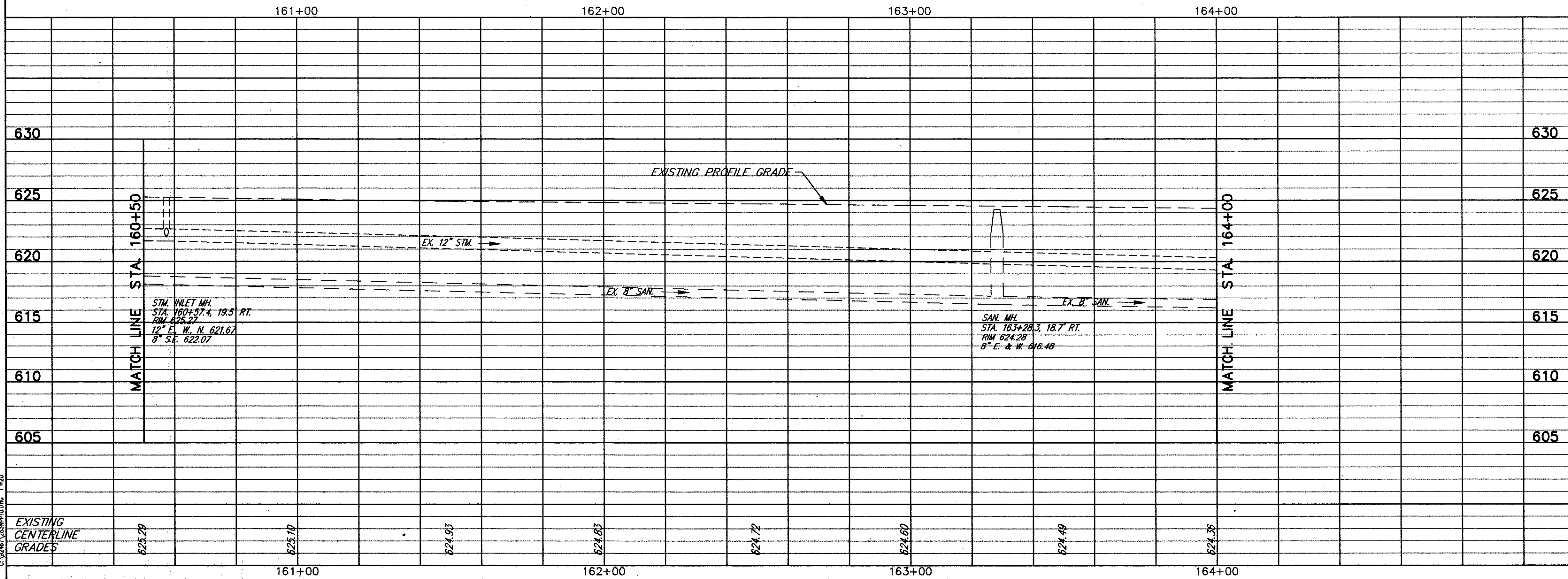

DRAINAGE				
REF	LOCATION	EACH	LIN. FT.	EACH
D-1	STA. 160+56.5, 22' LT. TO 160+56.7, 14' LT.	8		1
D-2	STA. 162+00, 22' RT. TO 16' RT.	1	10	1
D-3	STA. 160+57.4, 19.5' RT.			1
D-4	STA. 163+28.3, 18.7' RT.			1
<b>TOTALS</b>			18	2

PLAN & PROFILE STA. 160+50 TO STA. 164+00