

Summary of Soil Test Data

Station & Offset	Depth From-To	% Agg.	% C.S.	% F.S.	% Silt	% Clay	LL	Pl.	% W.C.	SHTL Class
105+00	0.6-2.0	45	18	21	13	3	NP	NP	11	A-1-b
	2.0-6.0	0	3	63	23	11	NP	NP	16	A-3a
	6.0-7.0	0	2	79	13	6	NP	NP	24	A-3a
	7.0-8.0	8	6	14	34	28	25	5	18	A-4a
109+00	0.0-2.0	0	11	43	31	15	NP	NP	12	A-4a
	2.0-5.0	4	8	56	20	12	NP	NP	12	A-3a
	5.0-8.0	6	3	6	37	43	13	12	19	A-4a
112+00	0.0-2.0	59	17	14	8	2	NP	NP	6	A-1-a
	2.0-6.0	0	0	2	99	59	10	19	13	A-6a
	6.0-8.0	11	8	10	36	35	28	8	15	A-4a
113+10	0.0-0.2	PAVEMENT SURVEY								
	0.2-0.9	6	7	20	31	36	20	11	11	A-6a
	0.9-4.0	7	7	13	32	41	32	13	17	A-6a
114+50	0.3-4.0	14	11	20	30	29	27	9	20	A-4a
	4.0-7.0	7	7	11	41	34	32	14	17	A-6a
	7.0-10.0	3	7	11	43	36	27	11	16	A-6a
	10.0-20.0	4	8	11	43	34	27	11	13	A-6a
114+50	0.3-1.0	VISUAL								
115+50	0.3-6.0	20	12	14	40	14	NP	NP	16	A-4a
	6.0-8.0	3	8	11	44	34	NP	NP	15	A-4a
	8.0-20.0	5	7	10	39	39	26	11	16	A-6a
116+50	0.8-2.0	37	20	26	14	3	NP	NP	23	A-1-b
	2.0-4.5	VISUAL								
116+50	0.3-8.0	5	11	37	28	19	25	8	12	A-4a
117+25	0.3-1.0	40	24	18	17	1	NP	NP	9	A-1-b
	1.0-5.0	11	11	14	30	34	33	2	30	A-6a
	5.0-7.0	9	9	35	32	15	23	2	30	A-4a
	7.0-12.0	7	8	11	41	33	26	11	15	A-6a
119+00	0.8-4.0	0	3	48	18	11	NP	NP	12	A-3a
	4.0-8.0	0	2	47	45	6	NP	NP	25	A-4a
	8.0-10.0	0	1	4	42	53	33	12	23	A-6a
	124+00	0.6-5.0	19	40	23	13	5	NP	NP	5
124+00	5.0-6.0	8	54	27	8	3	NP	NP	5	A-3a
	6.0-8.0	0	14	51	22	13	18	1	15	A-3a
	124+50	0.3-3.0	6	60	26	4	4	NP	NP	5
124+50	0.3-8.0	9	55	30	3	3	NP	NP	5	A-3a

NOTE: NP shown in the Liquid Limit and Plasticity Index columns indicates that the material is non plastic

LEGEND FOR PROJECT - AVERAGE RESULTS OF TESTS - 35 SAMPLES TESTED

DESCRIPTION	H. R. B. CLASS	OHIO CLASS	% AGG.	% C. SAND	% F. SAND	% SILT	% CLAY	LIQUID LIMIT	PLASTICITY INDEX	WATER CONTENT	SAMPLES TESTED
Gravel	A-1-a(0)	A-1-a	59	17	14	8	2	NP	NP	6	1
Gravel or cinders with sand	A-1-b(0)	A-1-b	40	21	22	15	2	NP	NP	14	3
Coarse and fine sand	-	A-3a	5	29	44	14	8	NP	NP	11	9
Sandy silt	A-4(5)	A-4a	8	8	26	36	22	13	3	18	11
Silt and clay	A-6(9)	A-6a	5	7	11	38	39	26	12	18	10
Silty clay	A-6(12)	A-6b	0	0	2	39	59	40	19	23	1

• Water content nearly equal to or greater than liquid limit.
 W- Free water
 Note: Figures adjacent to borings designate water content in per cent.

General Note

Pavement between Sta 105+00 and Sta 111+50 is in fair to good condition with lateral cracking and ravelling; between Sta 111+50 to 113+50, pavement is in extremely poor condition - broken, patched, wavy; between Sta 113+50 and Sta 128+00, pavement is in good condition with lateral cracking and ravelling. Pavement is Portland Cement Concrete with a bituminous concrete surface treatment.

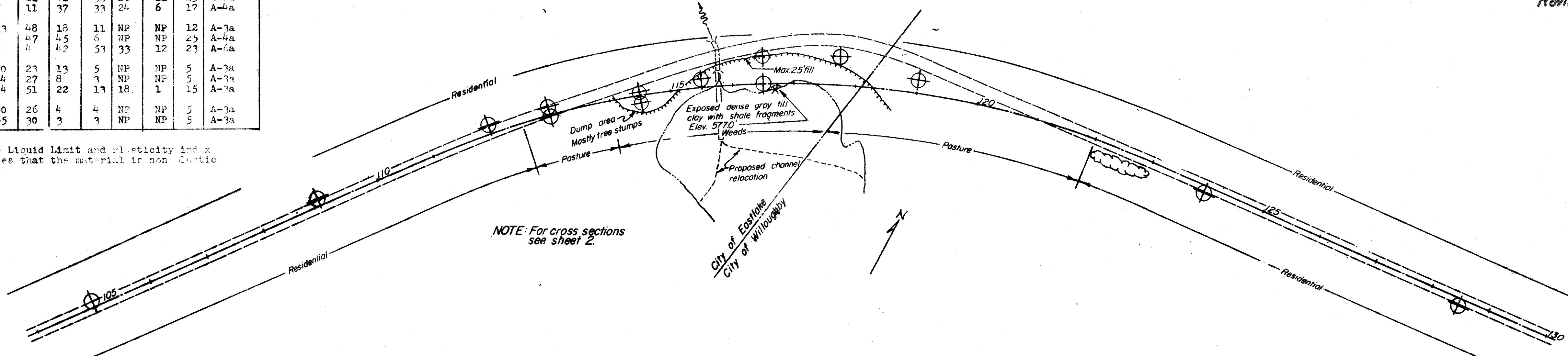

SOIL PROFILE
LAKE COUNTY
LAK-283-6-63 (661-694)
STATE HIGHWAY TESTING AND RESEARCH LABORATORY
O. S. U. CAMPUS, COLUMBUS, OHIO

NOTE: THE INFORMATION SHOWN BY THIS SUBGRADE PROFILE WAS SECURED FOR THE USE OF THE STATE OF OHIO AND IS NOT TO BE CONSTRUED AS A PART OF THE PLANS GOVERNING THE CONSTRUCTION OF THE PROJECT.

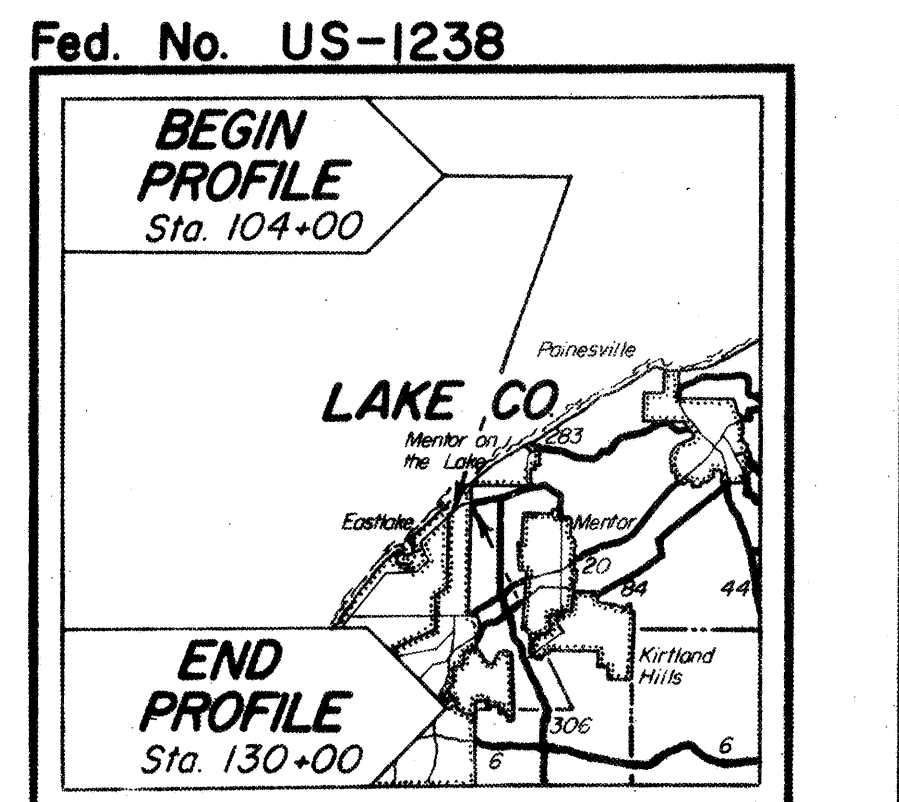

LOCATION MAP
Recon - C.J.K. - August 28, 1957
Drilling - C.A.S. - August 28, 1957
Drafting - D.L.W. - September 20, 1957
Revised October 22, 1957

