

500  
41

ROUTE — 283

SECT. — 6.61-6.94

COUNTY — LAKE

FED. RD. DIVISION	STATE	PROJECT	8 29
2	OHIO		

LAK 283 - (6.61 - 6.94)  
LAKE COUNTY

TOTAL NUMBER OF OWNERS — 6

### SUMMARY OF ADDITIONAL R/W REQUIRED

PARCEL N <sup>o</sup>	OWNER	AREA ACRES	EXIST. BLDGS.	SHEET N <sup>o</sup>	REMARKS
1	LOUISE G. BIBOW				NOT USED
2	CLIFTON E. & FAYE A. JENKS				" "
3	OLGA E. MASON				" "
4	MABEL D. WINNIE				" "
5	CARL & DIANE SUMMERS				" "
6	HILDRED O. HARTMAN				" "
7	MARGARET E. KITZMILLER				" "
8	DANIEL P. & ELEANOR S. BARNARD				" "
9	CHARLES M. RICHARDSON	1.302	—	8 & 9	
9 X	" " " "	1.053	—	9	
10	NELLIE S. HAWGOOD	0.393	—	"	SEE 18
10 WA	" " " "		—	"	" "
* 11 WA	JOSEPH S. COLE		—	"	
12	WM W. & MARY R. BROWN				NOT USED
13	HARRY L. & LEONA E. ADAMS				" "
14	WM A. & RUTH A. HURST				" "
15	HARVEY H. & LILLIAN E. DITTENHAVER				" "
16	FREDA STRONG	0.015	—	"	
17	HAROLD C.F. & BESSIE LAMMERS	0.016	—	"	
18		0.540	—	"	SEE 10
18 X		0.758	—	"	" "
19	MILAN S. KAPEL & LAURENCE J. GAUDIO	0.012	—	"	
20	" " " "	0.115	—	"	
* 10 WA-1			—	"	SEE 10 & 18

Compl. Oct. 9, 1957

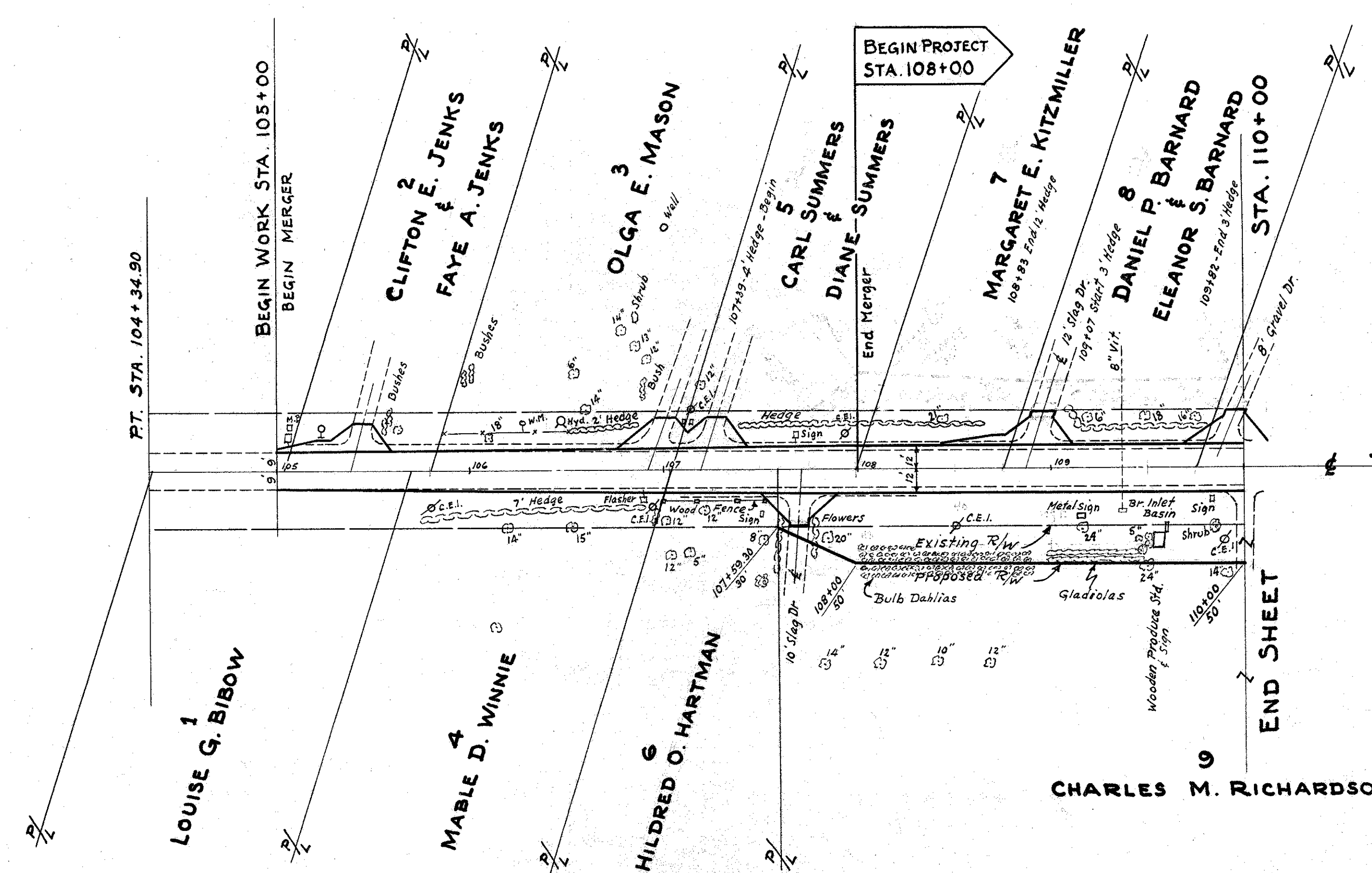

S.R. 283  
N. 31°-45'-00" E.

**UTILITIES INVOLVED.**

- THE CLEVELAND ELECTRIC ILLUMINATING COMPANY.
- THE OHIO BELL TELEPHONE COMPANY.
- THE EAST OHIO GAS COMPANY.
- THE CITY OF CLEVELAND (WATER DEPARTMENT).
- OHIO WATER SERVICE (MENTOR, OHIO)
- CITY OF EASTLAKE (WATER DEPARTMENT)

Scale: - 1" = 50'

RIGHT-OF-WAY STA. 105+00 TO STA. 110+00