

- ① TIE PROPOSED UNDERDRAIN INTO EXISTING UNDERDRAIN AT STA. 182+25, RIGHT
- ② LIGHT POLE TO BE RELOCATED BY OTHERS
- ③ CONNECT EXISTING UNDERDRAIN OUTLET IN EXISTING CATCH BASIN (R-65) INTO CATCH BASIN (D-65) WITH ITEM 603-6" CONDUIT, TYPE F, 707.17, NON-PERFORATED, ASTM D-3034, SDR-35, SS931 OR SS944.
- ④ LAK-REEVES ROAD IMPROVEMENTS TO BE CONSTRUCTED DURING SAME TIME PERIOD AS LAK-283. REEVES ROAD PROJECT INCLUDES REALIGNMENT OF REEVES ROAD AND WIDENING ALONG THE EAST SIDE OF SR 283. PROPOSED IMPROVEMENTS FOR THE LAK-REEVES RD PROJECT ARE SHOWN BELOW AS EXISTING

- ⑤ GUARDRAIL TERMINATION, SEE DETAIL SHT. 17
- ⑥ CURB / SHOULDER TRANSITION, SEE DETAIL SHT. 17
- ⑦ INTERSECTION IMPROVEMENT, SEE DETAIL SHT. 18
- ⑧ 5' RADIUS CURB TRANSITION, SEE DETAIL SHT. 17

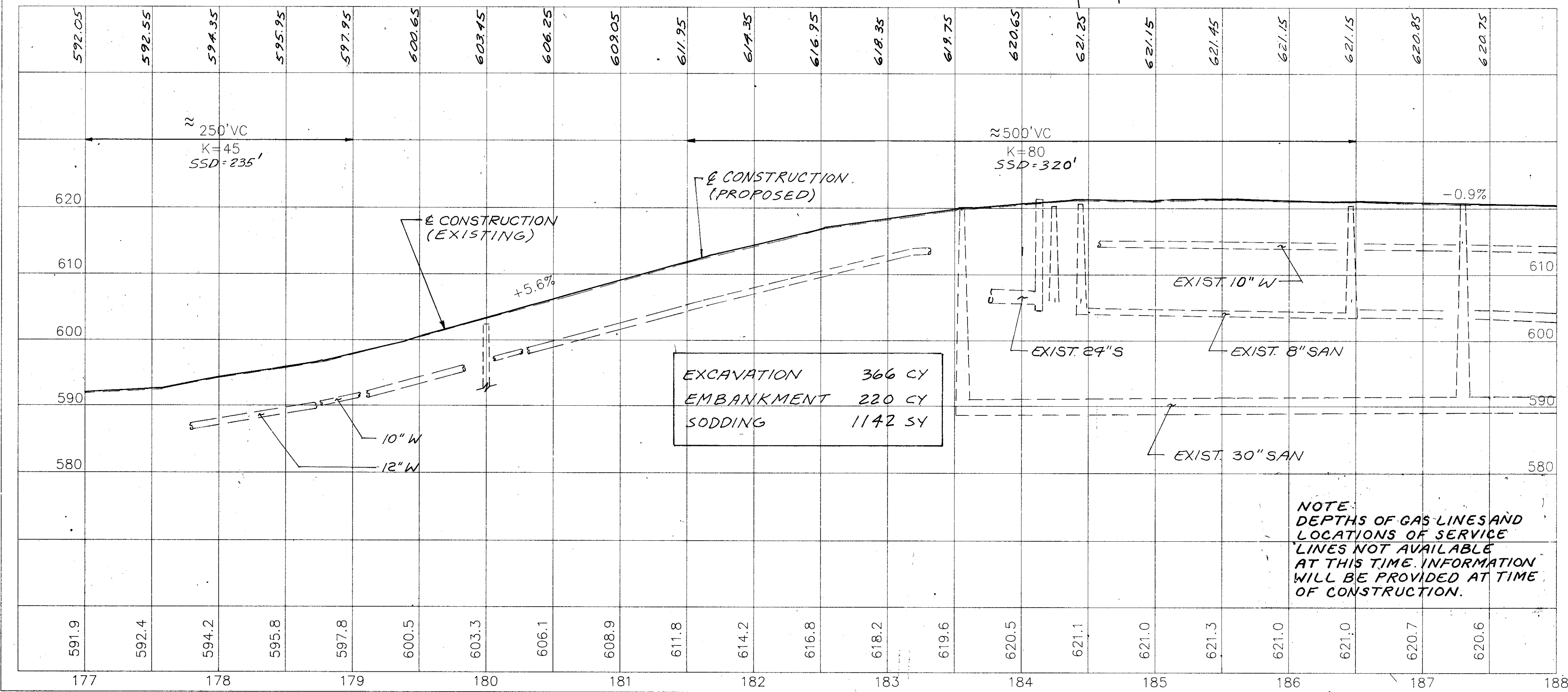
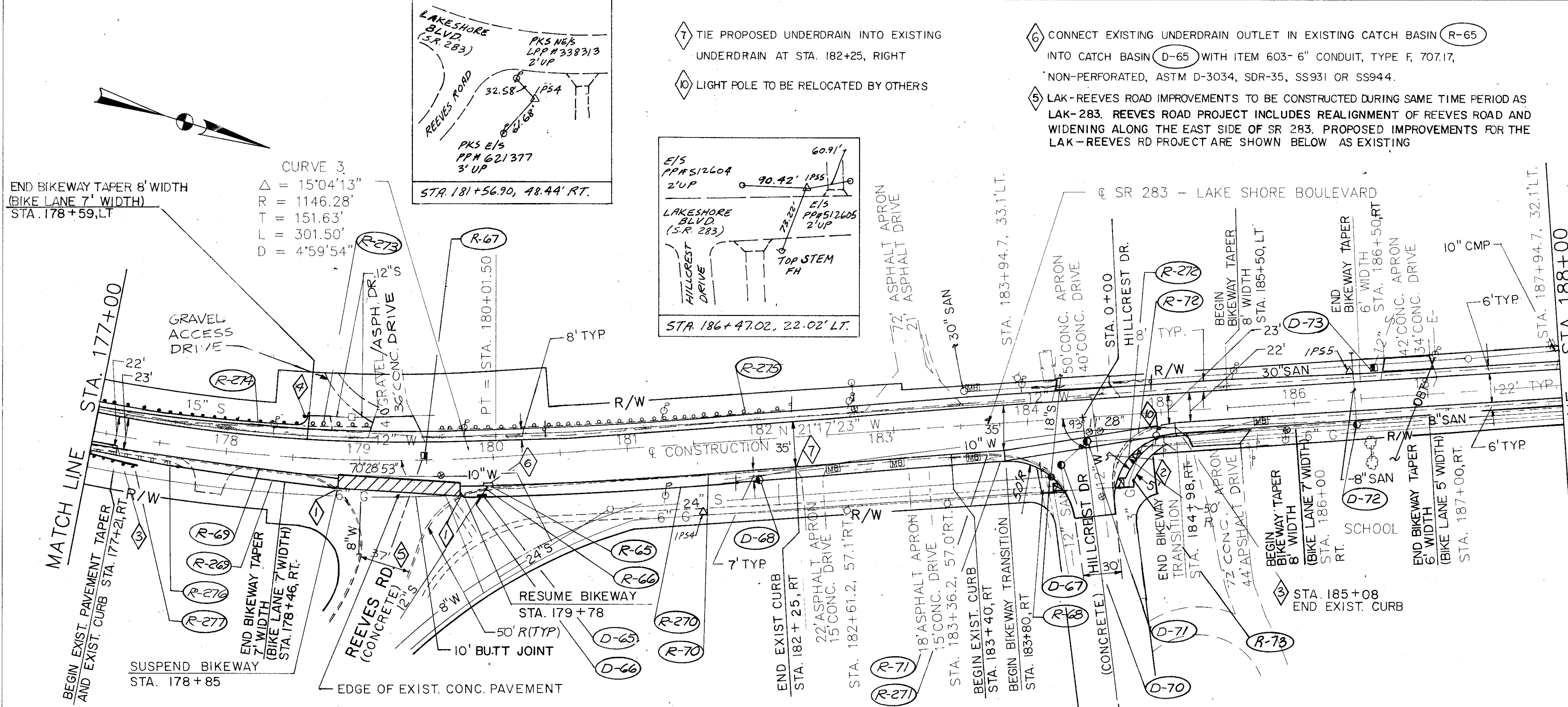

REF	LOCATION	EA	LN. FT.	202	202	606	604	606	606	608	202	609	
R-65	STA. 179+93, RT.	1											
R-66	STA. 179+90 TO 179+93, RT.		5										
R-67	STA. 179+48												
R-68	STA. 184+05 TO 184+14, RT.						1			225	1	155	
R-69	STA. 177+21 TO 178+87, RT.											166	
R-70	STA. 179+76 TO 182+25, RT.											209	
R-71	STA. 183+40 TO 0+76, RT.											124	
R-72	STA. 0+76 TO 184+98, RT.											86	
R-73	STA. 184+60 TO 185+10, RT.									320	2		
R-269	STA. 177+21 TO 178+87, RT.											166	
R-270	STA. 179+76 TO 183+81, RT.											405	
R-271	STA. 183+81 TO 0+76, RT.											76	
R-272	STA. 0+76 TO 185+08, RT.											85	
R-273	STA. 177+00 TO 179+09, LT.		209										
R-274	STA. 177+00 TO 178+56, LT.				1465			1					
R-275	STA. 179+60 TO 182+20, LT.		260										
R-276	STA. 177+00 TO 177+69, RT.		69										
R-277	STA. 177+00 TO 177+44, RT.				19			1					
TOTALS		1	538	5	1655	1	1	1	545	3	155	1225	732

REF	LOCATION	EA	LN. FT.	604	603	603	604	604
D-65	STA. 179+90, RT.	1						
D-66	STA. 179+85 TO 179+90, RT.		5		10			
D-67	STA. 184+14, RT.						1	
D-68	STA. 181+97, 30' RT.						1	
D-70	STA. 184+23, RT.						1	
D-71	STA. 184+44, RT.						1	
D-72	STA. 186+45, RT.						1	
D-73	STA. 186+62, RT.							1
TOTALS		1	5	10	5	1		

S.R. 283 PLAN & PROFILE STA. 177+00 TO 188+00