

CURVE 3  
 $\Delta = 72^{\circ}35'42''$   
 $R = 1145.57$   
 $T = 841.43$   
 $L = 1451.46$   
 $D = 5^{\circ}00'05''$

REF	LOCATION	202	202	606	606	202	606	606
		CATCH BASIN REMOVED	GUARDRAIL REMOVED	GUARDRAIL TYPE 5	ANCHOR ASSEMBLY TYPE T	PIPE REMOVED 24" AND UNDER	GUARDRAIL TYPE 5 AS PER PLAN	ANCHOR ASSEMBLY TYPE A
		EACH	LIN. FT.	LIN. FT.	EACH	LIN. FT.	LIN. FT.	EACH
R-30	STA. 158+80, 20' RT.	1						
R-31	STA. 159+31, 16' RT.	1						
R-32	STA. 159+81, 16' RT.	1						
R-33	STA. 160+20, 16' RT.	1						
R-34	STA. 161+03, 16' RT.	1						
R-35	STA. 161+68, 23' RT.	1						
R-36	STA. 162+96, 16' RT.	1						
R-37	STA. 163+58, 16' RT.	1						
R-38	STA. 158+05 TO 160+20, 16' RT.					215		
R-39	STA. 164+68.5 TO 165+51, LT.		82.5					
R-40	STA. 164+66.5 TO 165+51, LT.			75	1		49	
R-41	STA. 165+47 TO 166+00, RT.			12.5			53	1
R-42	STA. 161+03 TO 163+58, 16' RT.					255		
TOTALS		8	82.5	87.5	1	470	102	1

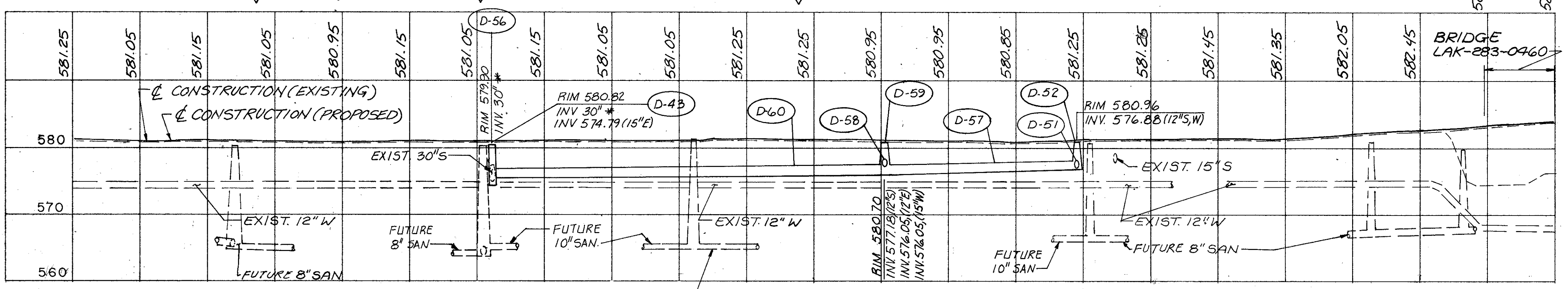

\* VERIFY IN FIELD APPROX 574.0 ±

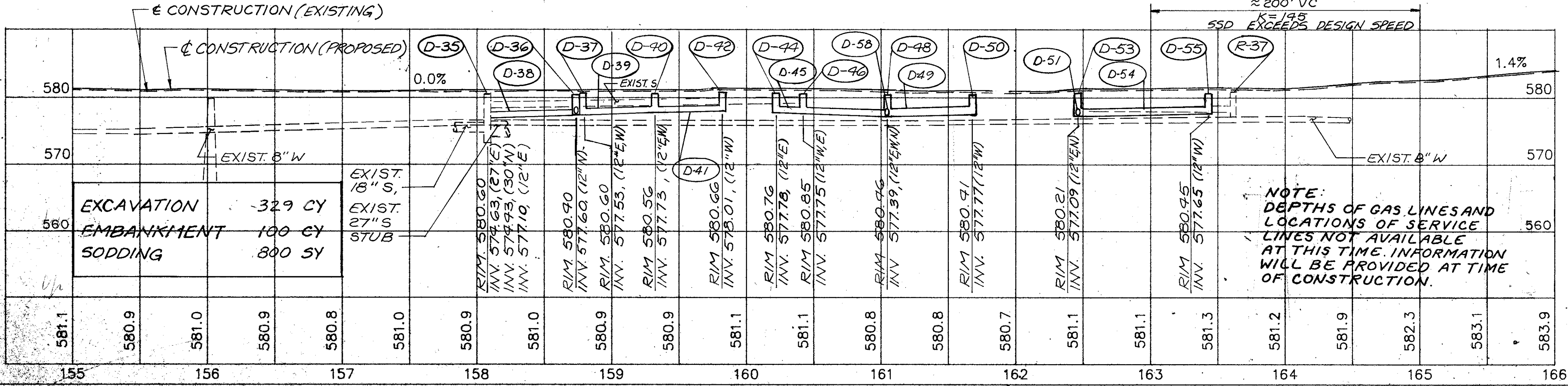

NOTE:  
 DEPTHS OF GAS LINES AND  
 LOCATIONS OF SERVICE  
 LINES NOT AVAILABLE  
 AT THIS TIME. INFORMATION  
 WILL BE PROVIDED AT TIME  
 OF CONSTRUCTION.

REF	LOCATION	604	604	604	603	603	604	603	603
		CATCH BASIN ADJUSTED TO GRADE	MANHOLE No. 1	CATCH BASIN 2-2-B	12" CONDUIT, TYPE B, 706.02, AS PER PLAN	30" CONDUIT, TYPE B, 706.02, AS PER PLAN	CATCH BASIN No. 2-3	15" CONDUIT TYPE B, 706.02, AS PER PLAN	12" CONDUIT TYPE B, 706.02, AS PER PLAN, ENCASED
		EACH	EACH	EACH	LIN. FT.	LIN. FT.	EACH	LIN. FT.	LIN. FT.
D-35	STA. 158+05, 20' RT.	1							
D-36	STA. 158+73, 25' RT.			1	8				
D-37	STA. 158+79, 17' RT.		1						
D-38	STA. 158+05 TO 158+79, RT.					74			
D-39	STA. 158+79 TO 159+31, RT.					34			
D-40	STA. 159+31, 24' RT.			1					
D-41	STA. 159+31 TO 159+80, 24' RT.					49			
D-42	STA. 159+80, 24' RT.			1					
D-43	STA. 158+10, 12' LT.						8		
D-44	STA. 160+20, 24' RT.		1						
D-45	STA. 160+20 TO 160+41, RT.					22			
D-46	STA. 160+41, 17' RT.		1						
D-47	STA. 160+41 TO 161+03, RT.					62			
D-48	STA. 161+03, 24' RT.			1					
D-49	STA. 161+03 TO 161+68, 24' RT.					65			
D-50	STA. 161+68, 24' RT.			1					
D-51	STA. 162+46, 12' LT TO 24' RT								36
D-52	STA. 162+46, 12' LT		1						
D-53	STA. 162+96, 24' RT.			1					
D-54	STA. 162+96 TO 163+92, 24' RT.					96			
D-55	STA. 163+92, 24' RT.			1					
D-56	STA. 158+12, 25' CT.						8	1	
D-57	STA. 161+03 TO 162+46, 12' LT					143			
D-58	STA. 161+03, 24' RT TO 12' LT								36
D-59	STA. 161.03, 12' LT		1						
D-60	STA. 158+10 TO 161+03, 12' LT								293
TOTALS		1	5	8	553	16	1	293	72