

80 70 60 50 NORTH 40 30 20 10 0 10 20 30 40 SOUTH 50 60

10 OHIO 1941  
 Rainsville Euclid Road  
 S.H. 520 Sec. B(Pt.) & Lakeline  
 Lake County

25  
37

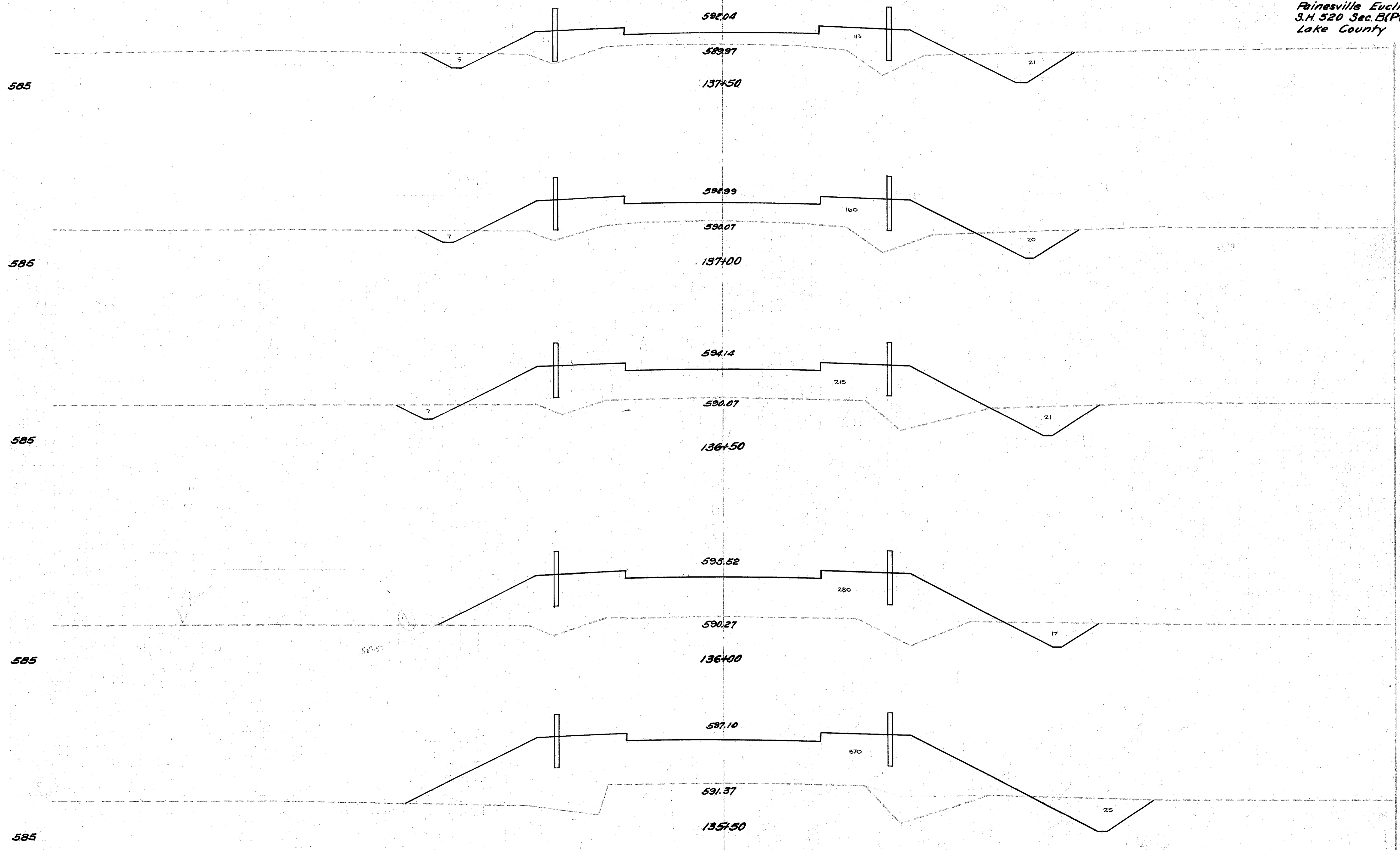

Station	Proposed Elev. (ft)	Existing Elev. (ft)	Stationing	End Area (sq ft)	Area (sq ft)	Cu. Yd.
137+50	589.04	589.97	137+50	30	113	43
137+00	592.99	590.07	137+00	27	160	53
136+50	594.14	590.07	136+50	28	215	51
136+00	595.52	590.27	136+00	17	280	42
135+50	597.10	591.37	135+50	25	370	39
<b>Total</b>				<b>137</b>	<b>198</b>	<b>253</b>

80 70 60 50 40 30 20 10 0 10 20 30 40 50 STA. 135+50 TO STA. 137+50