

Item	Station	Side	I-17 Cu. Yds
D-1	36+40	Lt.	2.3

LAKE COUNTY
S.H. 520 SEC. PAINESVILLE (PT.)
S.H. 744 SEC. PAINESVILLE (PT.)
& FAIRPORT (PT.)

CURVE DATA
 $\Delta = 110^{\circ}-47'$
 $R = 5'$
 $L = 1145.92$
 $E = 118.25$
 $M = 239.67$
 $P = 6.09$

STRUCTURES 20' SPAN & UNDER

Mark	Station	Type	Size	Sheet No.
C-3	35+01.55	Std. P. Col.	60'x68'	27
C-2	33+12		12'x45'	26

PAVED GUTTER & RIP RAP

Item	Station	To Station	Side	Type	LF	PG	Rip Rap Sq. Yds
PG-1	34+50	35+22	Rt		72		5

GUARD RAIL

Item	From Station	To Station	Side	Remove & Rebuild LF	Remove & Store LF
RG-1	34+73	37+32	Rt	47	229
RG-2	37+18	37+34	Lt		16
RG-3	40+68	45+00	Lt	432	
RG-4	40+68	43+12	Rt	244	
Total				723	245

REBUILT GUARD RAIL

Item	From Station	To Station	Side	Lin. Ft
GR-1	34+68	37+30.5	Rt	262.5
GR-2	37+18	37+34	Lt	16.0
GR-3	40+68	43+80.5	Lt	312.5
GR-4	40+68	43+12	Rt	244.0
Total				835.0

† Use 112 LF removed from Sta. 45+00 to 46+12
 The above Table not to be used as a pay item. To be used for
 locations of rebuilt guard rail only.

PAVEMENT REMOVAL

Station	To Station	Length	Width	Sq. Yds
33+00	37+40.32	439	18	878
40+56.2	45+00	443.8	18	887.6
Total				1765.6

EXISTING STRUCTURE
 Type: High Thru Truss - Overall Span 316' with center pier.
 Width: 20' with 4'-8" sidewalk - No. LA-535-0.4
 No work required

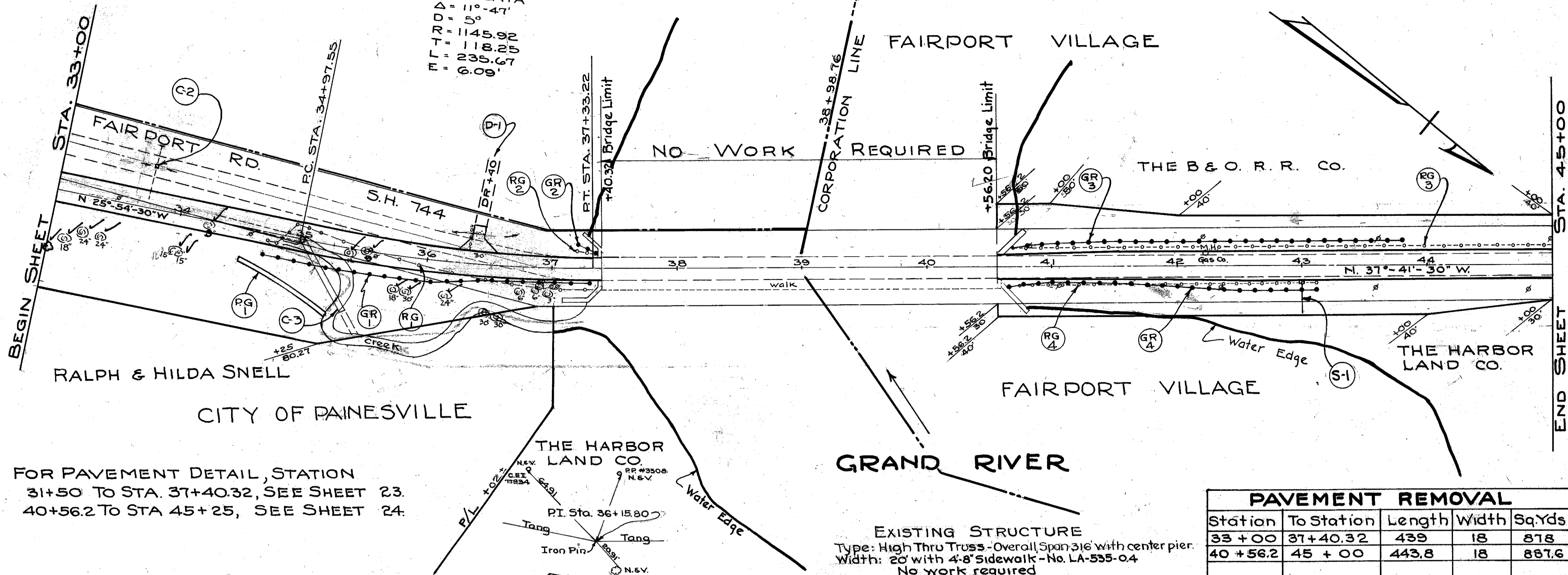

FOR PAVEMENT DETAIL, STATION
 31+50 TO STA. 37+40.32, SEE SHEET 23.
 40+56.2 TO STA. 45+25, SEE SHEET 24.

B.M. No. 10 Drill Hole N.W. Corner
 Culvert on West 360' South of Bridge
 Elev. 590.020

B.M. No. 11 X on N.E. Corner S.E. Abut.
 of Bridge
 Elev. 591.178

B.M. No. 12 Spike 25' up on C.E. Pole #77940
 150' N. of Bridge on West.
 Elev. 584.647

B.M. No. 13 Spike in W. Root 54" Elm
 150' E. & - 500 N. Bridge
 Elev. 583.302

Note: 1/2 to 1 slopes on approaches on
 both sides of Bridge to be sodded.
 Estimated Quantity - 140 Sq. Yds
 (Painesville 60.5%) (Fairport 80.5%)

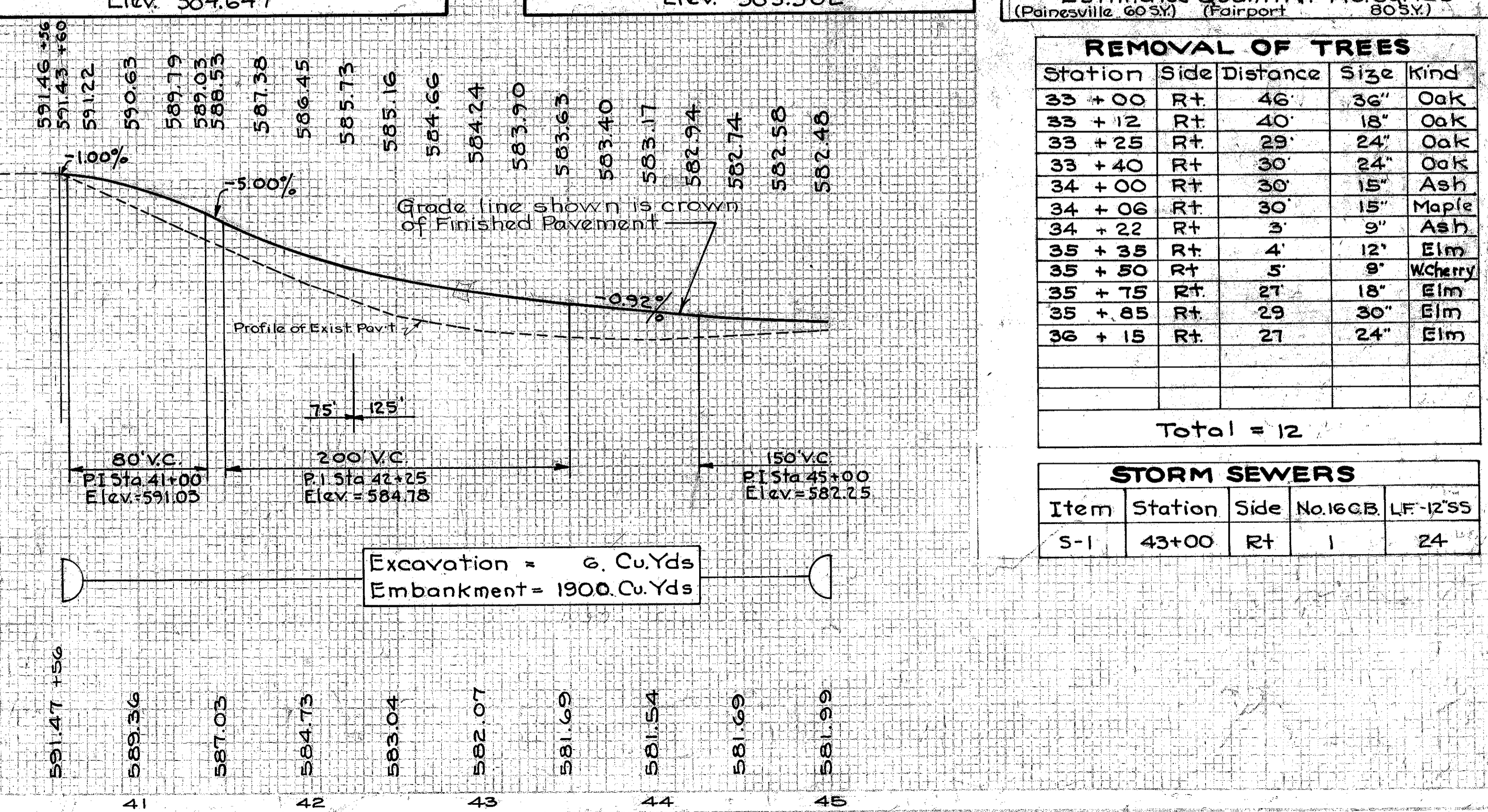
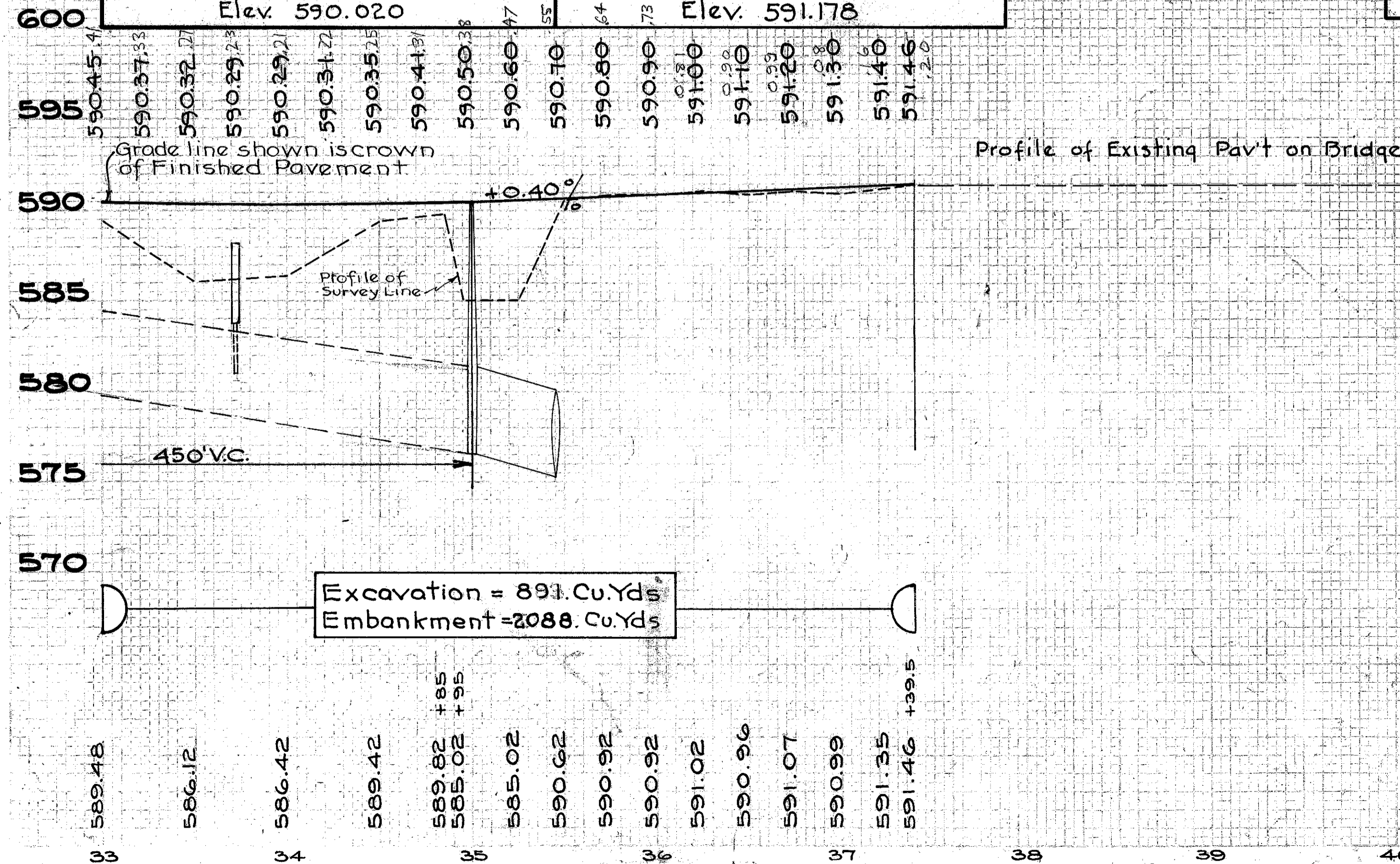

Excavation = 891 Cu. Yds
 Embankment = 2088 Cu. Yds

Excavation = 6 Cu. Yds
 Embankment = 1900 Cu. Yds

REMOVAL OF TREES

Station	Side	Distance	Size	Kind
33+00	Rt	46'	36"	Oak
33+12	Rt	40'	18"	Oak
33+25	Rt	29'	24"	Oak
33+40	Rt	30'	24"	Oak
34+00	Rt	30'	15"	Ash
34+06	Rt	30'	15"	Maple
34+22	Rt	3'	9"	Ash
35+35	Rt	4'	12"	Elm
35+50	Rt	5'	9"	Wcherry
35+75	Rt	27'	18"	Elm
35+85	Rt	29'	30"	Elm
36+15	Rt	27'	24"	Elm
Total = 12				

STORM SEWERS

Item	Station	Side	No. 16 G.B.	LF-12"SS
S-1	43+00	Rt	1	24'