

I. G. H. No. 520 SEC. F
LAKE COUNTY

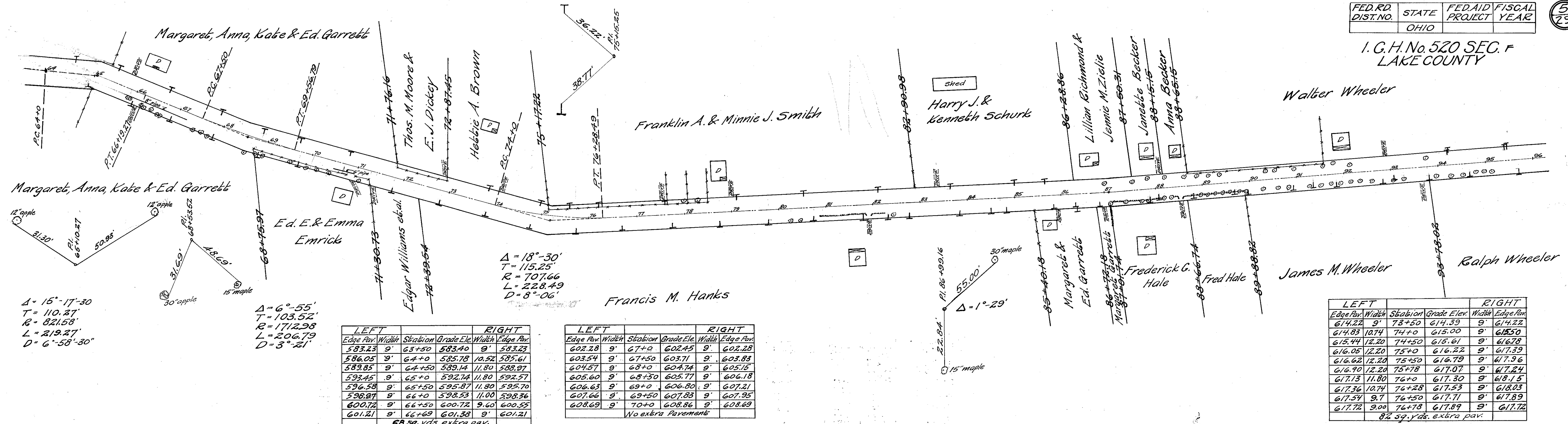

Δ = 15°-17'-30"
T = 110.37'
R = 821.58'
L = 219.27'
D = 6°-58'-30"

Δ = 6°-55'
T = 103.52'
R = 1712.98'
L = 206.79'
D = 3°-21'

Δ = 18°-30'
T = 115.25'
R = 707.66'
L = 228.49'
D = 8°-06'

Δ = 1°-29'
T = 55.00'
R = 100.16'
L = 10.84'

| LEFT | | RIGHT | |
|-----------|-------|---------|-------------|
| Edge Par. | Width | Station | Grade Elev. |
| 583.23 | 9' | 63+50 | 583.40 |
| 586.05 | 9' | 64+00 | 585.78 |
| 589.85 | 9' | 64+50 | 589.14 |
| 593.45 | 9' | 65+00 | 592.74 |
| 596.58 | 9' | 65+50 | 595.87 |
| 598.97 | 9' | 66+00 | 598.53 |
| 600.72 | 9' | 66+50 | 600.72 |
| 601.21 | 9' | 66+69 | 601.38 |

| LEFT | | RIGHT | |
|-----------|-------|---------|-------------|
| Edge Par. | Width | Station | Grade Elev. |
| 602.28 | 9' | 67+00 | 602.45 |
| 603.54 | 9' | 67+50 | 603.71 |
| 604.57 | 9' | 68+00 | 604.74 |
| 605.60 | 9' | 68+50 | 605.77 |
| 606.63 | 9' | 69+00 | 606.80 |
| 607.66 | 9' | 69+50 | 607.83 |
| 608.69 | 9' | 70+00 | 608.86 |

| LEFT | | RIGHT | |
|-----------|-------|---------|-------------|
| Edge Par. | Width | Station | Grade Elev. |
| 614.22 | 9' | 73+50 | 614.39 |
| 614.83 | 10.74 | 74+00 | 615.00 |
| 615.44 | 12.20 | 74+50 | 615.61 |
| 616.05 | 12.20 | 75+00 | 616.22 |
| 616.62 | 12.20 | 75+50 | 616.79 |
| 616.90 | 12.20 | 75+78 | 617.07 |
| 617.13 | 11.80 | 76+00 | 617.30 |
| 617.36 | 10.74 | 76+28 | 617.53 |
| 617.54 | 9.7 | 76+50 | 617.71 |
| 617.72 | 9.00 | 76+78 | 617.89 |

B.M. #18 Sta. 65+47
Spike in bel. pole
26' to L of P
Elev. = 598.35

B.M. #19 Sta. 68+75
Spike in 24" maple
29' to R of P
Elev. = 607.75

B.M. #20 Sta. 72+80
Spike in bel. pole
21' to R of P
Elev. = 613.50

B.M. #21 Sta. 77+58
Spike in bel. pole
21' on L of P
Elev. = 618.17

B.M. #22 Sta. 82+44
Spike in 48" oak
21' to R of P
Elev. = 621.27

B.M. #23 Sta. 86+94
Spike in 24" maple
18' to L of P
Elev. = 623.65

B.M. #24 Sta. 92+12
Spike in 24" maple
18' to R of P
Elev. = 625.01

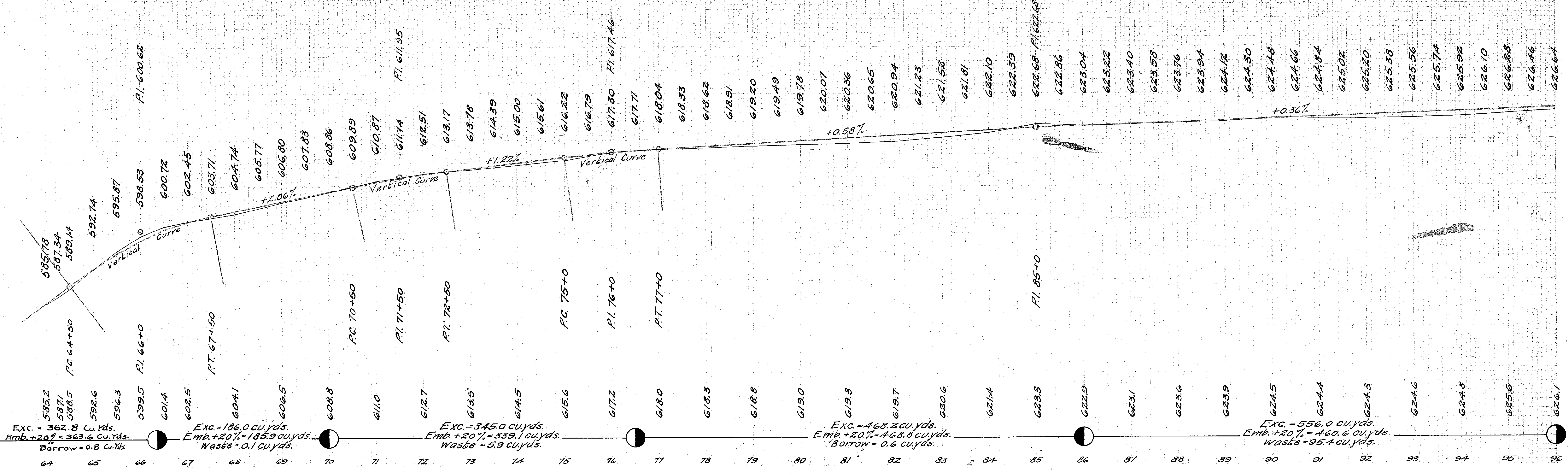

Exc. = 362.8 cu. yds.
Emb. +20% = 363.6 cu. yds.
Borrow = 0.8 cu. yds.

Exc. = 186.0 cu. yds.
Emb. +20% = 185.9 cu. yds.
Waste = 0.1 cu. yds.

Exc. = 345.0 cu. yds.
Emb. +20% = 339.1 cu. yds.
Waste = 5.9 cu. yds.

Exc. = 468.2 cu. yds.
Emb. +20% = 468.8 cu. yds.
Borrow = 0.6 cu. yds.

Exc. = 556.0 cu. yds.
Emb. +20% = 460.6 cu. yds.
Waste = 95.4 cu. yds.