

PLAN
 NOTES:
 1. PLANTING
 2. SEE PLAN FOR
 3. SEE PLAN FOR
 4. SEE PLAN FOR
 5. SEE PLAN FOR

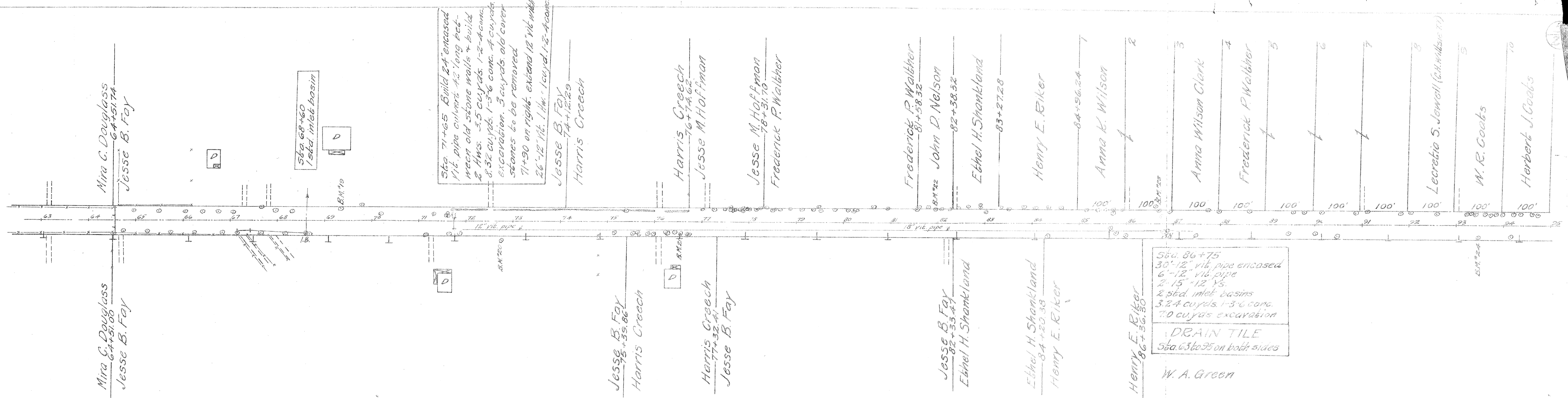

B.M. #18 Sta. 54+56
 on headwall
 26' to R of E
 Elev. = 612.62

B.M. #19 Sta. 69+34
 spike in 24" maple
 26' to L of E
 Elev. = 609.48

B.M. #20 Sta. 72+76
 spike in 18" Hickory
 40' to R of E
 Elev. = 606.06

B.M. #21 Sta. 76+42
 spike in 10" apple
 20' to R of E
 Elev. = 612.43

B.M. #22 Sta. 81+96
 spike in 24" elm
 29' to L of E
 Elev. = 612.93

B.M. #23 Sta. 86+62
 spike in 18" poplar
 39' to L of E
 Elev. = 612.65

B.M. #24 Sta. 93+45
 spike in 24" elm
 35' to R of E
 Elev. = 613.45

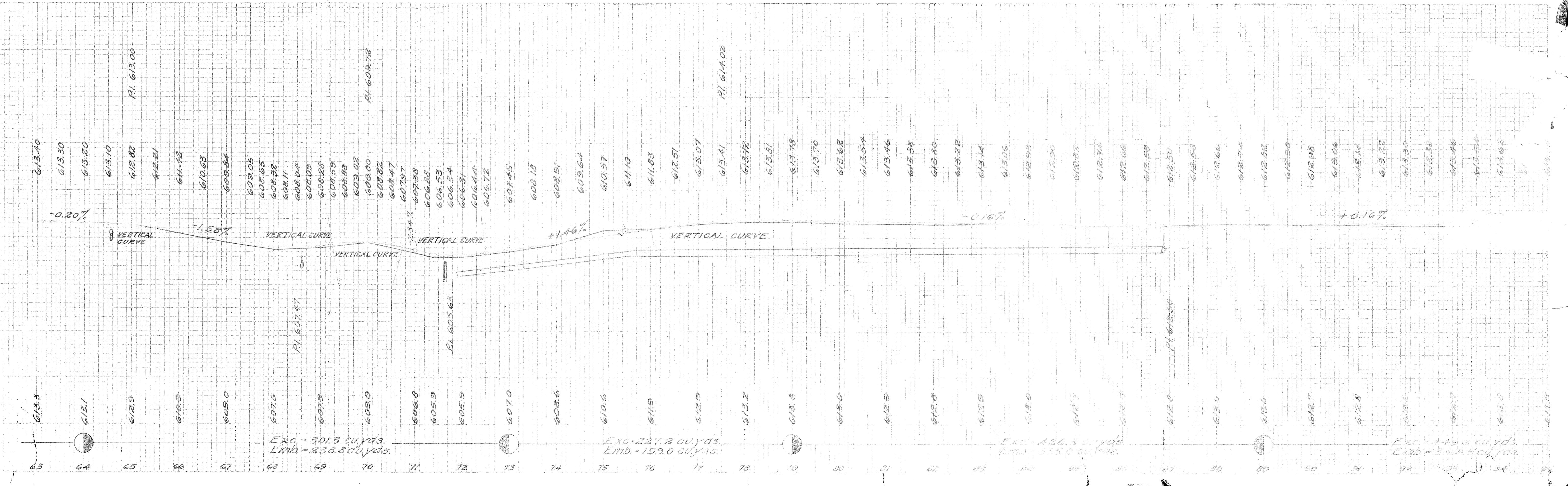

PROFILE
 NOTES:
 1. SEE PLAN FOR
 2. SEE PLAN FOR
 3. SEE PLAN FOR
 4. SEE PLAN FOR