

DATE
BY
NO.
NO.

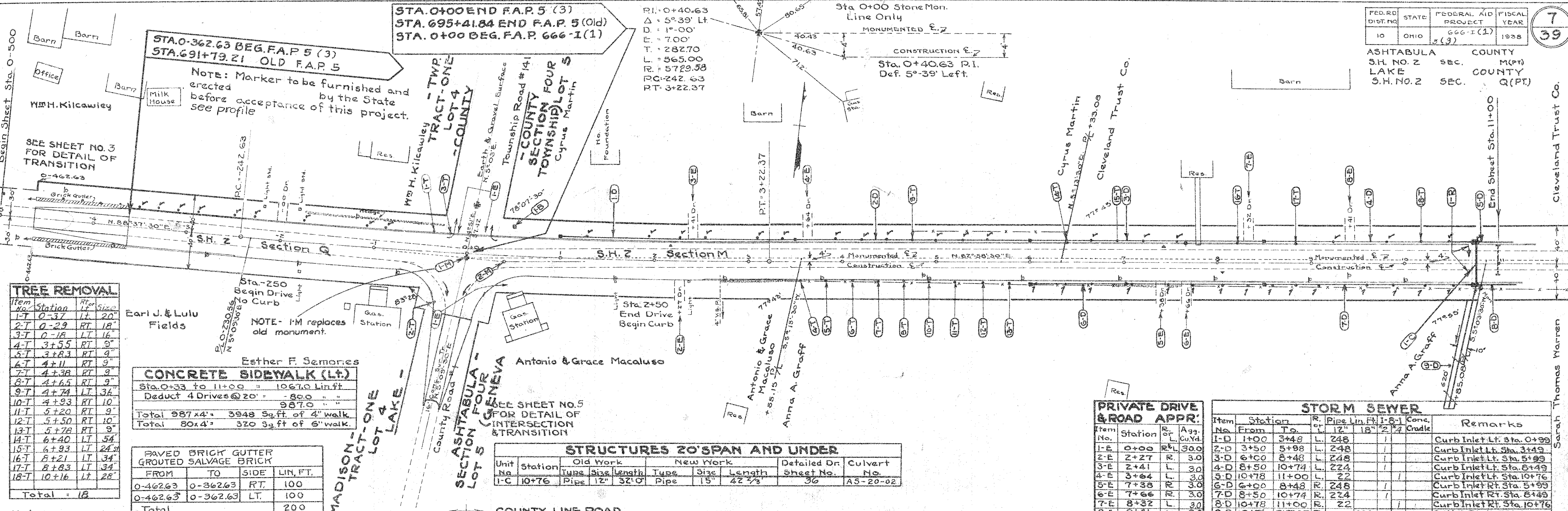

TREE REMOVAL

Item No.	Station	Rt.	Size
1-T	0+37	LT	20"
2-T	0+39	RT	18"
3-T	0+18	LT	16"
4-T	3+55	RT	9"
5-T	3+83	RT	9"
6-T	4+11	RT	9"
7-T	4+38	RT	9"
8-T	4+65	RT	9"
9-T	4+74	LT	36"
10-T	4+23	RT	10"
11-T	5+20	RT	9"
12-T	5+78	RT	10"
13-T	5+78	RT	9"
14-T	6+40	LT	54"
15-T	6+93	LT	24"
16-T	8+21	LT	34"
17-T	8+83	LT	34"
18-T	10+16	LT	28"

Total = 18

CONCRETE SIDEWALK (LT.)

Sta. 0+33 to 11+00 = 1067.0 Lin. Ft.
Deduct 4 Drives @ 20' = 80.0
987.0

Total 987' x 4" = 3948 Sq. ft. of 4" walk
Total 80' x 4" = 320 Sq. ft. of 6" walk.

PAVED BRICK GUTTER
GROUTED SALVAGE BRICK

FROM	TO	SIDE	LEN. FT.
0-462.63	0-362.63	RT.	100
0-462.63	0-362.63	LT.	100
Total			200

STRUCTURES TO SPAN AND UNDER

Unit No.	Station	Old Work		New Work		Detailed Dr. Sheet No.	Culvert No.
		Type	Size Length	Type	Size Length		
I-C	10+76	Pipe	12" 32' 0"	Pipe	15" 42' 2 1/2"	36	AS-20-02

PRIVATE DRIVE & ROAD APPR.

Item No.	Station	Rt.	Agg. Cu. Yd.
1-E	0+00	Rt.	30.0
2-E	2+27	Rt.	3.0
3-E	2+41	Lt.	3.0
4-E	3+64	Rt.	3.0
5-E	7+38	Rt.	3.0
6-E	7+38	Rt.	3.0
7-E	8+62	Lt.	3.0
8-E	9+41	Lt.	3.0
9-E	As directed		20.0
Total			71.0

STORM SEWER

Item No.	Station	Rt.	Pipe Lin. Ft.	1-8" Conc.	18" Cradle	Remarks
1-D	1+00	Lt.	248			Curb Inlet Lt. Sta. 0+39
2-D	3+50	Lt.	248			Curb Inlet Lt. Sta. 3+49
3-D	6+00	Lt.	248			Curb Inlet Lt. Sta. 5+99
4-D	8+50	Lt.	224			Curb Inlet Lt. Sta. 8+49
5-D	10+78	Lt.	22			Curb Inlet Lt. Sta. 10+76
6-D	2+00	Rt.	248			Curb Inlet Rt. Sta. 5+99
7-D	8+50	Rt.	224			Curb Inlet Rt. Sta. 8+49
8-D	10+78	Rt.	22			Curb Inlet Rt. Sta. 10+76
9-D	10+76	OUTLET				Outlet Rt. to Ditch
Total			1484	632	0.2	0.9

Note: - Trees marked thus are to remain in place. See Sheet 38 for Tree Protection Summary.

COUNTY LINE ROAD
(South Profile)
Concrete Surface Treated

COUNTY LINE ROAD
(North Profile)
(North)

TYPICAL SECTION ADJOINING THIS PROJECT AT STA. 0-362.63

MONUMENT BOX & BENCH MARK ASSEMBLY

Item No.	Station	Side	Mon. Box	Bench Mk
1-B	0+50	31' Lt.		1
1-M	0+00	51' Rt.	1	
2-M	0+40.63	7.0 Rt.	1	
Total			2	1

TRENCH REINFORCING

Item No.	Station	No. Bars	Size	Length	Weight Lbs.
1-R	10+76	44	3/8"	15'	689
Total					689 Lbs.

STORM SEWER OUTLET (STA. 10+76 RT.)

See Table for Quantities

DATE
BY
NO.
NO.

