

FED. RD. DIST. NO.	STATE	FED. AID PROJECT	FISCAL YEAR
10	OHIO	277	1922

44

I. C.H. No. 2 SEC. B  
LAKE COUNTY

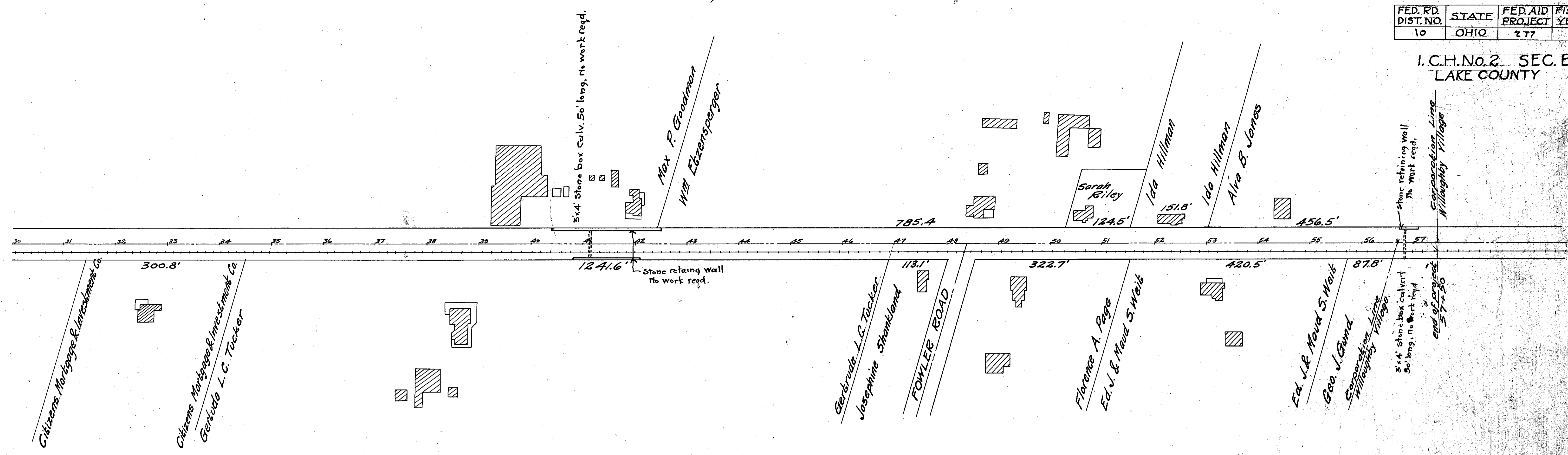

B.M. #6 N.W. corner of outer end of concrete  
step at stop 34  
Elev. 683.26 Sta. 38+12.7

B.M. #7 N.E. corner of east end of  
stone retaining wall east of stop 34  
Elev. 677.90 Sta. 42+05.

B.M. #8 Spike in north side of stump  
west of stop 35  
Elev. 686.31 Sta. 47+86.6

B.M. #9 N.W. corner of walk 12' east  
of pole W 498  
Elev. 690.37 Sta. 53+05

- 684.20
- 684.07
- 683.95
- 683.82
- 683.70
- 683.57
- 683.45
- 683.32
- 683.20
- 683.07
- 682.95
- 682.83
- 682.70
- 682.57
- 682.45
- 682.29
- 682.04
- 681.12
- 681.30
- 680.85
- 680.40
- 680.04
- 679.87
- 679.89
- 680.10
- 680.40
- 680.70
- 681.04
- 681.46
- 681.96
- 682.50
- 683.10
- 683.70
- 684.30
- 684.90
- 685.50
- 686.10
- 686.70
- 687.26
- 687.76
- 688.17
- 688.51
- 688.82
- 688.95
- 689.05
- 689.25
- 689.35
- 689.75
- 689.50
- 688.25
- 689.00
- 687.78
- 687.62
- 687.53
- 687.49
- 687.52
- 687.62

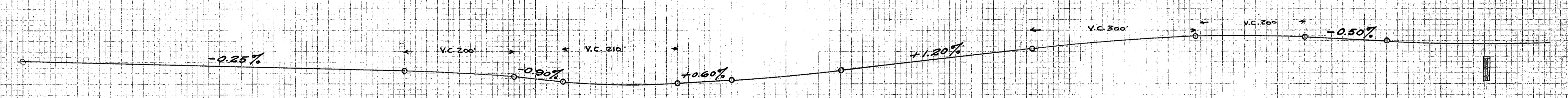

30 31 32 33 34 35 36 37 38 39 40 41 42 43 44 45 46 47 48 49 50 51 52 53 54 55 56 57 58

7-14  
SURVEY  
NOTE BOOK

ORIGINAL  
SURVEY  
NOTE BOOK