

THE UNDERGROUND UTILITIES ARE SHOWN ACCORDING TO INFORMATION FURNISHED BY THE UTILITIES CONCERNED AND THE STATE DOES NOT GUARANTEE THE ACCURACY THEREOF.

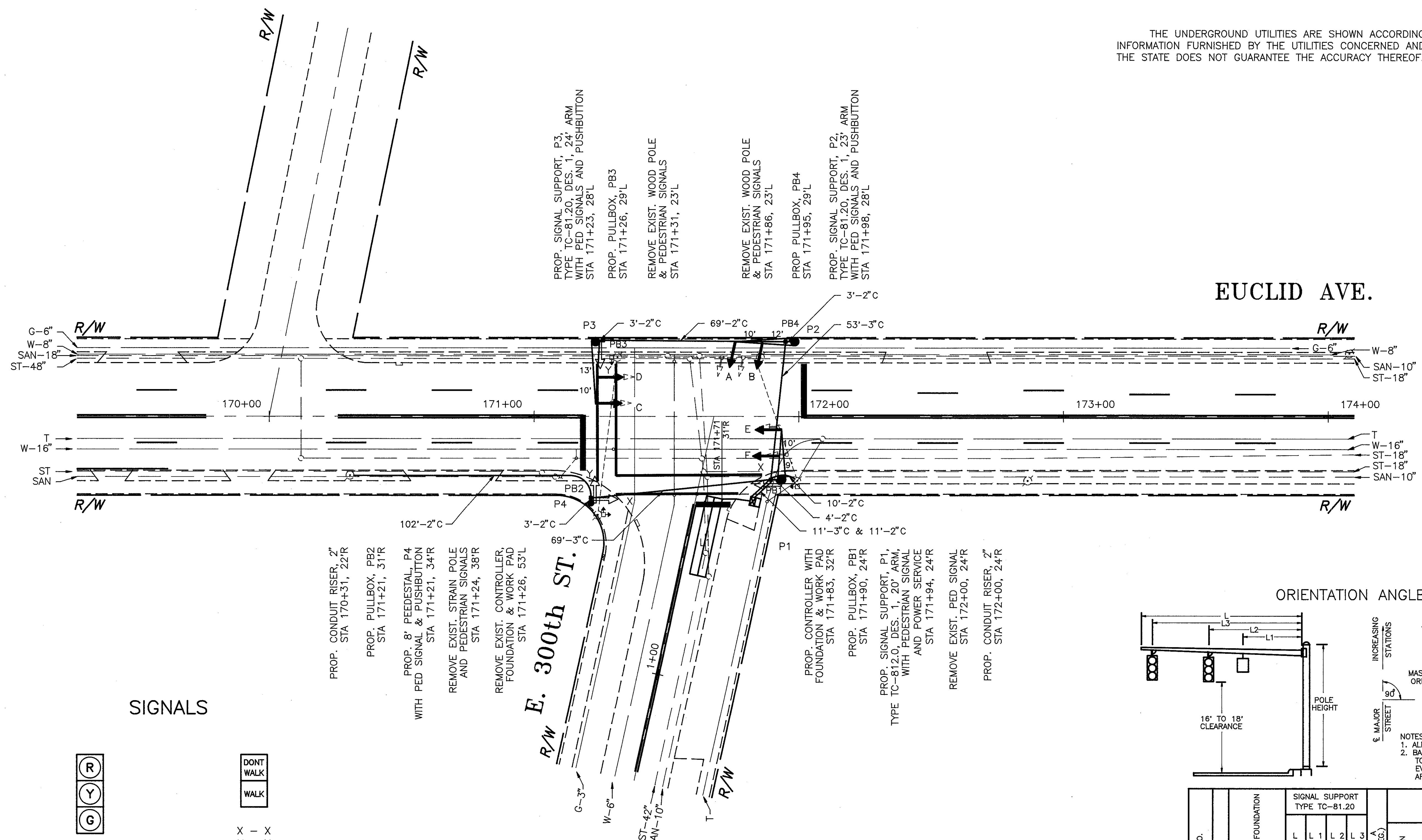

SIGNALS

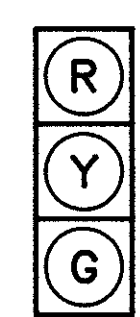

A, B, C, D, E & F
ALL HEADS ARE 12" POLY



X - X
Y - Y
TYPE "D-2"

ALL PAVEMENT MARKINGS BY OTHERS

ORIENTATION ANGLES

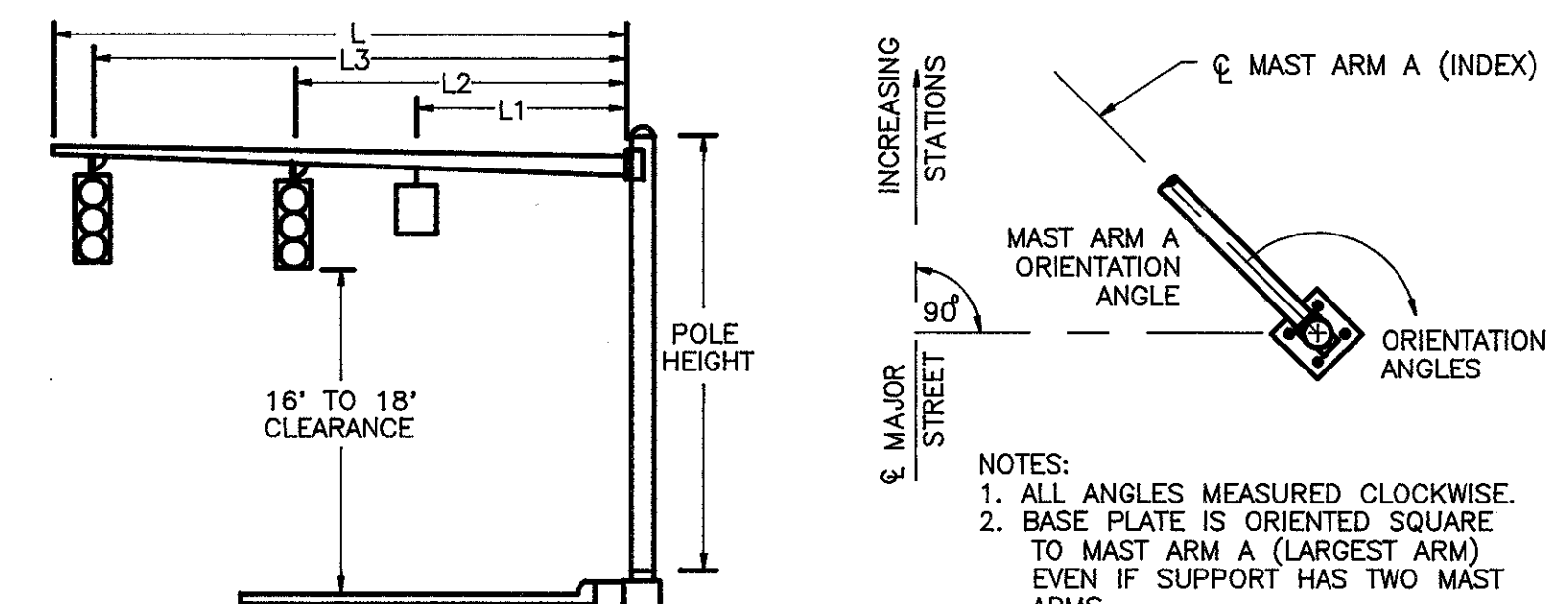

SUPPORT NO.	DESIGN NO.	FOUNDATION		SIGNAL SUPPORT TYPE TC-81.20				ORIENTATION ANG. (DEG.) FROM MAST ARM A					
		STATION	OFFSET	L (FT.)	L 1 (FT.)	L 2 (FT.)	L 3 (FT.)	MAST ARM A ANGLE (DEG.)	PEDESTRIAN SIGNALS	PEDESTRIAN PUSHBUTTON	POWER SERVICE	CABLE ENTRANCE	HANDHOLE
P1	1	171+94	24'R	20	9	19		0	180		90	90	180
P2	1	171+98	28'L	23	12	22		90					180
P3	1	171+23	28'L	24	13	23		0	270	0			180
P4	PED	171+21	34'R					0		0			180