

BM*69 Sta. 351+08
x on stone base West Gate Post
32' to L of \pm
Elev. 690.42

BM*70 Sta. 356+90
Arab. NE cor. N wall culvert
30.5' to L of \pm
Elev. 686.88

BM*71 Sta. 363+56
Spike in root 24" M
21.5' to L of \pm
Elev. 686.88

BM*72 Sta. 367+78
x on NE cor. N wall culvert
31' to L of \pm
Elev. 684.78

BM*73 Sta. 372+43
Spike in root 20" M
23' to L of \pm
Elev. 686.58

BM*74 Sta. 379+70
Spike in root 30" M
31' to L of \pm
Elev. 686.90

Grade line shown is \pm profile.

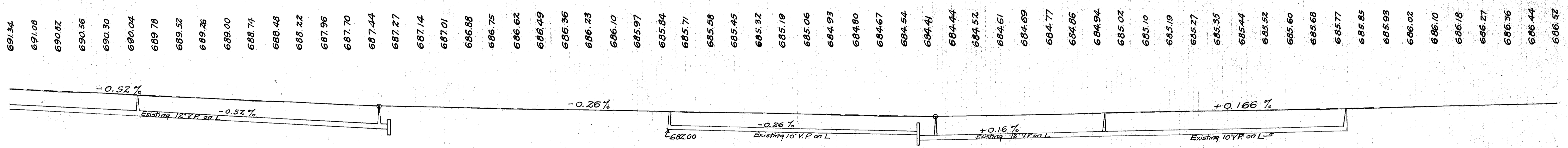

Station	Surface Elevation	Elevation
349	691.32	684.90
350	690.78	685.05
351	690.35	685.21
352	689.76	685.37
353	689.26	685.48
354	688.74	685.64
355	688.22	685.85
356	687.67	686.01
357	687.19	686.18
358	687.03	686.41
359	686.78	686.54
360	686.50	
361	686.28	
362	686.02	
363	685.74	
364	685.47	
365	685.24	
366	684.97	
367	684.62	
368	684.41	
369	684.57	
370	684.72	
371	684.90	
372	685.05	
373	685.21	
374	685.37	
375	685.48	
376	685.64	
377	685.85	
378	686.01	
379	686.18	
380	686.41	
381	686.54	

Exc. 686.7 cu. yds.
Emb+20% 549.2 cu. yds.
Waste 137.5 cu. yds.

Exc. 998.9 cu. yds.
Emb+20% 79.0 cu. yds.
Waste 919.9 cu. yds.

Exc. 1028.1 cu. yds.
Emb+20% 1.8 cu. yds.
Waste 1026.3 cu. yds.