

STATE OF OHIO
DEPARTMENT OF HIGHWAYS AND PUBLIC WORKS
DIVISION OF HIGHWAYS

FED. RD. DIST. NO.	STATE	FED. AID PROJECT	FISCAL YEAR
10	OHIO	5196	1929

S.H. NO. 2 SEC. G, H. & Mentor
LAKE COUNTY

S.R.-20 **8.84-14.13**

CLEVELAND-BUFFALO ROAD

S.H. NO. 2

SEC. G, H. & MENTOR PET. NO.

LAKE

COUNTY

PAINESVILLE & MENTOR TWPS.

FEB. 1929

INDEX

Title page	p. 1
Typical Sections	p. 2
Plan & Profile	p. 3 to 11
Gross-Sections	p. 12 to 41
Structures	p. 42-51
Summary of Quantities	p. 52
Special Structures	p. 51

The Standard Specifications of the State of Ohio, Division of Highways in force on date of contract will govern this improvement.
I hereby approve these plans and declare that the making of this improvement will not require the closing to traffic of the highway.

CONVENTIONAL SIGNS

State line	_____
County line	_____
Township line	_____
Section line	_____
Property line not fenced	_____
Center line	_____
City or Village line	_____
Fence	_____
Telephone or Telegraph	TTTTTTTTTT
Steam Railroad	_____
Electric line	_____
Guard Rail	_____
Drain Pipe - new	_____
Drain Pipe - old	_____

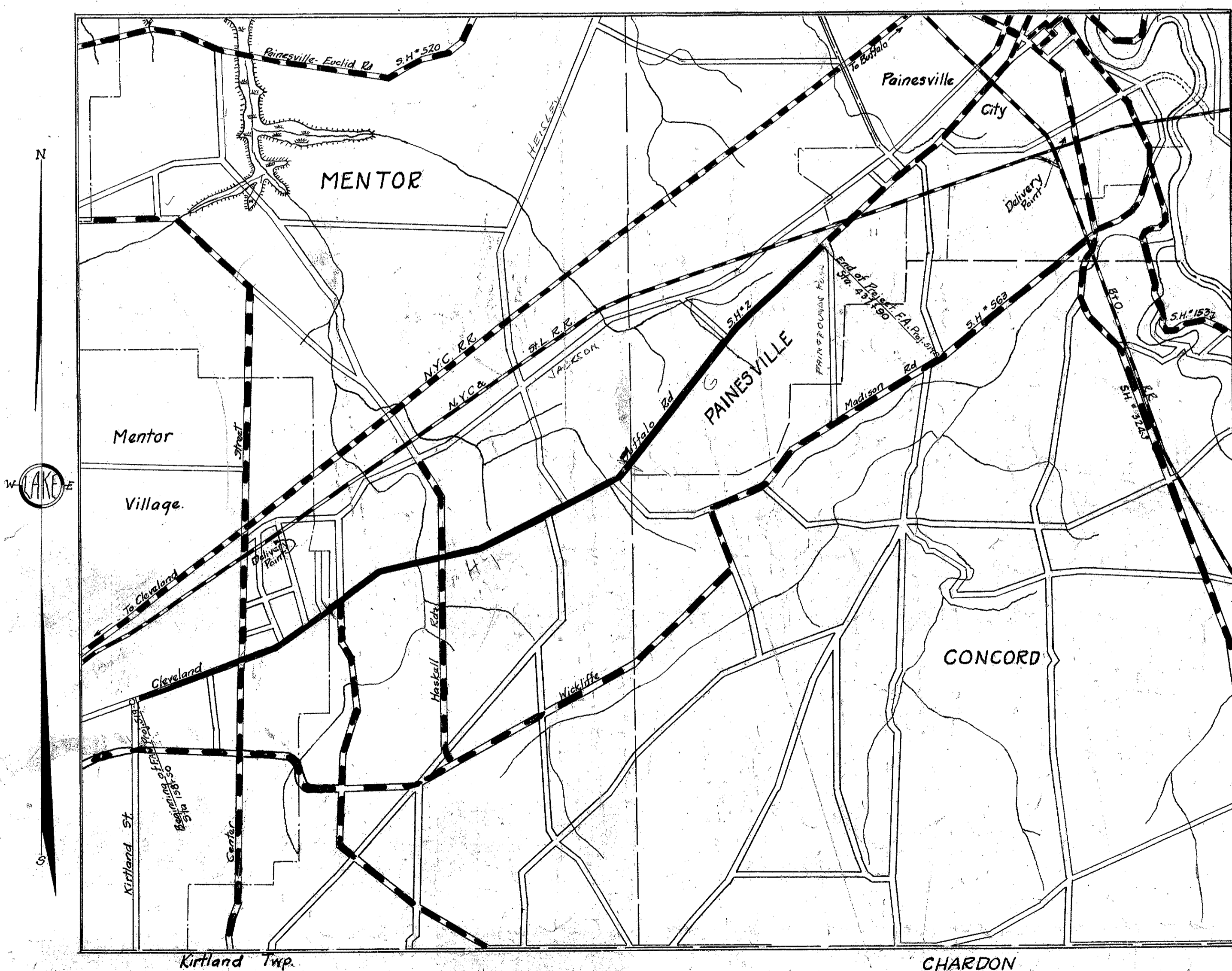

We, the Commissioners of Lake County hereby approve these plans and certify that the right of way 60 feet is available for the construction, maintenance and repair of the above highway.

C. M. Fawell
W. C. Reynolds
Chas. Mauchelle

Date, _____ County Commissioners.

LOCATION PLAN

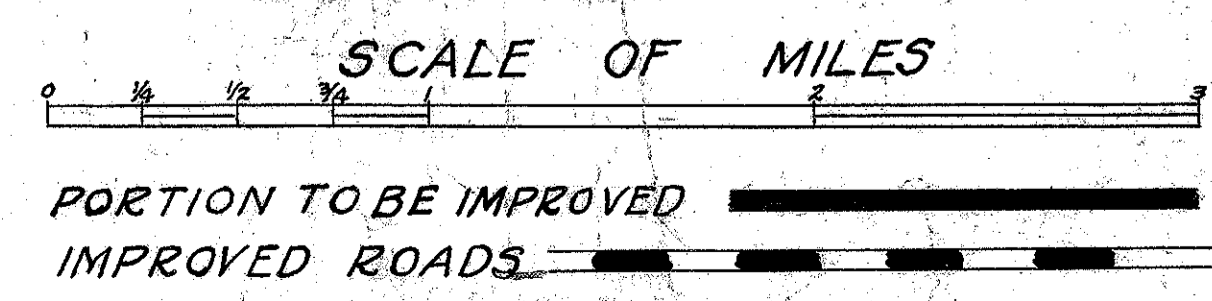

SCALES

Plan	1" = 100'
Profile (vertical)	1" = 10'
Profile (horizontal)	1" = 100'
Cross-sections	1" = 5'



- Approved: *A. B. Wilson*
Date, 3/27/29 Resident District Deputy Director.
- Approved: *L. A. Bruen*
Date, 3/27/29 Resident Division Deputy Director.
- Approved: *Mark W. Ruckey*
Date, 4/18/29 Deputy Director
Bureau of Construction.
- Approved: _____
Date, _____ Deputy Director
Bureau of Maintenance.
- Approved: _____
Date, _____ Deputy Director
Bureau of Bridges.
- Approved: *Robt. O. Beigsten*
Date, 4/26/29 Chief Engineer & First Assistant Director.
- Approved: *Robt. W. Waid*
Date, 4/26/29 State Highway Director.
- Recommended for Approval: _____
Date, _____ District Engineer
Bureau of Public Roads.
- Recommended for Approval: _____
Date, _____ Chief Engineer
Bureau of Public Roads.
- Approved: _____
Date, _____ Chief of Bureau.