

COLOR SEQUENCE CHART

SIGNAL NO	LENS	DIAL SETTINGS (Seconds)							
		24	3	19	3	15	3	10	3
		INTERVAL							
		1	2	3	4	5	6	7	8
1	R								(4)
	Y								(3)
	G								(4)
2	R								(3)
	Y								(3)
	G								(3)
3	R								
	Y								
	G								
4	R				(2)				
	Y				(1)				
	G								
5	R				(2)				
	Y				(1)				
	G								
6	R								
	Y								
	G								

Offset None (Isolated Intersection)  
 (1)  $\theta B$  to  $\theta C$  Clearance Interval  
 (2)  $\theta B$  to  $\theta D$  Clearance Interval  
 (3)  $\theta D$  to  $\theta A$  Clearance Interval  
 (4)  $\theta D$  to  $\theta B$  Clearance Interval

LAK-20/84/283/306/615

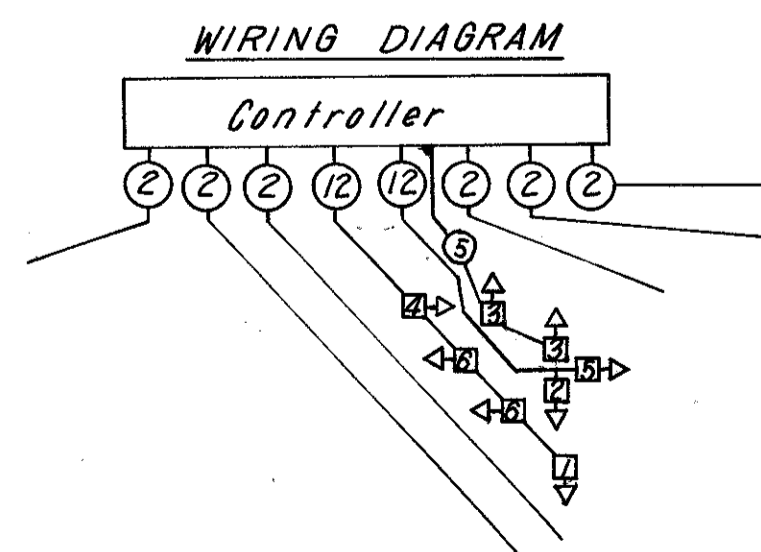
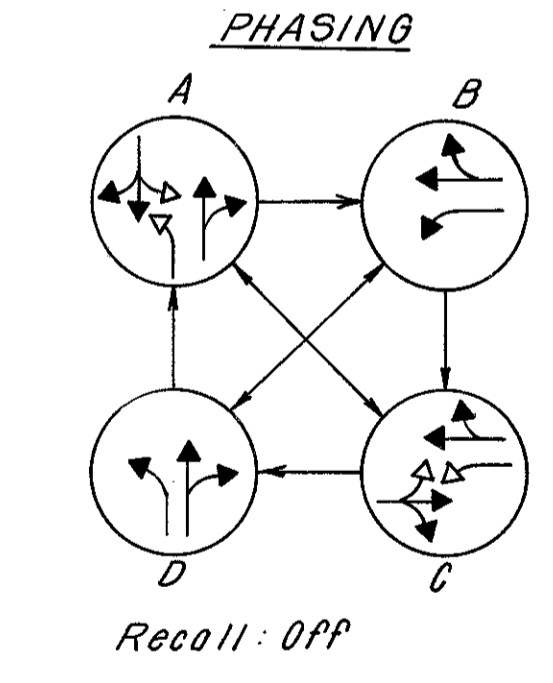
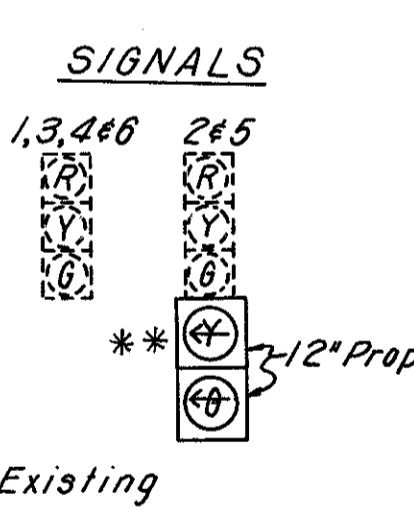
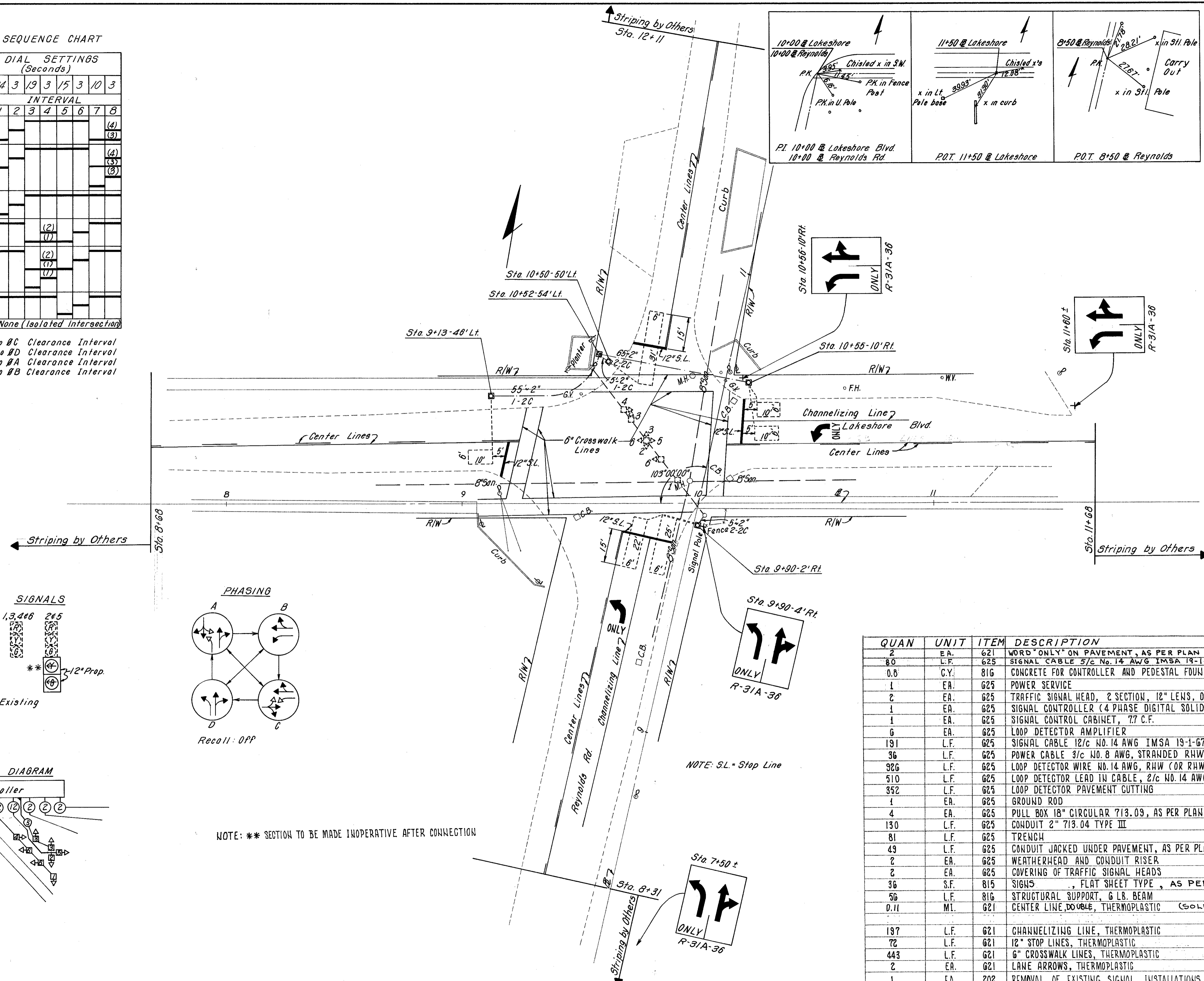

NOTE: \*\* SECTION TO BE MADE INOPERATIVE AFTER CONNECTION

NOTE: SL = Stop Line

CALC: P.C.B. 4-73  
 CHK: J.L.T. 4-73

QUAN	UNIT	ITEM	DESCRIPTION
2	EA.	G21	WORD "ONLY" ON PAVEMENT, AS PER PLAN
80	L.F.	G25	SIGNAL CABLE 5/8 NO. 14 AWG IMSA 19-1-67
0.8	C.Y.	816	CONCRETE FOR CONTROLLER AND PEDESTAL FOUNDATION
1	EA.	G25	POWER SERVICE
2	EA.	G25	TRAFFIC SIGNAL HEAD, 2 SECTION, 12" LENS, ONE WAY
1	EA.	G25	SIGNAL CONTROLLER (4 PHASE DIGITAL SOLID STATE TRAFFIC TIMER)
1	EA.	G25	SIGNAL CONTROL CABINET, 77 C.F.
6	EA.	G25	LOOP DETECTOR AMPLIFIER
191	L.F.	G25	SIGNAL CABLE 12/c NO. 14 AWG IMSA 19-1-67
36	L.F.	G25	POWER CABLE 3/c NO. 8 AWG, STRANDED RHW (OR RHW TYPE)
926	L.F.	G25	LOOP DETECTOR WIRE NO. 14 AWG, RHW (OR RHW TYPE)
510	L.F.	G25	LOOP DETECTOR LEAD IN CABLE, 2/c NO. 14 AWG, TWISTED PAIR, SHIELDED
352	L.F.	G25	LOOP DETECTOR PAVEMENT CUTTING
1	EA.	G25	GROUND ROD
4	EA.	G25	PULL BOX 18" CIRCULAR 7/3.09, AS PER PLAN
130	L.F.	G25	CONDUIT 2" 7/3.04 TYPE III
81	L.F.	G25	TRENCH
49	L.F.	G25	CONDUIT JACKED UNDER PAVEMENT, AS PER PLAN
2	EA.	G25	WEATHERHEAD AND CONDUIT RISER
2	EA.	G25	COVERING OF TRAFFIC SIGNAL HEADS
36	S.F.	815	SIGNS, FLAT SHEET TYPE, AS PER PLAN
56	L.F.	816	STRUCTURAL SUPPORT, 6 LB. BEAM
0.11	MI.	G21	CENTER LINE, DOUBLE, THERMOPLASTIC (SOLID-DASHED)
197	L.F.	G21	CHANNELIZING LINE, THERMOPLASTIC
72	L.F.	G21	12" STOP LINES, THERMOPLASTIC
443	L.F.	G21	6" CROSSWALK LINES, THERMOPLASTIC
2	EA.	G21	LANE ARROWS, THERMOPLASTIC
1	EA.	202	REMOVAL OF EXISTING SIGNAL INSTALLATIONS