

15/5

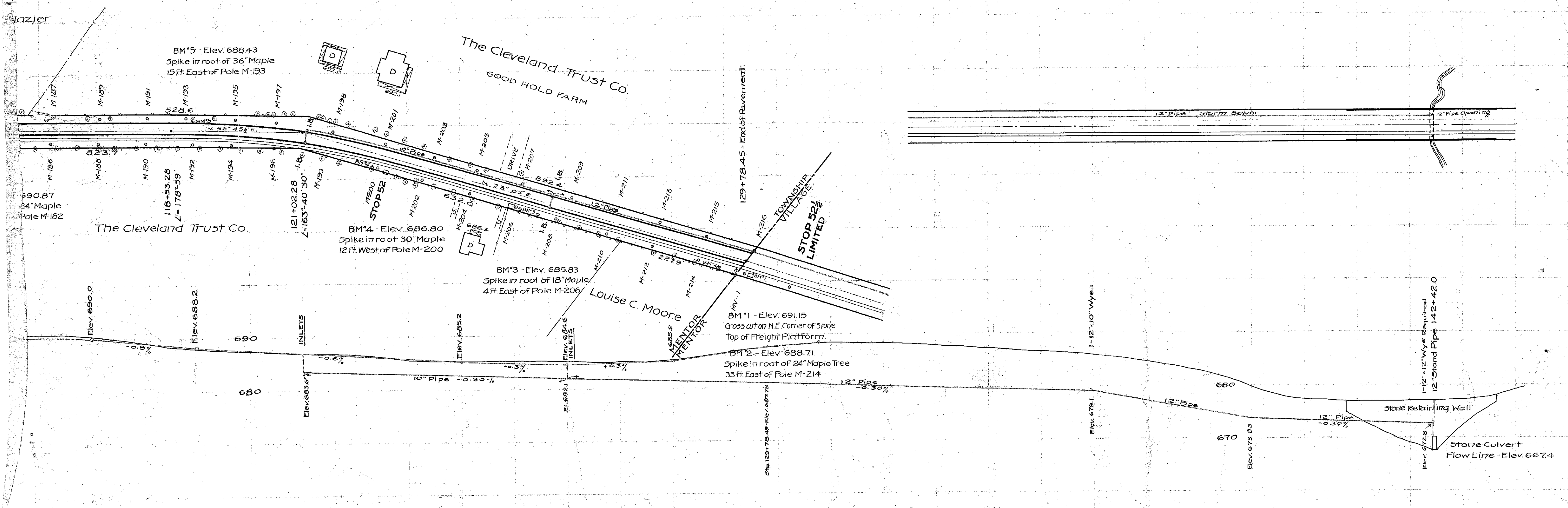

From Sta 120 to Sta 129+78.45  
 CUT = 685.4 Cu.Yds.  
 FILL = 348.1 "

Station	Cut (Cu.Yds.)	Fill (Cu.Yds.)
691.0	63.0	15.6
690.0	79.6	2.0
689.0	54.8	7.2
688.0	44.3	14.4
687.0	54.3	30.4
686.0	67.4	24.1
685.0	61.3	17.4
684.0	57.2	39.6
683.0	89.8	24.4
682.0	104.1	9.6
681.0	82.0	42.2
680.0	63.7	64.8
679.0	60.2	59.4
678.0	45.4	36.2
677.0	15.7	10.2