

S.H. (I.C.H.) No. 2 SEC. H. & MENTOR LAKE COUNTY  
Cleveland Trust Co.

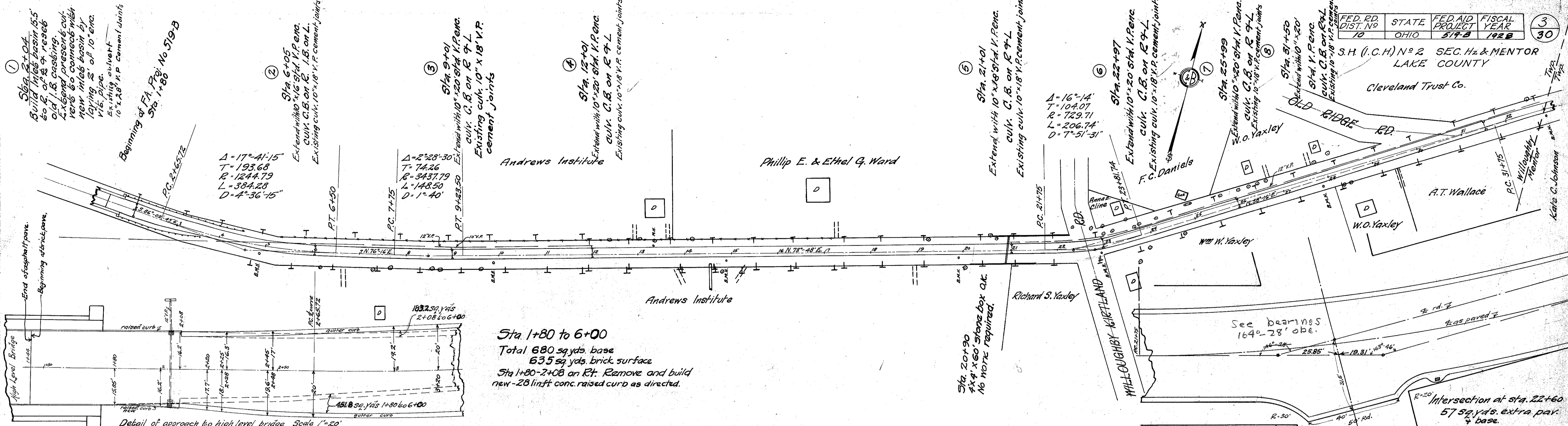

Sta 1+80 to 6+00  
Total 680 sq. yds. base  
635 sq. yds. brick surface  
Sta 1+80-2+08 on Rt. Remove and build new - 28' lift conc. raised curb as directed.

B.M. #1 Sta. 1+76  
x on N.E. cor. s. walk  
E. end of high level bridge  
Elev. = 653.10

B.M. #2 Sta. 6+18  
Spike in side 15" sycamore  
3.15' to R. of R.  
Elev. = 666.31

B.M. #3 Sta. 9+60  
Spike in side 18" W. cherry  
30' to R. of R.  
Elev. = 675.57

B.M. #4 Sta. 14+80  
Spike in side 20" W. cherry  
39' to R. of R.  
Elev. = 678.40

B.M. #5 Sta. 20+64  
x on S.W. cor. N. wall  
31' to L. of R.  
Elev. = 672.19

B.M. #6 Sta. 25+03  
x on E. end foundation to gas pump  
33' to L. of R.  
Elev. = 681.37

B.M. #7 Sta. 30+97  
Spike in roof of 12" walnut  
40' to L. of R.  
Elev. = 681.25

Grade line shown is 1/2" profile

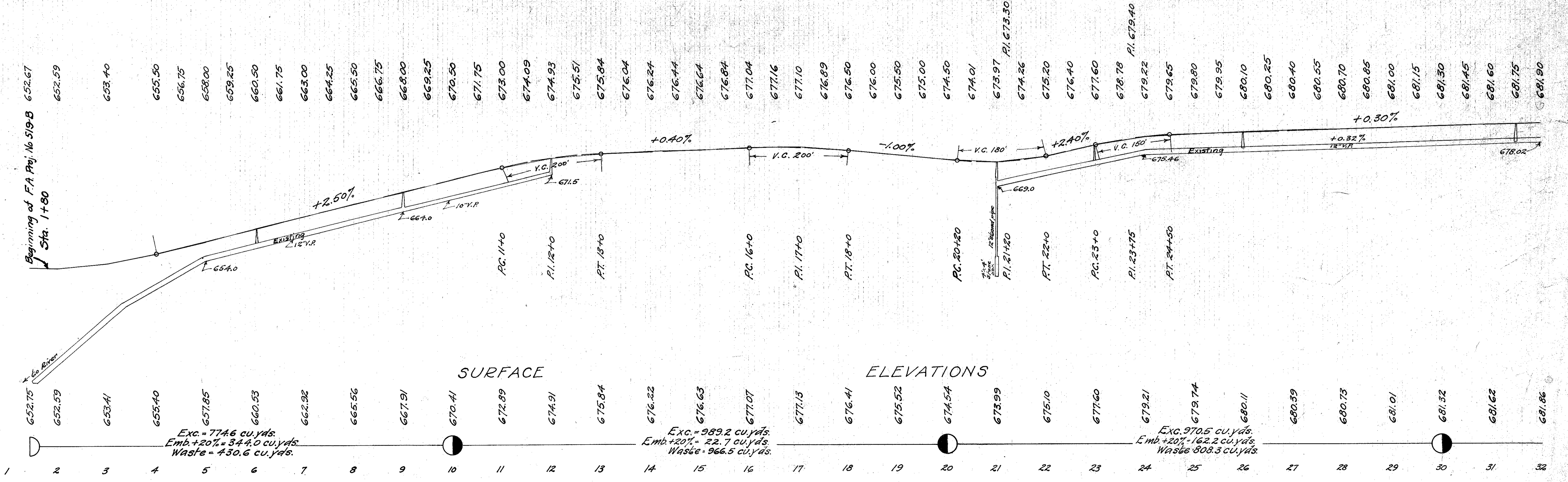

Exc. = 774.6 cu. yds.  
Emb. +20% = 344.0 cu. yds.  
Waste = 430.6 cu. yds.

Exc. = 989.2 cu. yds.  
Emb. +20% = 22.7 cu. yds.  
Waste = 966.5 cu. yds.

Exc. 970.5 cu. yds.  
Emb. +20% = 162.2 cu. yds.  
Waste = 808.3 cu. yds.