

CALC: ROB 7/77
CHK: WOB 8/77

- NOTES:**
- FOR EROSION CONTROL QUANTITIES SEE SHEET 28
 - FOR ADDITIONAL WORK LIMITS AND R/W SEE SHEET 28
 - FOR STORM SEWER DETAILS SEE SHEET 37
 - FOR EXIST. UNDERGROUND UTILITIES SEE SHEET 37 & 38
 - EXISTING STRUCTURE TO BE REMOVED BY OTHERS.
 - FOR REMOVAL OF NET AND LOOSE SOIL SEE SHEET 10

LEGEND
 PRESSURE RELIEF JOINT, TYPE A

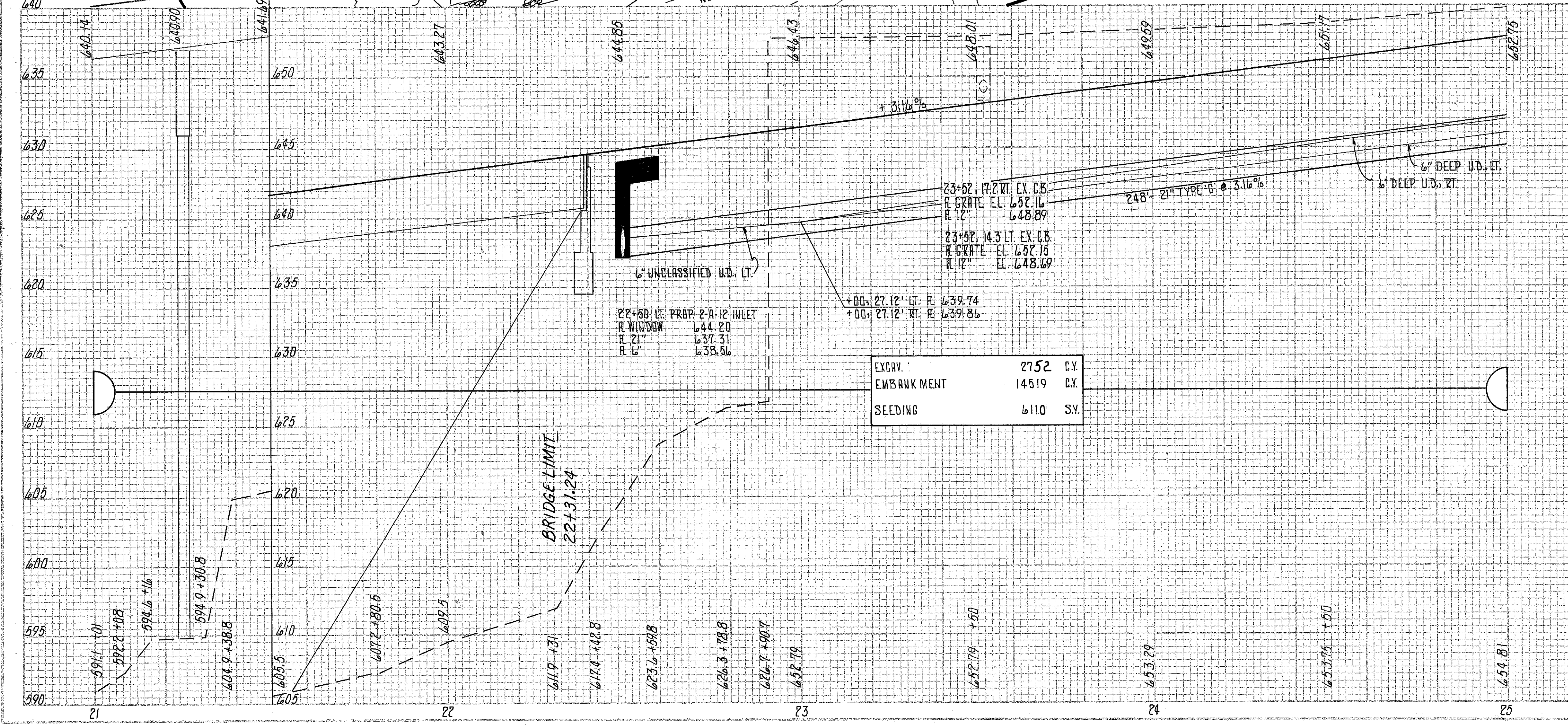
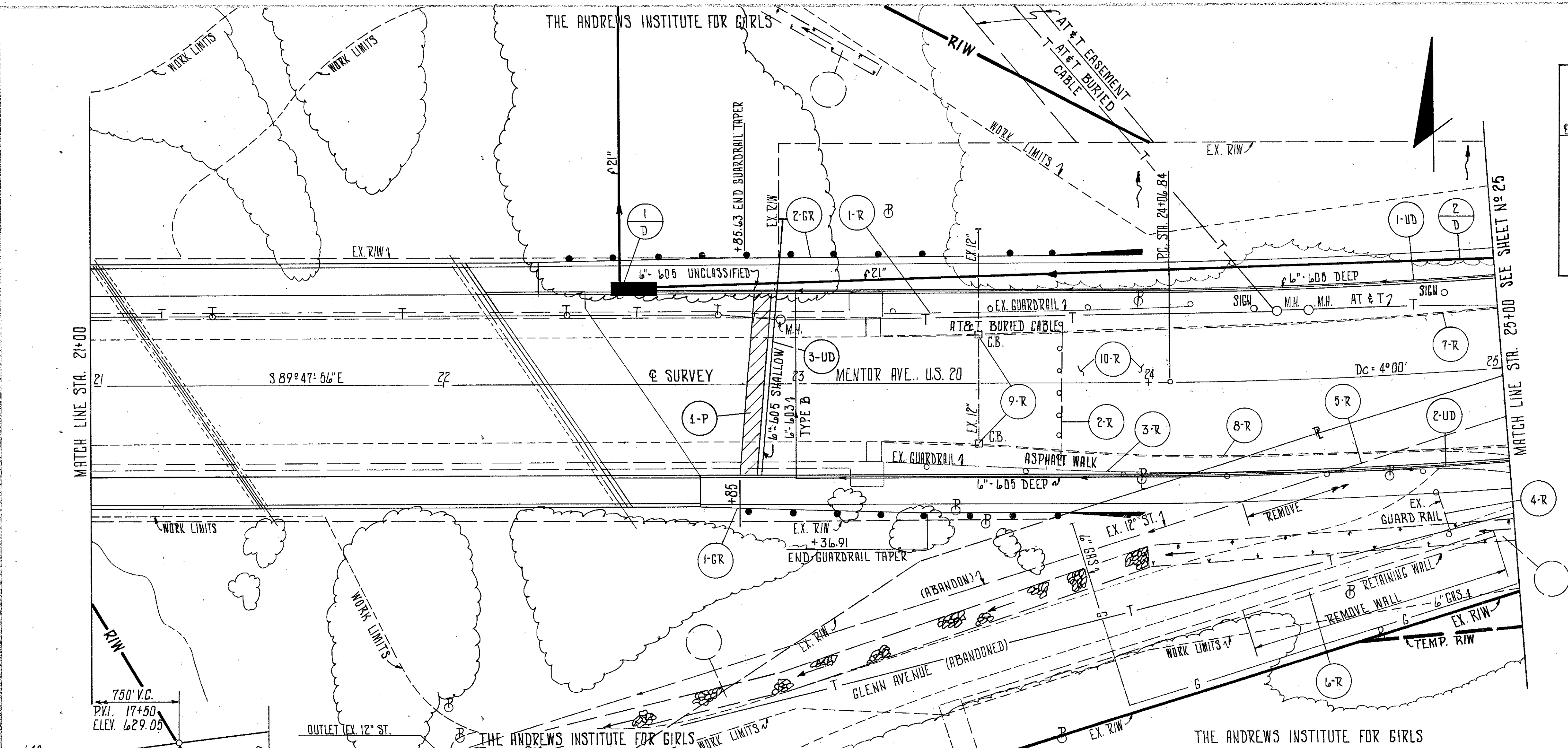

+ WITH BEDDING * 707.13

REF.	STATION TO STATION	SIDE	601 ROCK C.P. TYPE 'B' +	602 CONCRETE MASONRY	603 2" TYPE 'B' 2" TYPE 'C' 2" TYPE 'F' * BRANCHES & BRANCHES	604 INLET 2-A-12	605 6" U.D. DEEP 6" U.D. SHALLOW	6" U.D. SHALLOW	6" U.D. SHALLOW	SPEC. PRESSURE RELIEF JOINT TYPE A	
			C.Y.	C.Y.	L.F.	L.F.	L.F.	L.F.	L.F.	L.F.	
1-D	22+50	LT.	2	0.4							
2-D	22+50 TO 26+00	LT.			248						
1-UD	22+50 TO 25+00	LT.					200		50		
2-UD	23+00 TO 25+00	L&R			53	2	200				
3-UD	22+92 TO 22+98	L&R						75			
1-P	22+88	L&R								53	
TOTALS			2	0.4	53	248	100	1	400	75	50

REF.	STATION TO STATION	SIDE	202				606 BRIDGE TERMINAL ASSEMBLY TYPE 'J'	ANCHOR ASSEMBLY TYPE 'A'			
			PIPE REMOVED UNDER 24" CATCH BASIN REMOVED	PAVEMENT REMOVED	GUARDRAIL REMOVED	CURB REMOVED			STRUCTURE REMOVED		
			L.F.	EA.	S.Y.	L.F.	L.F.	LUMP	L.F.	EA.	EA.
1-GR	22+74.41 TO 23+99.41	RT.							87.5	1	1
2-GR	22+23.13 TO 23+98.13	LT.							137.5	1	1
1-R	23+25 TO 23+75	LT.				50					
2-R	23+75	L&R				37.5					
3-R	23+25 TO 24+75	RT.				150					
4-R	24+80	RT.				12.5					
5-R	24+25 TO 25+00	RT.	79								
6-R	24+25 TO 24+95	RT.						LUMP			
7-R	23+24 TO 25+00	LT.				175					
8-R	23+24 TO 25+00	RT.				178					
9-R	23+82	L&R	60	2							
10-R	23+24 TO 25+00	L&R			704						
TOTALS			139	2	704	250	353	LUMP	225	2	2