

LAKE COUNTY
LAK-20-5.60

NOTES

1. FOR PAVEMENT DETAILS SEE SHEET 43
2. FOR DRIVE PROFILES SEE SHEET 32 & 33
3. FOR DRIVE DETAILS SEE SHEET 6, 7 & 43
4. FOR STORM SEWER DETAILS SEE SHEET 32
5. FOR EXIST. UNDERGROUND UTILITIES SEE SHEET 32 & 33

CALC: ROB 7/77
CHK: W.D.B. 8/77

LEGEND

- ITEM 452 8" PLAIN PORTLAND CEMENT CONCRETE PAVEMENT
- ITEM 404 BUTT JOINT TYPE FEATHER AREA

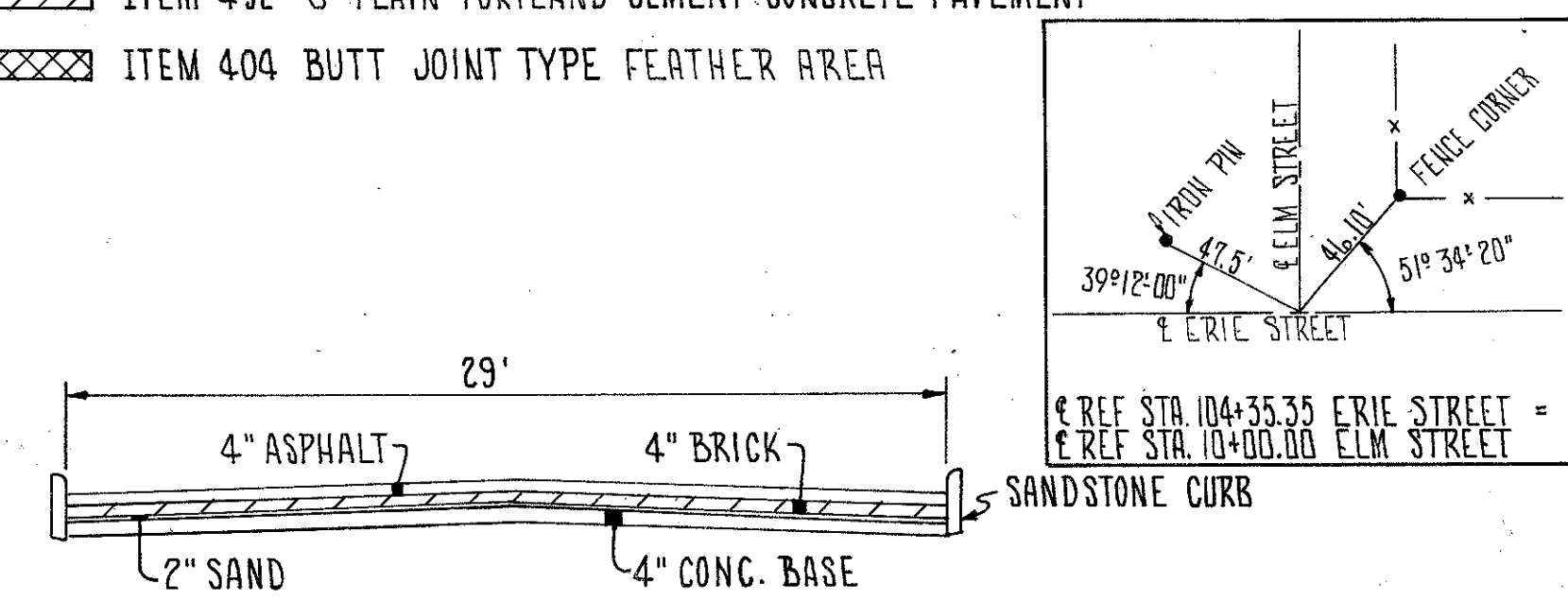

EXISTING TYPICAL-ERIE STREET

* INCLUDES CONCRETE DRIVE APPROACHES

REF.	STATION TO STATION	SIDE	202		603	604	604	604	604
			CURB REMOVED	SIDEWALK REMOVED					
			L.F.	S.F.	L.F.	EA.	EA.	EA.	EA.
1-D	104+34	LT.				1			
2-D	104+36	RT.				1			
3-D	103+83 TO 103+93	LT.			8				1
4-D	103+83 TO 103+93	L & R			44			1	
5-D	103+93	LT.					1		
1-R	102+00 TO 104+19	LT.	251						
2-R	104+49 TO 106+00	LT.	184						
3-R	102+00 TO 106+00	RT.	400						
4-R	102+00 TO 104+17 *	LT.		1415					
5-R	104+03 TO 104+08	LT.		84					
6-R	104+50 TO 104+80	LT.		145					
TOTALS			835	1644	52	2	1	1	1

REF.	STATION TO STATION	SIDE	202				301
			CONC. FND. REMOVED	SIDEWALK REMOVED	WEARING COURSE REMOVED	PAVEMENT REMOVED	
			EA.	S.F.	S.Y.	S.Y.	C.Y.
1-P	103+83	L & R					8
7-R	102+92	LT.	1				
8-R	103+87	LT.	1				
9-R	103+90 TO 104+47	RT.				87	
10-R	106+00 TO 106+10	L & R			32		
11-R	9+32.5 TO 9+42.5 ELM ST.	L & R			33		
12-R	102+52 TO 102+69	RT.		80			
13-R	103+00 TO 103+09	RT.		40			
14-R	103+51 TO 103+60	RT.		45			
15-R	103+98 TO 104+16	RT.		95			
16-R	105+00 TO 105+20	RT.		100			
17-R	105+67 TO 105+76	RT.		50			
TOTALS			2	410	65	87	8

EXCAV. 375 C.Y.
EMBANK. 42 C.Y.
SODDING 519 S.Y.

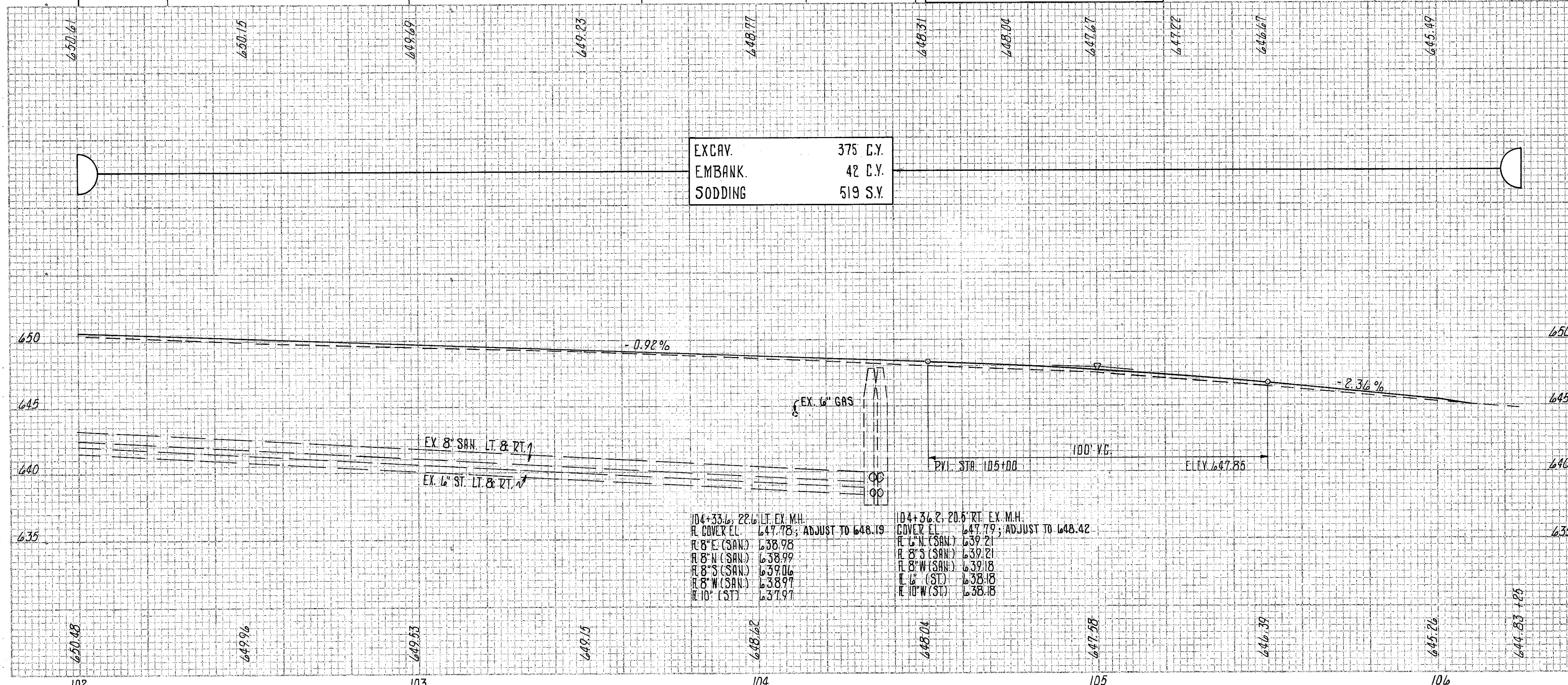

104+33.22 LT. EX. M.H. COVER EL. 647.78; ADJUST TO 648.19
 R 8" E (SAN) 638.98
 R 8" N (SAN) 638.99
 R 8" S (SAN) 639.06
 R 8" W (SAN) 638.97
 R 10" (ST) 637.97

104+36.20 RT. EX. M.H. COVER EL. 647.79; ADJUST TO 648.42
 R 8" E (SAN) 639.21
 R 8" S (SAN) 639.21
 R 8" W (SAN) 639.18
 L 8" (ST) 638.18
 R 10" (ST) 638.18