

LAKE COUNTY
S.H. 2 SEC. Q (Pt)

CURVE DATA

Δ = 15°-25'-30"
T = 387.99'
R = 2864.79'
L = 771.29'
D = 2°-00'
E = 26.18'

H.C. & NELLIE
G. BERRY

WM. H. KILCAWLEY

EXISTING STRUCTURE DATA

Type - Concrete Beam Bridge
Span - 45' f. to f. Abuts.
Rdwy - 40'-2" plus 2 @ 2'-6" Sidewalks
Loading - H-15-33
Skew - None
Surf. Course - 3 1/2" Concrete
App. Slabs - 18' x 20' 2" wide
Alignment - 2° 00' Curve Lt.
Superelevation - .042' / ft.

PROPOSED WORK
Remove existing Sidewalks & Lip Curbs and replace with new concrete Widening & Curb. Roadway = 44'-0"

DRIVES & APPROACHES

Item	Station	Side	T-71 Sq. Yds	I-17 Cu. Yds.	Deduct Curb Lin. Ft.	T-71 Sq. Yds	DETAIL SHEETING
D-1	653+20	Lt.	11.9	1.1	22		
D-2	654+10	Lt.	11.9	1.1	22		
D-3	655+38.26	Rt.	32.1	36.9	50		6
D-4	655+66.26	Lt.	91.3		156	117.6	4
D-5	656+25	Rt.	91.1	13.7	134.4		3
D-6	660+10	Rt.	90.2	13.0	141		3
TOTAL			334.5	65.8	525.4	117.6	
DUAL	D-6	660+10	Rt.	31.5	4.3	33	

SIDEWALK T-71

STATION TO STATION	LIN. FT.	DEDUCTIONS	SIDE LENGTH	WIDTH	SQ. FT.
653+00	654+50	150	2D: @ 14.5' = 29	Lt	121 4'-6" 544.5

STORM SEWERS

Item No	Side Station	To Station	Pipe Lin. Ft.	Outlet Pipe Lin. Ft.	Pipe Under Pavt. Lin. Ft.	24" Tee	12" Tee	24" Catch Basins	13X No. G.	Man Holes Each	Class. Conc.
SS-1	Lt.	653+00	654+45	143							
SS-2	Lt.	654+40	654+40	6							
SS-3	Lt.	654+45	656+13	102	26			32		2	
SS-4	Lt.	658+64	660+43	162		16					0.1
SS-5	Lt.	660+48	660+48	6						1	
SS-8	Lt.	657+92	657+92	18						1	
Total T-71			192	245	26	16		32	1	3	2
SS-7	Rt.	662+65	664+00	134							0.1
SS-6	Lt.	662+60	662+60	6						2	
TOTAL DUAL			140	29				2	2	1	

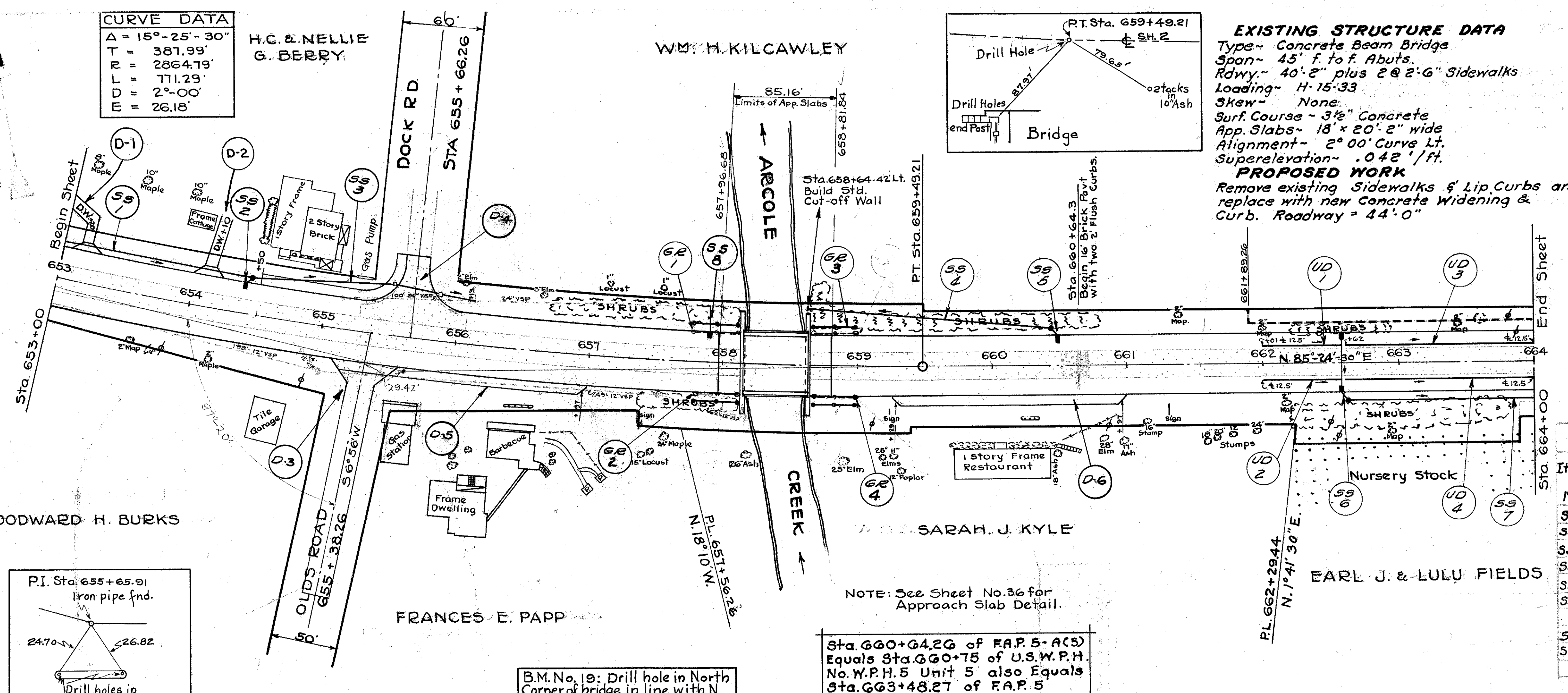

NOTE: See Sheet No. 36 for Approach Slab Detail.

Sta. 660+64.26 of F.A.P. 5-A(5) Equals Sta. 660+75 of U.S.W.P.H. No. W.P.H. 5 Unit 5 also Equals Sta. 663+48.27 of F.A.P. 5

B.M. No. 19: Drill hole in North Corner of bridge in line with N. rail 23' L. of Sta. 658+63.5 Elevation = 659.560

Excavation = 929 Cu. Yds
Embankment = 603 Cu. Yds.

Removal & Disposal of Exist. Brick Wearing Course
Sta. 660+64.3 to 661+75. (110.7 x 18) = 196.8 Sq. Yds

Removal & Disposal of Exist. 2' flush curb
Sta. 660+64.3 to 661+00 Left = 35.7 Lin. Ft.
Sta. 660+64.3 to 661+75 Right = 110.7 Lin. Ft.
Total = 146.4 Lin. Ft.

Extra 1/4" Insulation Course (46.4 x 2) = 32.5 Sq. Yds.
Extra B-50 Pavt. (at curb) (Base & Leveling Course) = 32.5 Sq. Yds.
Extra B-50 Level Course (to build up center) = 22 Cu. Yds.

REMOVAL OF EXISTING STRUCTURES

Item No	Side Station	Structure	DIST.	Lump
RS-1	Rt.	654+89 Catch Basin	21.3	1
RS-2	Rt.	655+00 Manhole	34.5	1
RS-3	Lt.	655+13 Manhole	22.5	1
RS-4	Rt.	657+53 Manhole	27	1
RS-5	Rt.	658+15 Headwall	42.2	1
TOTAL T-71			5	

PIPE UNDERDRAINS Full Depth Porous Backfill.

Item No	Side Station	To Station	6" Perfor. C.M. Pipe Lin. Ft.	
UD-1	Lt.	662+01	662+60	58
UD-2	Rt.	662+01	662+60	58
UD-3	Lt.	662+62	664+00	138
UD-4	Rt.	662+62	664+00	138
TOTAL DUAL			392	

NOTE: Flow Line of 6" Pipe Underdrains Same as for Storm Sewers

REMOVAL OF EXISTING PAVEMENT REPLACEMENT

Station	From To	Length Lin. Ft.	Width Lin. Ft.	Sq. Yds	8" B-71 Sq. Yds
DUAL	662+56	662+64	8	20	17.8
	655+66	Dock Rd (See Sheet 4)			255
	660+34.3	660+64.3	30	10'-1"	33.6
T-71	Total			288.6	

SEALING (ONLY) EDGE EXIST. PAVT.

Station To Station	Side	Lin. Ft.
653+00	657+97	R&L 994
658+82	660+64.3	R&L 364
TOTAL T-71		1358
1 Crossover 1(20x2)		40
660+64.3	664+0	R&L 1348
TOTAL DUAL		1383

GUARD RAIL

Item No	Station From To	Side	Remove & Rebuild Lin. Ft.
GR-1	657+80	658+12	L 32
GR-2	657+80	658+12	R 32
GR-3	658+67	658+99	L 32
GR-4	658+67	658+99	R 32
TOTAL T-71			128

PIPE REMOVED

Station From To	Side	Lin. Ft.	Pipe 12" 24"
653+00	655+00	Rt.	198
654+89	655+00	Rt.	14
655+00	657+53	Rt.	249
655+13	656+13	Lt.	100
657+53	658+45	Rt.	62
T-71 TOTAL			523

