

LAKE COUNTY  
 S.H. 2 SEC. Q (Pt)

Walk to house  
 Lt. of Sta. 637+65  
 Remove 25' of pres. walk = 50 cu yds  
 Build 10' of new walk = 20 cu yds

Note: Sta. 631+40 to 638+14  
 Inside edge of sidewalk 32.5 from c/c

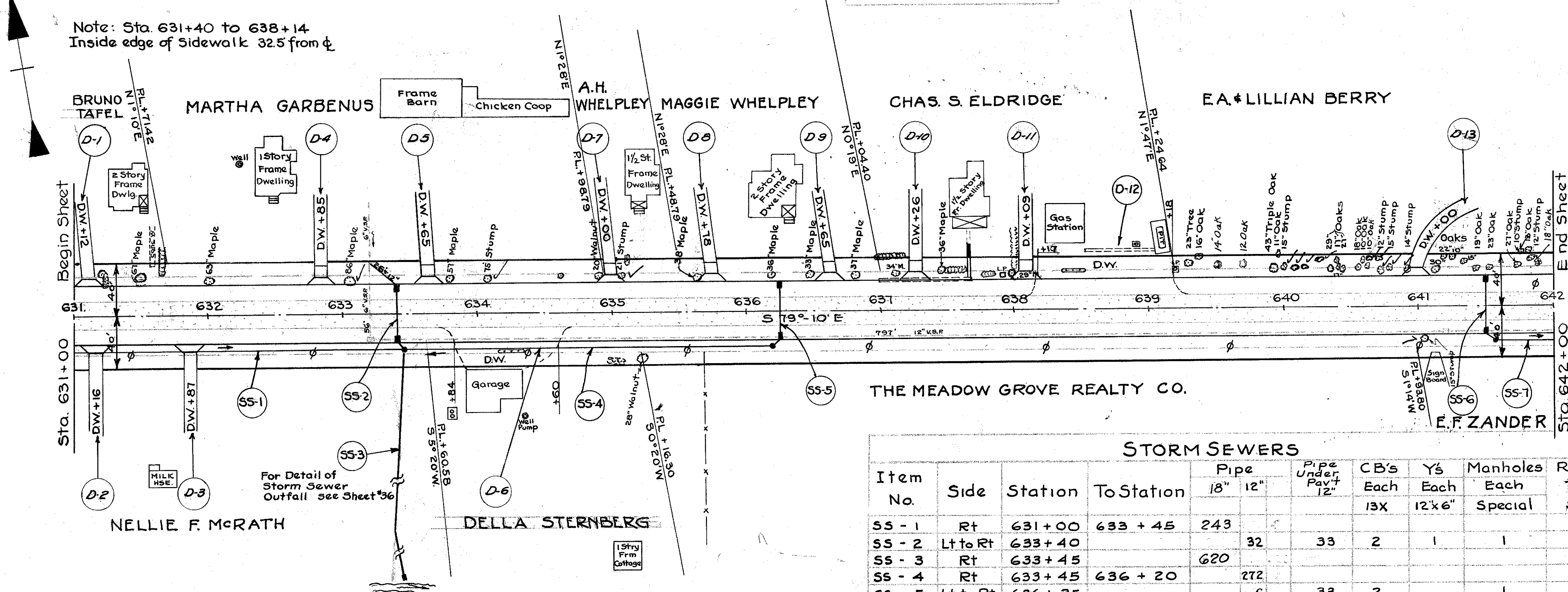

Item	Station	Side	T-70 Sq. Yds	I-17 Cu. Yds	Deduct Curb Lin. Ft.	Detail Sheet No.
D-1	631+12	Lt.	11.9	2.0	22	37
D-2	631+16	Rt.	11.9	1.1	22	
D-3	631+87	Rt.	11.9	1.1	22	
D-4	632+85	Lt.	21.3	0.3	22	
D-5	633+65	Lt.	21.3	0.3	22	
D-6	634+22	Rt.	55.2	7.5	82	3
D-7	635+00	Lt.	21.3	0.3	22	
D-8	635+18	Lt.	21.3	0.3	22	
D-9	636+65	Lt.	21.3	0.3	22	
D-10	637+26	Lt.	21.3	0.3	22	
D-11	638+09	Lt.	21.3	0.3	22	
D-12	638+67	Lt.	73.3	10.1	107	3
D-13	641+00	Lt.	11.9	2.0	22	37
Totals			325.2	25.9	431	

Item No.	Side	Station	To Station	Pipe		Pipe Under Pav't	CB's	Ys	Manholes	Riprap	Class 'C'
				18"	12"						
SS-1	Rt	631+00	633+45	243			13X	12'x6"	Special	Sq. yds	Cu. Yds
SS-2	Lt to Rt	633+40			32	33	2	1	1		
SS-3	Rt	633+45		620						5	2.4
SS-4	Rt	633+45	636+20		272						
SS-5	Lt to Rt	636+25			6	33	2		1		
SS-6	Lt to Rt	641+50			6	33	2		1		
SS-7	Rt	641+55	642+00		44						
Total				863	360	99	6	1	3	5	2.4

Station	To Station	Lin. Ft.	Deductions	Net Length	Width	Sq. Ft.
631+00	642+00	1100	2 Dr. @ 145' = 29' 7 Dr. @ 10' = 70' 1 Dr. @ 101' = 101'	900	4.5	4050
Walk to house Lt of Sta. 637+65 - 20' = 4050 + 20 = 4070						
SIDEWALK REMOVED						
636+99	637+66	67	None	67	3	201
Walk to house Lt of Sta. 637+65 - 50' = 201 + 50 = 251						

Station	Item	Dist. from c/c
633+20	Brick Inlet	18.5 Rt.
641+20	"	18.3 Rt.
Total = 2		

B.M. No. 15: Spike in South West root of 63' Maple tree, 26.5' left of sta. 631+91. Elevation = 664.015

Excavation 536 Cu. Yds.  
 Embankment 539 Cu. Yds.

Station	Side	Dist from c/c	Size	Kind
633+05	Lt	23'	86"	Maple
634+07	Lt	25'	75"	Stump
639+97	Lt	30'	15"	Stump
640+05	Lt	29.5'	11"	Stump
640+16	Lt	29.5'	10"	Stump
640+25	Lt	36'	10"	Stump
640+60	Lt	30.5'	11"	Stump
635+06	Lt	28'	21"	Stump
640+68	Lt	36'	11"	Stump
640+72	Lt	29'	12"	Stump
640+77	Lt	29.5'	15"	Stump
640+93	Lt	27'	14"	Stump
641+03	Rt	32'	15"	Stump
641+74	Lt	39'	10"	Stump
641+78	Lt	34'	12"	Stump
Total = 15				Indicated thus: <input checked="" type="checkbox"/>

Station From	Station To	Length	Width	Sq. Yds	8" B-71 Sq. Yds.
633+16	633+24	8	20	17.8	17.8
633+36	633+44	8	20	17.8	17.8
636+21	636+29	8	20	17.8	17.8
641+46	641+54	8	20	17.8	17.8
Total				71.2	71.2

Station	To Station	Side	Lin. Ft.
631+00	642+00	Lt & Rt	4400
4 Crossovers		4x(20x2)	160
Total			4560

Station	To Station	Side	Lin. Ft.
633+20	641+19	Lt to Rt	56
633+22	641+19	Rt	797
641+23	642+00	Rt	77
Total			56 874

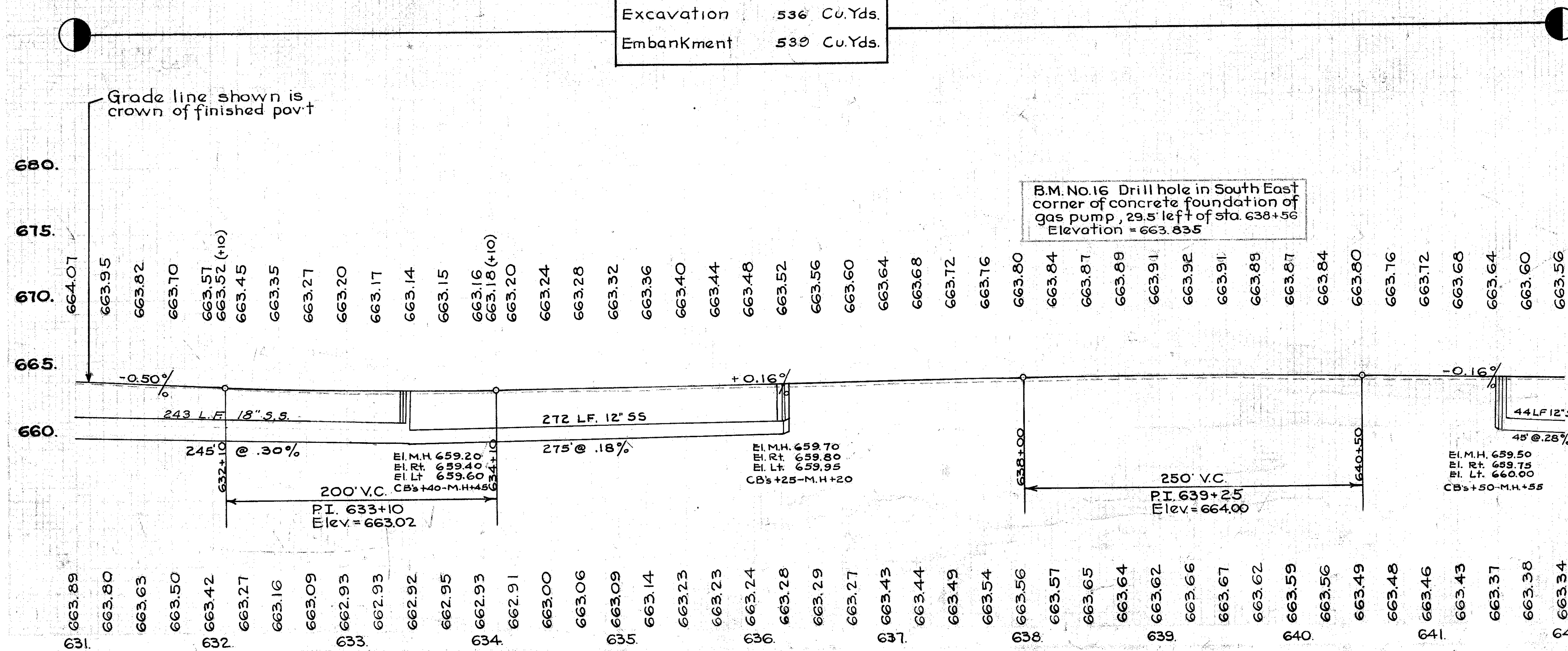

B.M. No. 16 Drill hole in South East corner of concrete foundation of gas pump, 29.5' left of sta. 638+56. Elevation = 663.835