

LAKE COUNTY
S.H. 2 SEC. Q (Pt)

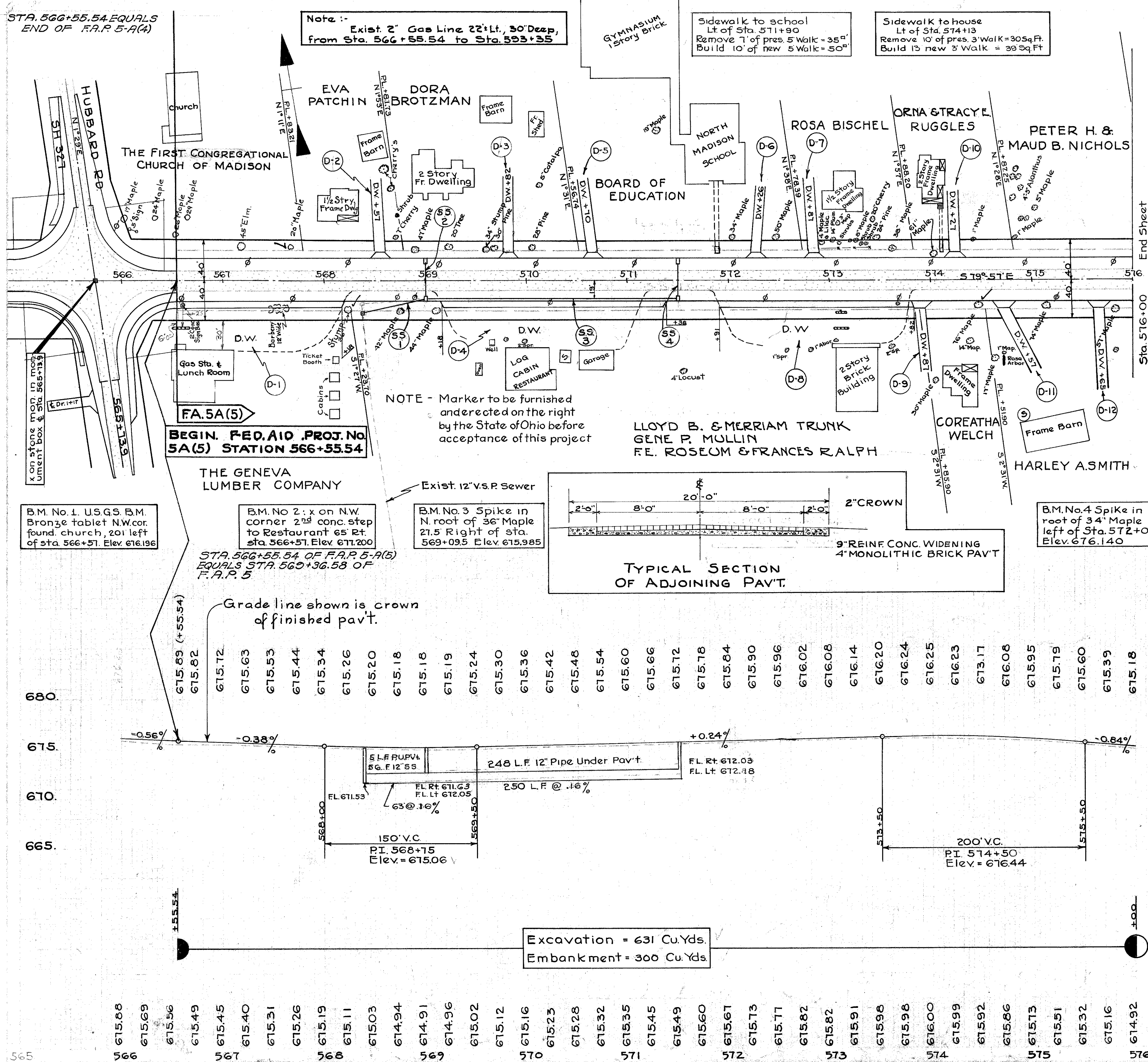

DRIVES & APPROACHES

Item	Station	Side	T-10 Sq.Yds	I-17 Cu.Yds	Deduct Curb Lin. Ft	See Sheet No.
* D-1	567+00	Rt	117.5	16.7	165.5	
D-2	568+57	Lt	11.9	1.1	22	
* D-3	569+82	Lt	11.9	1.1	22	
* D-4	570+00	Rt	159.2	22.7	226	
D-5	570+70	Lt	11.9	1.1	22	
D-6	572+26	Lt	11.9	1.1	22	
D-7	572+87	Lt	11.9	1.1	22	
* D-8	573+00	Rt	138.0	19.7	197	
D-9	573+87	Rt	11.9	1.1	22	
D-10	574+27	Lt	11.9	1.1	22	
D-11	574+57	Rt	11.9	2.0	22	37
D-12	575+65	Rt	11.9	2.0	22	37
Totals			521.8	70.8	786.5	

* See sheet 3 for quantities.

SIDEWALK (LEFT)

Station	To Station	Lin Ft	Deductions	Length	Width	Sq.Ft
566+55.54	576+00	944.46	6 Drs @ 14.5 = 87	857.46	4.5	3858.6
Connections 571+90 Lt 50 Sq Ft, 574+13 Lt 39 Sq Ft						89
Sidewalk Removed 574+13 Lt 35 + 574+13 Lt 30 = 65 Sq Ft						65
Total						3947.6

STORM SEWER

Item No.	Side	Station	To Station	Pipe Lin. Ft	Pipe Under Pavt (Lin. Ft)	Catch Basins 13X 13Y 2-3
SS-1	Rt	568+40	568+99	56	5	1
SS-2	Lt to Rt	569+00			33	1 1
SS-3	Rt	569+01	571+49		248	
SS-4	Lt to Rt	571+50			33	1 1
Totals				56	319	2 2 1

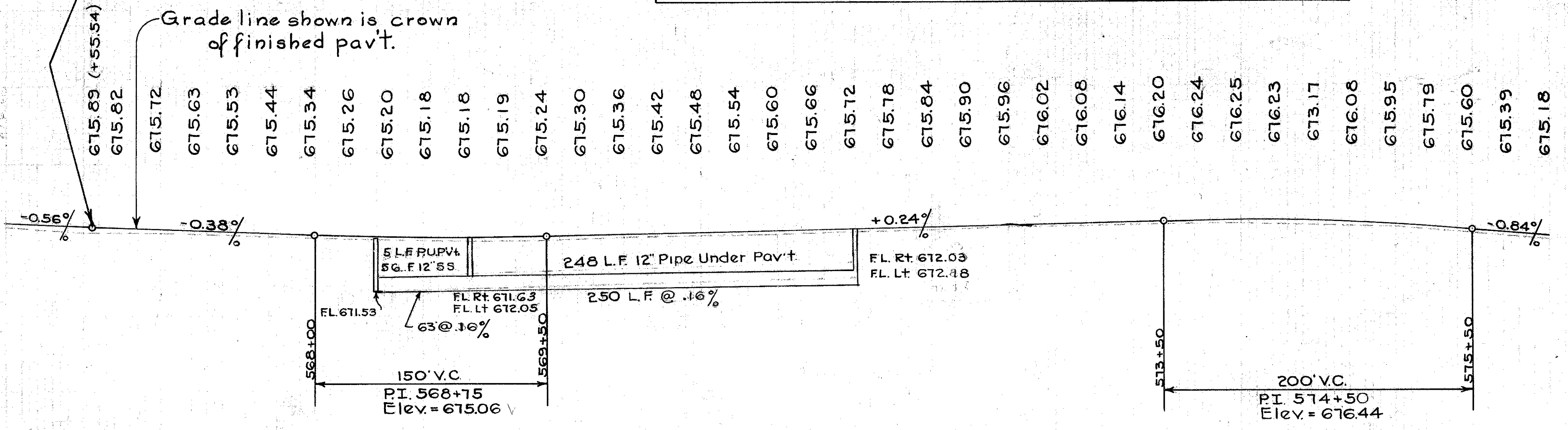
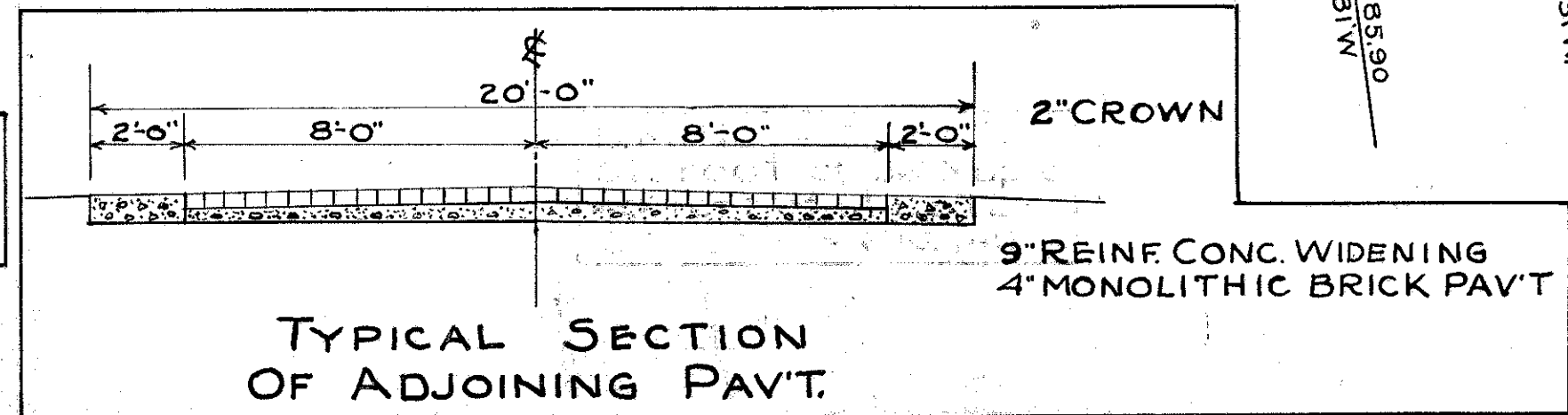

REMOVAL OF EXISTING PAVT.

Station From	Station To	Length	Width	Sq.Yds
568+96	569+04	8	20	17.8
571+46	571+54	8	20	17.8
Total				35.6

REMOVAL OF TREES & STUMPS

Station	Side	Dist from &	Size	Kind
569+61	Lt	29'	34"	Stump
568+25	Rt	28'	36"	Stump
574+45	Rt	23'	76"	Maple
567+67	Lt	32'	20"	Maple
Total = 4 Indicated thus (✓)				

REPLACEMENT FOR CROSSOVERS

Station From	Station To	Length	Width	Sq.Yds
568+96	569+04	8	20	17.8
571+46	571+54	8	20	17.8
Total				35.6

SEALING (ONLY) EDGES OF EXIST. PAVT

Station	To Station	Side	Lin. Ft.	
566+55.54		Lt. to Rt	44'	
566+55.54	576+00	Lt. & Rt	3718'	
Total				3822'

PIPE REMOVED

Station From	Station To	Side	Lin. Ft.	
568+38		Rt	10'	
568+39	568+91	Rt	52'	
Total				62'

INLETS REMOVED

Station	Side	Dist from &
568+37.5	Rt	24'
568+92	Rt	19'
Total = 2		