

LAKE COUNTY
S.H. 2 SEC. Q (Pt)

P.C. 651+77.92		P.T. 659+49.21			
D=2°-00' L					
LEFT		CENTER		RIGHT	
Elev. New Edge 22' from	Elev. Pres. Edge 10'-1" from	Station	Def.	Elev. Pres. Edge 10'-1" from	Elev. New Edge 22' from
	73		650+89.5 End. Brick Begin Conc.		663.85
663.85		650+75			663.85
663.68	663.82	651+00		663.90	663.80
663.50	663.71	651+25		664.22	664.25
663.32	663.69	651+50		664.40	664.75
663.13	663.63	651+77.92	0°-00"	664.44	664.94
663.10	663.60	652+00	0°-13'-15"	664.43	664.93
663.05	663.55	652+25	0°-28'-15"	664.40	664.90
663.01	663.51	652+50	0°-43'-15"	664.33	664.83
662.94	663.44	652+75	0°-58'-15"	664.29	664.79
662.89	663.39	653+00	1°-13'-15"	664.24	664.74
662.86	663.36	653+25	1°-28'-15"	664.18	664.68
662.83	663.33	653+50	1°-43'-15"	664.11	664.61
662.75	663.25	653+75	1°-58'-15"	664.05	664.55
662.74	663.24	654+00	2°-13'-15"	663.99	664.49
662.69	663.19	654+25	2°-28'-15"	663.94	664.44
662.62	663.12	654+50	2°-43'-15"	664.12	664.46
662.54	663.04	654+75	2°-58'-15"	663.84	664.34
662.51	663.01	655+00	3°-13'-15"	663.83	664.33
662.42	662.92	655+25	3°-28'-15"	663.76	664.26
662.29	662.79	655+50	3°-43'-15"	663.62	664.12
662.14	662.64	655+75	3°-58'-15"	663.48	663.98
661.99	662.49	656+00	4°-13'-15"	663.33	663.83
661.78	662.28	656+25	4°-28'-15"	663.12	663.62
661.61	662.11	656+50	4°-43'-15"	662.91	663.41
661.35	661.85	656+75	4°-58'-15"	662.66	663.16
661.04	661.54	657+00	5°-13'-15"	662.38	662.88
660.77	661.27	657+25	5°-28'-15"	662.08	662.58
660.44	660.94	657+50	5°-43'-15"	661.77	662.27
660.05	660.55	657+75	5°-58'-15"	661.34	661.84
659.66	660.16	658+00	6°-13'-15"	661.00	661.50
659.52	660.02	658+14	6°-28'-15"	660.83	661.33
659.67	659.17	658+64	6°-43'-15"	659.97	660.47
658.42	658.92	658+75	6°-58'-15"	659.70	660.20
657.98	658.48	659+00	7°-13'-15"	659.27	659.77
657.54	658.04	659+25	7°-28'-15"	658.84	659.34
657.09	657.59	659+49.21	7°-42'-45"	658.40	658.90
656.80	657.23	659+75		657.94	658.38
656.50	656.82	660+00		657.35	657.65
656.30	656.55	660+25		656.78	656.90
656.14	656.35	660+50		656.43	656.40
656.10	656.30	660+64.3	End. Conc. Begin Brick	656.37	656.30
656.03		661+00			656.03

Run Offs not standard but made to fit pres. Conc.

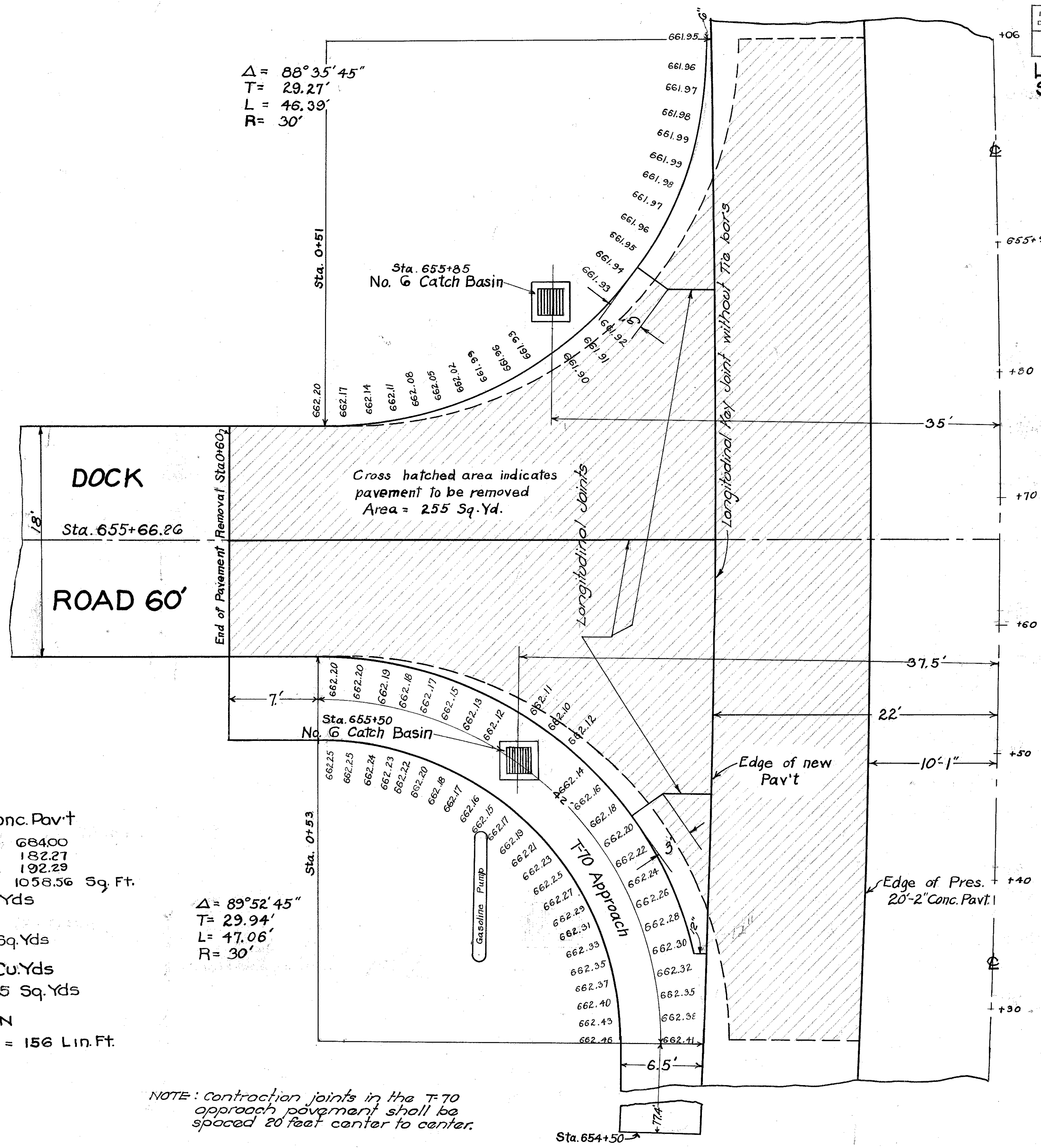

DOCK ROAD
Sta. 655 + 66.4

Extra 9'-7"-9" T-71 Conc. Pav't

38x18	=	684.00
29.27x30-L	=	182.27
29.94x30-L	=	192.29
		Total 1058.56 Sq. Ft.

1058 ÷ 9 = 117.6 Sq. Yds

T-70 Approach
(126 ÷ 6.5) ÷ 9 = 21.3 Sq. Yds

Excavation = 25 Cu. Yds
Pav't Removal = 255 Sq. Yds

CURB DEDUCTION
Sta. 654+50 to 656+06 = 156 Lin. Ft.

$\Delta = 89^{\circ}52'45''$
 $T = 29.94'$
 $L = 47.06'$
 $R = 30'$

NOTE: Contraction joints in the T-70 approach pavement shall be spaced 20 feet center to center.

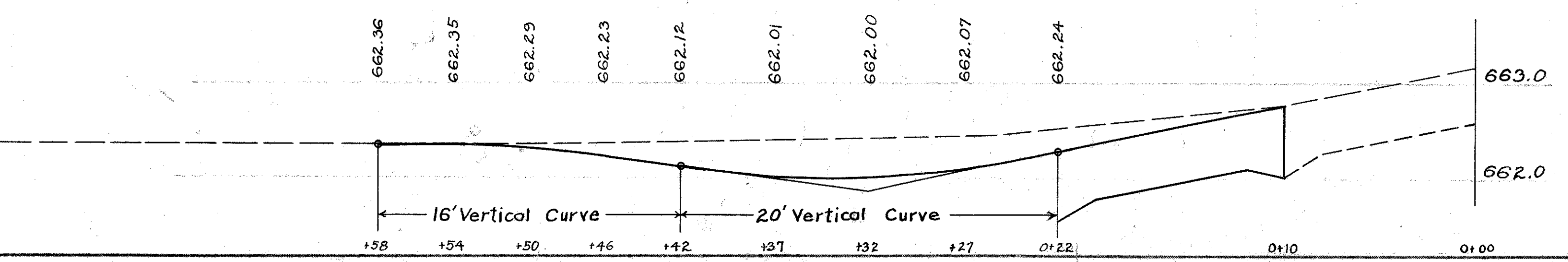

CURVE TABLE.