

ORIENTATION ANGLES

CALCULATED
CHECKED

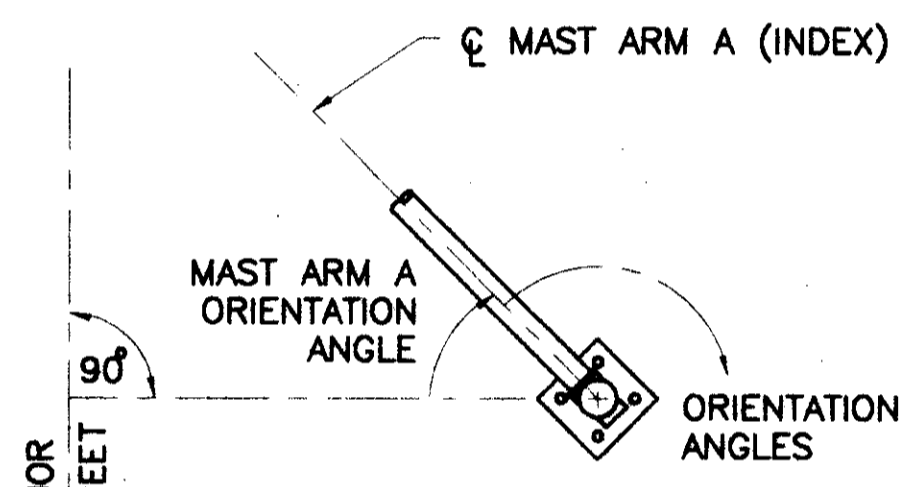
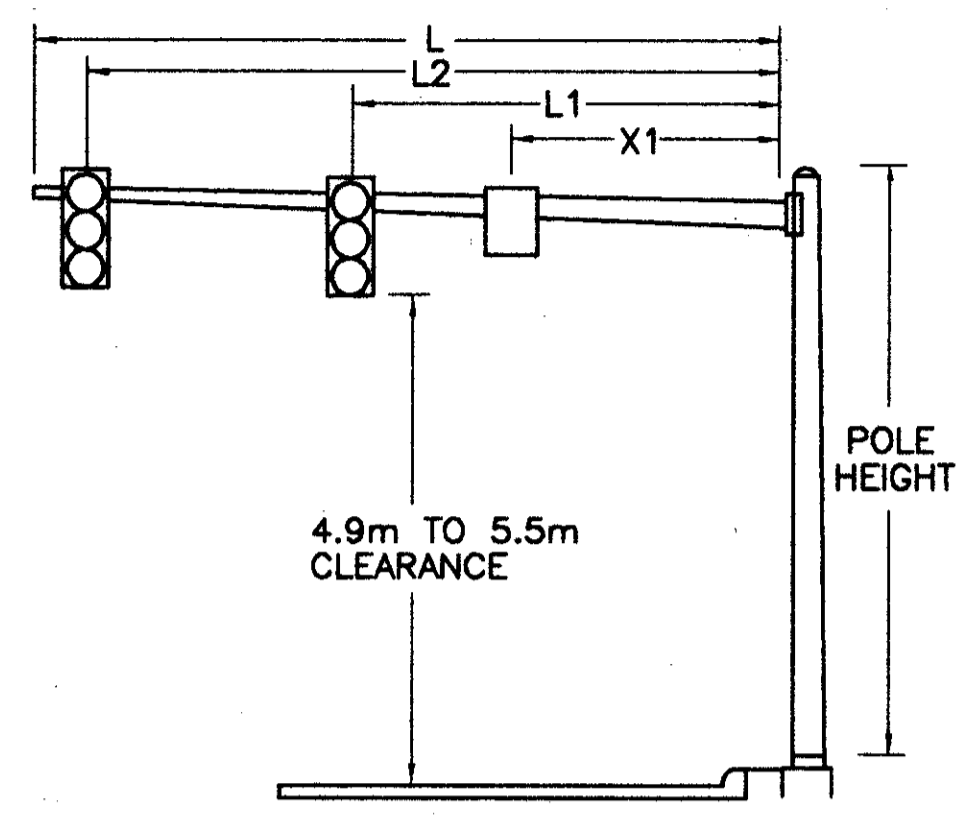

NOTES:
1. ALL ANGLES MEASURED CLOCKWISE.
2. BASE PLATE IS ORIENTED SQUARE TO MAST ARM A (LARGEST ARM) EVEN IF SUPPORT HAS TWO MAST ARMS.

NOTES:
1. THE MAJOR STREET SHALL BE THE FIRST STREET NAME CALLED OUT FOR EACH INTERSECTION.

INTERSECTION	PLAN SHEET NO.	SUPPORT NO.	SIGNAL SUPPORT														ORIENTATION ANGLES FROM MAST ARM A								
			POLE DESIGN NO.			ARM DESIGN NO.	POLE HEIGHT	FOUNDATION		L	L1	L2	L3	L4	X1	X2	MAST ARM A ANGLE (DEG.)	MAST ARM B	PEDESTRIAN SIGNALS	PEDESTRIAN PUSHBUTTONS	HANDHOLE	CABLE ENTRANCE 0.3m FROM TOP	VEHICLE SIGNALS	CONTROLLER	POWER
			TC-6L20	TC-6L20	TC-6L10			STATION	OFFSET	(m.)	(m.)	(m.)	(m.)	(m.)	(m.)	(m.)									
WEST JACKSON STREET & FERN DRIVE/SR 44 RAMP	20	P1	11		11	6.1m	0+354.3	12.2m L	11.6	8.1	11.2				7.2	0	90	135	180						
		P2	1		1	6.1m	0+373.1	7.3m L	6.4	2.7	5.8				1.8	90	180	315	180						
		P3	2		2	6.1m	0+376.7	7.8m R	8.8	5.1	8.2				4.2	0	180/270	180/270	180	180					
		P4	1		1	6.1m	0+361.6	7.4m R	5.6	2.0	5.1				1.0	90	180/270	180/270	180						
WEST JACKSON STREET & NEWELL STREET	22	P1	4		2	6.1m	1+033.6	7.7m L	8.4	4.7	7.1				8.3	270			180						
		P2	3		2	6.1m	1+043.6	9.7m R	9.2	6.7	8.9				4.6	0	0	0	180	180					
		P3	3		3	6.1m	1+028.3	5.3m R	10.0	7.4	9.7					105	255	75	180						
		P4	PED			2.4m	1+058.9	8.0m L									90	0	180						
		P5	PED			2.4m	1+056.8	8.4m R									90	90	180						
WEST JACKSON STREET & GRANT ST./W. EAGLE ST.	24	P1	1		1	6.1m	1+576.8	5.6m R	4.8	2.0	4.4					0	180	180	180						
		P2	PED			2.4m	1+560.2	9.3m R									0	0	180	180					
		P3	3		1	6.1m	1+561.5	7.0m L	6.8	3.8	6.3					0			180						
					1				6.8	3.8	6.3					270									
MENTOR AVENUE & FERN DRIVE	26	P1	12		11	6.1m	0+157.3	9.8m R	11.6	8.6	11.2					270			180						
		P2	PED		2	2.4m	0+139.4	8.7m R	8.4	4.0	7.9					90									
		P3	3		3	6.1m	0+137.3	9.9m L	10.0	6.2	9.4					0	90	90	180						
		P4	PED			2.4m	0+156.9	12.3m L									0/270	0/270	180						
																	0	0	180						
MENTOR AVENUE & ROOSEVELT DRIVE	28	P1	1		1	6.1m	0+477.1	6.7m L	6.4	2.5	6.1					0	0/270	180/270	180						
		P2	PED			2.4m	0+495.0	9.4m L									0	0	180						
		P3	3		1	6.1m	0+487.7	6.8m R	6.8	3.1	6.3					0			180	0		180	90		
					1				4.8	1.5	4.4					270									
		P4	PED			2.4m	0+479.2	8.9m R									90	90	180						
MENTOR AVENUE & CHESTNUT STREET	30	P1	4		3	6.1m	1+026.7	7.2m L	10.4	6.4	9.0					270	45	0	180						
					2				7.6	4.9	7.3					90									
		P2	1		1	6.1m	1+041.1	8.0m R	6.8	3.5	6.3					0	180	180	180						
		P3	PED			2.4m	1+023.9	8.1m R									90/180	135/225	180						
MENTOR AVENUE & GRANT STREET/W. WALNUT STREET	32	P1	4		4	6.1m	1+365.7	11.4m R	11.2	6.6	10.9					0	0/270	0/270	180						
		P2	2		3	6.1m	1+344.7	10.1m R	10.0	6.5	9.6					90	0/270	0/270	180	225					
		P3	2		2	6.1m	1+344.6	7.9m L	9.6	6.2	9.3					0	180/270	180/270	180						
		P4	3		3	6.1m	1+365.7	8.1m L	9.6	5.6	9.0					90	0/90	45/135	180						
MENTOR AVENUE & WASHINGTON STREET	34	P1	1		1	6.1m	1+924.1	7.4m L	6.8	2.4	6.4					0			180						
		P2	11		11	6.1m	1+910.5	10.7m R	12.0	6.7	7.1	11.3	11.6			30			180						
		P3	PED			2.4m	1+954.3	7.3m L									90	90	180						
		P4	PED			2.4m	1+954.2	7.0m R									270	270	180						
		P5	PED			2.4m	1+945.4	11.3m R									210	240	180						
		P6	PED			2.4m	1+933.6	20.9m R									30	30	180						

ORIENTATION ANGLES

LAKE COUNTY
LAK-20-22.916/VARIOUS