

TREE PROTECTION (A)							
Item No.	Station	Ft. Ror.L.	Size	Aeration		Riprap Wall	
				Cu. Yds. App.	Sp. Yds. Riprap Well to Thick	Length	Ht.
1-A	147+98	225 L	15"	6.0	5.1		
2-A	149+01	23 L	10"	7.5	7.2		
3-A	149+29	23 L	10"	10.0	9.3		
4-A	150+36	23 L	8"	7.0	7.0		
5-A	166+98	235 L	24"	12.4	5.6		
Total				42.9	34.2		

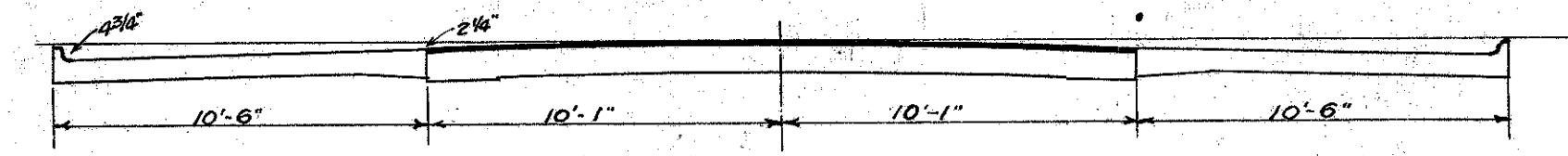

Existing pavement adjoining beginning of project consists of a bituminous wearing surface, 20'-2" wide, flanked by 2 strips of reinforced concrete pavement 10'-6" wide with 6"x4" integral concrete raised curb.

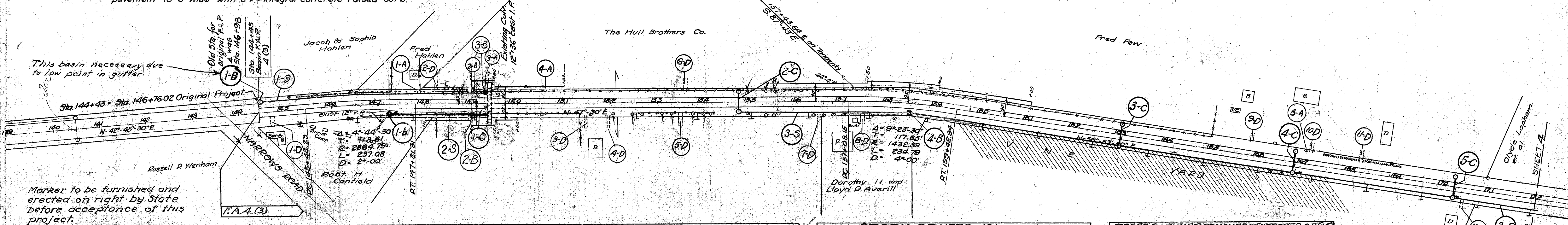

Item No.	Station	Type	Size	Excav. Cu. Yds.	12" C.P. Form. Lin. Ft.	Conc. 1-5/8" Cu. Yds.	Reinf. Steel Lbs.	12" Pipe for Catch Basins Lin. Ft.	Type	Std. No. 11-A Catch Basin		Work Required
										Each	Each	
1-C	149+39	Conc. Box	8'-6" x 9'	333.0	36	81.8	10,599		4	1	1	Build 8'x6' Reinf. Conc. Box for Cat Ho. Pass (See sheet 27)
2-C	154+75	Pipe	12"x37"	16.0				37	L	1	R	Build Std. 12"x37" Pipe Culv. Std. 11-AC Bonk. Std. 12-AC Bonk.
3-C	163+00	"	12"x37"	16.0				37	L	1	R	" " " " " " " " " " " "
4-C	166+76	"	12"x37"	16.0				37	L	1	R	" " " " " " " " " " " "
5-C	170+25	"	12"x37"	16.0				37	L	1	R	" " " " " " " " " " " "
TOTALS				397.0	36	81.8	10,599	148	4	4	4	See Details on Sheet # 27, 28, 29

Item No.	Station	Right or Left	Pipe for St. Sewers		
			Lin. Ft.	15"	
1-S	144+45	149+35	24.0 L	463	
2-S	147+25	149+35	24.0 R	205	
3-S	154+75	172+00	24.0 R	1643	
TOTALS				668	1643

Note: All pipe shall have cemented joints.

No.	Station	Ft. Ror.L.	TREES & STUMPS REMOVED & DISPOSED OF (Y)	
			Size	Kind
1	148+43	18.7	L	15" Cherry
2	148+61	18.7	L	15" Cherry
3	148+81	19	L	12" Cherry
4	149+58	18.3	L	18" Apple
5	152+07	20.2	R	12" Cherry
6	152+47	20.7	R	12" Cherry
7	153+10	20.5	R	15" Cherry
8	153+30	20.5	R	15" Cherry
9	153+77	20.2	R	15" Cherry
10	153+98	19.8	R	12" Cherry
11	154+94	20.9	L	12" Apple
12	155+35	20.5	L	12" Cherry
13	155+53	20.8	L	12" Stump

STD. 12-A CATCH BASINS (B) (Roadway Quantities)			
Item No.	Station	Type	Quantity
1-B	144+45	on left	1
2-B	149+00	on right	1
3-B	149+31	on left	1
4-B	152+26	on right	1
TOTAL = 4			

PRIVATE DRIVES			
Item No.	Station	Side	Quantity
1-D	144+75	R	0.5
2-D	146+32	R	2.9
3-D	151+28	R	0.6
4-D	151+36	R	3.0
5-D	153+43	R	3.0
6-D	153+56	L	2.9
7-D	156+47	R	0.6
8-D	157+40	R	0.6
9-D	165+22	R	2.4
10-D	167+12	L	1.9
11-D	168+16	L	0.3
12-D	170+46	R	1.1
TOTAL			

SPECIAL SIDE DITCH INLET USE EXISTING CASTING (b)		
Item No.	Station	R or L
1-b	147+25	28 R
TOTAL = 1		

