

PHASING DIAGRAM

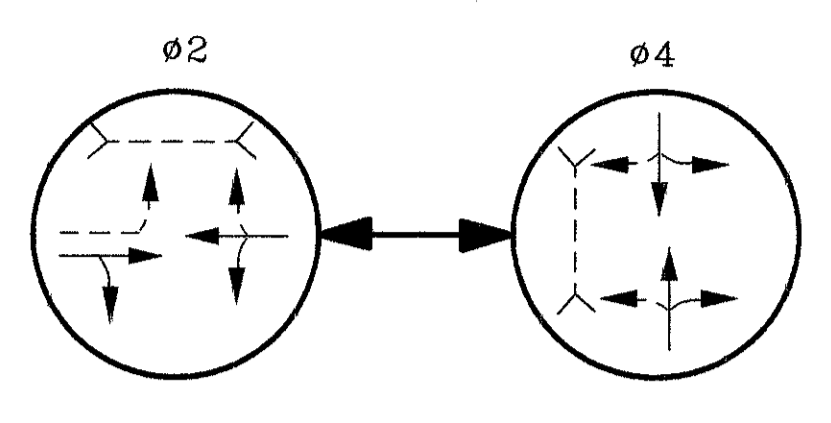

THE UNDERGROUND UTILITIES ARE SHOWN ACCORDING TO INFORMATION FURNISHED BY THE UTILITIES CONCERNED. THEIR ACCURACY IS NOT GUARANTEED, THEREFORE THEY SHOULD BE RECHECKED BEFORE UNDERGROUND CONSTRUCTION BEGINS.

THE UNDERGROUND UTILITIES ARE SHOWN ACCORDING TO INFORMATION FURNISHED BY THE UTILITIES CONCERNED. THEIR ACCURACY IS NOT GUARANTEED, THEREFORE THEY SHOULD BE RECHECKED BEFORE UNDERGROUND CONSTRUCTION BEGINS.

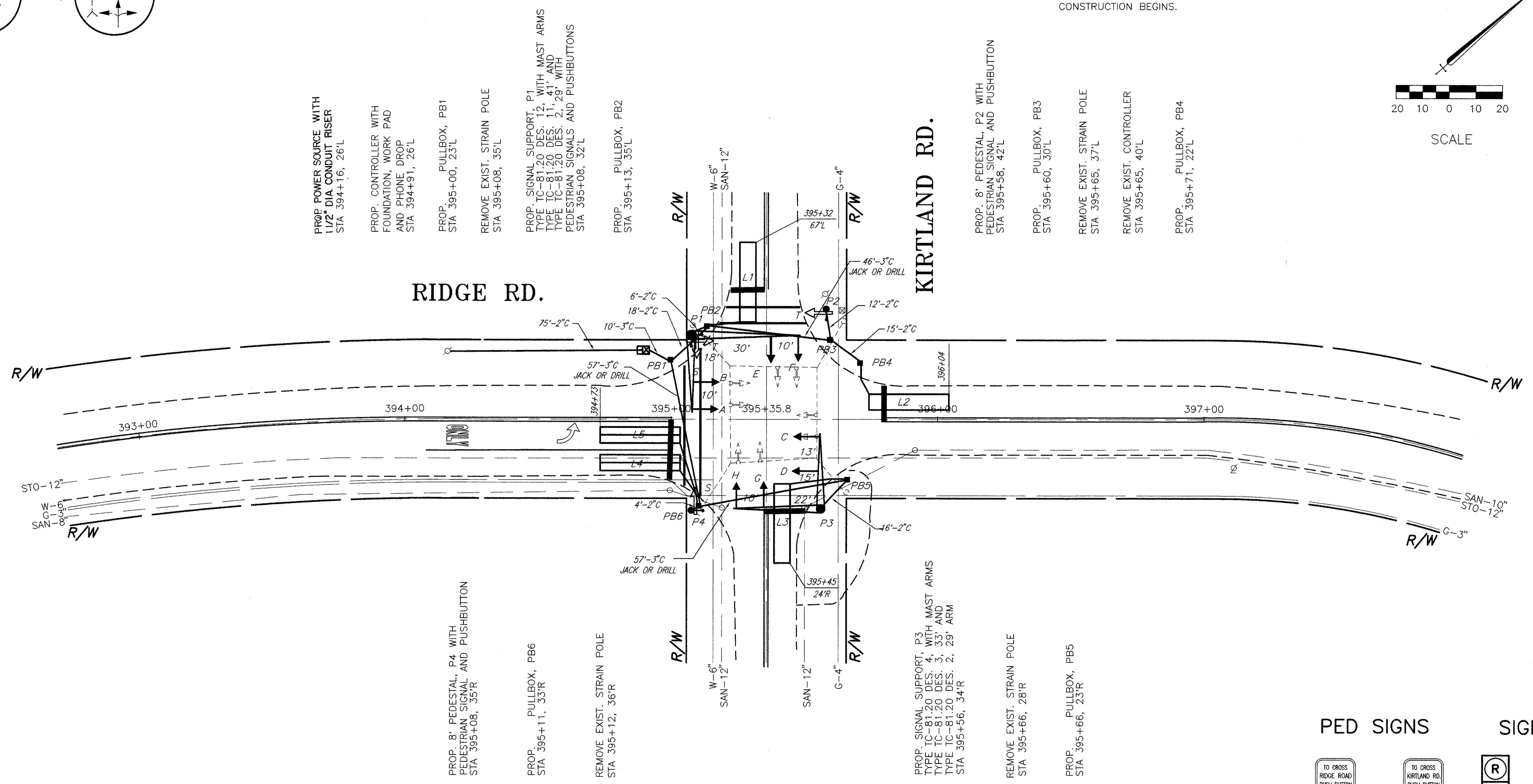
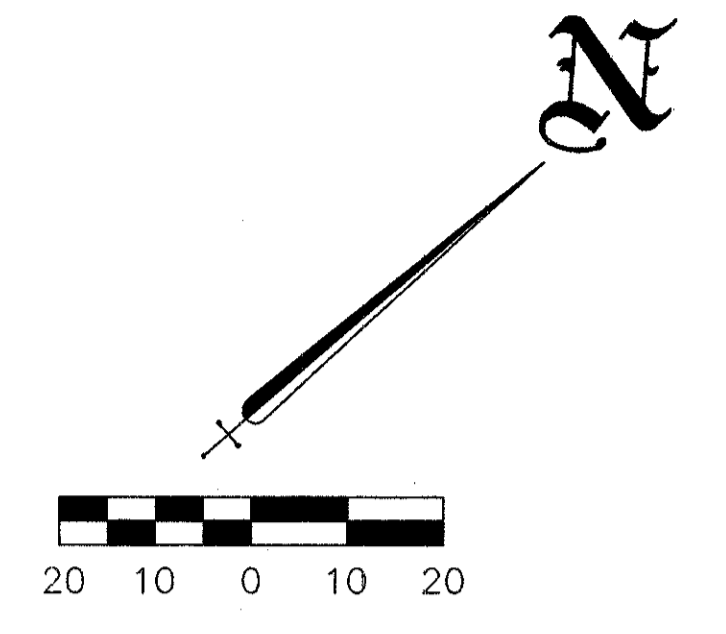

PROP. POWER SOURCE WITH 1 1/2" DIA. CONDUIT RISER
STA 394+16, 26'L

PROP. CONTROLLER WITH FOUNDATION, WORK PAD AND PHONE DROP
STA 394+91, 26'L

PROP. PULLBOX, PB1
STA 395+00, 23'L

REMOVE EXIST. STRAIN POLE
STA 395+08, 35'L

PROP. SIGNAL SUPPORT, P1
TYPE TC-81.20 DES. 12, WITH MAST ARMS
TYPE TC-81.20 DES. 11, 41' AND
TYPE TC-81.20 DES. 2, 29' WITH
PEDESTRIAN SIGNALS AND PUSHBUTTONS
STA 395+08, 32'L

PROP. PULLBOX, PB2
STA 395+13, 35'L

PROP. 8' PEDESTAL, P2 WITH PEDESTRIAN SIGNAL AND PUSHBUTTON
STA 395+58, 42'L

PROP. PULLBOX, PB3
STA 395+60, 30'L

REMOVE EXIST. STRAIN POLE
STA 395+65, 37'L

REMOVE EXIST. CONTROLLER
STA 395+65, 40'L

PROP. PULLBOX, PB4
STA 395+71, 22'L

PROP. 8' PEDESTAL, P4 WITH PEDESTRIAN SIGNAL AND PUSHBUTTON
STA 395+08, 35'R

PROP. PULLBOX, PB6
STA 395+11, 33'R

REMOVE EXIST. STRAIN POLE
STA 395+12, 36'R

PROP. SIGNAL SUPPORT, P3
TYPE TC-81.20 DES. 4, WITH MAST ARMS
TYPE TC-81.20 DES. 3, 33' AND
TYPE TC-81.20 DES. 2, 29' ARM
STA 395+56, 34'R

REMOVE EXIST. STRAIN POLE
STA 395+66, 28'R

PROP. PULLBOX, PB5
STA 395+66, 23'R

PED SIGNS

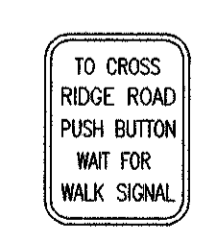

R-73A-9
QTY. = 2



R-73A-9
QTY. = 2

SIGNALS

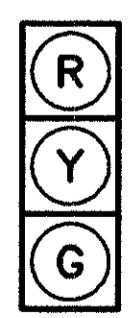

ALL

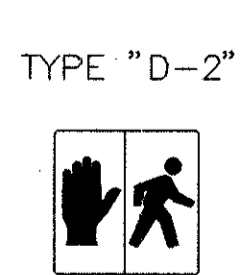

TYPE "D-2"

S - S
T - T

ALL HEADS ARE 12" POLY