

THE UNDERGROUND UTILITIES ARE SHOWN ACCORDING TO INFORMATION FURNISHED BY THE UTILITIES CONCERNED. THEIR ACCURACY IS NOT GUARANTEED, THEREFORE THEY SHOULD BE RECHECKED BEFORE UNDERGROUND CONSTRUCTION BEGINS.

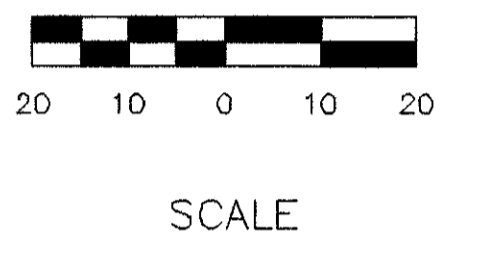

NOTE: CONTRACTOR SHALL SPOOL EXTRA SIGNAL CABLE IN POLES P1 & P3 FOR FUTURE SIGNAL HEAD LOCATION.

- PROP. PULLBOX, PB3
STA 195+92, 23'L
- REMOVE EXIST. POLE AND PEDESTRIAN SIGNAL
STA 196+47, 30'L
- REMOVE EXIST. CONTROLLER
STA 196+47, 30'L
- PROP. PULLBOX, PB4
STA 196+48, 39'L
- PROP. SIGNAL SUPPORT, P3
TYPE TC-81.20 DES. 12 WITH MAST ARMS
TYPE TC-81.20 DES. 11, 40' AND
TYPE TC-81.20 DES. 2, 27' WITH
PEDESTRIAN SIGNALS AND PUSHBUTTONS
STA 196+54, 45'L

- PROP. PULLBOX, PB5
STA 197+39, 23'L
- PROP. 8' PEDESTAL, P4 WITH
PEDESTRIAN SIGNAL AND PUSHBUTTON
STA 197+43, 24'L

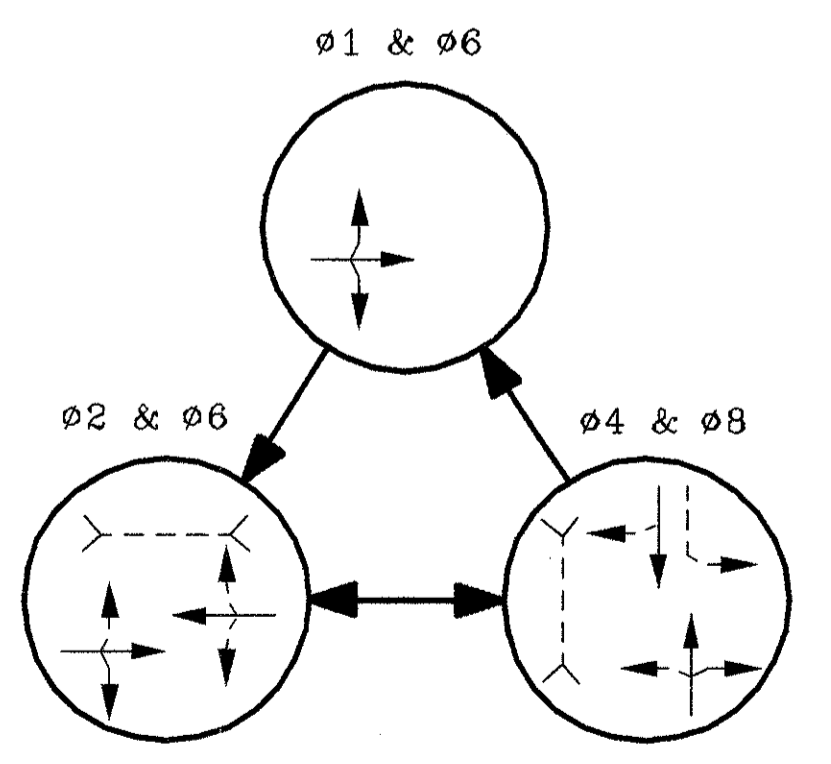
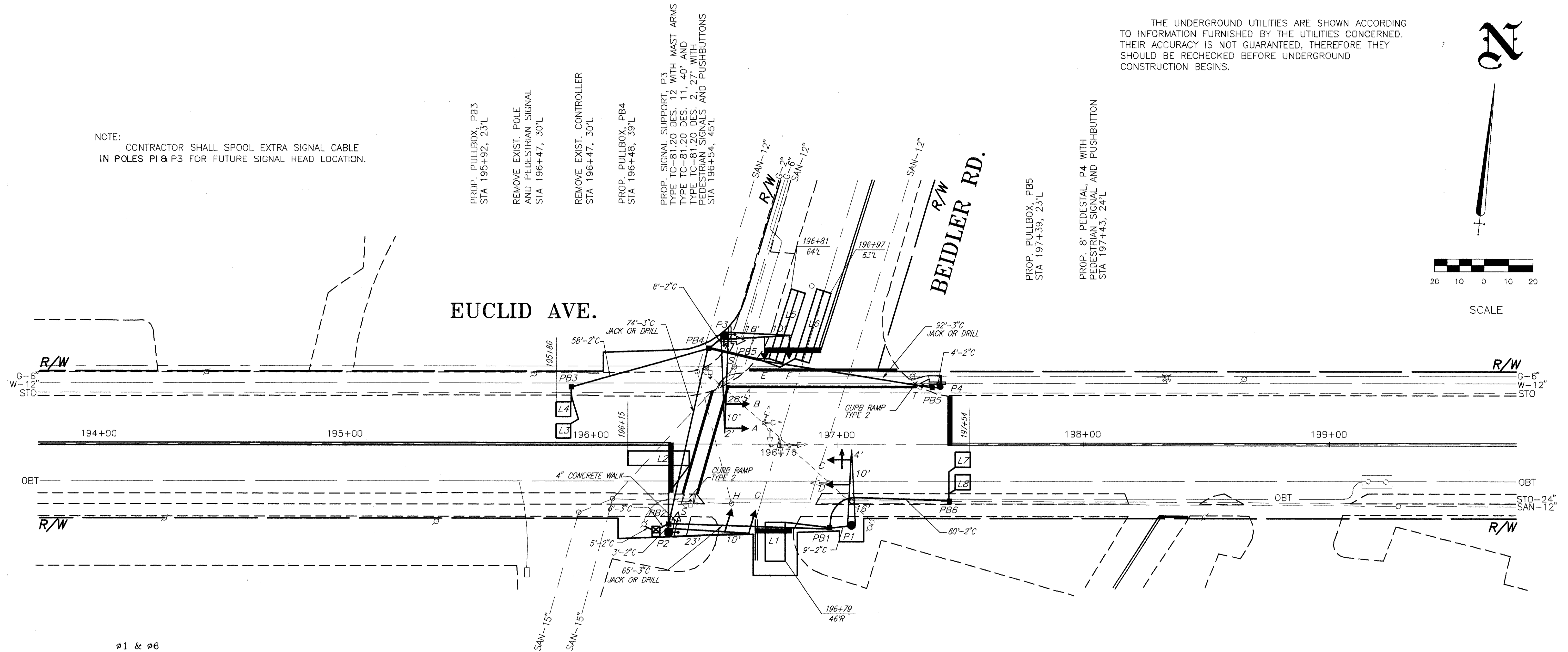

PHASING DIAGRAM

- PROP. POWER SOURCE WITH
1 1/2" DIA. CONDUIT RISER
STA 196+22, 32'R
- PROP. CONTROLLER WITH
FOUNDATION AND WORK PAD
STA 196+26, 34'R
- PROP. SIGNAL SUPPORT, P2
TYPE TC-81.20 DES. 4, 34' ARM
STA 196+32, 36'R
- PROP. PULLBOX, PB2
STA 196+32, 32'R
- REMOVE EXIST. POLE
AND PEDESTRIAN SIGNALS
STA 196+38, 24'R
- PROP. PULLBOX, PB1
STA 196+97, 34'R
- PROP. SIGNAL SUPPORT, P1
TYPE TC-81.20 DES. 2, 30'
STA 197+06, 33'R
- REMOVE EXIST. POLE
STA 197+15, 31'R
- PROP. PULLBOX, PB6
STA 197+45, 23'R

NOTE: SIGNALS A, B, C & D TO HAVE TUNNEL VISORS

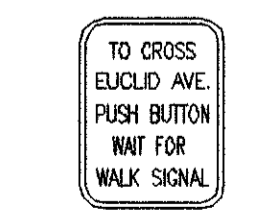

R-73A-9
QTY. = 2

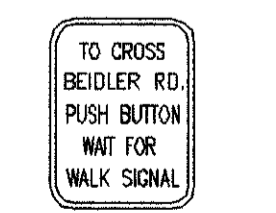

R-73A-9
QTY. = 2

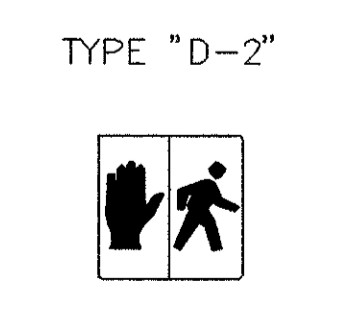
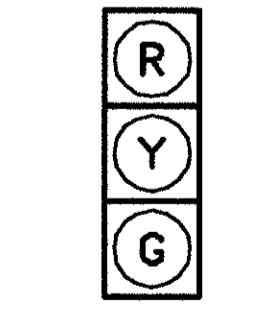
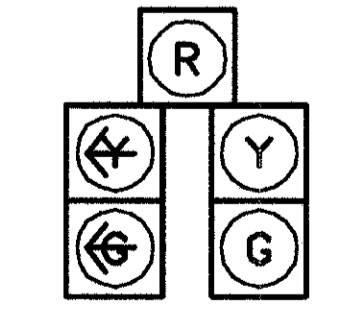

C
A, B, D, E, F, G & H
S - S
T - T

ALL HEADS ARE 12" POLY

PED SIGNS

SIGNALS