

F.H.W.A. REGION	STATE	PROJECT	
5	OHIO	NH - 69(123)	

11
15

LAKE COUNTY
LAK-20-15.58

NOTES:

1. SIGN AND BARRICADE PLACEMENT SHOWN ON DRAWINGS IS APPROXIMATE. CONTRACTOR SHALL VERIFY THE LOCATION OF ANY UNDERGROUND UTILITIES PRIOR TO SIGN POST PLACEMENT AND STAY CLEAR OF SAME.
2. ALL SIGNS AND INSTALLATION OF SAME ARE SUBJECT TO THE APPROVAL OF THE PROJECT ENGINEER.
3. BARRICADE LOCATIONS ARE TO BE APPROVED BY THE PROJECT ENGINEER.
4. STANDARD SIGNS ARE AS DESCRIBED IN THE "MANUAL OF UNIFORM TRAFFIC CONTROL DEVICES" OF THE STATE OF OHIO, DEPARTMENT OF TRANSPORTATION.

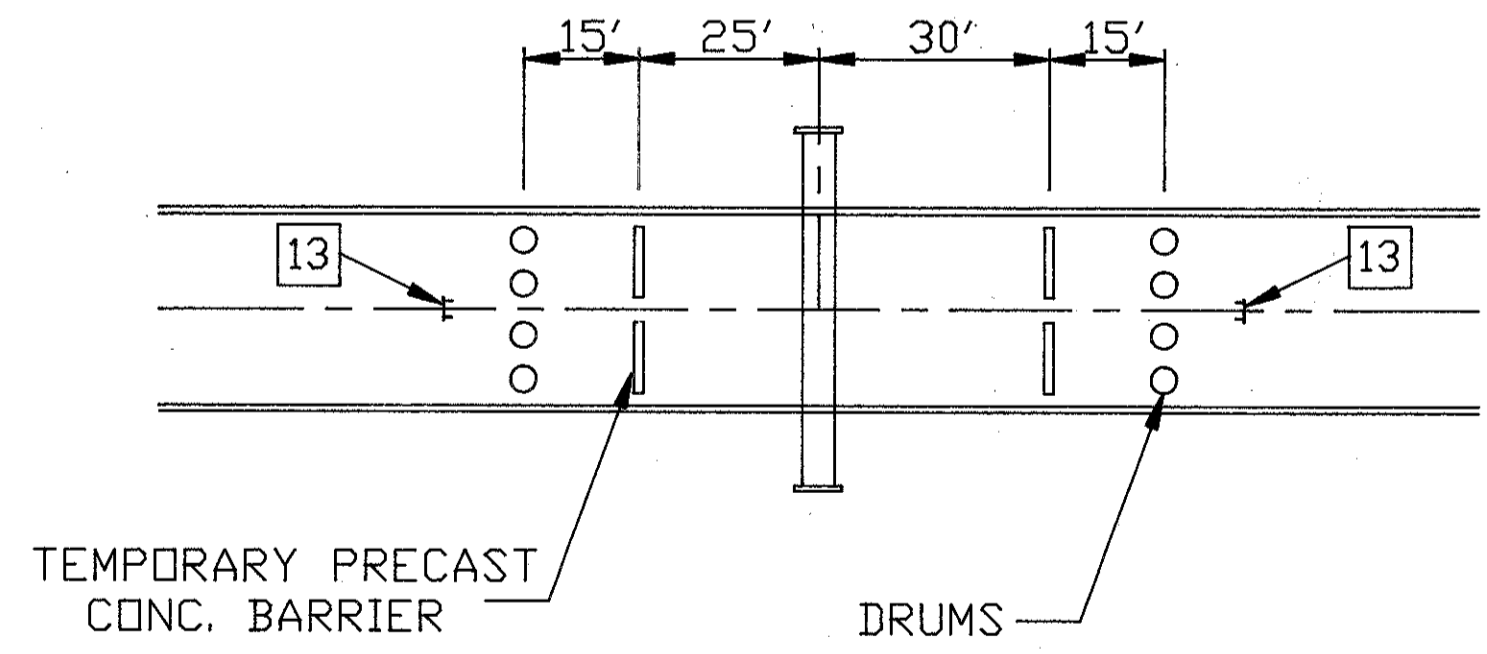
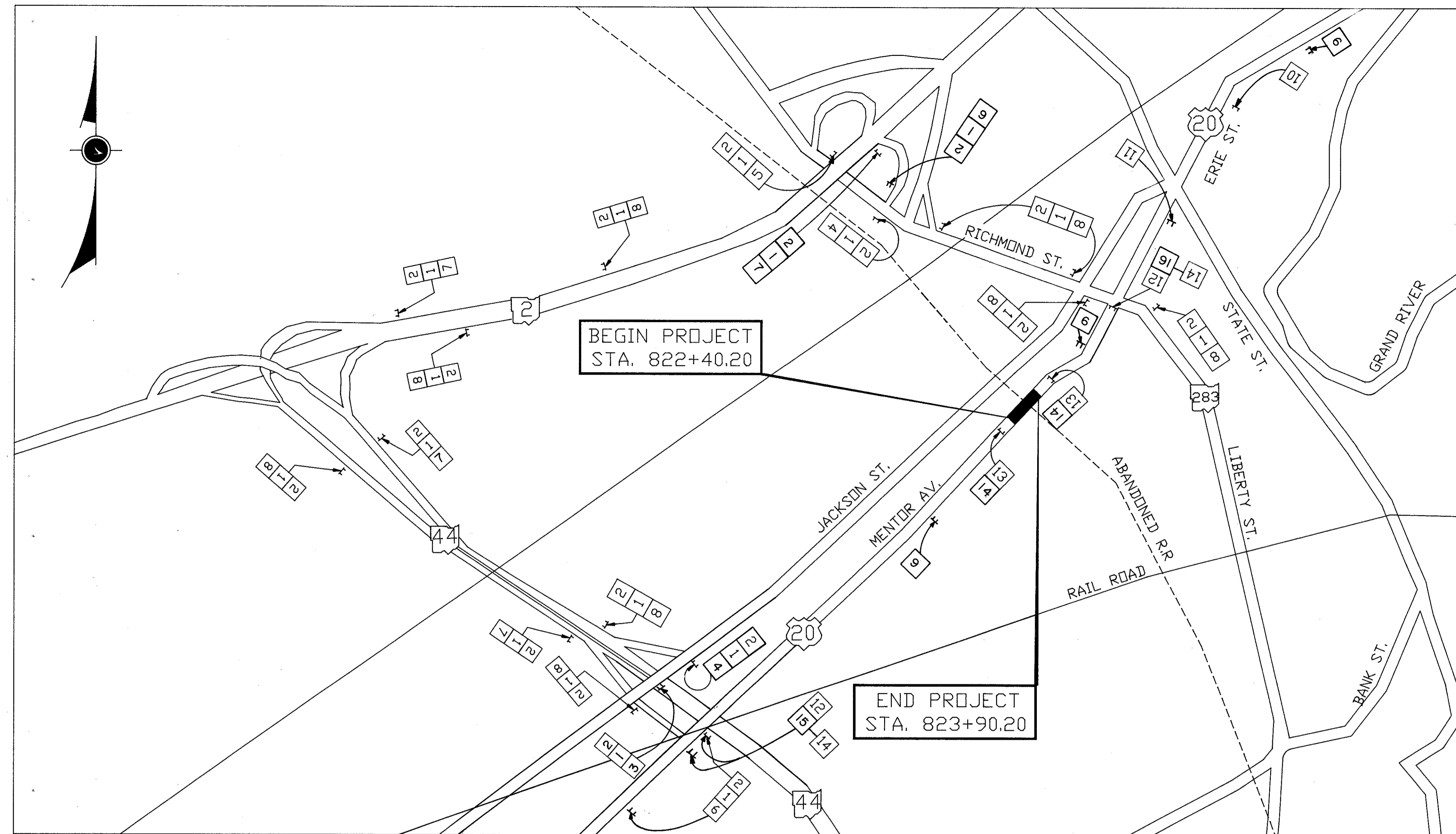

LAK-20-15.58

CONSTRUCTION SIGNS

1	2	3	4	5	6	7	8	9	10	11

12	13	14

SIGN LIGHTS OPTIONAL

RALPH C. TYLER, P.E., P.S., INC.
CIVIL ENGINEERS & LAND SURVEYORS
2143 FAIRHILL RD., CLEVELAND, OHIO 44106

DETOUR PLAN &
CONSTRUCTION SIGNS
LAK-20-15.58

DESIGNED	DRAWN	CHECKED	REVIEWED	DATE	REVISED	OHIO
R.J.K	R.L.	K.P.	R.C.T	1/93		