

FED. RD. DIST. No.	STATE	FED. AID PROJECT	FISCAL YEAR
10	OHIO	N.P.M. 519 E	1934

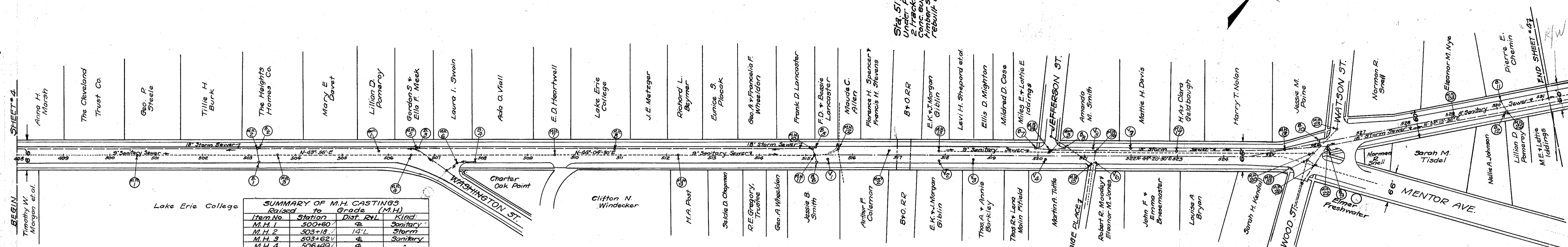

Sta. 517+10 Under Pass B.O.R.R. 2 Tracks Conc. Substructure Anteb. Superstructure Rebuilt Oct. 1933

**SUMMARY OF M.H. CASTINGS Raised to Grade (M.H.)**

Item No.	Station	Dist. R/L	Kind
M.H. 1	500+60	±	Sanitary
M.H. 2	503+18	14'L	Storm
M.H. 3	503+62	±	Sanitary
M.H. 4	506+49	±	Sanitary
M.H. 5	506+61	14'L	Storm
M.H. 6	507+49	18'R	Sanitary
M.H. 7	509+60	±	Sanitary
M.H. 8	510+89	13'L	Storm
M.H. 9	512+25	±	Sanitary
M.H. 10	515+15	13'L	Storm
M.H. 11	516+18	±	Sanitary
M.H. 12	515+69	18'L	Storm
M.H. 13	517+87	8.5'L	Sanitary
M.H. 14	520+26	14'L	Storm
M.H. 15	521+12	25'R	Sanitary
M.H. 16	521+24	7'L	Sanitary
M.H. 17	522+99	12.5'L	Storm
M.H. 18	525+32	2'R	Sanitary
M.H. 19	525+73	32'R	Sanitary
M.H. 20	525+92	20'R	Sanitary
M.H. 21	525+92	47'R	Sanitary
M.H. 22	526+26	10'R	Storm
M.H. 23	526+51	21'L	Sanitary
M.H. 24	529+07	±	Sanitary
M.H. 25	530+20	10'R	Storm

Total 25 M.H. Castings raised to Grade.

**SUMMARY OF CATCH BASINS Built as per detail (B)**

Item No.	Station	R/L
B-1	508+72	R
B-2	503+21	L
B-3	508+63	L
B-4	507+87	R
B-5	515+20	L
B-6	515+22	R
B-7	519+36	L
B-8	520+57	L
B-9	526+26	R
B-10	526+07	L
B-11	530+11	L
B-12	530+15	R

Total 12 Inlet Basins.

**SUMMARY OF MONUMENT CASTINGS Raised to Grade (Mon.)**

Item No.	Station	Location
Mon. 1	505+78.88	9'L of ±
Mon. 2	516+79.58	9'L of ±
Mon. 3	520+22.28	9'L of ±

Total 3 Mon. Cast. Raised

**SUMMARY OF VALVE BOXES Raised to Grade (V.)**

Item No.	Station	R/L
V-1	515+18	3.5'L
V-2	517+87	12'R
V-3	518+60	9.5'R
V-4	520+17	8'R
V-5	521+20	17.5'L
V-6	521+24	14'R
V-7	522+01	17.5'L

Total 7 Valve Boxes Raised

Begin Street No. 43      End Street No. 41

Station	Surface Elevation	Elevations
498	677.10	
499	677.44	
500	+06 677.80	
501	+36 677.82	
502	677.68	
503	677.46	
504	+06 677.24	
505	+56 677.22	
506	677.39	
507	677.66	
508	677.98	
509	678.20	
510	678.47	
511	678.74	
512	+06 679.02	
513	+36 679.02	
514	679.86	
515	678.61	
516	678.35	
517	678.10	
518	+06 678.82	
519	+36 677.82	
520	+96 679.42	
521	+31 679.42	
522	678.44	
523	678.84	
524	678.00	
525	+64 677.22	
526	+44 677.22	
527	677.39	
528	677.69	
529	677.99	
530	678.29	
531	+52.5 678.45	
532	678.56	
533	+92.15 678.65	
534	678.59	
535	+42.87 678.44	
536	678.24	
537	677.89	
538	677.54	
539	+92.15 677.22	
540	677.15	
541	676.30	