

**CULVERT DATA**  
 Type: Pipe Culv. Std. Drawing 5-27 RC. 1x3  
 Size: 12" x 20"  
 Work Required: Remove 12" Vitrified Stopper from end of exist. 12" V.R. enc. culvert and extend to left with 12" x 20" Pipe culv. Clean exist. V.P. enc. culvert before extending. Removal of Existing 12" Vitr. Stopper included with Excav. for payment.

Culvert No.	Sheet	Station	Elevation "a"	Elevation "b"	Excavation Cu. Yds.	Old Pavement Removed Sq. Yds.	Pavement Replacement Sq. Yds.	12" V.S.P. (enc.) Lin. Ft.
C-1	9	121+10	678.60	678.85	9.3	13.0	13.0	20
1-C	10	137+41	676.69	676.88	9.3	13.0	13.0	20
2-C	10	141+46	675.31	675.56	9.3	13.0	13.0	20
3-C	10	145+32	674.11	674.36	9.3	13.0	13.0	20
4-C	10	149+11	671.74	671.99	9.3	13.0	13.0	20
1-C	11	161+81	671.91	672.16	9.3	13.0	13.0	20
2-C	11	166+00	670.65	670.90	9.3	13.0	13.0	20
3-C	11	170+02	669.45	669.70	9.3	13.0	13.0	20
4-C	11	174+52	668.10	668.35	9.3	13.0	13.0	20
5-C	11	178+51	666.90	667.15	9.3	13.0	13.0	20
Totals	519-A RE				93.0	130.0	130.0	200

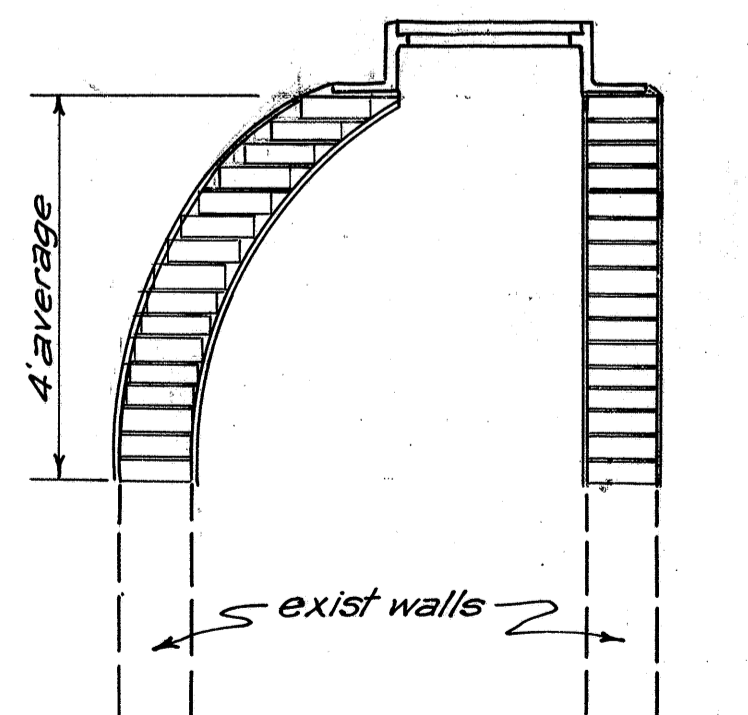

SECTION SHOWING MANHOLE REBUILT See Items (16) on Plan Sheets

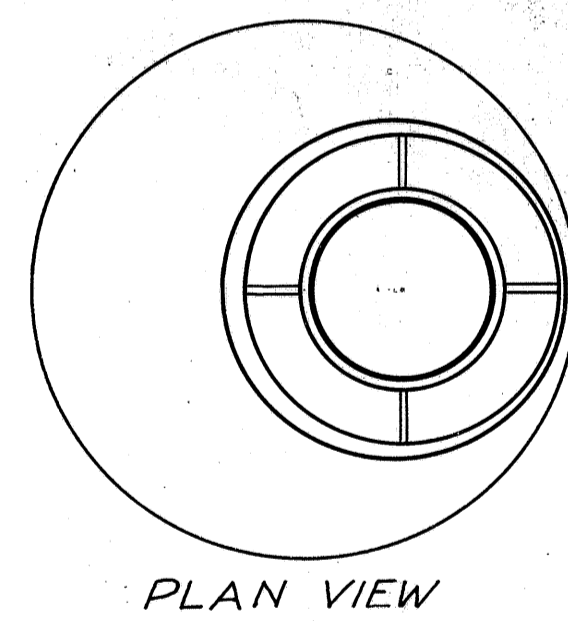
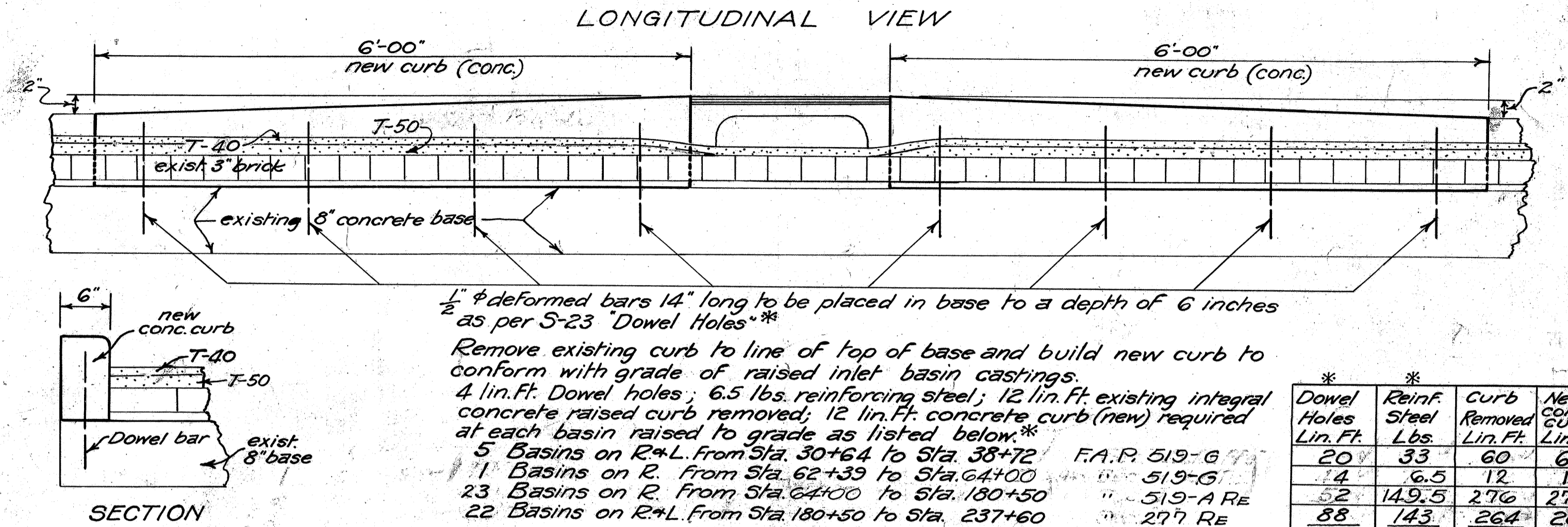

Dowel Holes Lin. Ft.	Reinf. Steel Lbs.	Curb Removed Lin. Ft.	New 12" V.S.P. (enc.) Lin. Ft.
20	33	60	60
4	6.5	12	12
52	149.5	276	276
88	143	264	264
204	333	612	612

Summary shown on Plan Sheets

DETAIL SHOWING CURB AT BASINS RAISED TO GRADE WHERE INT. CONC. RAISED CURB EXISTS

\* Note: Dowel Holes & Dowel bars included in price bid for Type 1-A Conc. Curb.

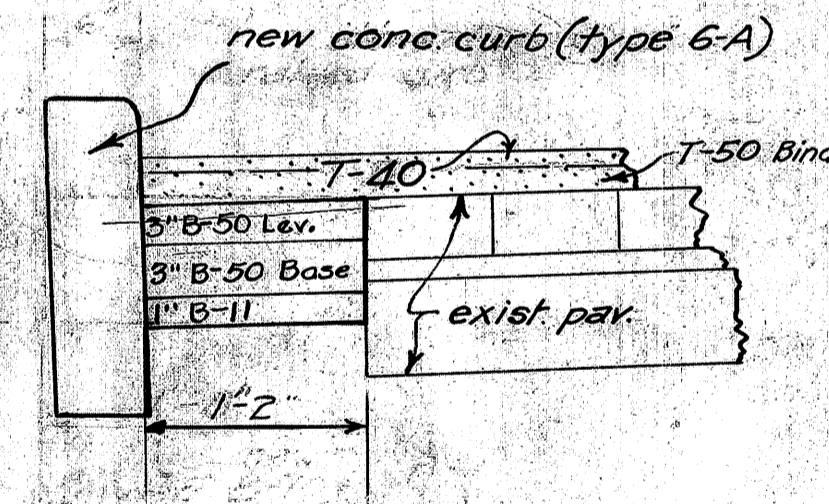
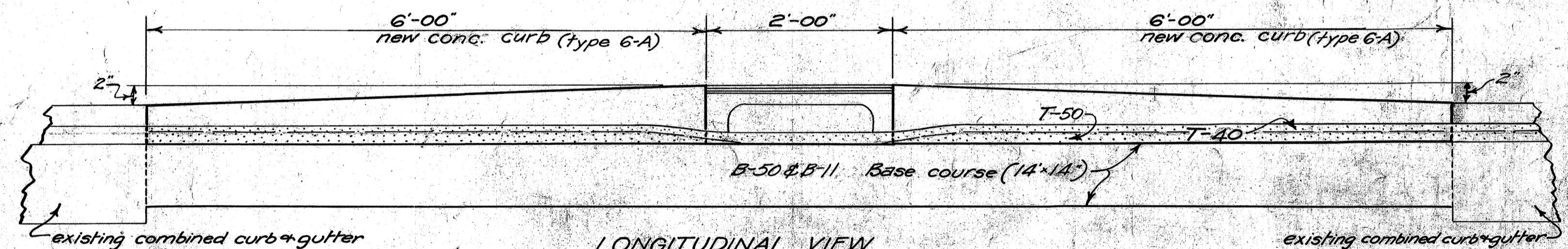

Remove existing curb & gutter and build new 8" B-70 base course to replace removed gutter and build type 6-A conc. curb Item I-12 to conform to grade of raised inlet basin castings.  
 12 lin. Ft. combined concrete curb & gutter removed and disposed of;  
 182 sq. yds. Base Replacement including fine grading;  
 12 lin. Ft. type 6-A concrete curb required at each basin raised to grade as listed below.

Combined Curb & Gutter Removal Lin. Ft.	New Base Replacement Sq. Yds.	6-A Conc. Curb Lin. Ft.
72	10.92	72
144	21.84	144
216	32.76	216

Summary shown on Plan Sheets

DETAIL SHOWING CURB AT BASINS RAISED TO GRADE WHERE COMBINED CURB & GUTTER EXISTS

Note: existing concrete combined curb & gutter to be removed and disposed of for a distance of 6' on each side of basins raised to grade.