

Transition at Beginning of Project
From Sta. 0+00 to 0+60
46.66 Sq. yds. $\frac{3}{4}$ " T-40 Surface (additional)
1"=20'

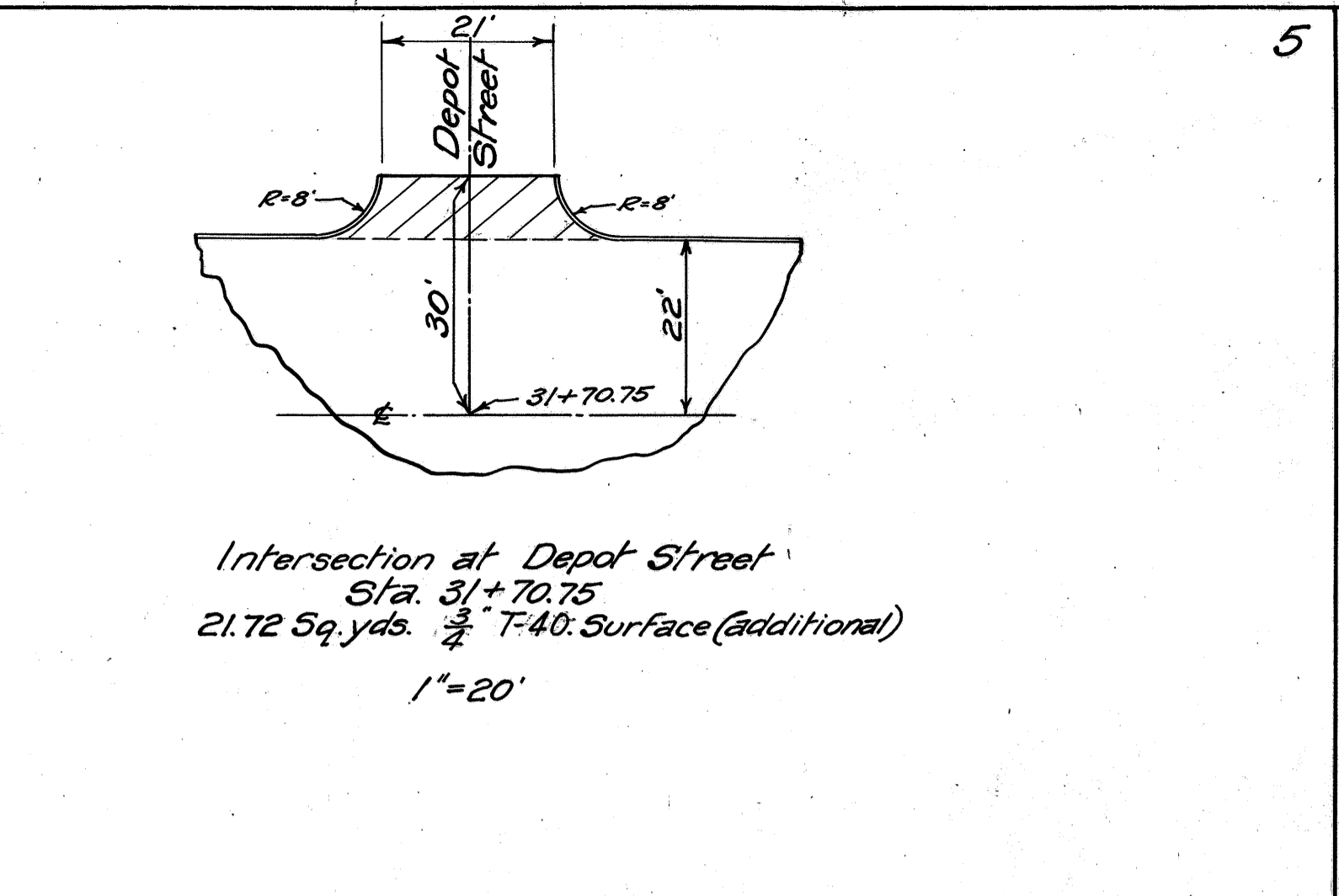

Intersection at Depot Street
Sta. 31+70.75
21.72 Sq. yds. $\frac{3}{4}$ " T-40 Surface (additional)
1"=20'

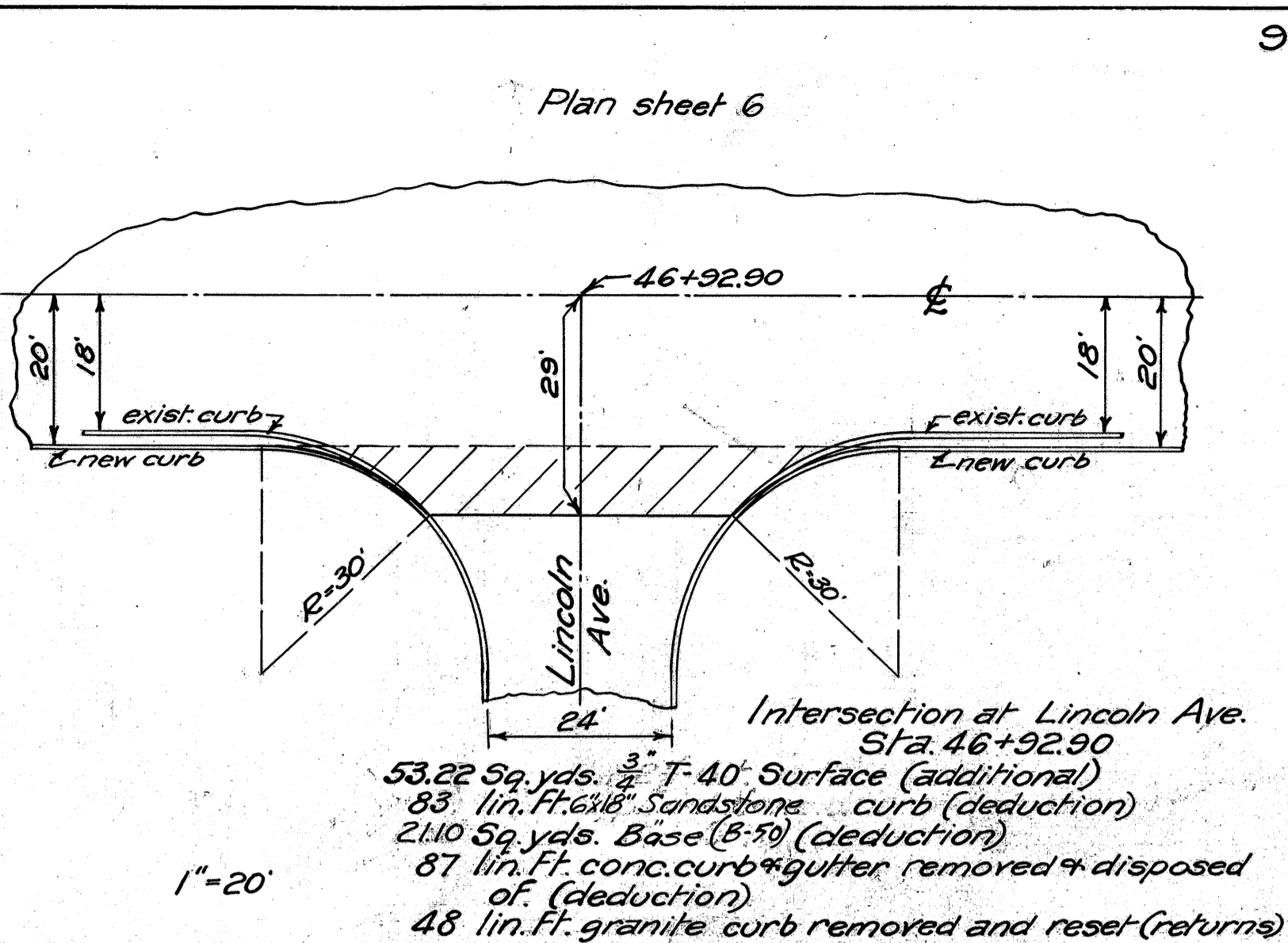

Intersection at Lincoln Ave.
Sta. 46+92.90
53.22 Sq. yds. $\frac{3}{4}$ " T-40 Surface (additional)
83 lin. Ft. 6"x18" Sandstone curb (deduction)
2110 Sq. yds. Base (8-50) (deduction)
87 lin. Ft. conc. curb + gutter removed & disposed of (deduction)
48 lin. Ft. granite curb removed and reset (returns)
1"=20'

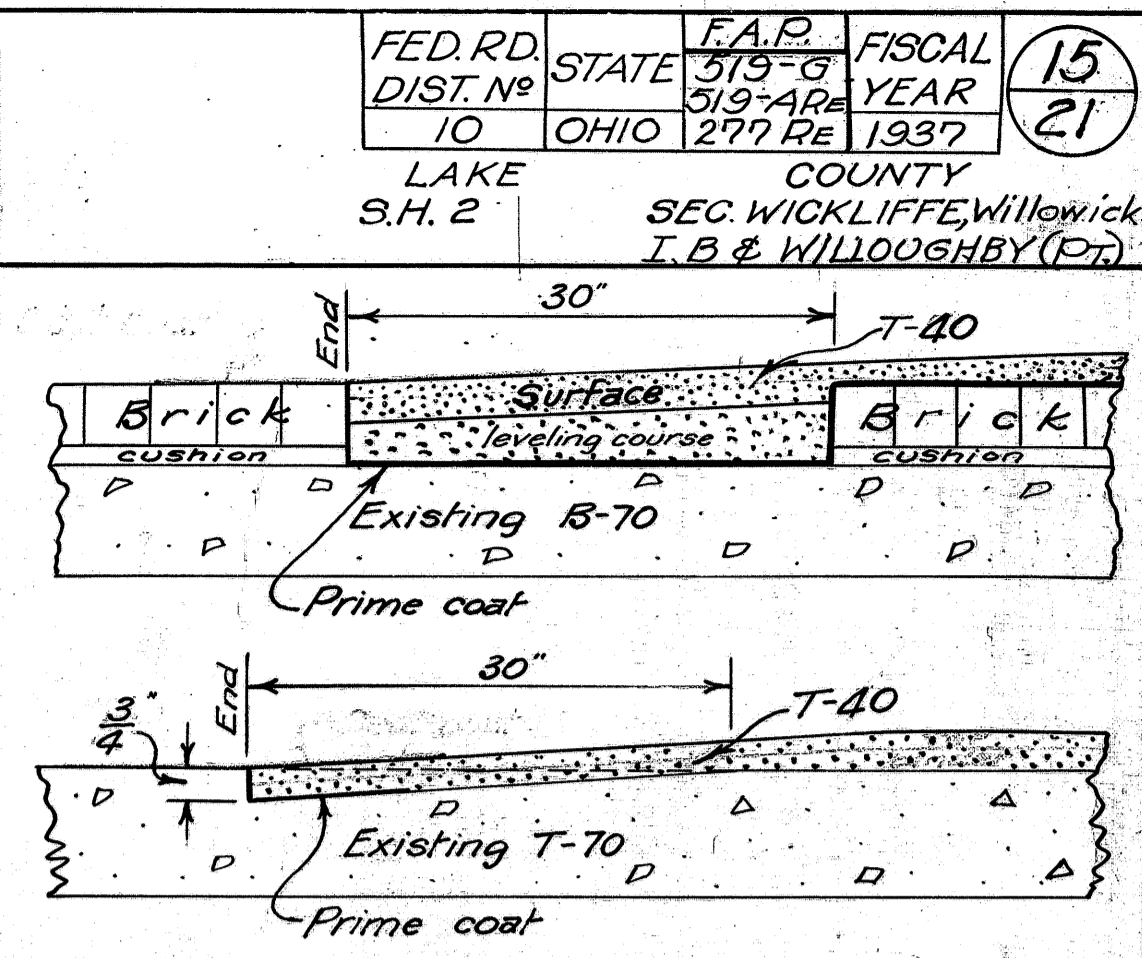

Method of keying in T-40 at ends of project and at all intersecting streets. See note on sheet No 3A for method of payment.
1"=1'

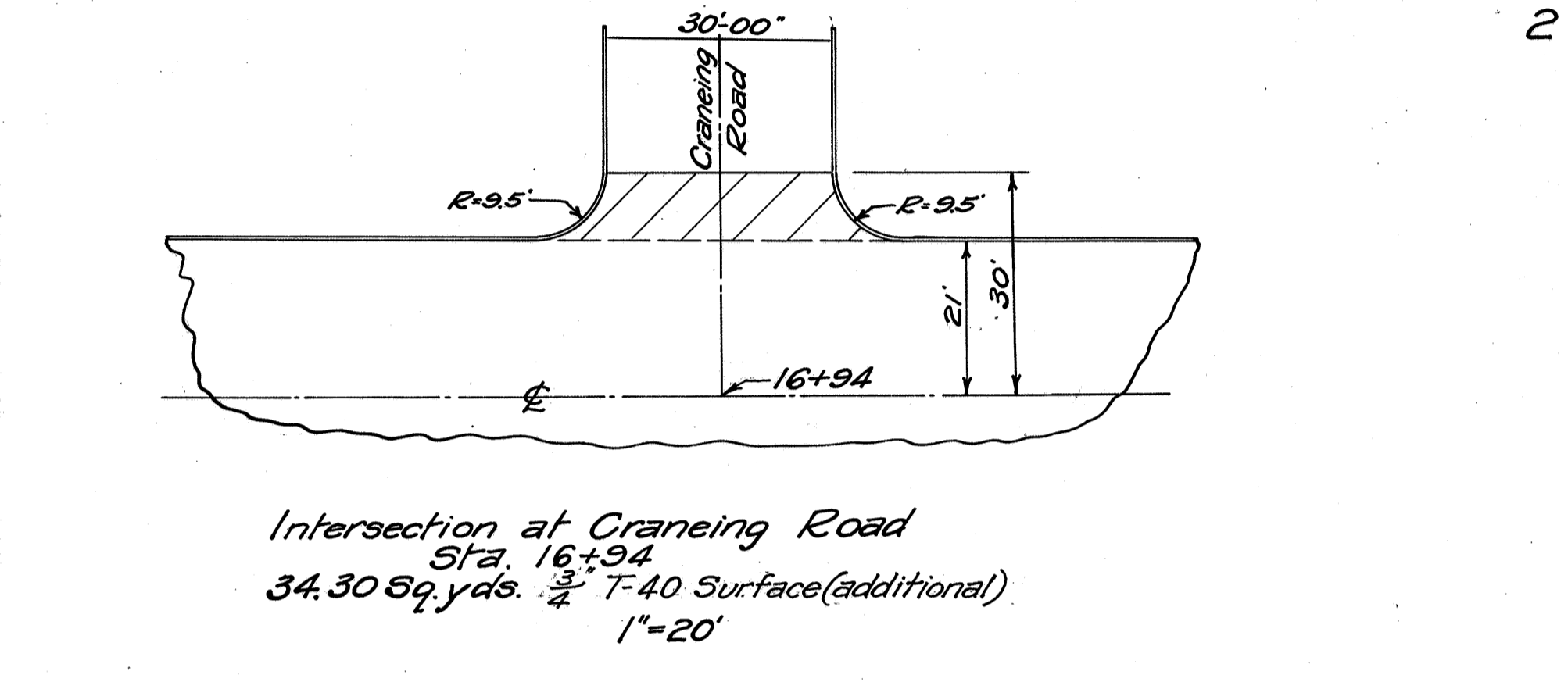

Intersection at Craning Road
Sta. 16+94
34.30 Sq. yds. $\frac{3}{4}$ " T-40 Surface (additional)
1"=20'

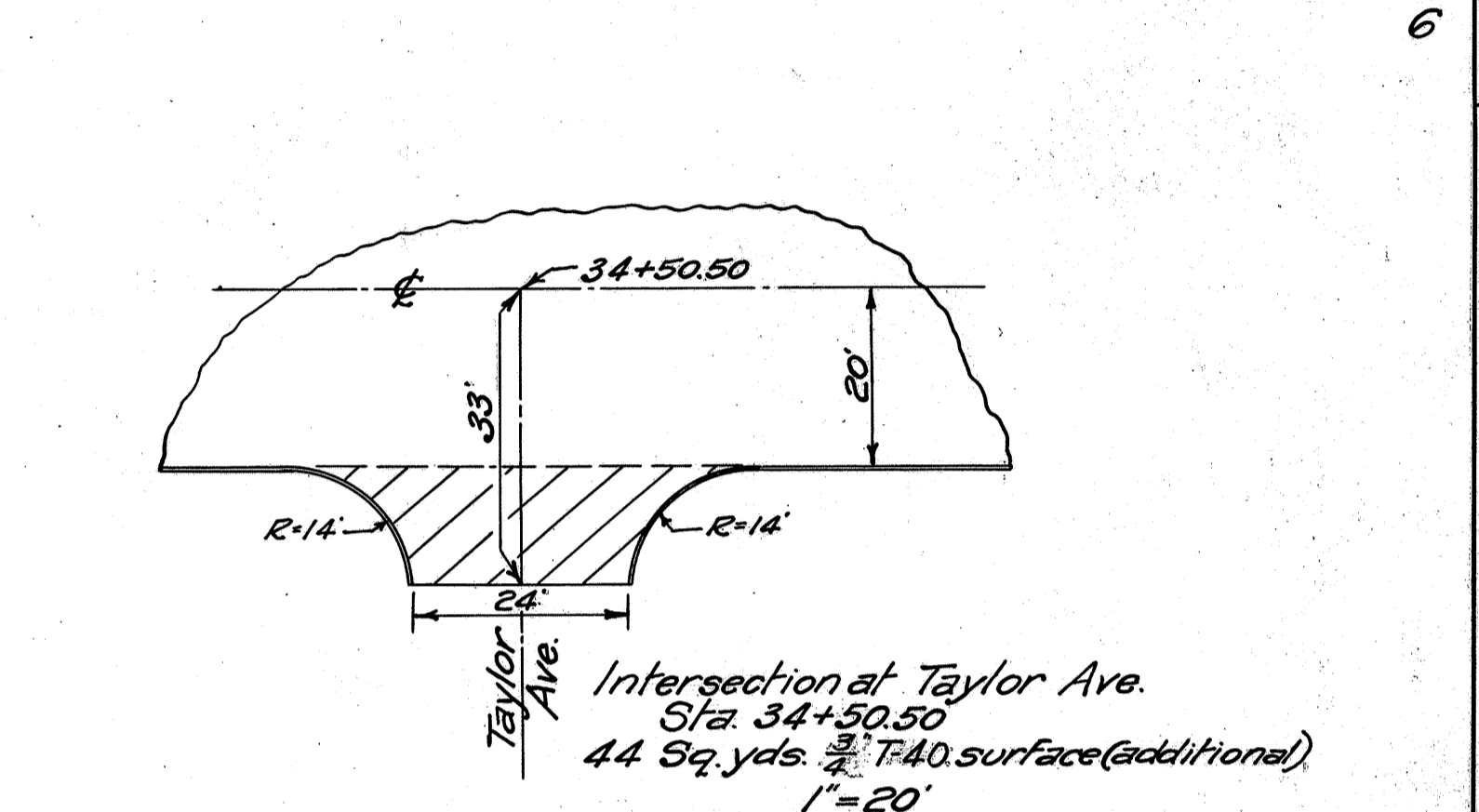

Intersection at Taylor Ave.
Sta. 34+50.50
44 Sq. yds. $\frac{3}{4}$ " T-40 surface (additional)
1"=20'

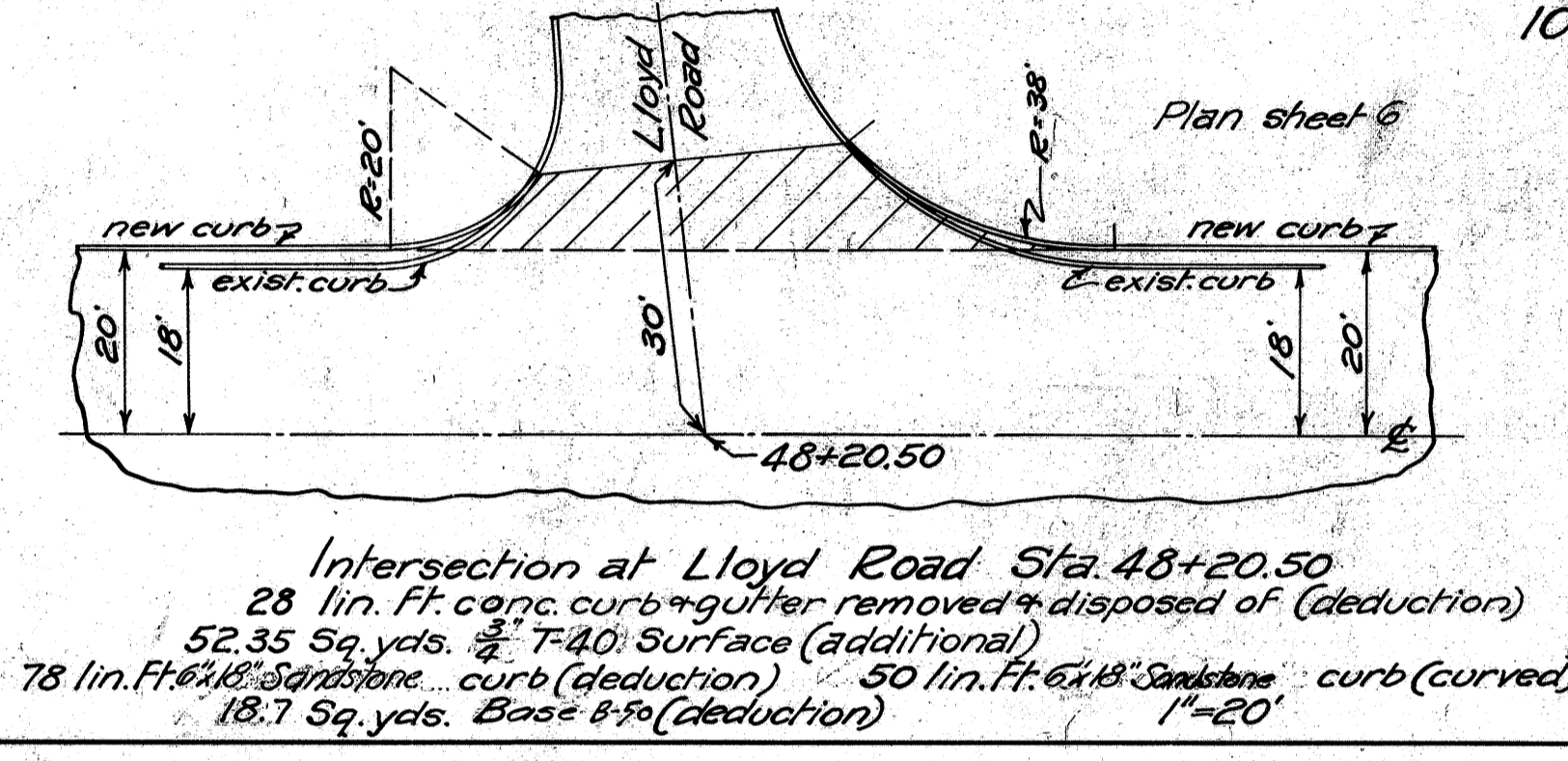

Intersection at Lloyd Road Sta. 48+20.50
28 lin. Ft. conc. curb + gutter removed & disposed of (deduction)
52.35 Sq. yds. $\frac{3}{4}$ " T-40 Surface (additional)
78 lin. Ft. 6"x18" Sandstone curb (deduction) 50 lin. Ft. 6"x18" Sandstone curb (curved)
18.7 Sq. yds. Base (8-50) (deduction)
1"=20'

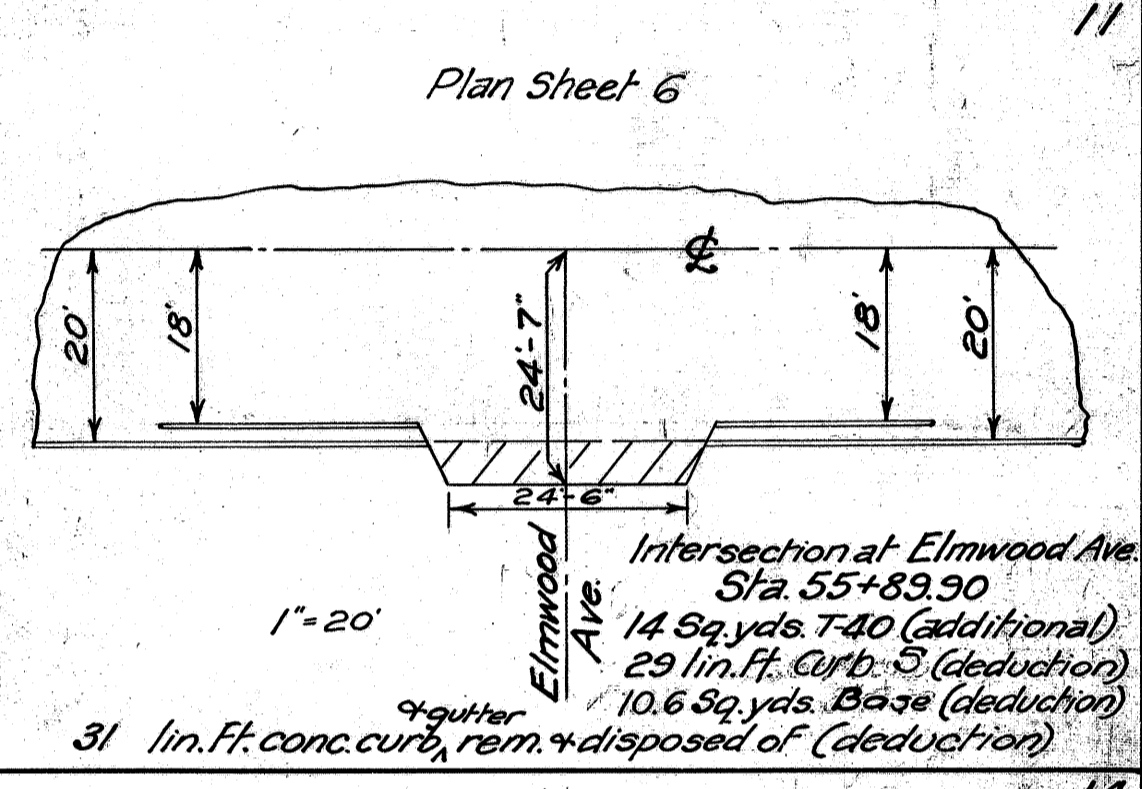

Intersection at Elmwood Ave.
Sta. 55+83.90
14 Sq. yds. T-40 (additional)
29 lin. Ft. Curb (deduction)
10.6 Sq. yds. Base (deduction)
31 lin. Ft. conc. curb, rem. & disposed of (deduction) + gutter
1"=20'

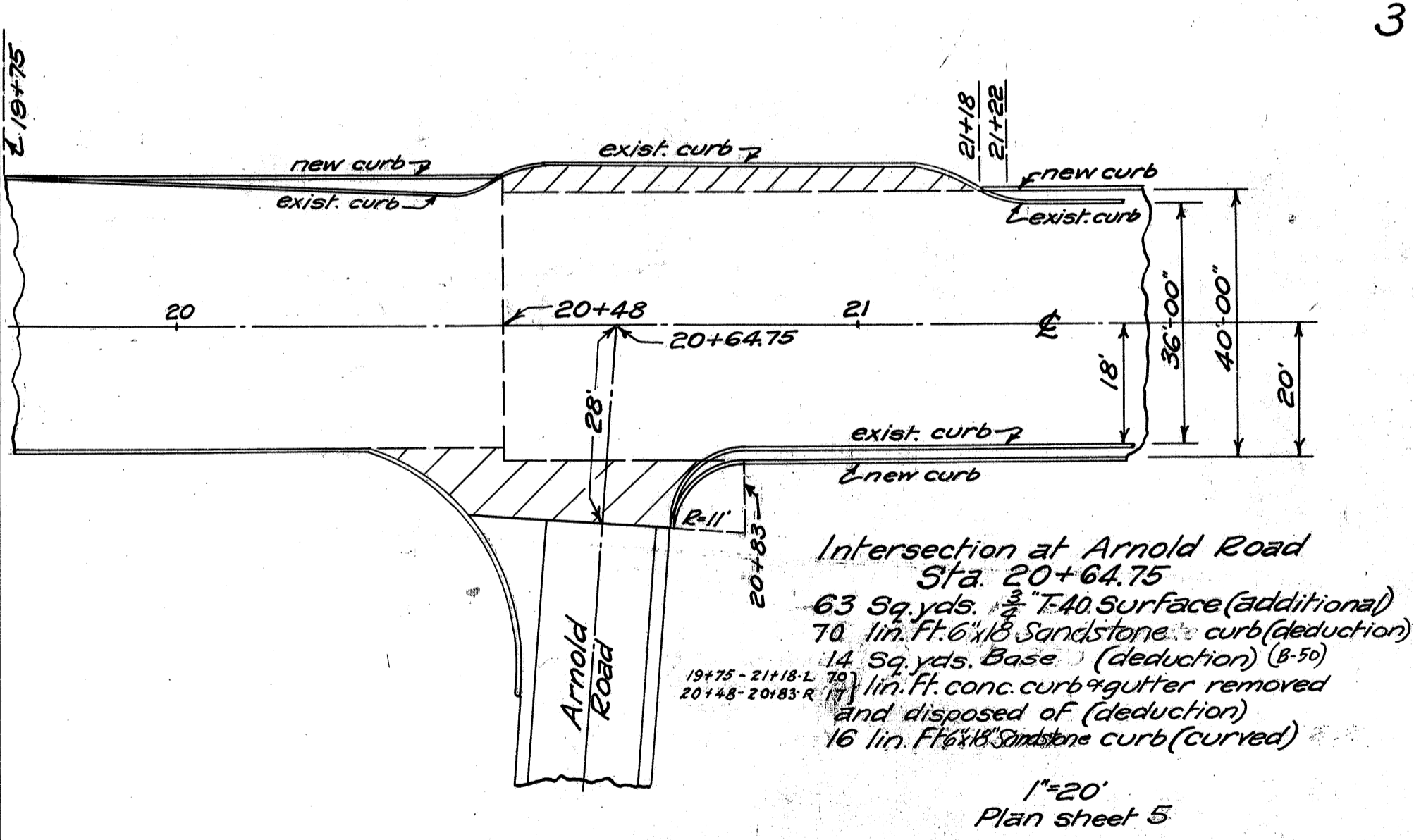

Intersection at Arnold Road
Sta. 20+64.75
63 Sq. yds. $\frac{3}{4}$ " T-40 Surface (additional)
70 lin. Ft. 6"x18" Sandstone curb (deduction)
14 Sq. yds. Base (8-50) (deduction)
19475 - 21118 L. 30' } 17 lin. Ft. conc. curb + gutter removed and disposed of (deduction)
20148 - 20185 R. 17' } 16 lin. Ft. 6"x18" Sandstone curb (curved)
1"=20'

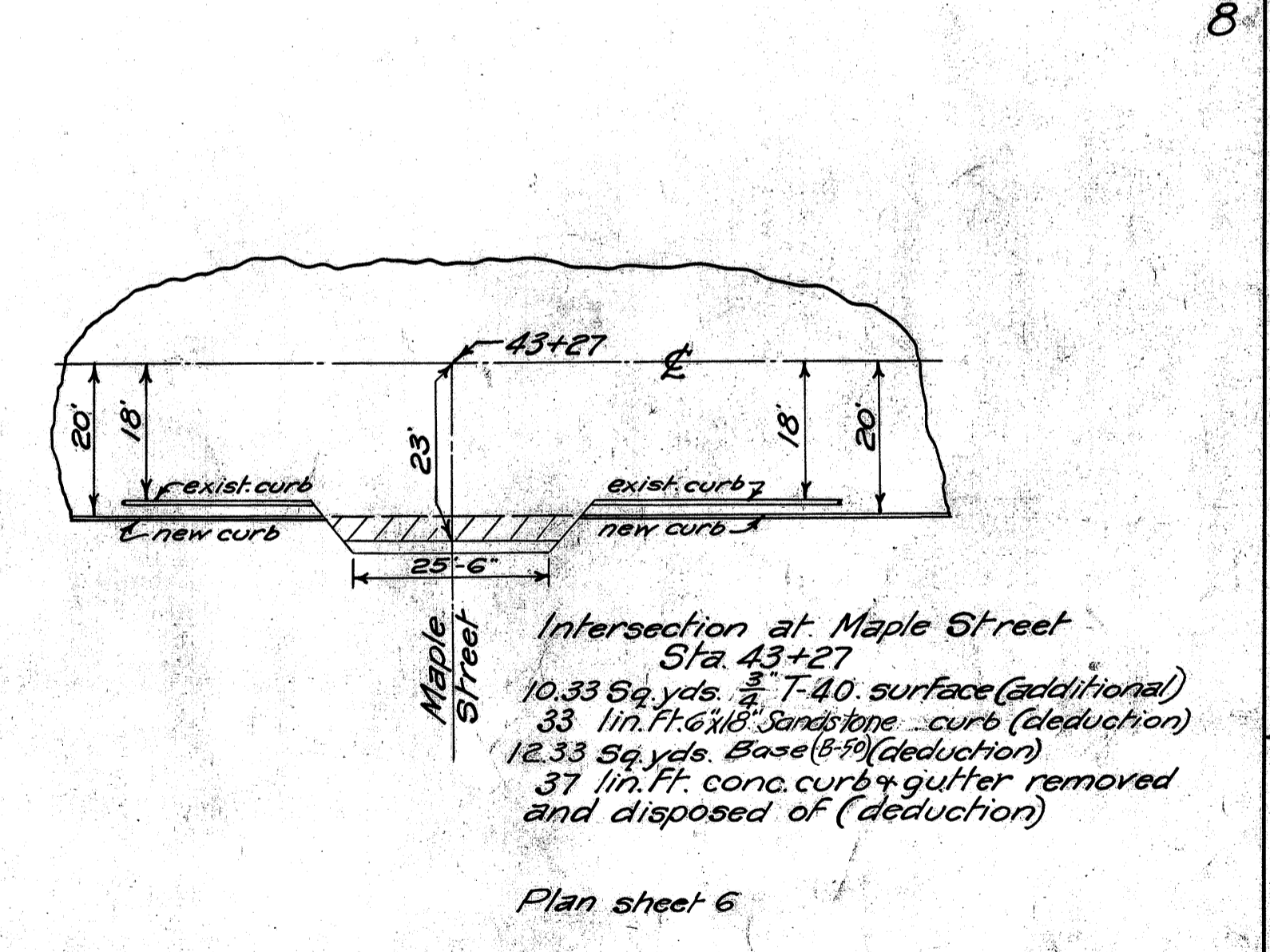

Intersection at Maple Street
Sta. 43+27
10.33 Sq. yds. $\frac{3}{4}$ " T-40 surface (additional)
33 lin. Ft. 6"x18" Sandstone curb (deduction)
12.33 Sq. yds. Base (8-50) (deduction)
37 lin. Ft. conc. curb + gutter removed and disposed of (deduction)
Plan sheet 6
1"=20'

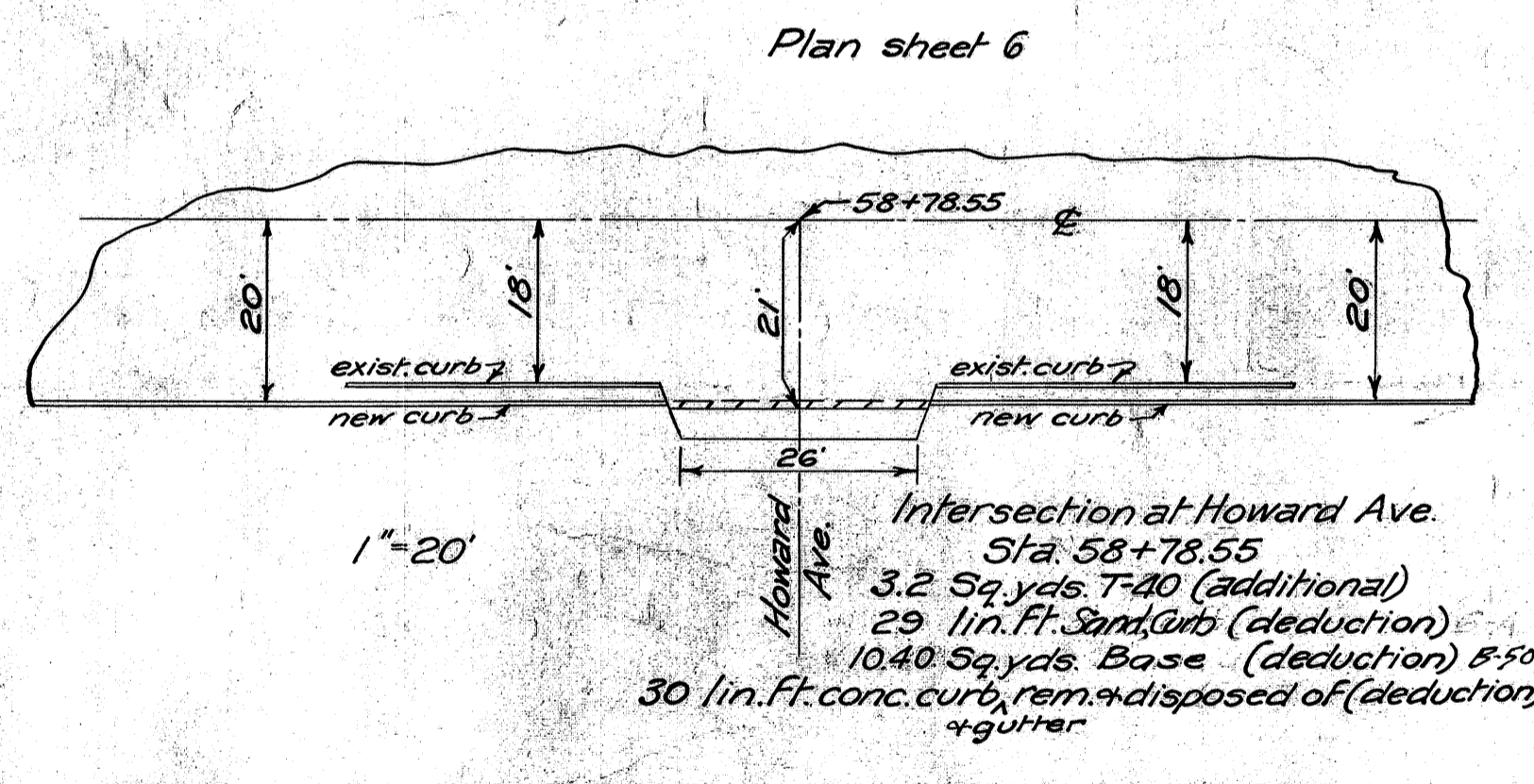

Intersection at Howard Ave.
Sta. 58+78.55
3.2 Sq. yds. T-40 (additional)
29 lin. Ft. Sand. Curb (deduction)
10.40 Sq. yds. Base (deduction) 8-50
30 lin. Ft. conc. curb, rem. & disposed of (deduction) + gutter
1"=20'

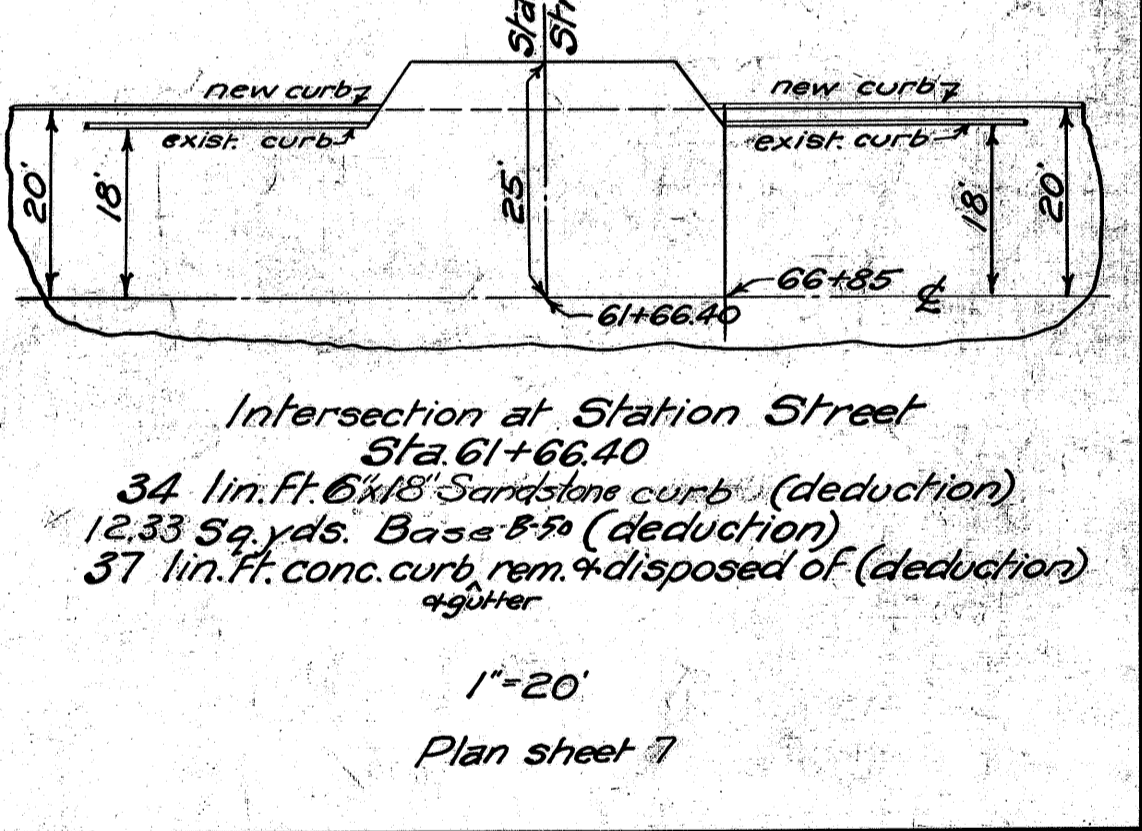

Intersection at Station Street
Sta. 61+66.40
34 lin. Ft. 6"x18" Sandstone curb (deduction)
12.33 Sq. yds. Base (8-50) (deduction)
37 lin. Ft. conc. curb, rem. & disposed of (deduction) + gutter
1"=20'

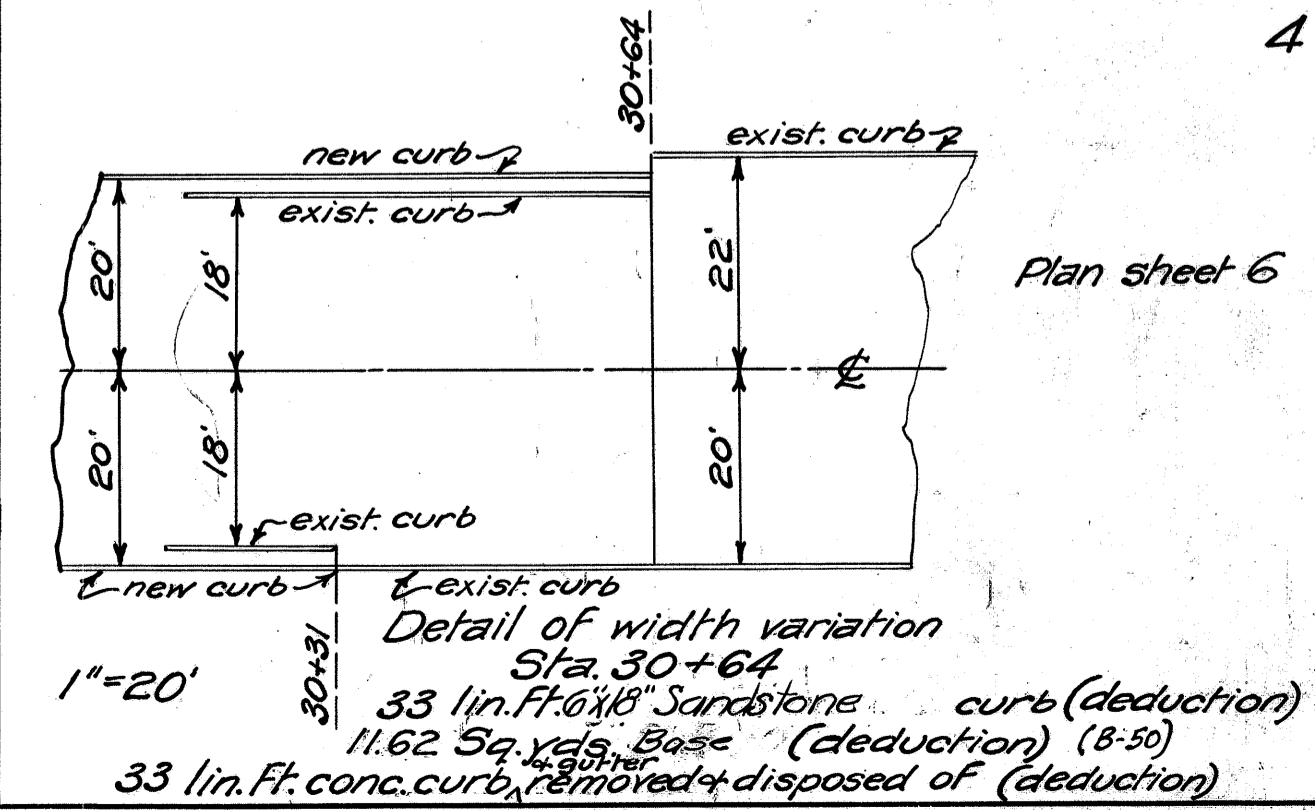

Detail of width variation
Sta. 30+64
33 lin. Ft. 6"x18" Sandstone curb (deduction)
11.62 Sq. yds. Base (deduction) 8-50
33 lin. Ft. conc. curb, removed & disposed of (deduction)
1"=20'

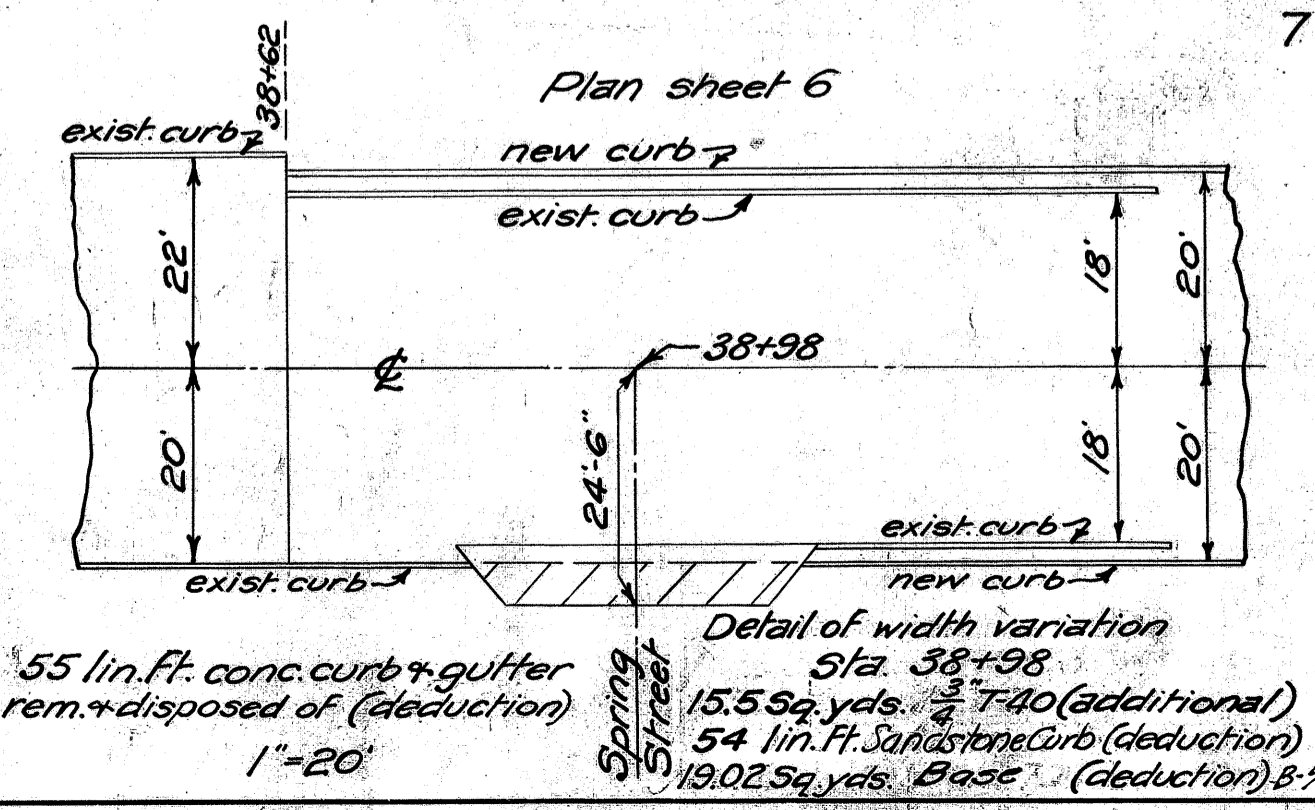

Detail of width variation
Sta. 38+98
55 lin. Ft. conc. curb + gutter rem. & disposed of (deduction)
15.5 Sq. yds. $\frac{3}{4}$ " T-40 (additional)
54 lin. Ft. Sandstone Curb (deduction)
19.02 Sq. yds. Base (deduction) 8-50
1"=20'

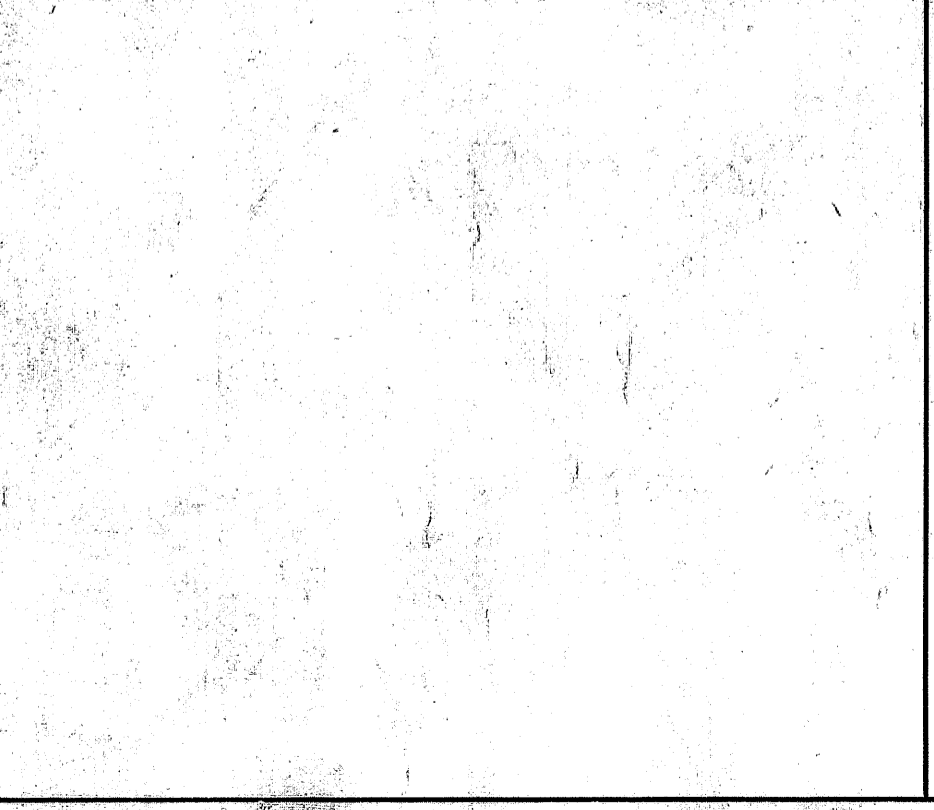

Intersection at Bell Ave.
Sta. 61+63
17.37 Sq. yds. T-40 (additional)
43 lin. Ft. Sand. Curb (deduction)
13.56 Sq. yds. Base (deduction) 8-50
32 lin. Ft. conc. curb, removed and disposed of (deduction)
10 lin. Ft. 6"x18" Sandstone curb (curved)
1"=20'

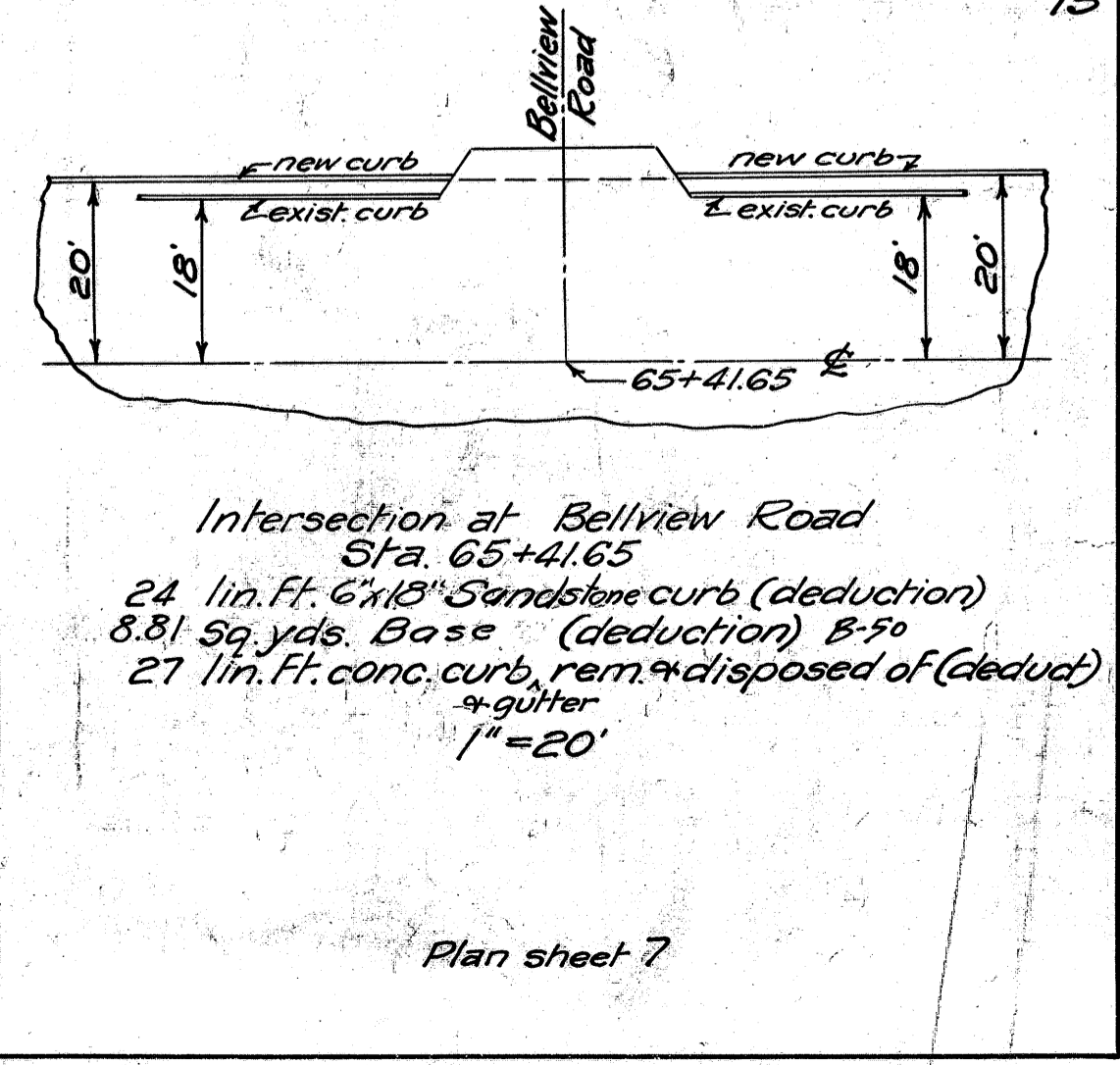

Intersection at Bellview Road
Sta. 65+41.65
24 lin. Ft. 6"x18" Sandstone curb (deduction)
8.81 Sq. yds. Base (deduction) 8-50
27 lin. Ft. conc. curb, rem. & disposed of (deduction) + gutter
1"=20'