

SUMMARY OF INLET BASIN CASTINGS RAISED TO GRADE (I.B.)

Item No.	Station	Dist. R or L
I.B. 1	191+25	20' R
I.B. 2	191+25	20' R
I.B. 3	196+73	20' L
I.B. 4	196+73	20' R
I.B. 5	201+51	20' L
I.B. 6	201+51	20' L
I.B. 7	210+50	20' L
I.B. 8	210+50	20' R
I.B. 9	215+50	20' R
I.B. 10	215+50	20' R
Total	10	277 Re

SUMMARY OF MANHOLE CASTINGS RAISED TO GRADE (M.H.)

Item No.	Station	Dist. R or L
M.H. 1	188+59	12' R
M.H. 2	193+59	13' R
M.H. 3	196+59	13' R
M.H. 4	203+52	13' R
M.H. 5	208+60	14' R
M.H. 6	213+61	14' R
M.H. 7	218+60	14' R
Total	7	277 Re

CURB INCIDENTALS ADJACENT TO BASINS RAISED TO GRADE

Station	R or L	Dowel Poles Lin. Ft.	Reinf. Steel Lbs.	Curb Removed Lin. Ft.	New Curb Lin. Ft. @
191+25	R	4	6.5	12	12
191+25	L	4	6.5	12	12
196+73	R	4	6.5	12	12
196+73	L	4	6.5	12	12
201+51	L	4	6.5	12	12
201+51	R	4	6.5	12	12
210+50	L	4	6.5	12	12
210+50	R	4	6.5	12	12
215+50	R	4	6.5	12	12
215+50	L	4	6.5	12	12
Totals	277 Re	40	65.0	120	120

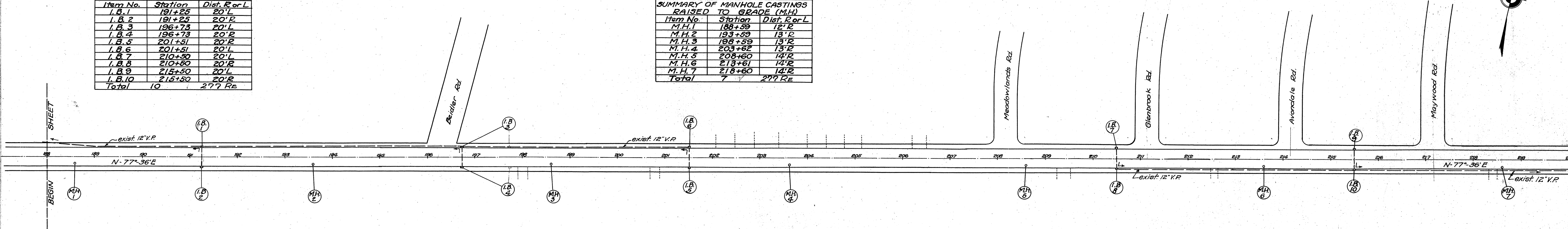

B.M. No. 38 STA 191+0
Spike Telephone Pole 24' L of C.
Elevation 674.04

B.M. No. 39 STA 196+65
Spike Telephone Pole 24' L of C.
Elevation 680.805

B.M. No. 40 STA 201+09
Spike root 30" Maple 35' L of C.
Elevation 685.33

B.M. No. 41 STA 206+20
Spike 20" Poplar 44' R of C.
Elevation 685.405

B.M. No. 42 STA 210+80
Spike Telephone Pole 24' L of C.
Elevation 684.10

B.M. No. 43 STA 217+08
Spike 24" Maple 24' R of C.
Elevation 685.81

