

Note: Marker to be furnished and erected on the left by the State before acceptance of this project.

Station	CURB INCIDENTALS		ADJACENT TO BASINS		RAISED TO GRADE		New Catch Basins	Total
	R or L	Dowel Holes Lin. Ft.	Reinf. Steel Lbs.	Curb. Rem. Lin. Ft.	New Curb Lin. Ft.	Curb. Rem. Lin. Ft.		
161+81	R						12	1.82
161+81	L	4	6.5	12	12	12		
166+0	R						12	1.82
166+0	L	4	6.5	12	12	12		
170+02	R						12	1.82
170+02	L	4	6.5	12	12	12		
174+52	R						12	1.82
174+52	L	4	6.5	12	12	12		
178+51	R						12	1.82
178+51	L	4	6.5	12	12	12		
182+38	R						12	1.82
182+38	L	4	6.5	12	12	12		
185+99	R						12	1.82
185+99	L	4	6.5	12	12	12		
Total 519-A RE		20	32.6	60	60	60		31.0
Total 277 RE		16	22.8	48	48	48		27.0
Total		36	55.4	108	108	108		58.0

Item No.	Station	Remarks
R.B-1	170+02	
R.B-2	174+52	
Total	519-A RE	2

Item No.	Station	Dist. East	Remarks
B-1	161+81	18'L	
B-2	166+0	18'L	
B-3	170+02	18'L	
B-4	174+52	18'L	
B-5	178+51	18'L	
Total	519-A RE		5

Item No.	Station	Structure	Type	Size	Excavation Cu Yds	Pipe Lin. Ft.	Span	Span Under	Remarks
1-C	161+81	12" V.P.	Pipe	12"x20"	9.3	20	13.0	13.0	Remove 12" V.P. Siph. from L end exist. culv. and extend to L.
2-C	166+0	12" V.P.	Pipe	12"x20"	9.3	20	13.0	13.0	
3-C	170+02	12" V.P.	Pipe	12"x20"	9.3	20	13.0	13.0	
4-C	174+52	12" V.P.	Pipe	12"x20"	9.3	20	13.0	13.0	
5-C	178+51	12" V.P.	Pipe	12"x20"	9.3	20	13.0	13.0	
Totals	519-A RE				46.5	100	65.0	65.0	

Item No.	Station	Dist. East	Remarks
M.H.1	158+57	8' R	
M.H.2	163+58	7.5' R	
M.H.3	173+59	8' R	
M.H.4	178+59	9' R	
M.H.5	183+59	13' R	
M.H.6	187+73	13' R	
M.H.7	187+78	12' R	
Total	519-A RE = 4		277 RE = 3

Item No.	Station	Dist. East	Remarks
I.B.1	161+81	20' R	
I.B.2	166+0	20' R	
I.B.3	170+02	20' R	
I.B.4	174+52	20' R	
I.B.5	178+51	20' R	
I.B.6	182+38	20' R	
I.B.7	182+38	20' R	
I.B.8	185+99	20' R	
I.B.9	185+99	20' R	
Total	519-A RE = 5		277 RE = 4

Item No.	Station	Location
Mon-1	170+57.40	+
Total	519-A RE	1

B.M. No. 32 STA. 160+87  
Spike 12" Oak 25' R. of  $\pm$   
Elevation 680.005

B.M. No. 33 STA. 166+72  
Spike 24" Maple 31' R. of  $\pm$   
Elevation 676.165

B.M. No. 34 STA. 171+12  
Spike 36" Maple 25' R. of  $\pm$   
Elevation 673.708

B.M. No. 35 STA. 175+07  
Spike 24" Maple 24' E. of  $\pm$   
Elevation 674.723

B.M. No. 36 STA. 182+27  
Spike Telephone Pole 24' L. of  $\pm$   
Elevation 671.065

B.M. No. 37 STA. 185+47  
X-S.W. Corner Stone Wall 23' L. of  $\pm$   
Elevation 669.065

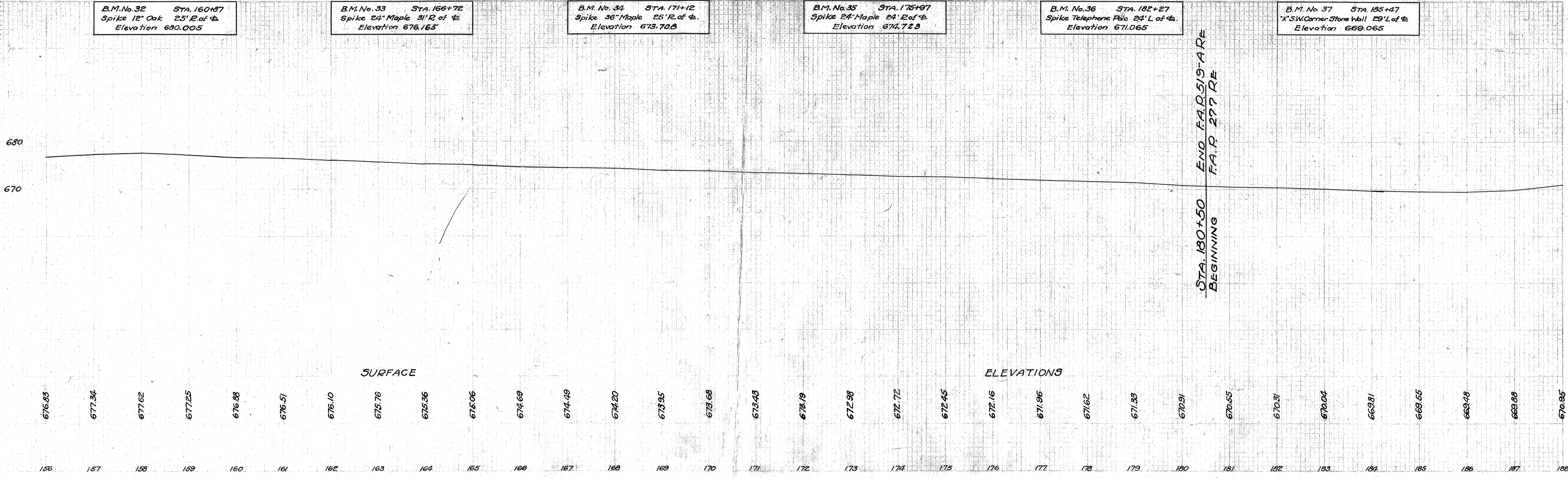

STA. 180+50 BEGINNING  
END F.A.D. 519-A RE  
F.A.R. 277 RE

STA. 180+50 OF F.A.R. 277 RE  
STA. 0+00 OF F.A.R. 277  
STA. 180+50 OF F.A.R. 519-A RE  
STA. 180+50 OF F.A.R. 519-A

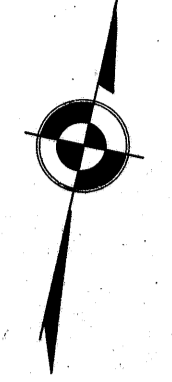

P.T. 156+01.17  
BEGIN STREET

277 RE  
F.A.D. 519-A RE

F.A. 519-A RE

END F.A.R. 519-A RE  
F.A.R. 277 RE

STA. 180+50 BEGINNING  
F.A. 277 RE

END SHEET