

Item No.	Station	Remarks
R.B. 1	98+36	Existing casting to be used in new C.B.
R.B. 2	101+51	" " " " " " " "
R.B. 3	112+51	" " " " " " " "
Total 519-A RE 3		

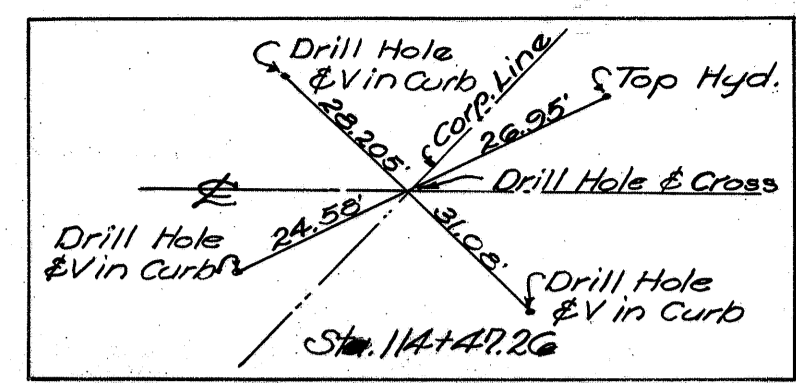

Station	R. or L.	Dowel Holes Lin. Ft.	Reinf. Steel Lbs.	Curb Removal Lin. Ft.	New Curb Lin. Ft.	Base Replacement Conc. 6" A. 5y Yds. @ 20 Curb Lin. Ft.	Curb Gutter Rem. Lin. Ft.
92+75	R	4	6.5	12	12		
101+51	R	4	6.5	12	12		
104+38	R	4	6.5	12	12		
112+51	R	4	6.5	12	12		
121+10	R+L	4	7.0	12	12	1.82	12
Total 519-A RE 20 33 60 60 1.82 12 12 +2658							

Item No.	Station	Remarks	Type	Size	Excavation Cu. Yds.	Pipe Lin. Ft.	Span	AND	UNDER	Remarks
C-1	121+10		PIPE	12"x20"	9.3	20	13.0			Remove 12" Wt. 5' from L end exist. culv. and extend to L.
Totals 519-A RE 1 9.3 20 13.0 13.0										

12" V.S.P. Stoppers Incl. with Excav.

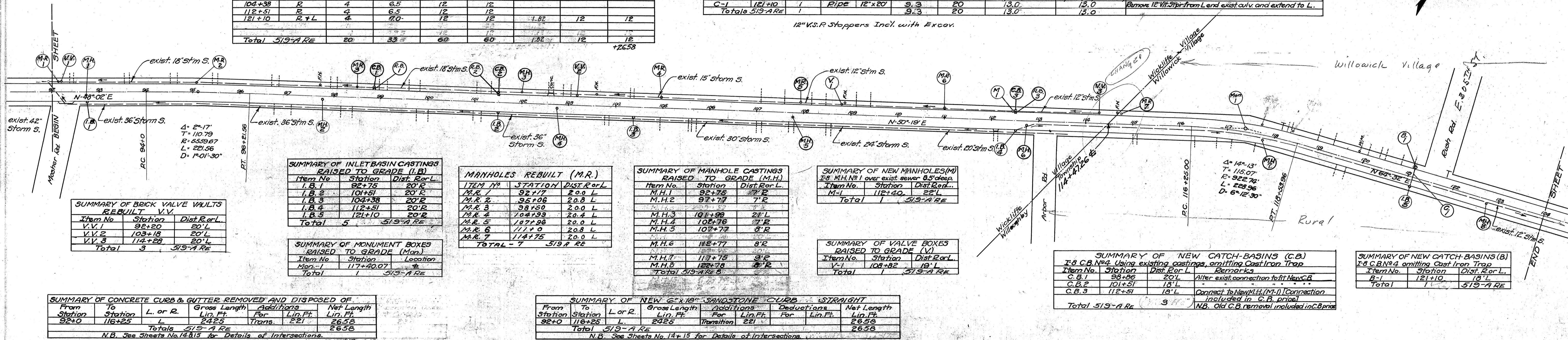

Item No.	Station	Dist. R or L
V.V. 1	93+20	20'L
V.V. 2	103+18	20'L
V.V. 3	114+28	20'L
Total 3 519-A RE		

Item No.	Station	Dist. R or L
I.B. 1	92+75	20'R
I.B. 2	101+51	20'R
I.B. 3	104+38	20'R
I.B. 4	112+51	20'R
I.B. 5	121+10	20'R
Total 5 519-A RE		

Item No.	Station	Dist. R or L
M.R. 1	92+17	2.0 L
M.R. 2	95+06	2.0 L
M.R. 3	98+50	2.0 L
M.R. 4	104+99	2.0 L
M.R. 5	107+98	2.0 L
M.R. 6	111+0	2.0 L
M.R. 7	114+75	2.0 L
TOTAL - 7 519-A RE		

Item No.	Station	Dist. R or L
M.H. 1	92+75	20'R
M.H. 2	97+77	7'E
M.H. 3	101+99	24'L
M.H. 4	102+76	7'E
M.H. 5	107+77	8'E
M.H. 6	112+77	8'E
M.H. 7	117+75	9'E
M.H. 8	122+78	8'E
Total 519-A RE 8		

Item No.	Station	Dist. R or L
M.L. 1	112+51	20'L
Total 1 519-A RE		

Item No.	Station	Dist. R or L
V-1	108+82	18'L
Total 1 519-A RE		

Item No.	Station	Dist. R or L	Remarks
C.B. 1	98+36	20'L	Alter exist. connection to fit New C.B.
C.B. 2	101+51	18'L	Connect to New M.H. (M-1) Connection included in C.B. price
C.B. 3	112+51	18'L	Connect to New M.H. (M-1) Connection included in C.B. price
Total 519-A RE 3			

Item No.	Station	Dist. R or L
C.B. 4	121+10	18'L
Total 1 519-A RE		

From Station	To Station	L. or R.	Gross Length Lin. Ft.	Additions For Lin. Ft.	Deductions For Lin. Ft.	Net Length Lin. Ft.
92+0	116+25	L	2425	221		2656
Total 519-A RE 2425 221 2656						

From Station	To Station	L or R.	Gross Length Lin. Ft.	Additions For Lin. Ft.	Deductions For Lin. Ft.	Net Length Lin. Ft.
92+0	116+25	L	2425	221		2656
Total 519-A RE 2425 221 2656						

B.M. No. 19 STA. 94+20  
Spike 12" Elm 33' R of &  
Elevation 686.502

B.M. No. 20 STA. 98+57  
Spike 14" Maple 55' R of &  
Elevation 687.122

B.M. No. 21 STA. 104+13  
Spike 10" Maple 31' R of &  
Elevation 687.042

B.M. No. 22 STA. 108+87  
Spike 15" Maple 30' R of &  
Elevation 686.378

B.M. No. 23 STA. 113+34  
Spike 14" Maple 32' L of &  
Elevation 685.835

B.M. No. 24 STA. 118+44  
Spike 18" Catalpa 30' L of &  
Elevation 686.470

B.M. No. 25 STA. 122+95  
Spike 76' Pole 23' R of &  
Elevation 682.33

